

INSTRUCTION MANUAL

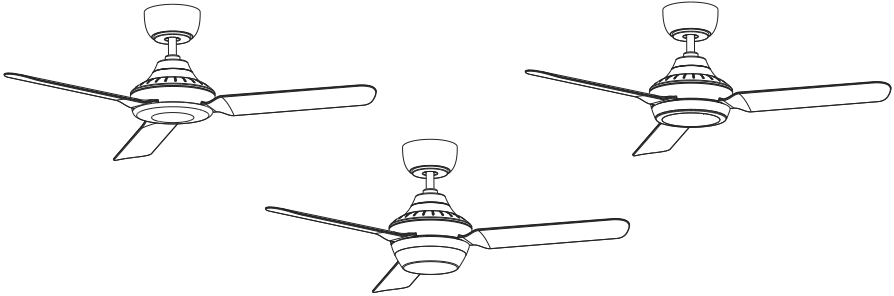

STANZA^{DC}



The images in this manual are for reference only.
Specifications subject to change without notice.

Ceiling Fan Installation Manual, Rev 1.01

WITHOUT LIGHT	WITH LIGHT
STADC1203CL STADC1203WH STADC1403WH	STADC1203WH-L STADC1203WH-LED
OPTIONAL REMOTE CONTROL	
SDCRC	
OPTIONAL EXTENSION RODS	
SDCEXTR60WH - 600mm Extension Rod to suit STANZA DC - White SDCEXTR90WH - 900mm Extension Rod to suit STANZA DC - White	

- SAFETY PRECAUTIONS
- SPECIFICATIONS
- INSTALLATION
- OPERATION
- MAINTENANCE
- TROUBLESHOOTING
- WARRANTY

CAUTION

Read Instructions Carefully for safe
Installation and Fan Operation.

MUST BE INSTALLED BY A
LICENSED ELECTRICIAN.



NOT FOR DIY
PROFESSIONAL INSTALLATION REQUIRED

THANK YOU FOR YOUR PURCHASE...

Congratulations on selecting a quality Ventair DC ceiling fan! You've invested in superior performance, comfort, and energy efficiency that will benefit you for many years to come.

For the safe, correct, and optimal operation of your new Ventair DC ceiling fan, it's absolutely essential that you take the time to thoroughly read and understand all the instructions provided within this manual before commencing any installation or use.

The detailed information presented in the subsequent pages has been carefully compiled to ensure you experience trouble-free operation of your ceiling fan, allowing you to fully enjoy its benefits.

SAFETY PRECAUTIONS

1. To ensure a successful installation, please read the instructions and study the diagrams thoroughly.
2. For your safety, all electrical work must only commence after the power supply has been isolated. This requires removing fuses or turning off the circuit breaker to ensure an all-pole isolation of the electrical supply.
3. To ensure optimal performance and safety, make sure the rotating fan blades will not come into contact with any objects at your installation site. There should be a minimum clearance of 300 mm from the blade tip to any wall or ceiling. Please note that greater clearance around the fan will improve airflow.
4. The fixing point for the fan must be able to support 4 times the net weight of the fan. Net weights can be found on the next page. If you are mounting the fan to a ceiling junction box, the box and fixing must be able to support the moving weight of the fan and must not twist or work loose.
5. The fan must be earthed.
6. Do not connect the fan motor to a dimmer switch. This may give an unsatisfactory performance (motor hum) and cause damage to the motor and void your warranty.
7. It's not recommended to operate ceiling fans and gas appliances in the same room simultaneously.
8. Do not insert anything into the fan blades while the fan is operating. This will damage the blades and upset the balance of the unit causing the unit to wobble.
9. After completing the fan's installation, check that all connections are secure and tight to avoid any problems.
10. Due to the fan's natural movement, some connections may loosen over time. To ensure continued safety and performance, check the support connections, brackets, and blade attachments twice a year to confirm they are secure. If any are loose, simply tighten them with a screwdriver.
11. Always have your fan installed by a licensed electrician.
12. This appliance is not intended for use by persons (including children) with reduced physical, sensory or mental capabilities, or lack of experience and knowledge, unless they have been given supervision or instruction concerning use of the appliance by a person responsible for their safety.
13. Children should be supervised to ensure that they do not play with the appliance.
14. For safe and effective operation, Ventair recommends the fan blades be installed at least 2.1m above the floor.

SPECIFICATIONS

IMPORTANT:

This fan is suitable for indoor / fully covered outdoor use only.
An all-pole disconnection switch must be incorporated into the fixed wiring, in accordance with local wiring rules.

MODEL	Light Wattage (W)	Fan Wattage (W)	Voltage (V)	Frequency (Hz)	Net Weight (Kg)
STADC1203WH STADC1203CL	No Light	20 watts	220-240V	50Hz	4.83kg
STADC1203WH-LED	20 watts	20 watts	220-240V	50Hz	5.0kg
STADC1203WH-L	2x7W B22 14W	20 watts	220-240V	50Hz	5.0kg
STADC1403WH	No Light	35 watts	220-240V	50Hz	5.16kg

Maximum Mounting Angle 18°

DIMENSIONS

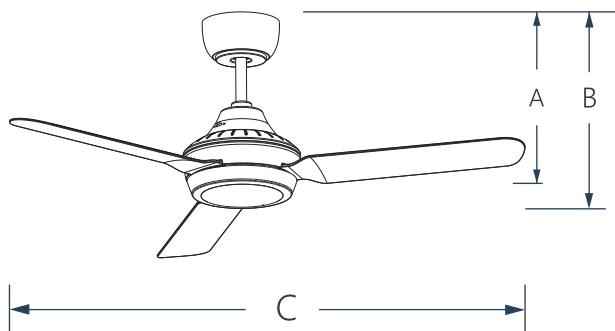

		A (BLADE)	B (TOTAL)	C (SWEEP)
1200MM	NO LIGHT	343mm	355mm	1200mm
	WITH LED	343mm	375mm	1200mm
	WITH B22	343mm	404mm	1200mm
1400MM	NO LIGHT	343mm	355mm	1400mm

PARTS LIST

Carefully unpack the fan and check all parts are present and free from any damage.

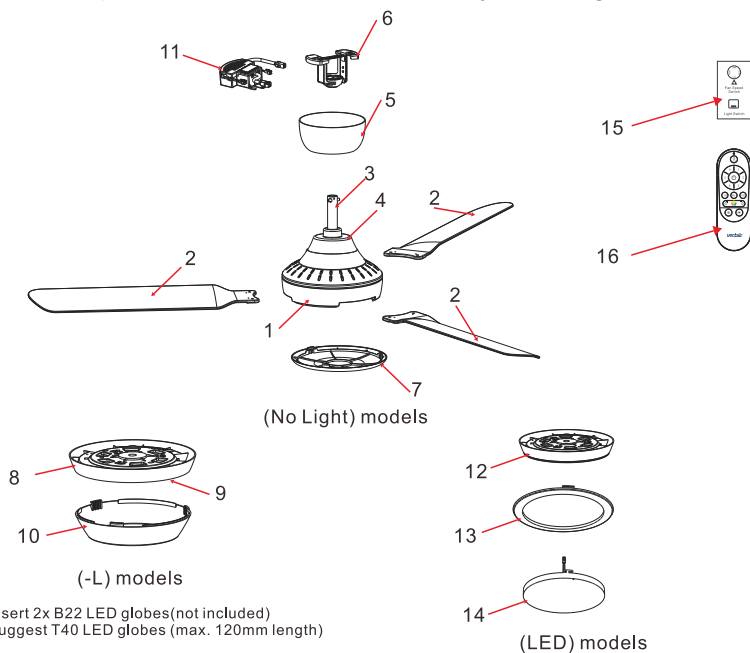

Figure 1 - Parts Diagram

Part	Quantity
1. Motor Assembly	1
2. Blades	1(set of 3)
3. Down Rod	1*
4. Lower Canopy	1
5. Upper Canopy	1
6. Hang-Sure Set	1
7. Fascia	1
8. Light frame	1
9. B22 lamp holders	1
10. Light diffuser	1
11. LED Light Driver	1
12. Light frame	1
13. Decorative Ring	1
14. LED Light Panel	1
15. Wall Control	1
16. Remote	*

*Optional Accessory
* 170 mm length

OPTIONAL ACCESSORIES

EXTENSION RODS:

SDCEXTR60WH - 600mm Extension Rod to suit STANZA DC - White
SDCEXTR90WH - 900mm Extension Rod to suit STANZA DC - White

REMOTE CONTROL

SDCRC - 3 Speed remote to suit STANZA DC

INSTALLATION

1. Ceiling Joist
2. Canopy
3. Terminal Block and Mounting Plate
4. Earth Wire
5. Hanging Ball
6. Downrod
7. Safety tether

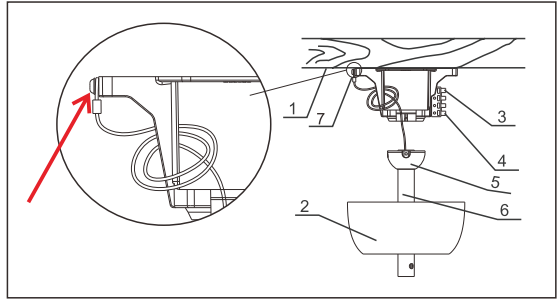

Ensure the fixing tab is securely seated in the groove of the hanging ball.

Minor design changes may result in slight variations between the product illustrated and that which is contained in this package.



INSTALLATION ON A RAKED CEILING

1. Please ensure the groove on the fan hanging ball is securely locked into the fixing tab on the hanging bracket.
2. Ensure the fixing tab is set at the highest point.

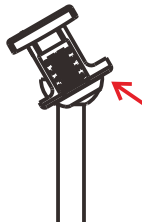
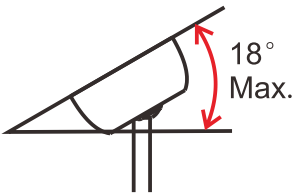

Fixing tab at
Highest point

HOW TO INSTALL THE FAN

1. Remove light diffuser (Turning counterclockwise direction).
2. Attaching blades in hanging position.

NOTE: 'THIS SIDE UP' text on the blades should be facing upwards once the fan is installed.

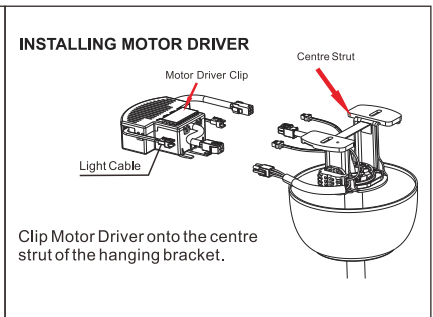
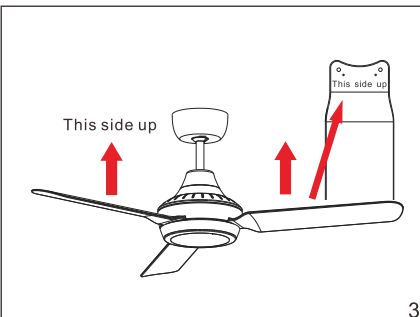
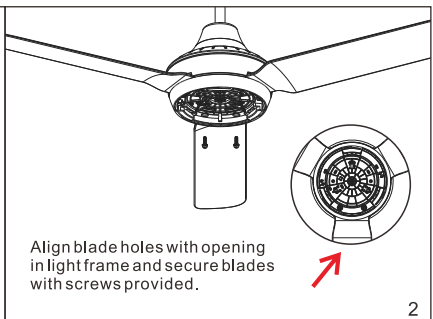
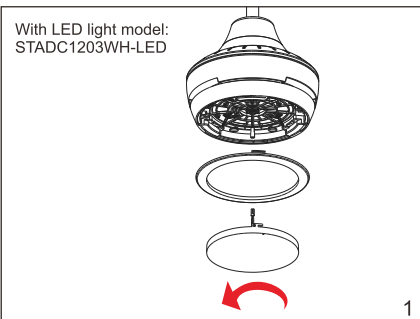
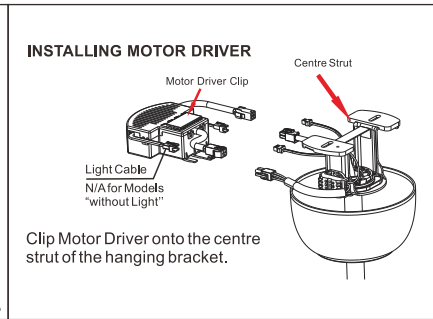
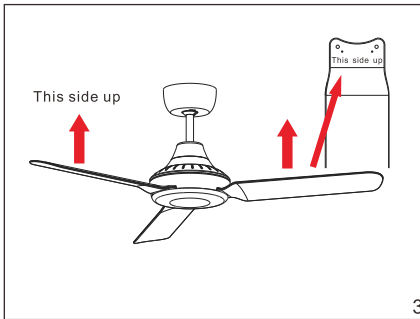
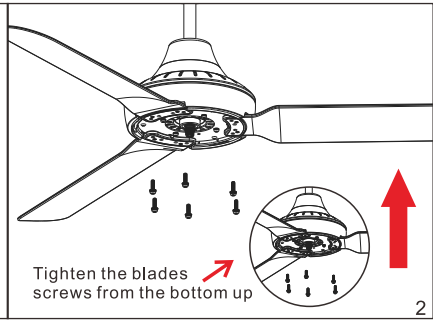
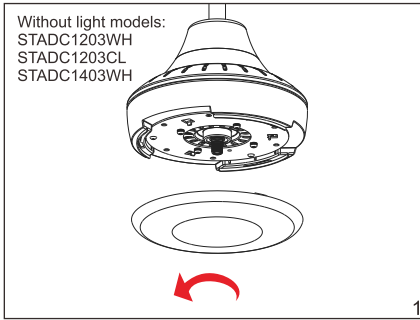

B22 light model:
STADC1203WH-L

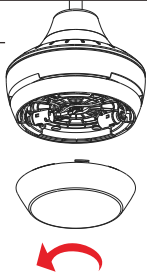

1

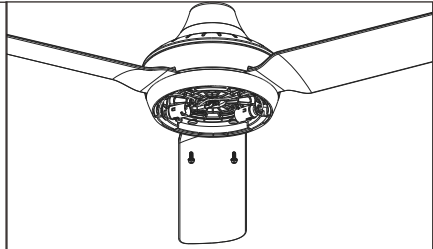

Align blade holes with opening in light frame and secure blades with screws provided.

2

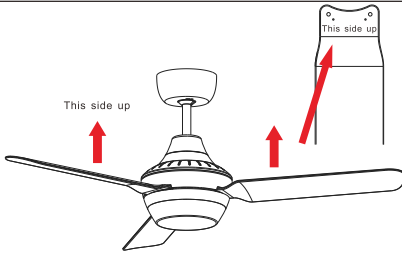

3

INSTALLING MOTOR DRIVER

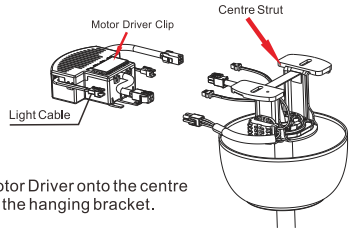

Clip Motor Driver onto the centre strut of the hanging bracket.

Follow the electrical diagram on page 9 for all connections.

Match and firmly connect all motor driver plugs to their sockets, using the labels as a guide.

Note: Motor drivers for fans with lights will have 4 cables, while those for fans without lights will have 2 cables.

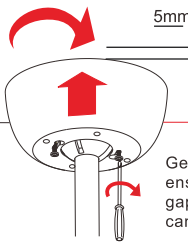
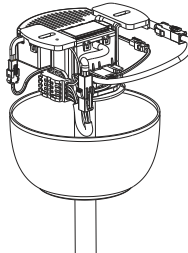

Align the two canopy fixing screws on the hanging bracket with the keyholes in the upper canopy, then twist clockwise to secure.

Gently tighten the screws, ensuring a uniform 5mm (approx.) gap between the ceiling and the canopy.

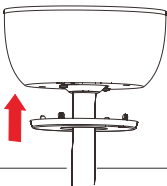

Clip 'decorative screw cover' into place.

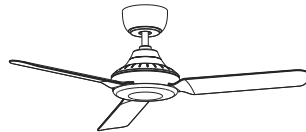

STEP DIMMING INSTRUCTIONS (LED models only)







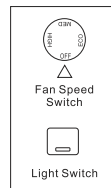





Using the Included Wall Control (4 steps)

1. Flick light switch to 'ON' - Light will be at 100% brightness.
2. With the light on, flick the switch 'OFF' then 'ON' again within 2 seconds, Light will be at 75%.
3. Repeat the same process and the light will continue to dim to 50% then 25% and finally back to 100%.

NOTE: If the light switch remains 'OFF' for more than 2 seconds, the light will operate at its previous setting when next operated.



Using the optional SDCRC Remote Control (not included).

1.  Fan Off (light remains unchanged).
2.  Adjust the fan speed from 1 (lowest) to 6 (highest).
3.  Breeze Mode: Varies the fan speed to create a natural breeze effect.
4.  Light ON/OFF.
5.  Forward / Reverse alters the direction of blade rotation (Summer / Winter).
6.  Adjust light colour (Cool, Natural or Warm). (Not available)
7.   Adjust the light intensity up to maximum brightness.
 Adjust the light intensity down to minimum brightness. (For LED model only)
(Remote Dimming: 9 Levels)
8.    One, four, and eight hour Fan off timer.



Remote Control Pairing:

How to pair the remote control (without wall control):

Step 1: Preparation: Turn the isolation switch 'OFF' for a minimum of 1 minute.

With wall control (SDC3SPWC): Ensure the **fan speed dial** and the **light switch** are set to the "OFF" position for a minimum of 1 minute.

Step 2: Turn the isolation switch or speed dial / light switch on and within 2 seconds, press and hold the fan off () button for 3-4 seconds until you hear a 'beep, beep' sound to indicate pairing succeeded.

Pairing a second remote with your fan:

One fan can be paired with a maximum of two remote controls (two pairing operations). To pair a second remote, follow the above pairing procedure with the new handpiece.

Removing a remote from your fan memory:

To remove one remote when your fan is paired with two, simply re-pair the first remote. This action will overwrite the data for the second remote in the fan's memory, meaning only the first remote will continue to operate the fan.

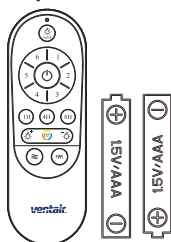

Two AAA batteries supplied.

NOTE: Using high-quality Lithium batteries will extend the time between replacements.

WIRING DIAGRAMS FOR REMOTE & WALL CONTROL COMBINATIONS

WITH LIGHT

Recommended wiring for fans with a light.

Control is managed using only the **SDC3SPWC** wall control or a combination of the **SDCRC** remote control and **SDC3SPWC** wall control.

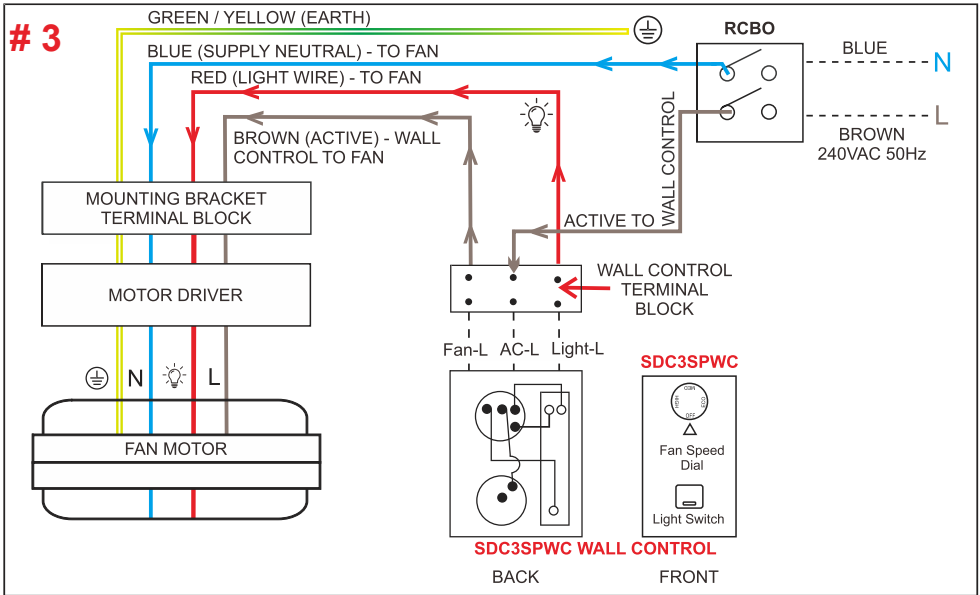

Recommended wiring for fans with a light.

Control is managed solely by the **SDCRC** remote control.

NOTE: With this wiring method, the wall switch cuts power to the fan and light.

When the switch is reactivated, the light will turn on.

The fan will be in standby mode and requires the remote control for activation.

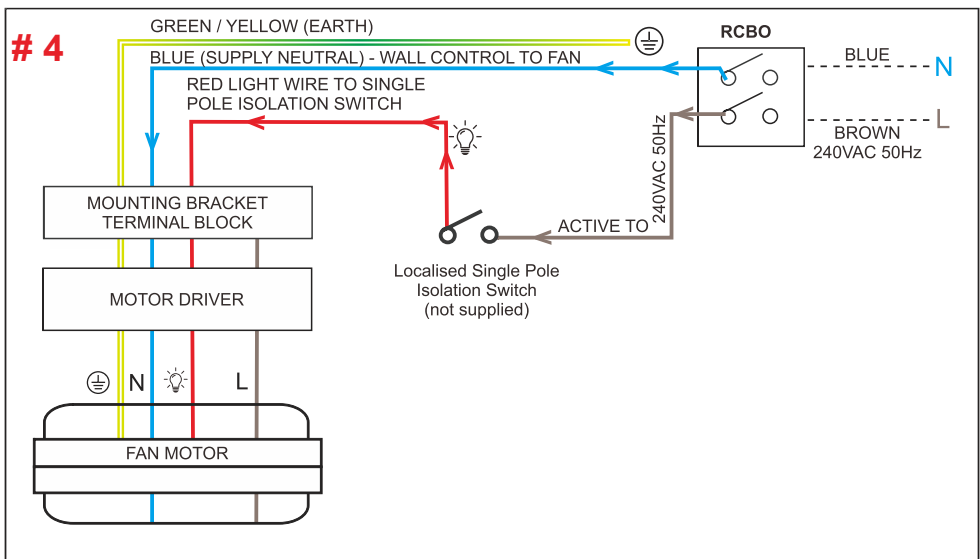

WALL CONTROL WIRING DIAGRAM

WARNING: For your safety, switch off the mains supply at the circuit breaker before undertaking any electrical tasks.

Step A: Connect the EARTH wire to the mounting bracket terminal block marked with the earth symbol '⊕'.

Step B: Connect the LIVE supply wire to the wall control terminal labelled "TO 240V/50HZ".

Step C: Connect a wire from the Fan Live "L" terminal of the hanging bracket to the terminal labelled "FOR FAN-L" on the wall controller.

Step D: Connect a wire from the Light Live "⚡" terminal of the hanging bracket to the terminal labelled "FOR LIGHT-L" on the wall controller.

NOTE: Light wiring only applicable for fan models with integrated light.

Step E: Connect the supply Neutral wire to the terminal port marked "N".

See **Page 12** for instructions on how to connect multiple fans to the one wall control

Using aftermarket wall switches.

To install an aftermarket wall switch, follow the steps below:

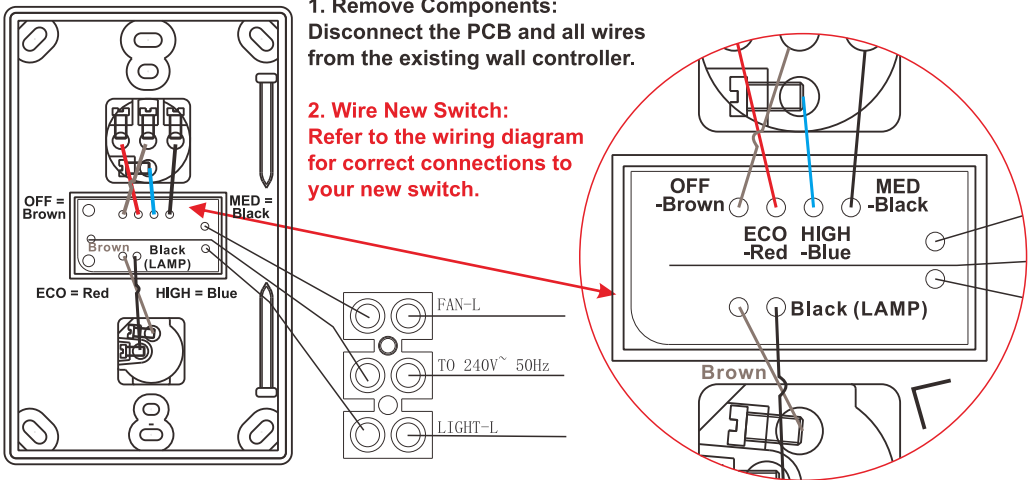

MULTIPLE FANS ON ONE WALL CONTROL

A single wall control or PCB module is capable of operating as many as 10 SONNET DC fans.

The diagram below details the wiring for models with lights; however, you have the flexibility to mix fans with lights and those without.

10 Fans (MAX) connected to a wall single control

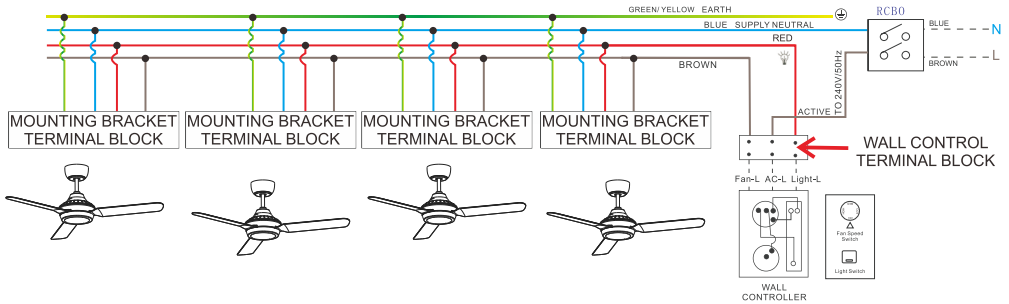

INSTALLATION TIPS:

The fixing point must be capable of supporting four times the net weight of the fan. If mounting to a ceiling junction box, the box and its fixings must support the fan's dynamic (moving) weight and remain rigid without twisting or loosening.

Do not use a solid-state dimmer control.

Do not use the light switch to control the fan motor.

The wall control should fit into existing gang block or wall plate. If you do not flush mount the control, use a standard single gang mounting block.

Be careful not to mix up the supply Active and the fan Active connections. Reversing the speed control connections will prevent the fan from operating correctly.

With the wiring connections finished, please ensure that all wires are organised neatly and the hanging ball is firmly in place within the bracket. This step is vital for minimising fan wobbling.

Once the previous steps are complete, you may restore the mains power. Ensure the area under and around the fan is clear of people, then turn ON the fan (and the light switch, if applicable) to test the operation.

HOW TO OPERATE

To turn the fan on, simply turn the speed dial to the desired speed. To turn off, rotate the knob to the OFF position.

MAINTENANCE

Safety First: Always isolate the power supply to the fan before performing any cleaning or maintenance.

Guards: Always isolate the power supply to the fan before removing any guards or covers.

Cleaning: To clean your fan, don't use harsh solvents like mineral turpentine, white spirit, or petrol. These can damage the fan and are a fire hazard. Instead, simply use a clean, soft cloth dampened with ordinary soap and water, then wipe it dry straight away.

TROUBLESHOOTING

Troubleshooting: Shaking, Vibration, or Noise

Except for an actual manufacturing fault, which is extremely rare, noises and vibrations can often be rectified by checking and adjusting various components. If your fan is experiencing excessive movement, wobbling, or unusual noise, please follow these steps:

- 1. Check all fasteners:** Securely tighten all screws, bolts, and nuts. Ensure the two blade fixing screws on each of the blades are tight, along with any other fasteners on suspended parts.
- 2. For models with a light:** Ensure the light assembly and diffuser are securely tightened; for non-light models, ensure the cover disc is securely attached. See page 4 for parts identification.
- 3. Inspect blades for damage:** Carefully inspect all blades for signs of damage. If any blade is deformed, it must be replaced. For optimal balance, it is recommended to replace all three blades as a complete set.
- 4. Ensure canopy clearance:** Confirm that the fan's canopy isn't touching the ceiling surface.
- 5. Swap blade positions:** To balance the fan, you may need to rotate the blade positions. Move blade 1 to position 2, blade 2 to position 3, and blade 3 to position 1 (see Fig. A).
- 6. Check blade height:** Rotate the fan slowly and measure the distance from the ceiling to each blade tip to check for consistent height. If a blade is too high or low, loosen its screws, adjust the position, and then re-tighten them (Fig. B).
- 7. Obstructions:** Placing a ceiling fan too close to a wall or other fixed obstructions can induce wobble by creating unequal air pressure and aerodynamic turbulence as the blades rotate. To correct this, move the fan to a different position that has greater clearance from walls, beams, cabinets etc...

WARNING: If the fan wobbles excessively or shows any unusual side-to-side movement, immediately stop using it. Contact the manufacturer, their service agent, or a suitably qualified professional straight away.

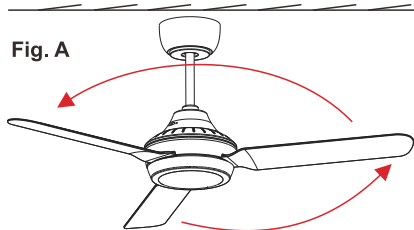

Swap Blade Positions

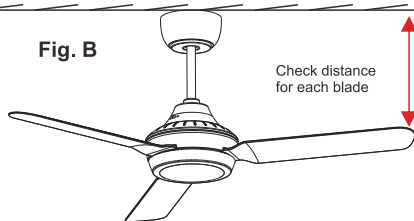

- 8. LIGHT OPERATION:** The light assembly (where fitted) is designed for many years of reliable operation. If the diffuser needs to be removed, exercise extreme care; rotating the entire light assembly will damage the internal wiring, which is not covered under warranty. Please contact the Ventair support team if you require assistance.

For technical assistance please contact Ventair support via email support@ventair.com.au or call 1300 665 926.

If you suspect a manufacturing defect, submit a warranty by visiting www.ventair.com.au/warranty

VENTAIR

4 CAPITAL PLACE,
CARRUM DOWNS, VIC, 3201
PHONE: (03) 9775 0556
support@ventair.com.au
<https://ventair.com.au>

Please do not dispose of this product in your household rubbish. Recycle it responsibly at a designated e-waste collection point to protect the environment. Contact your local council for details.

