

ROBUS®

**HARBOUR EXPRESS 16W/13W/10W/8W LED CORROSION PROOF,
IP66, 2FT, GREY, 3000K/4000K/5700K, DALI DIMMABLE**

RHEX06DD-24

PLEASE READ INSTRUCTION BEFORE COMMENCING INSTALLATION AND RETAIN FOR FUTURE REFERENCES.

! Electrical products can cause death or injury, or damage to property. If in any doubt about the installation or use of this product, consult a competent electrician. Product or a person falling from height can cause serious personal injury. Please ensure suitable equipment is used by a competent person.

Note:

Product technical information and specification may change over time without prior notification. For the latest technical information please visit our web site www.robust.com.au and www.robustled.co.nz

-20°C < Ta < +40°C, 220-240V ~ 50Hz, Class I, IP66

Luminaire is non-dimmable.

Compatible with R3EM2PA-04 emergency pack, (1.5-hour emergency duration) which must be fixed onto the location marked emergency on the inside of fitting.

Installation

1. Ensure mains supply is switched off before commencing work.
2. Select suitable location for luminaire. Safety note! The power supply cable must not be exposed to mechanical damage.
3. Disassemble the fitting base from the fitting.
4. Mark appropriate fixing hole positions on the wall based on the Dimensional distance marked on the back of fitting and check location of buried cables, pipes and other building services before drilling.
5. Insert the wall plugs into the holes after drilling and fix the brackets onto the wall.
6. Assemble the IP gland into the end of fitting and attach the base to the brackets. Feed supply cables through gland and tighten gland.
7. Connect power supply cable to terminal: Live SL– Brown, Neutral –Blue and Yellow/Green - Earth. Permanent Live (PL) as optional (for EM).
8. Select the wattage (16W, 13W, 10W or 8W) using DIP switch on the driver and adjust colour temperature CCT (3000K, 4000K or 5700K) using a switch. Factory default setting: 4000K, 16W. **WARNING: Do not change wattage and cct when the fitting is on and do not shift to other gear that we dont recommend on dip switch otherwise it would damage the fitting and impact on the lifespan.**
9. Attach metal plate/diffuser to base, refit the clips and fasten them with the screws. Ensure it is secure.

Note: This luminaire has no user serviceable parts. If damaged, disconnect from mains and discontinue use.

DALI System:

The output current programming can be realized through the DALI-2 interface.

Push Dimm mode (Figure8)

Short press(<1s) the pushbutton 5 times quickly within 3s, then long press(>1s) the pushbutton 1 time, The driver will automatically switch to the pushDIM dimming mode.

Max. 50 drivers per pushDIM control line.

Turn on or turn off: Short press pushbutton for 0.2-1s.

Dimming: Long press pushbutton for 1-5s.

Multiple lights synchronize control operation

Method 1:

Step 1: Long press the pushbutton, confirm each luminaire is on.

Step 2: Short press the pushbutton, confirm each luminaire is off.

Step 3: Long press the pushbutton, confirm each light is from darkest to brightest and all the luminaires are synchronous.

Method 2:

Long press the pushbutton 15s, all lights output to the brightest state.

The Installation must be carried out by a qualified electrician

LED Group Australia Pty Limited

Suite B, 2 Pittwin Road

Capalaba

Queensland 4157

Australia

Tel: 07 3890 5444

Fax: 07 3890 4777

Email: purchases@robust.com

Website: www.robust.com.au

LED Group

Crowe Hogwarth

72 Trafalgar Street

NELSON 7010

New Zealand

Tel: +64 3668 5285

Email: nz_purchases@robust.com

Website: www.robustled.co.nz



0.77Kg

670mm

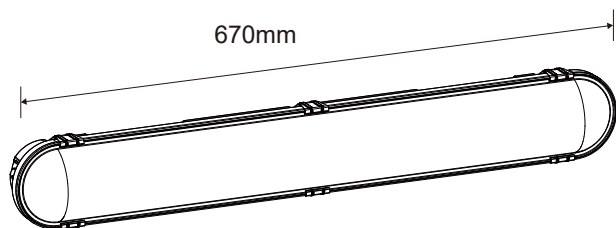

78mm



96mm

1

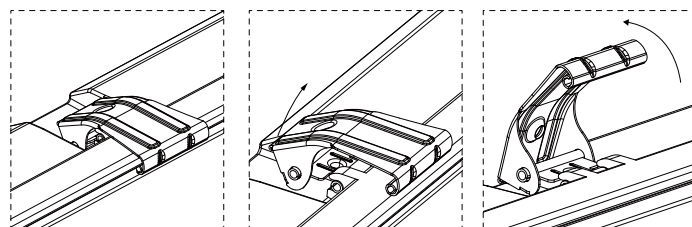

2

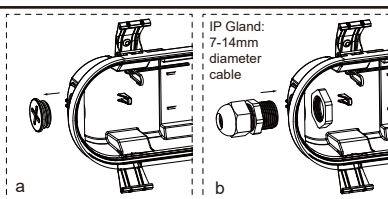
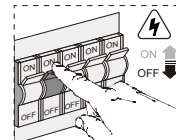
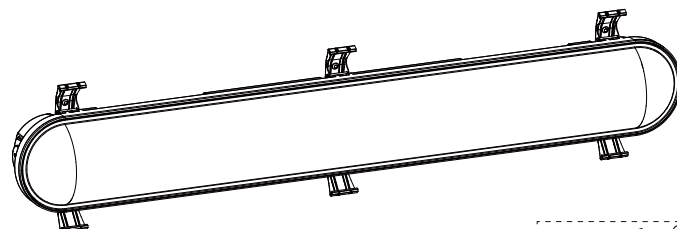

IP Gland:
7-14mm
diameter
cable

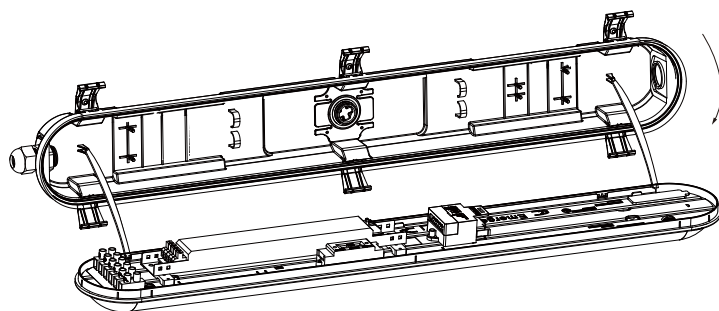

3

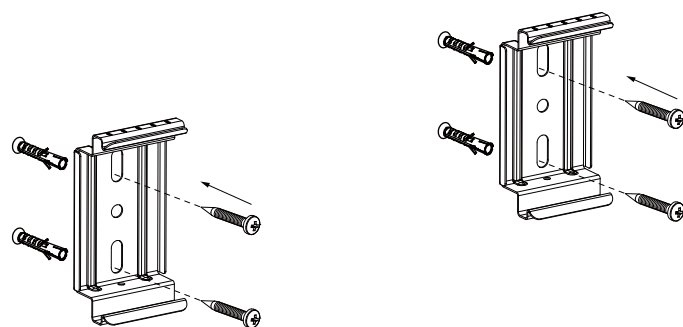

4

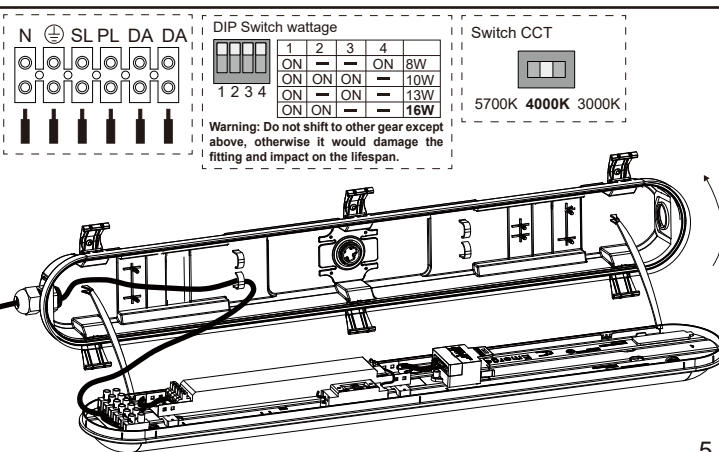
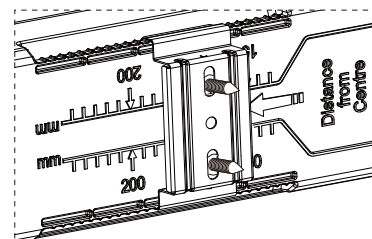

5

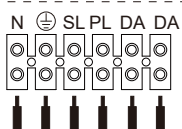

DIP Switch wattage

1	2	3	4	
ON	—	—	ON	8W
ON	ON	—	—	10W
ON	—	ON	—	13W
ON	ON	ON	—	16W

Warning: Do not shift to other gear except above, otherwise it would damage the fitting and impact on the lifespan.

Switch CCT

5700K	4000K	3000K
ON	—	—
ON	ON	—
ON	—	ON
ON	ON	ON

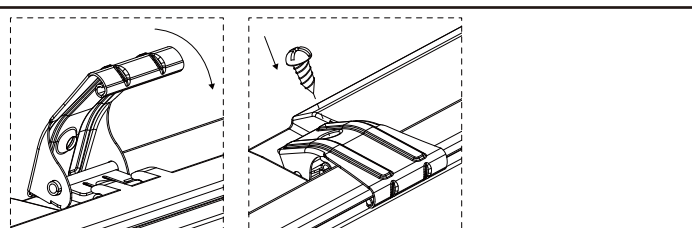

6

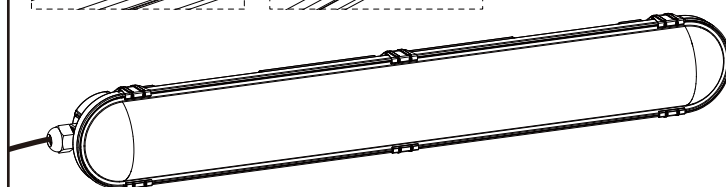

Wiring diagram: DALI System

Harbour express fitting

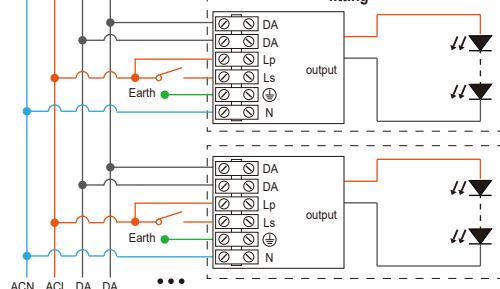

7

Wiring diagram: Push Dimm

Harbour express fitting

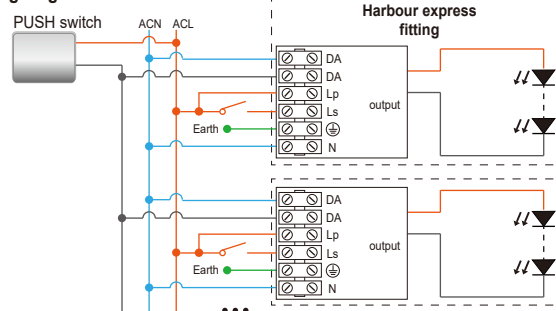

8