

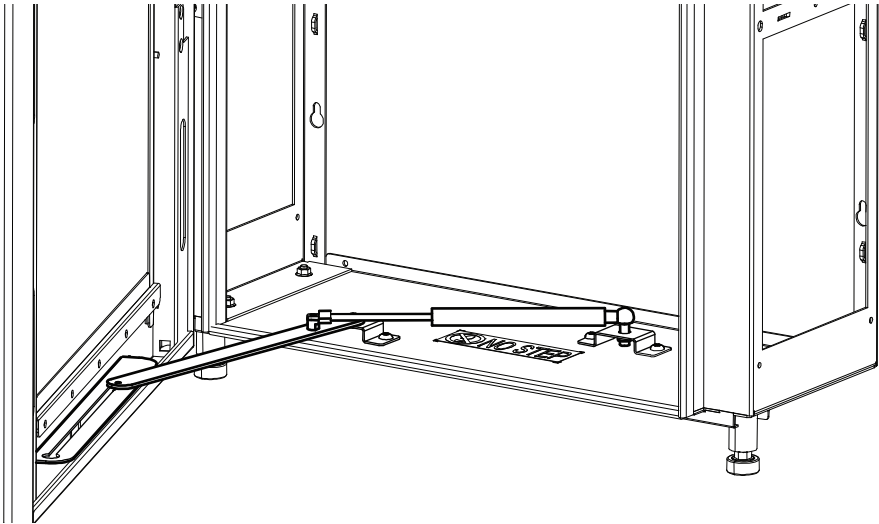

# Emergency Ventilation Kit

EVP1000



## Receiving

### Inspect the Equipment

Carefully inspect the shipment for visible signs of damage. If you detect shipping damage, contact your shipping company immediately and Schneider Electric Customer Support at [www.se.com](http://www.se.com).

### Storage

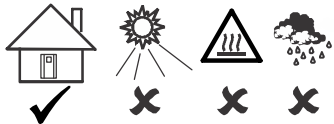

The kit components should be stored indoors and out of the weather. Do not allow the components to be exposed to the elements.

## Unpacking

Each kit contains the parts for the installation of two (2) Emergency Ventilation Kits to two (2) Air Containment Adapter doors. The kits can be installed on a front or rear door.

1. Open and unpack the kit boxes. Use a box cutter (not provided) to open the boxes.
2. Check the contents against the Inventory list on this page.
3. Confirm the contents of the boxes are complete.



Recycle or dispose of the packaging materials appropriately.

## Inventory

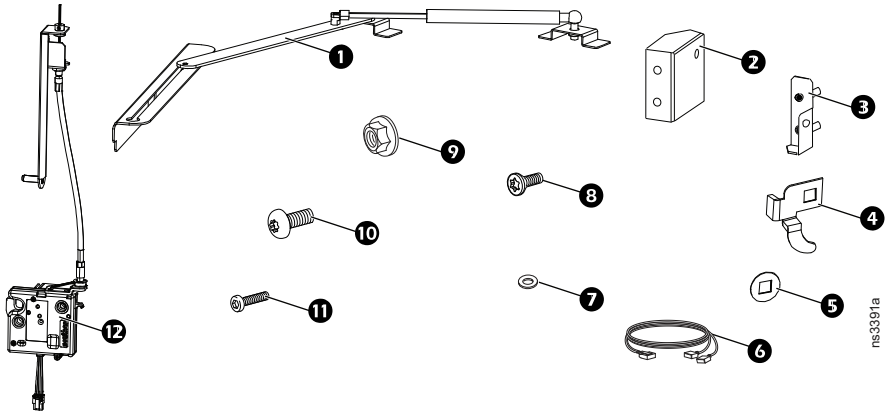

Item	Description	Qty
1	Door opener assembly	2
2	Interior bracket for electronic lock assembly	2
3	Exterior bracket for electronic lock assembly	2
4	Latch cam (electronic lock assembly) for door handle	2
5	Latch cam spacer (electronic lock assembly) for door handle	2
6	Power and signal cable for electronic lock assembly	1
7	Spacer for electronic lock assembly	4
8	M4 x 8 pan head T20 screw	8
9	M6 flanged head hex nut	8
10	M6 x 12 pan head T30 screw	8
11	M5 x 16 hex screw	4
12	Electronic lock assembly	2

## Tools Required (not provided)

T20 and T30 Torx head screwdrivers	Allen wrench	10-mm wrench	Box cutter

## Install the Door Lock Components

Remove the screw and latch cam from the Air Containment adapter door handle.

Save the screw to install the latch cam from the kit.

Install the latch cam and spacer from the kit using the screw saved when the door handle latch cam was removed.

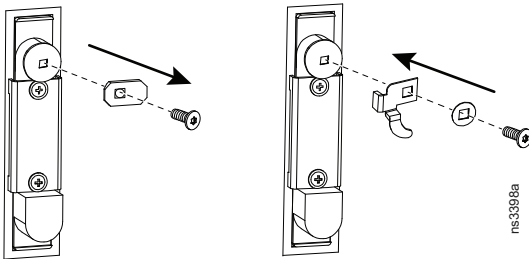

## Install the Door Opener Assembly

### Install the door opener plate to the door

1. Insert the opener plate into the three (3) clips on the bottom of the door.
2. Secure the plate in position behind the clips with four (4) M4 x 8 pan head T20 screws included in the kit. Use a T20 screwdriver (not provided).

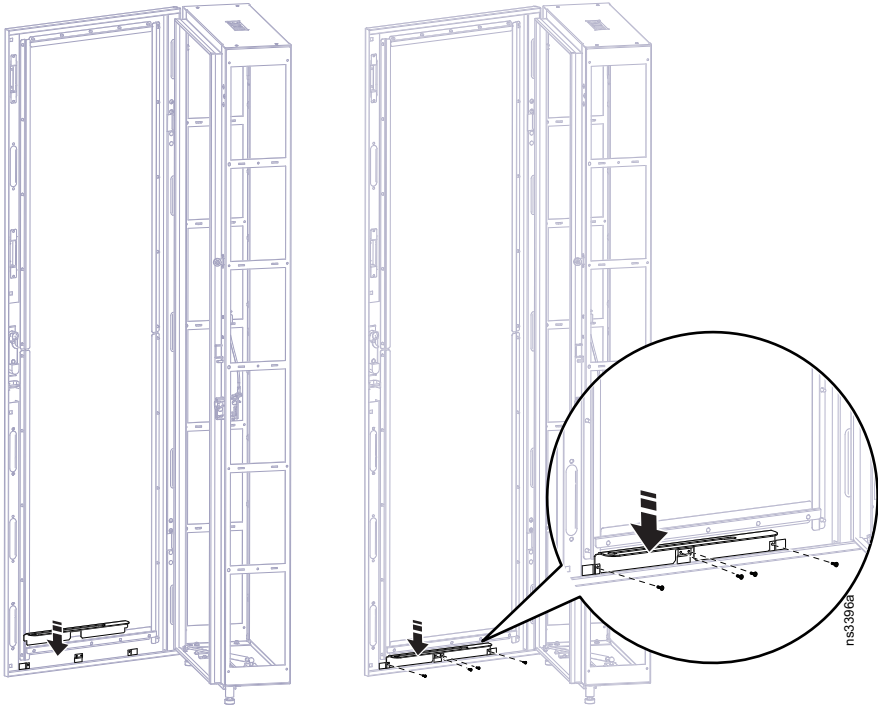

10/2021

990-91506

© 2021 Schneider Electric. All rights reserved.

Customer support and warranty information is available at [www.se.com](http://www.se.com)

Worldwide Customer Support

Install the opener bracket assembly to the floor of the Air Containment frame

1. Remove the four (4) hole plugs from the floor of the Air Containment Adapter frame.
2. Install the opener bracket assembly with four (4) M6 x 12 pan head T30 screws included in the kit. Use a T30 screwdriver (not provided) to tighten the screws.

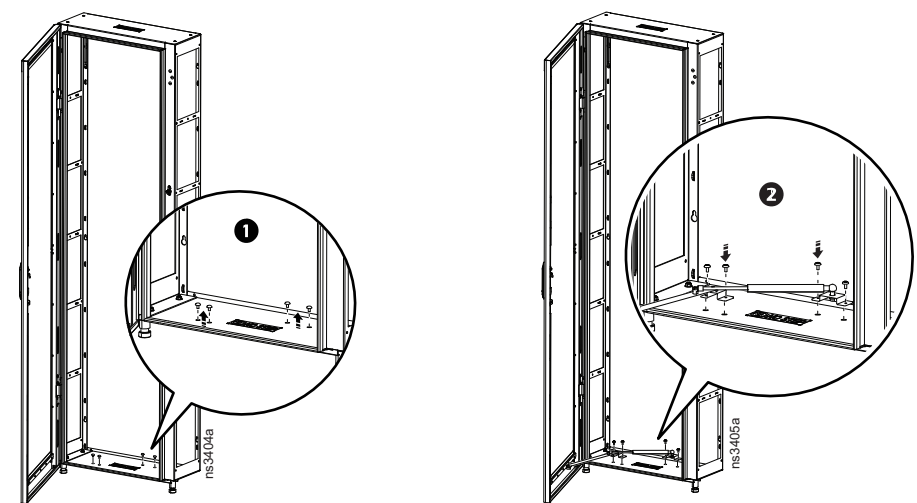

3. Install the pin on the end of the extension arm of the bracket assembly into the large hole in the opener plate on the door.

**NOTE:** The pin will fit through either hole and can accommodate installation or removal of the pin.

4. The pin should slide smoothly in the channel between the large hole and smaller hole in the opener plate.

**NOTE:** The door of the Air Containment adapter has a normal opening range of 130 degrees. With the door opener bracket of the Emergency Ventilation Kit installed, the opening range is 70 degrees. Remove the pin on the extension arm from the door plate to open the door to its full range.

Install the Electronic Locking Assembly

1. Remove the cover plate on the Air Containment Adapter frame.
2. Install the interior and exterior brackets from the kit with two (2) M6 flanged hex nuts from the kit. Use a 10-mm wrench (not provided) to tighten the hex nuts..

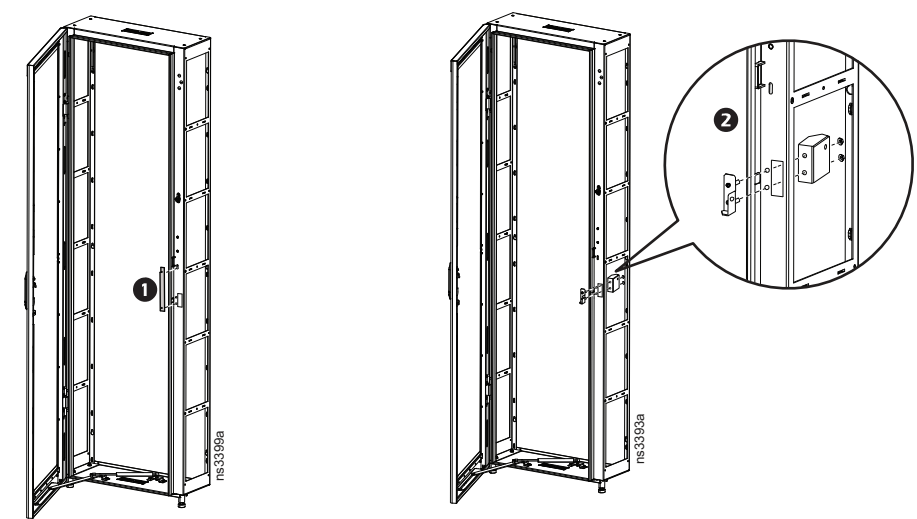

3. Install the body of the electronic locking assembly through the rectangular opening on the frame next to the interior and exterior brackets.

4. Secure the bracket to the frame with the two (2) spacers from the kit to the frame with two (2) M6 flanged hex nuts also from the kit. Use a 10-mm wrench (not provided) to tighten the hex nuts.

5. Remove the hole plug from the Air Containment adapter frame.
6. Secure the body of the electronic lock to the interior bracket and the Air Containment adapter frame with two (2) M5 x 15 hex screws (included) using an Allen wrench (not provided).

Cable Configuration

Make the cable connections as shown in the table.

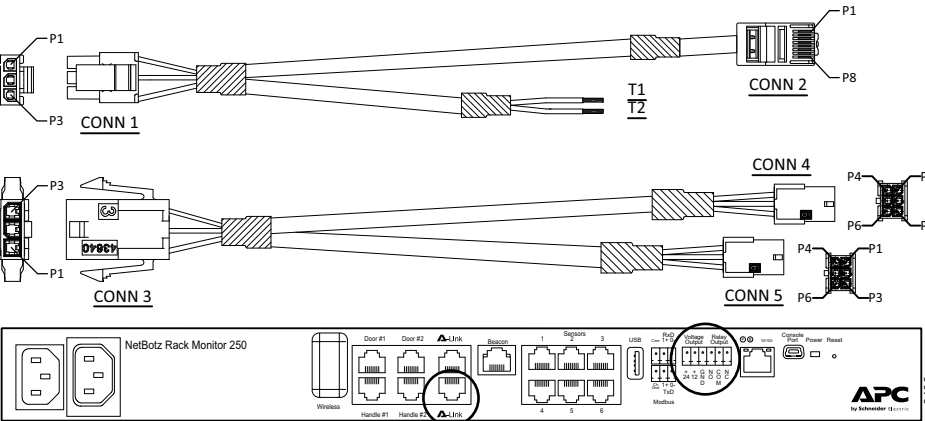

Connector	PIN Definition	Connection
CONN1	P1: GND, P3: 24VDC	Connect to CONN3
CONN3	P1: GND, P3: 24VDC	Connect to CONN1
CONN2	P4, P5: GND; P3, P6: 24 VDC	Connect to the NetBotz A-Link port
CONN4	P1: GND; P2: 24VDC Power; PIN3: 24VDC Control Signal	Connect to the cable on the electronic lock body installed on the rear door.
CONN5	P1: GND; P2: 24VDC Power; PIN3: 24VDC Control Signal	Connect to the cable on the electronic lock body installed on the front door.
T1; T2	T1: GND; T2: 24VDC	Connect to the NetBotz Relay Output port

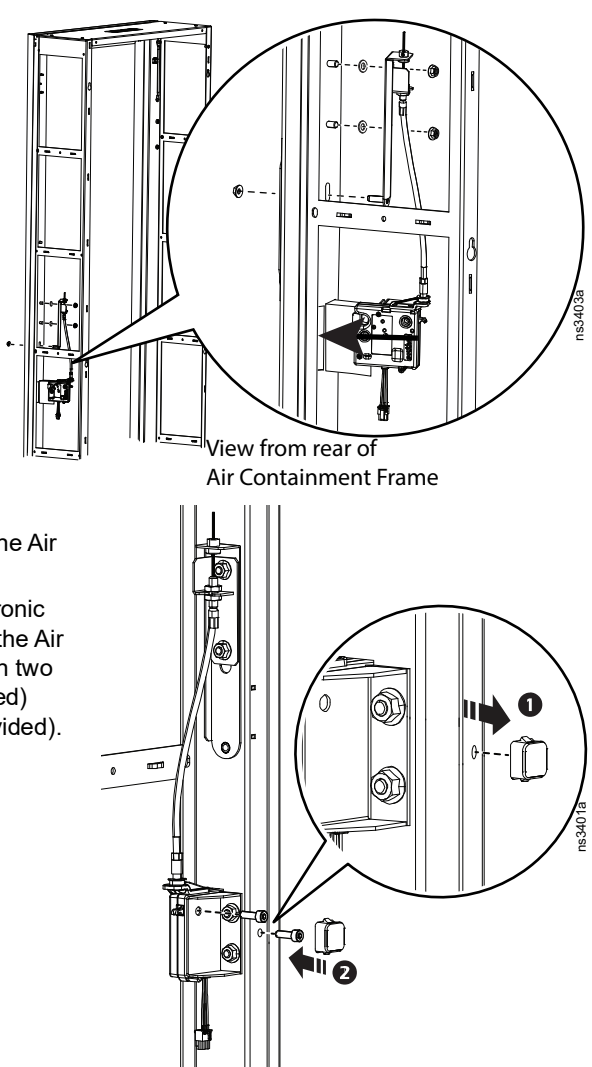

Connect the Cable

1. Connect the cable to the connector at the bottom of the electronic locking assembly body.
2. Connect the other end of the cable to the NetBotz appliance in your Easy Rack.
3. Secure the cable to the frame with zip ties (not provided).

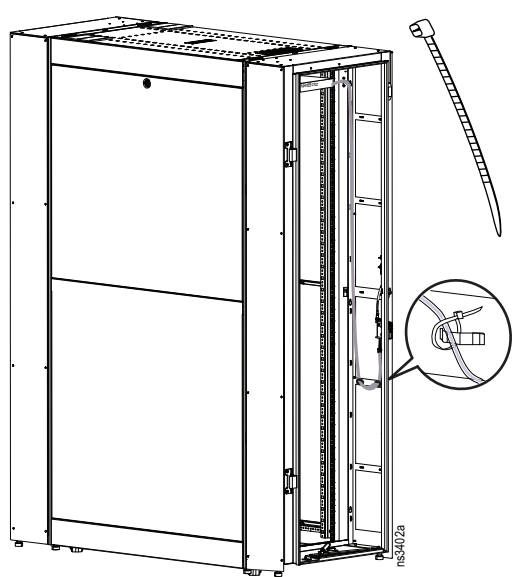

Configure the NetBotz

The cold aisle temperature maximum threshold initiates the Emergency Ventilation system causing the electronic lock to release and allowing the doors to open.

1. Log in to the NetBotz Web UI (see the NetBotz user manual for information).
2. Navigate to the **Configuration > Temperature & Humidity Sensors** page. Select the cold aisle sensor. Set the Maximum Threshold value to 35°C (default) and the High Value to 30°C (default). Click the **Apply** button to save the settings.

