

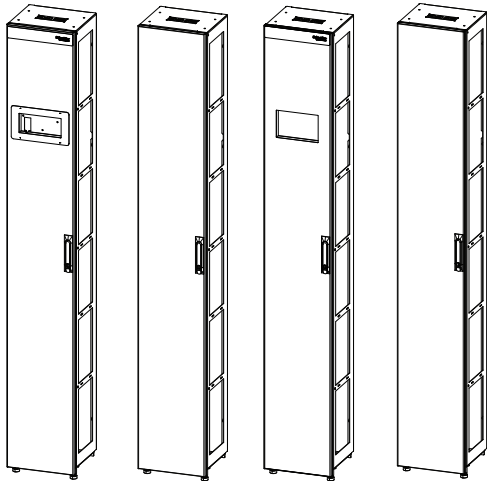

Air Containment Adapter Kits (300mm) Installation

ACCS2004 - ACCS2005 - ACCS2006 - ACCS2007



ACCS2004 and ACCS2005 compatible with ACRD101, ACRD301
ACCS2006 and ACCS2007 compatible with ERC301BD1HPS, ERC301BD1CPS, ERC301BS1CGS



Recycle or dispose of the packaging materials appropriately.

Inventory

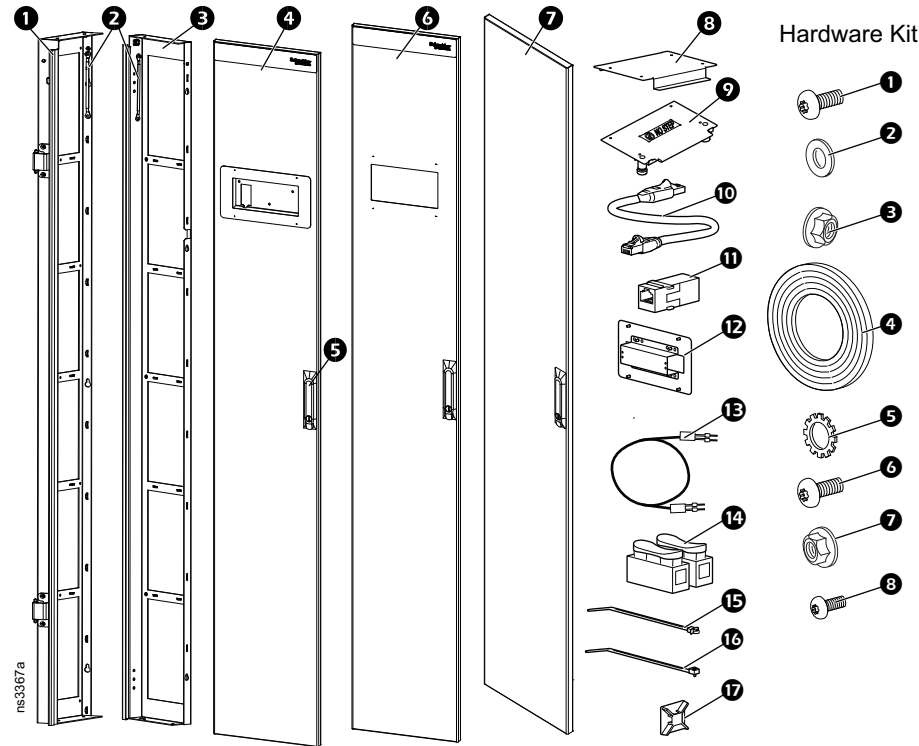

Hardware Kit		
1	Screw M6 x 12 Pan head T30 Nylok	6
2	Washer Nylon ID 6 PD 12	6
3	Hex nut M6 flanged	8
4	Gasket material: EVA foam seal 2.0 x 20 x 2000 (mm)	1
5	Washer M6 serrated	2
6	Screw M6 x 12 Pan head T30	1
7	M5 flanged hex nut	1
8	Screw M5 x10 Pan head T30	8

NOTE: In ACCS2006, item 1 is replaced with five M5 x 10 Phillips head screws. Item 8 is replaced with one M4 flanged hex nut.

Tools Required (not provided)

T25 and T30 Torx head screwdrivers	8-mm, 10-mm, 13-mm wrenches	Scissors	Level

IMPORTANT SAFETY INSTRUCTIONS

⚠ CAUTION
HEAVY EQUIPMENT HAZARD <ul style="list-style-type: none">The kit components are heavy. Use caution when lifting.Wear appropriate personal protective equipment (PPE) and follow safe work practices. Failure to follow these instructions can result in injury or equipment damage.

Receiving

Carefully inspect the shipment for visible signs of damage. If you detect shipping damage, contact your shipping company immediately and Schneider Electric Customer Support at www.se.com.

Storage

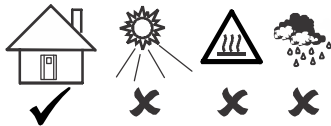

These components should be stored indoors and out of the weather. Do not allow the panels to be exposed to the elements.

NOTICE
<ul style="list-style-type: none">Leaving the kit components uncovered and exposed to the elements will cause damage and void the factory warranty.Wipe the panels with a damp cloth to clean. Do not use solvents or abrasive cleaners.

Item	Description	Qty
1	Adapter side frame with door hinges	1
2	Grounding Wire (one inside adapter door, one on inside rear of hinge side adapter frame)	2
3	Adapter door handle side frame 42U	1
4	Door, ACCS2004	1
5	Door Handle (installed on doors)	2
6	Door, ACCS2006	1
7	Door, ACCS2005 and ACCSS2007	1
8	Adapter top	1
9	Adapter bottom	1
10	Display extension cable (for use with ACRD101, ERC301 series)	1
11	RJ45 connector (for use with ACRD101, ERC301 series, included with ACCS2004 and ACCS2006)	1
12	Display panel adapter (for use with ACRD101, included with ACCS2004)	1
13	Power cable extension (included with ACCS2006)	1
14	Power cable connector (included with ACCS2006)	1
15	Aircraft head cable tie, 4 x 150 mm (included with ACCS2006)	6
16	Cable tie, 3 x 150 mm (included with ACCS2006)	8
17	Cable tie holder (included with ACCS2006)	2

8/2023

990-91538A

© 2021–2023 Schneider Electric. All rights reserved.

Customer support and warranty information is available at www.se.com

Worldwide Customer Support

Prepare the Cooling Unit

Each kit contains the parts for one (front or rear) installation.
Refer to your cooling unit's manual for instructions for the below tasks.

- 1. Disconnect the cable from the display.
- 2. Remove the front and rear doors from the cooling unit.
- 3. Remove the hinges from the cooling unit, if applicable.

NOTE: 1. In existing rows of racks, the joining brackets securing the racks and cooling units together on the front side are not removed.
2. All racks in the row must be level and secured together with the joining brackets (at the front) prior to installing the air containment adapters.

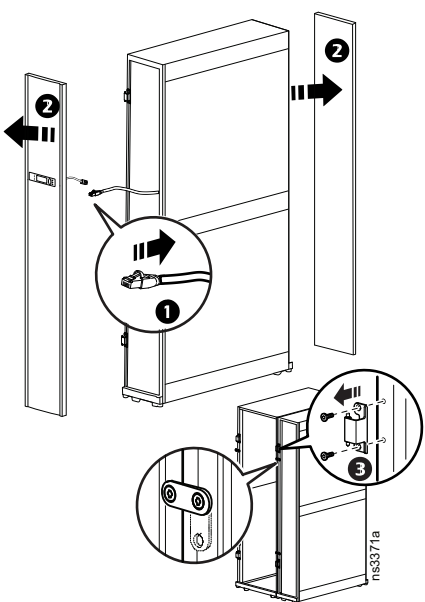

Cooling Unit Display Interface

NOTICE

Remove the display from the cooling unit door. Save the display and its mounting hardware for installation to the adapter door.

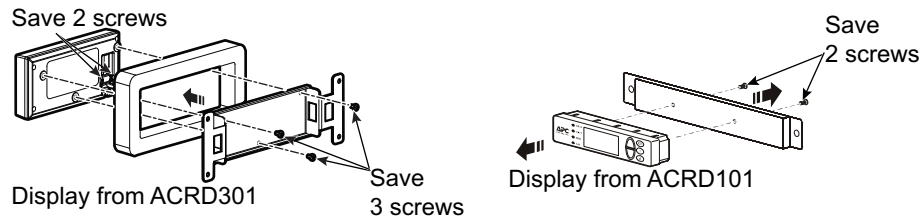

Re-route Cables (ACCS2006 Only)

Remove the cable ties securing the power and network cables to the right side of the cooling unit. Use the provided cable ties and holders to route the power and network cables along the top of the cooling unit and down the left side.

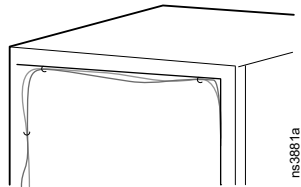

Install Air Containment Kit Mounting Screws

ACCS2004, ACCS2005: Install six M6 x 12 Pan head T30 screws and six nylon washers (provided) to the front or rear of the cooling unit in the holes corresponding to the mounting holes in the Air Containment frame. Install the screws only halfway to leave room to place the Air Containment frame over the screw heads.

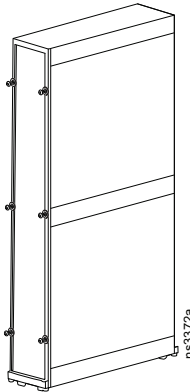

ACCS2006, ACCS2007: Install four M5 x 10 screws and four nylon washers (provided) to the front or rear of the cooling unit in the holes corresponding to the mounting holes in the Air Containment frame. Install the screws only halfway to leave room to place the Air Containment frame over the screw heads.

Assemble the Air Containment Kit

CAUTION

HEAVY EQUIPMENT HAZARD
Some of the components of the Air Containment Kit are heavy. It is recommended that two people lift and move the larger parts.
Failure to follow these instructions can result in injury or equipment damage.

Frame

Insert the four threaded posts on top and bottom parts through the holes at the top and bottom of the left and right frame pieces. Once the top and bottom are set into the side frames, secure them with eight M6 flanged hex nuts using a 10-mm wrench.

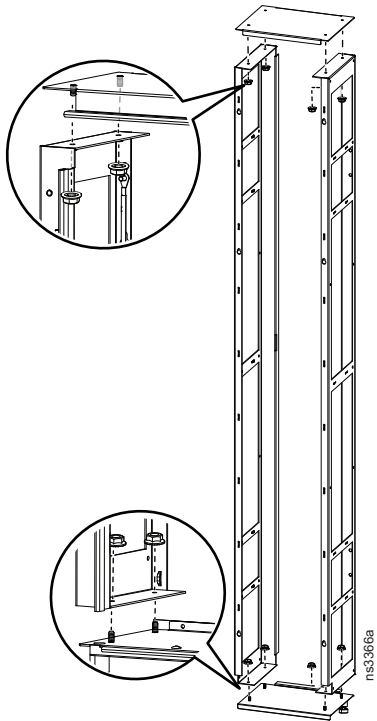

Apply the Gasket Material

- 1. Cut the gasket material to size.
- 2. Peel the backing paper from the gasket, exposing the glue.
- 3. Apply the gasket material to the top and bottom of the frame, pressing to secure the gasket in position.

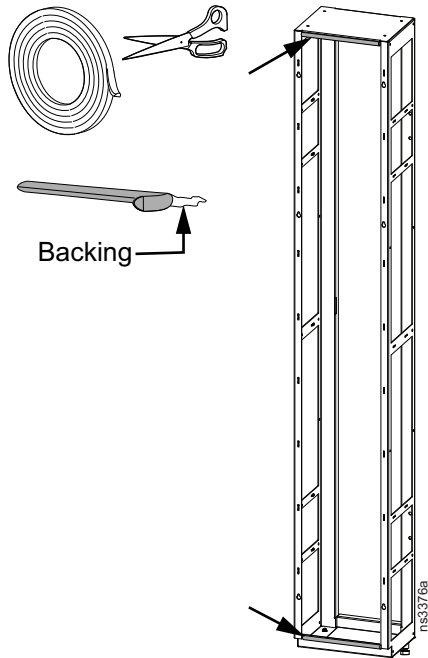

Install the Air Containment Frame

- 1. Hang the Air Containment frame on the screws leaving the washers between the frame and the cooling unit.
- 2. Tighten the screws to secure the air containment frame to the rack. Use a level (not provided) to make sure the frame and cooling unit are level.
- 3. Lower and adjust the leveling feet of the adapter using a 13-mm wrench (not provided). Continue using the level to make sure the frame and cooling unit are level.

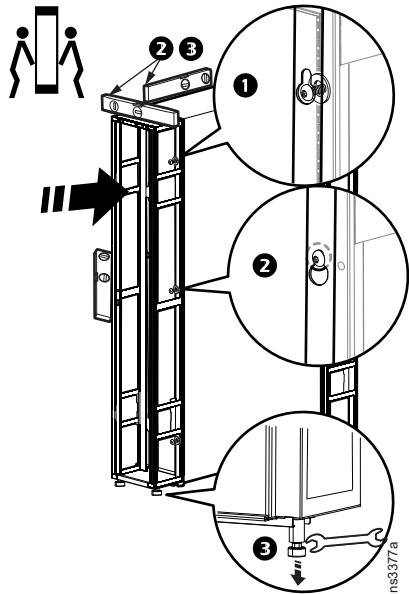

Attach the ground wire on the rear of the Air Containment frame to the rack in the row next to the cooling unit using one M6 serrated washer and one M6 x 12 pan head T30 screw (provided).

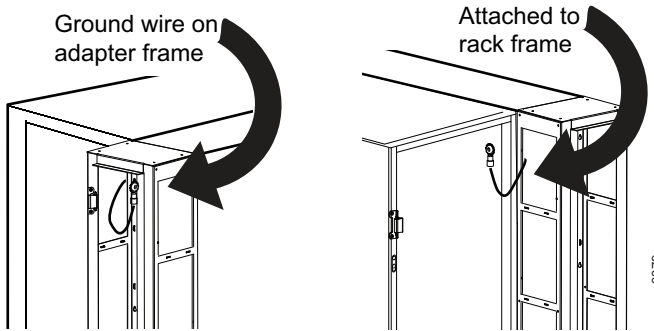

NOTE: There is a ground wire on all Air Containment frames.

Install the Door

- 1. Install the door to the Air Containment frame by lifting the door until the receivers on the door are positioned above the hinge pins on the frame and then lowering the door until the receivers engage the hinge pins.
- 2. Attach the ground wire on the Air Containment frame to the threaded stud on the door using one M6 serrated washer and one M5 flanged nut (provided).

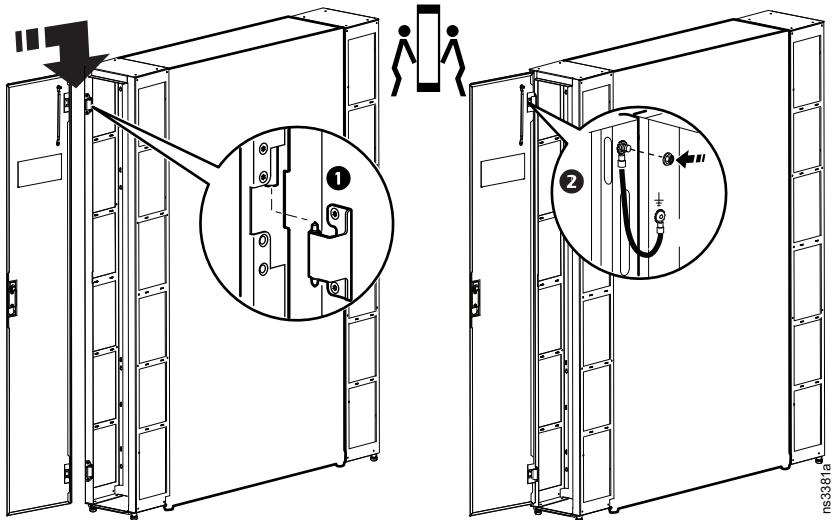

Install the Cooling Unit Display Interface to the Adapter Door

Use the hardware saved when the display was removed from the cooling unit to install the display in the door of the adapter.

Special Instructions to Install ACRD101 Display Interface to ACCS2004

- 1. Remove the display bracket from the door, but retain the four M5 nuts.
- 2. Use the M5 nuts to install the display panel adapter to the door.
- 3. Install the display cable extension and RJ45 connector to the display cable.
- 4. Install the ACRD101 display to the display adapter panel using the saved screws.
- 5. Connect the display cable extension to the display.

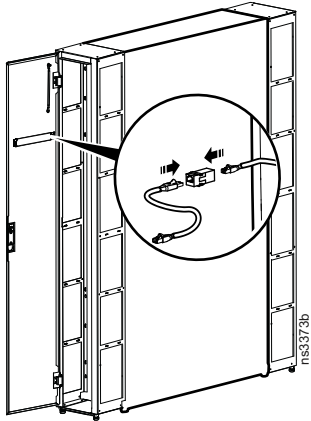

Special Instructions to Install ERC301-series Display Interface to ACCS2006

- 1. Use the hardware saved when the display was removed from the cooling unit to install the display in the door of the adapter.
- 2. If the grounding cable was removed from the display, re-install it. Use the M4 flanged hex nut (provided) to secure the grounding cable of the display to the M4 weld stud on the door (A).
- 3. Use the provided cable connector (C) to connect the power cable extension (D) to the power cable. Connect the power cable extension to the display at the +(24V) and -(GND) connection points on the display.
- 4. Use the provided RJ45 connector (E) to connect the display cable extension (F) to the network cable. Connect the cable extension to the display.

You can use the provided cable ties (B) to secure the cables to the cable management bracket on the door.

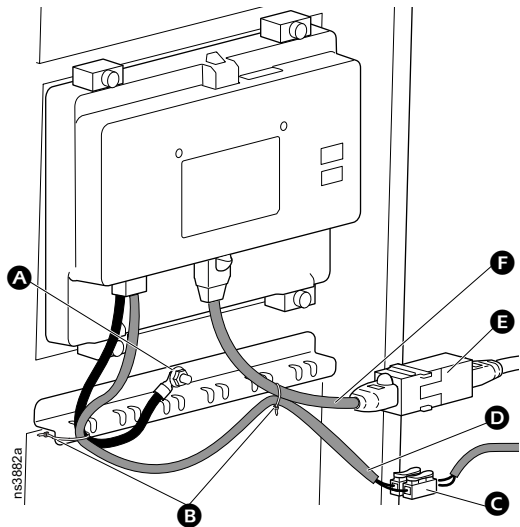

Join the Air Containment Adapters

When multiple Air Containment Kits are installed in a row of racks, the adapter side frames are secured to the next side frame in the row using three M5 x 10 screws.

