

## Product Datasheet

### Panel & Surrounds



- IP20 Enclosure, 0.9mm Galvanised Sheet Body
- All sides cable entry with 24- 75mm diameter knock-outs
- Fitted switch panel
- Internal M6 Earth stud included
- Switch panel tested for water absorption, insulation resistance & 960°C glow wire by TÜV.
- Pre-drilled options are suitable for 1 or 3 phase meters and Test Block

#### Specifications

Category	Meter Panels
IP Rating	IP20
Mounting	Wall Mounted
Cable Entry	All sides
Colour, Body / Housing	Galvanised surround with bakelite panel
Compliance	NSW Service Installation Rules AS/NZS 61439.1 & 2

Part No.	Description
PS300	PANEL SURROUND 300X300X100 BLANK SWITCH PANEL
PS400	PANEL SURROUND 400X400X100 BLANK SWITCH PANEL
PS450	PANEL SURROUND 450X450X100 BLANK SWITCH PANEL
PS450.150	PANEL SURROUND 450X450X150 BLANK SWITCH PANEL
PS100	PANEL SURROUND 600X600X100 BLANK SWITCH PANEL
PS100D	PANEL SURROUND 600X600X100 <u>DRILLED</u> SWITCH PANEL
PS150	PANEL SURROUND 600X600X150 BLANK SWITCH PANEL
PS150D	PANEL SURROUND 600X600X150 <u>DRILLED</u> SWITCH PANEL
PS900	PANEL SURROUND 900X900X100 BLANK SWITCH PANEL

# Product Datasheet

## Panel & Surrounds



TOP VIEW

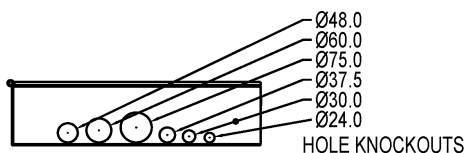

BOTTOM VIEW

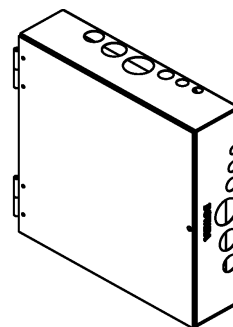

ISOMETRIC VIEW  
(DOORS ON)

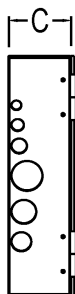

LHS VIEW  
(DOORS ON)

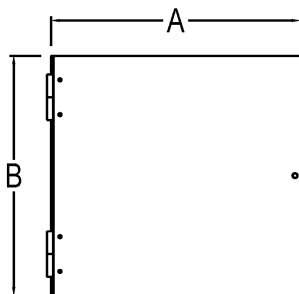

FRONT VIEW  
(DOORS ON)

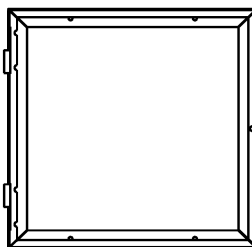

FRONT VIEW  
(DOORS OMITTED)



RHS VIEW  
(DOORS ON)

Part No.	A (width)	B (height)	C (depth)
PS300	300	300	100
PS400	400	400	100
PS450	450	450	100
PS450.150	450	450	150
PS100	600	600	100
① PS100D	600	600	100
PS150	600	600	150
① PS150D	600	600	150
PS900	900	900	100

**\*\*Dimensions in (mm)**

① Switch panel is pre-drilled, suitable for single / 3 phase meters and test block (CT.TB)