

Electrical bracket vertical and horizontal mounting 153x 6 mm

Caracteristics

Thickness (mm) : 1
 Mount Type : **Horizontal and vertical**
 Length (mm) : 154
 Width (mm) : 92
 Depth (mm) : 40

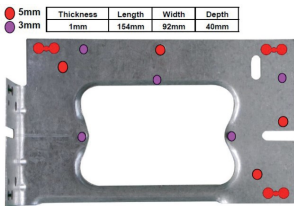
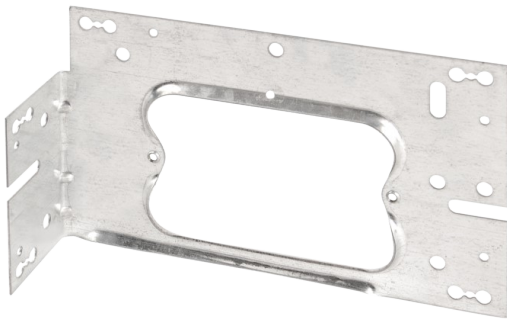

GENERAL INFORMATION

Technical details

Material: pre-galvanized steel.

Application(s)

Used to support electrical metal boxes into metal or wood.

ADDITIONAL INFORMATION

BIZ 500 901 :
 Length : 135 mm.
 Width : 73 mm.
 Depth : 38 mm.
 Thickness : 1 mm.

BIZ 500 902 :
 Length : 135 mm.
 Width : 73 mm.
 Depth : 38 mm.
 Thickness : 1 mm.
 BIZ 500 903 :
 Length : 127 mm.
 Width : 74 mm.
 Depth : 23 mm.
 Thickness : 1.2mm.

BIZ 500 904 :
 Length : 98 mm.
 Width : 117 mm.
 Depth : 19 mm.
 Thickness : 1.2 mm.
 BIZ 500 906 :
 Length : 154 mm.
 Width : 92 mm.
 Depth : 40 mm.
 Thickness : 1.2 mm

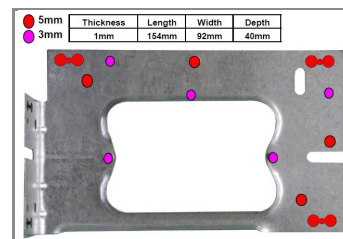
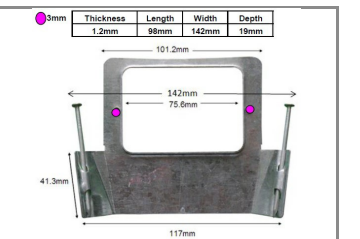
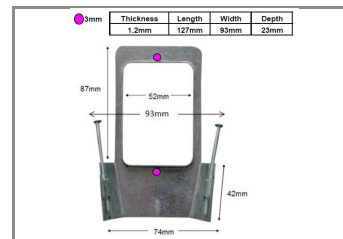
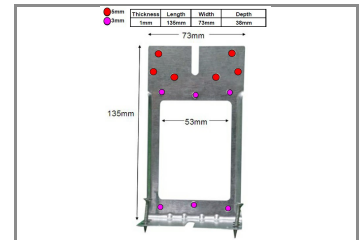
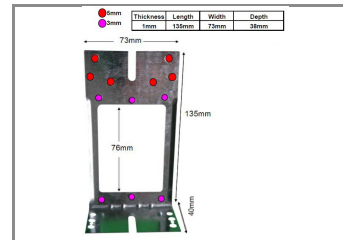

LOGISTIC INFORMATION

Packaging



Carton box

Height (cm) : 7.5
 Length (cm) : 16.6
 Depth (cm) : 8.6
 Net weight (kg) : 1.74
 Gross weight (kg) : 1.79



Outer package 1



x 10

Carton box

Height (cm) : 9.5
 Length (cm) : 45
 Depth (cm) : 35
 Net weight (kg) : 17.9
 Gross weight (kg) : 18.4



Outer package 2



x 500

Pallet

Height (cm) : 115
 Length (cm) : 120
 Depth (cm) : 80
 Net weight (kg) : 920
 Gross weight (kg) : 926

