



## xPole eRBXH Compact RCBO

Expand your possibilities with Eaton's compact 18mm RCBO. At the same physical size as a standard single pole MCB, the eRBXH RCBO is designed for small assemblies and big savings!

The new RCBO is a single pole plus switched neutral device where the line/load can be connected from top or bottom. Having no restriction to the connection of supply enhances the safety of your installation and the compact single pole size allows more poles to fit into assemblies offering a cost effective solution.

### Features at a glance

- Fully conforms to AS/NZS 61009-1
- Compliant to Energy Safe Victoria – Additional Testing Requirements for RCBOs.
- Suits Eaton XH series busbar for easy installation
- Rated current up to 40A
- Type AC and Type A sensitivity devices available
- Approval number: NSW28377

### Specifications

Electrical	
Design according to	IEC61009-1 AS/NZS61009-1
Number of poles	1P+N Active and neutral poles switched
Rated current $I_n$ :	6 – 40A
Rated voltage $U_n$	230/240 Vac
Rated frequency	50/60 Hz
Voltage range for protective function	50 - 253V
Rated short circuit capacity	6kA
Rated residual making/breaking capacity	3kA
Tripping characteristic	C
Rated tripping current $I_{\Delta n}$	250A (8/20us)
Rated tripping current $I_{\Delta no}$	10, 30mA
Residual current sensitivity	AC, A
Rated non-tripping current $I_{\Delta no}$	0.5 $I_{\Delta no}$
Rated Insulation voltage	500V
Dielectric strength	2.5kV
Selectivity class	3
Operating temperature	-5 to 40°C
Endurance	Electrical comp. >10,000 operating cycles Mechanical comp. >30,000 operating cycles
Mechanical	
Mounting	3-Position DIN rail clip, permits removal from existing busbar system
Load terminals	Open mouthed/lift terminals
Line terminals	Open mouthed/lift terminals
Terminal protection	Finger and hand touch safe
Terminal capacity	1 - 16 mm <sup>2</sup>
Terminal screw torque	1.2Nm
Degree of protection, switch	IP20
Degree of protection, built-in	IP40
Resistance to climatic conditions	acc. To IEC/EN 61009



Powering Business Worldwide

Description Sensitivity Type AC	Rating (A)	Sensitivity (mA)	Material no	Item no.	Units per package
eRBXH RCBO 6A 1P+N 6kA 30mA C-curve	6	30	CBE02437	eRBXH-6/1N/C/003	1/10
eRBXH RCBO 10A 1P+N 6kA 30mA C-curve	10	30	CBE02438	eRBXH-10/1N/C/003	1/10
eRBXH RCBO 16A 1P+N 6kA 30mA C-curve	16	30	CBE02439	eRBXH-16/1N/C/003	1/10
eRBXH RCBO 20A 1P+N 6kA 30mA C-curve	20	30	CBE02440	eRBXH-20/1N/C/003	1/10
eRBXH RCBO 25A 1P+N 6kA 30mA C-curve	25	30	CBE02441	eRBXH-25/1N/C/003	1/10
eRBXH RCBO 32A 1P+N 6kA 30mA C-curve	32	30	CBE02442	eRBXH-32/1N/C/003	1/10
eRBXH RCBO 40A 1P+N 6kA 30mA C-curve	40	30	CBE02443	eRBXH-40/1N/C/003	1/10
eRBXH RCBO 6A 1P+N 6kA 10mA C-curve	6	10	CBE02444	eRBXH-6/1N/C/001	1/10
eRBXH RCBO 10A 1P+N 6kA 10mA C-curve	10	10	CBE02445	eRBXH-10/1N/C/001	1/10
eRBXH RCBO 16A 1P+N 6kA 10mA C-curve	16	10	CBE02446	eRBXH-16/1N/C/001	1/10
eRBXH RCBO 20A 1P+N 6kA 10mA C-curve	20	10	CBE02447	eRBXH-20/1N/C/001	1/10
eRBXH RCBO 25A 1P+N 6kA 10mA C-curve	25	10	CBE02448	eRBXH-25/1N/C/001	1/10
eRBXH RCBO 32A 1P+N 6kA 10mA C-curve	32	10	CBE02449	eRBXH-32/1N/C/001	1/10
eRBXH RCBO 40A 1P+N 6kA 10mA C-curve	40	10	CBE02450	eRBXH-40/1N/C/001	1/10

Description Sensitivity Type A	Rating (A)	Sensitivity (mA)	Material no	Item no.	Units per package
eRBXH RCBO 6A 1P+N 6kA 30mA C-curve	6	30	CBE02451	eRBXH-6/1N/C/003-A	1/10
eRBXH RCBO 10A 1P+N 6kA 30mA C-curve	10	30	CBE02452	eRBXH-10/1N/C/003-A	1/10
eRBXH RCBO 16A 1P+N 6kA 30mA C-curve	16	30	CBE02453	eRBXH-16/1N/C/003-A	1/10
eRBXH RCBO 20A 1P+N 6kA 30mA C-curve	20	30	CBE02454	eRBXH-20/1N/C/003-A	1/10
eRBXH RCBO 25A 1P+N 6kA 30mA C-curve	25	30	CBE02455	eRBXH-25/1N/C/003-A	1/10
eRBXH RCBO 32A 1P+N 6kA 30mA C-curve	32	30	CBE02456	eRBXH-32/1N/C/003-A	1/10
eRBXH RCBO 40A 1P+N 6kA 30mA C-curve	40	30	CBE02457	eRBXH-40/1N/C/003-A	1/10
eRBXH RCBO 6A 1P+N 6kA 10mA C-curve	6	10	CBE02458	eRBXH-6/1N/C/001-A	1/10
eRBXH RCBO 10A 1P+N 6kA 10mA C-curve	10	10	CBE02459	eRBXH-10/1N/C/001-A	1/10
eRBXH RCBO 16A 1P+N 6kA 10mA C-curve	16	10	CBE02460	eRBXH-16/1N/C/001-A	1/10
eRBXH RCBO 20A 1P+N 6kA 10mA C-curve	20	10	CBE02461	eRBXH-20/1N/C/001-A	1/10
eRBXH RCBO 25A 1P+N 6kA 10mA C-curve	25	10	CBE02462	eRBXH-25/1N/C/001-A	1/10
eRBXH RCBO 32A 1P+N 6kA 10mA C-curve	32	10	CBE02463	eRBXH-32/1N/C/001-A	1/10
eRBXH RCBO 40A 1P+N 6kA 10mA C-curve	40	10	CBE02464	eRBXH-40/1N/C/001-A	1/10



## Dimensions

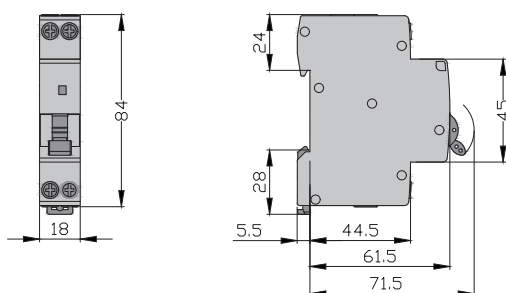

## Connection diagram

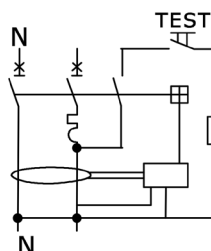

Powering Business Worldwide

Eaton  
Experience and Technology Centre  
10 Kent Road  
Mascot NSW 2020  
Tel: 1300 332 866

Email: [australiasales@eaton.com](mailto:australiasales@eaton.com)  
[www.eaton.com](http://www.eaton.com)  
December 2020