

CLP501401  
PDL501401

Wiser™

Detailed production information is available online in the system user guide: Scan the QR code for your region.

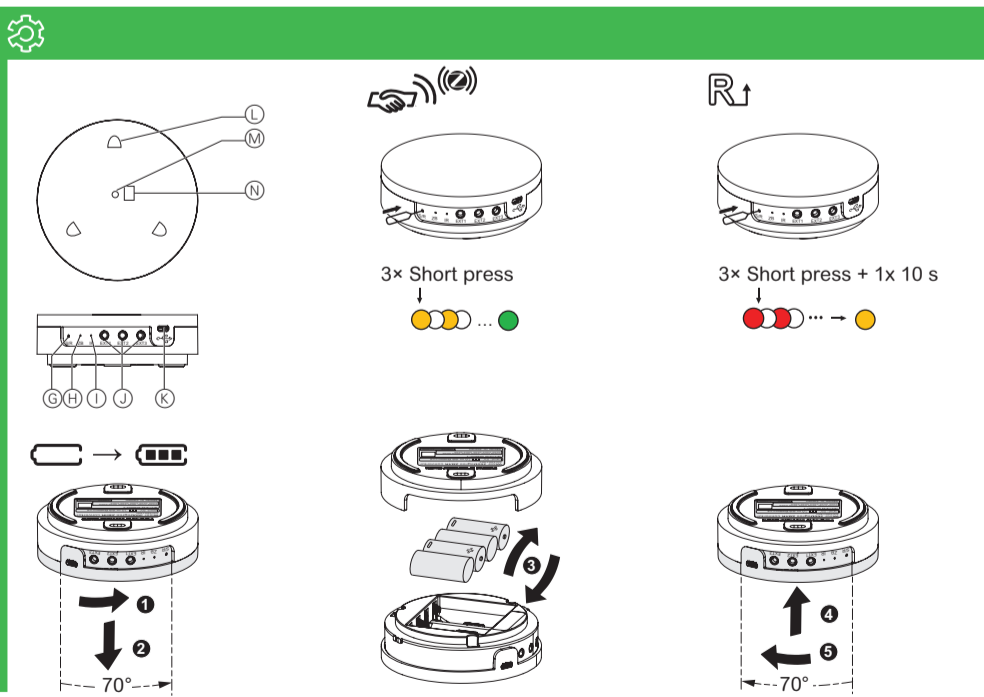
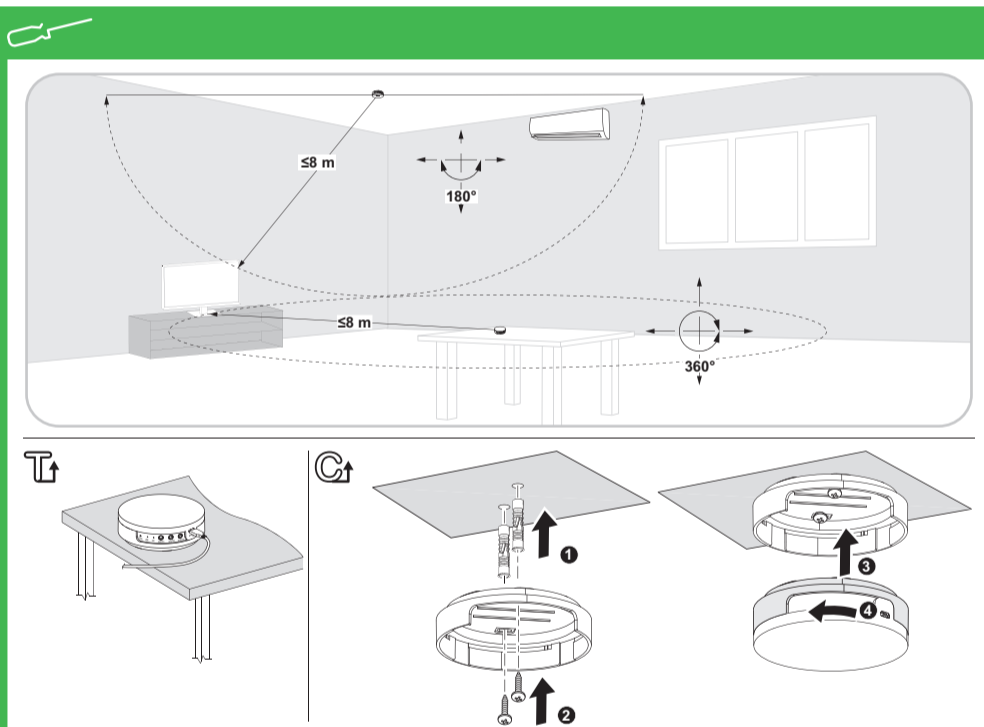
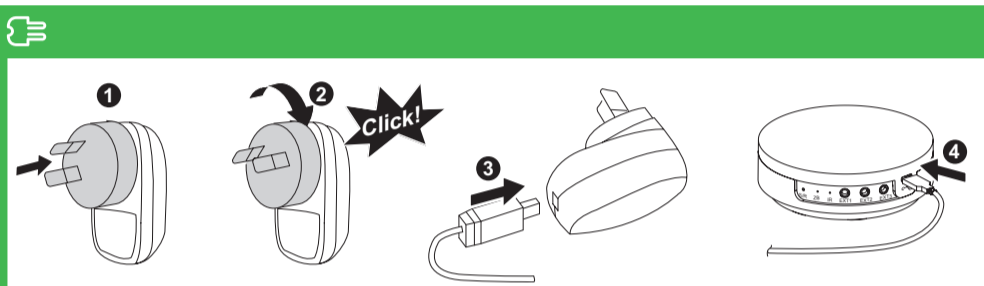
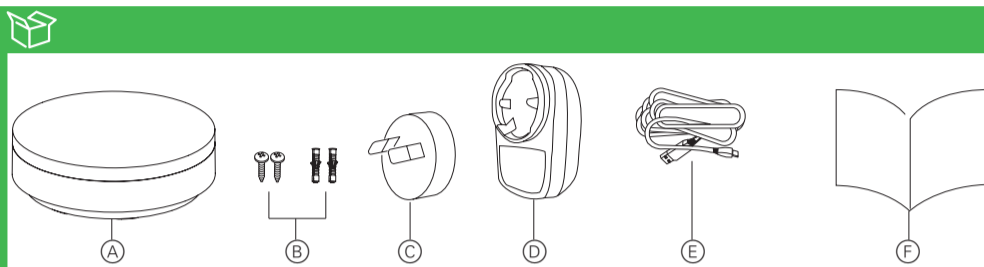

## Wiser IR Converter

### Prerequisites

Download the **Wiser by SE App** to your smartphone and install the **Wiser Gateway/Hub** (hereinafter referred to as Wiser Hub) to configure and control Wiser devices.

### For your safety

#### ⚠️ DANGER

#### HAZARD OF ELECTRIC SHOCK, EXPLOSION, OR ARC FLASH

- It is illegal for persons other than an appropriately licensed electrical contractors or other persons authorised by legislation to work on the fixed wiring of any electrical installation.
- To comply with all safety standards, the product must be used only for the purpose described in this instruction and must be installed in accordance with the wiring rules and regulation in the location where it is installed.
- Lock out and tag the input circuit before accessing the wiring connections.
- There are no user serviceable parts inside the product.

**Failure to follow these instructions will result in death or serious injury.**

### Getting to know the product

The Wiser IR Converter (the device) is a control device to automate your home IR controlled devices such as televisions, air conditioners, music systems and so on. The device converts mesh network signal to infrared signal.

#### Key features

- 360° IR signal coverage
- 3 sockets for IR extension cables
- Supports up to 8 types of IR controlled devices

**i** Some IR controlled devices may not be supported in your country. Please check with your sales representative.

### Package contents

- A Wiser IR Converter
- B Screws: 2 × ST4.2 × 25 mm with wall plugs
- C 2-pin plug
- D AC adaptor
- E AC adaptor USB cable
- F Installation instructions

### Mounting the device

#### Installing the AC adaptor

#### ⚠️ DANGER

#### RISK OF ELECTRIC SHOCK, EXPLOSION OR ARC FLASH

Make sure that the 2-pin plug is inserted in the correct position and rotated clockwise 90° until the plug firmly locks onto the AC adaptor with a 'click' sound.

**Failure to follow these instructions will result in death or serious injury.**

#### Choosing the installation location

The device can be installed on:

- Table
- Ceiling

#### Connecting the device

**i** To power the device, use either the supplied AC adaptor or 4× AA batteries.

#### Recommended power supply for different mounting options:

**Device mounted on the table:** use either the supplied AC adaptor or batteries.

**Device mounted on the ceiling:** use the batteries.

### NOTICE

#### PERFORMANCE DEGRADATION OR EQUIPMENT DAMAGE

- The device should be powered only by the provided AC adaptor or 4× AA batteries.
- Only alkaline batteries should be used. Do not use rechargeable batteries.

**Failure to follow these instructions can result in equipment damage.**

#### Using the IR extension cable

The device supports IR extension cables (3 sockets). When the Wiser IR Converter is installed in a closed cabinet, use up to 3 IR extension cables to route the infrared signals to the IR-controlled devices.

**i** It is recommended to use Schneider Electric 8050LD or 8050/2LD IR extension cables. Other brands of IR extension cable with a 3.5 mm mono mini plug can also be used. However, the performance cannot be guaranteed.

### NOTICE

#### EQUIPMENT DAMAGE

- Use 3.5 mm mono mini plug.
  - Do not use other types of plug with a different size.
- Failure to follow these instructions can result in equipment damage.**

### Operating elements

- G Set/Reset button
- H Network status LED
- I IR LED
- J 3× 3.5 mm phone jacks for IR extension cables
- K Micro USB port for 5 VDC power supply

- L 3× IR emitters under plastic cover, edge emitting
- M IR emitter under plastic cover, top emitting
- N IR receiver under plastic cover, top receiving

### Setting the device

#### Connecting to the Wiser Hub

Short press the Set/Reset button 3 times with a time interval of <1 s to connect to the mesh network.

For more info, refer to the System user guide.

#### Resetting the device

Short press the Set/Reset button 3 times with a time interval of >10 s and then long press the Set/Reset button once for >10 s to reset the device to factory default mode.

Upon successful reset, all configuration data, user data, and network data are deleted.

#### Replacing the batteries

### Operating the device

#### Prerequisites

The Wiser Hub must be properly installed and powered on.

#### Configuring the device

The device can be configured and controlled by the Wiser by SE App.

For detailed configuration procedures, refer to the system user guide.

### Behaviour of the LEDs

Refer to the system user guide.

### Troubleshooting

Refer to the system user guide.

### Technical data

<b>AC power adaptor</b>	Model number: CPS008050100* Input: 100-240 VAC, 50/60 Hz Output: 5.0 VDC, 1.0 A, 5.0 W Average active efficiency: 73.7% @115 VAC, 230 VAC No-load power consumption: 0.08 W @115 VAC, 230 VAC
<b>Power supply</b>	AC adaptor (included in the package) or 4× AA Alkaline batteries (not included in the package)
<b>Connector type</b>	Micro USB port for the AC adaptor Applicable for 3× 3.5 mm mono mini plug
<b>Battery</b>	4× AA Alkaline batteries
<b>Battery life</b>	Up to 1 year (may vary based on the usage, frequency of firmware update and environment)
<b>Communication interface</b>	IR emitter energy IEC825 compliant Zigbee: 2.4 GHz, IEEE802.15.4 compliant
<b>Operating frequency</b>	2405-2480 MHz (Zigbee)
<b>Max. radio-frequency power transmitted</b>	<10 mW (Zigbee)
<b>IR extension cable length</b>	3 m <b>Note:</b> Applies to the recommended IR extension cable
<b>IR control range with IR extension cable</b>	1 m (from emitter to the IR controlled device) <b>Note:</b> Applies to the recommended IR extension cable
<b>IR control range without IR extension cable</b>	≤8 m (from Wiser IR Converter to IR controlled device)
<b>IP rating</b>	IP20
<b>Operating temperature</b>	-10 °C to +45 °C
<b>Relative humidity</b>	10% to 90%, non-condensing
<b>Product dimensions</b>	Ø100.0 × 32.5 mm
<b>Compliance</b>	

#### Trademarks

- Apple® and App Store® are brand names or registered trademarks of Apple Inc.
- Google Play™ Store and Android™ are brand names or registered trademarks of Google Inc.
- Wiser™ is a trademark and the property of Schneider Electric SE, its subsidiaries and affiliated companies.
- Zigbee® is a registered trademark of the Zigbee Alliance.

Other brands and registered trademarks are properties of their relevant owners.

### Customer Care

#### Warranty information

We warrant this product for 1 year. See **Warranty** links below.

#### Schneider Electric (Australia) Pty Ltd

33-37 Port Wakefield Road, Gepps Cross SA 5094

**Customer Care:** 13 73 28

**Email:** customercare.au@se.com

#### Warranty:

<https://www.se.com/au/en/about-us/legal/terms-and-conditions.jsp>  
www.se.com

#### Schneider Electric (NZ) Ltd

Building 6, 60 Highbrook Drive,

East Tamaka, Auckland 2013

**Customer Care:** 0800 652 999

**Email:** sales@nz.schneider-electric.com

#### Warranty:

<https://www.se.com/nz/en/about-us/legal/terms-and-conditions.jsp>  
www.se.com