

HellermannTyton

Copper Lugs, Links,
Bi-Metal Series,
Crimping Tools



2018



Lugs and Links

Copper Lugs

Copper Cable Lug

Copper Lug Series

Copper cable lugs are used to terminate the ends of electrical cable so they can be connected to other electrical equipment, such as busbars and electric motors. Cable lugs are highly conductive and can handle very high currents. Our range of Copper Lugs/Links complies to Australian & New Zealand standard AS/NZS4325 Part 1:1995.

Features and Benefits

- Wide range of sizes
- Can be crimped using handheld crimper or hydraulic crimper
- Easy insertion of cable



Copper Lug and Link Series.



Long Barrel Short Palm Series



Long Barrel Long Palm Series



Bell Mouth Copper Lug Series



Bimetal Series

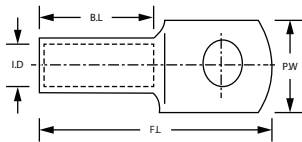

MATERIAL	Copper Grade C11000
Conductive Material	Copper 99.9% pure Oxygen content 30 p.p.m Max. Tensile strength 205 Mpa Min Ductile rating 40% Final metal state fully annealed Electroplating material tin 99.9% pure Other metals lead + antimony Thickness 5 -10 microns
Conformant Standards	AS/NZS4325 Part 1:1995
General Electrical Properties	Total conductivity 99.9% IACS Total resistivity: 1.72 micro-ohm cm
Operating Temperature	-55°C to 155°C due to oxygen-free copper

COPPER LUGS



HTA PART NUMBER	Conductor Size (mm ²)	Stranding metric	Stud	ID Size	Palm Width	Barrel Length	Full Length	A/F Hex	Pack Qty
CL1.5-4	1.5	7/0.50	M4	1.8	8	7	18	-	100
CL1.5-5			M5		8	7	18		
CL1.5-6			M6		10	7	19		
CL2.5-4	2.5	7/0.67	M4	2.4	8	8	19	-	100

All dimensions in mm. Subject to technical changes.



Date of issue: 01/2018



HTA PART NUMBER	Conductor Size (mm ²)	Stranding metric	Stud	ID Size	Palm Width	Barrel Length	Full Length	A/F Hex (mm)	Pack Qty
CL2.5-5	2.5	7/0.67	M5	2.4	10	8	19	-	100
CL2.5-6			M6		10		21		
CL2.5-8			M8		12	24			
CL4-5	4	7/0.85	M5	3.1	10	9	22	-	100
CL4-6			M6		12		27		
CL4-8			M8		15		32		
CL4-10			M10		18	38			
CL6-5	6	7/1.04	M5	3.8	10	9	23	4.4	100
CL6-6			M6		12		27		
CL6-8			M8		10	27			
CL6-10			M10			32			
CL10-5	10	7/1.35	M5	4.7	12	10	27	5.7	100
CL10-6			M6		14		29		
CL10-8			M8		15		32		
CL10-10			M10		18	38			
CL10-12			M12		21	45			
CL16-6	16	7/1.70	M6	5.5	11	19	39	6.3	50
CL16-8			M8		14		41		
CL16-10			M10		16		46		
CL16-12			M12		18	51			
CL25-6	25	19/1.35	M6	7.1	13.5	21	41	7.7	50
CL25-8			M8		16		44		
CL25-10			M10		18		48		
CL25-12			M12		21	54			
CL35-6	35	19/1.53	M6	8.4	16	21	45	9.2	50
CL35-8			M8		18		51		
CL35-10			M10		21	57			
CL35-12			M12		24	63			
CL50-6	50	19/1.78	M6	9.5	18	22	46	10.4	50
CL50-8			M8		21		52		
CL50-10			M10		24	58			
CL50-12			M12		27	64			
CL70-6	70	19/2.14	M6	11.3	21	24	54	11.5	25
CL70-8			M8						
CL70-10			M10						
CL70-12			M12						
CL70-16			M16						
CL95-8	95	37/1.78	M8	13.5	25	27	60	14.2	25
CL95-10			M10				64		
CL95-12			M12				70		
CL95-16			M16				76		
CL120-8	120	37/2.03	M8	15.6	30	30	64	16.5	25
CL120-10			M10				70		
CL120-12			M12				76		
CL120-16			M16				82		

All dimensions in mm. Subject to technical changes.





Lugs

Copper Lugs

HTA PART NUMBER	Conductor Size (mm ²)	Stranding metric	Stud	ID Size	Palm Width	Barrel Length	Full Length	A/F Hex (mm)	Pack Qty
CL150-10	150	37/2.25	M10	16.7	32	30	71	18.3	20
CL150-12			M12				75		
CL150-16			M16						
CL185-10	185	37/2.52	M10	18.4	36	32	74	20	20
CL185-12			M12		36	32	79		
CL185-16			M16		36	32	79		
CL240-10	240	61/2.25	M10	21.2	41	38	92	23.1	10
CL240-12			M12		41	38	92		
CL240-16			M16		41	38	92		
CL300-10	300	61/2.52	M10	23.8	46	42	101	26	5
CL300-12			M12						
CL300-16			M16						
CL400-12	400	61/2.85	M12	26.8	50	44	114	28.1	1
CL500-12	500	61/3.20	M12	30	56	50	119	31	1
CL630-12	630	127/2.52	M12	34	64.4	58	139	37	1

All dimensions in mm. Subject to technical changes.

LONG BARREL SHORT PALM



HTA PART NUMBER	Conductor Size (mm ²)	Stud	ID Size	Palm Width	Barrel Length	Full Length	A/F Hex (mm)	Pack Qty
CL10-6LB	10	M6	4.7	12	21	35	5.7	1
CL16-6LB	16	M6	5.5	11	21	41	6.3	1
CL16-8LB		M8		14				1
CL16-12LB		M12		16				1
CL25-8LB	25	M8	7.1	14	35	49	7.7	1
CL25-10LB		M10		16		52		1
CL25-12LB		M12		18		56		1
CL35-8LB	35	M8	8.2	16		59	9.2	1
CL35-10LB		M10		18		59		1
CL35-12LB		M12		20		64		1
CL50-10LB	50	M10	9.5	18	44	76	10.4	1
CL50-12LB		M12		21	46			1
CL70-10LB	70	M10	11.3	21	48	78	11.5	1
CL70-12LB		M12		21				1
CL95-10LB	95	M10	13.5	25	54	87	14.2	1
CL95-12LB		M12						1
CL120-10LB	120	M10	15.6	20.6	60	94	16.5	1
CL120-12LB		M12						1
CL150-12LB	150	M12	16.7	22.5		105	18.3	1
CL150-16LB		M16						1
CL185-12LB	185	M12	18.4	24.2	64	111	20	1
CL240-12LB	240	M12	21.2	41	80	134	23.1	1
CL300-16LB	300	M16	23.5	46	90	149	26	1
CL400LB	400	0	26.8	50	100	170	28.1	1
CL500LB	500		30.0	56	105	181	31	1
CL630LB	630		34.00	64.4	115	193	37	1

All dimensions in mm. Subject to technical changes.



LONG BARREL LONG PALM



HTA PART NUMBER	Conductor Size (mm ²)	ID Size	Palm Width	Barrel Length	Full Length	A/F Hex (mm)	Pack Qty
CL16LPB	16	5.5	16	21	82	6.3	1
CL25LPB	25	7.1	16	29	95	7.7	1
CL35LPB	35	8.4	18	35	112	9.2	1
CL50LPB	50	9.5	18	44	130	10.4	1
CL70LPB	70	11.3	21	48	154	11.5	1
CL95LPB	95	13.5	25	54	161	14.2	1
CL120LPB	120	15.6	28	60	168	16.5	1
CL150LPB	150	16.7	32	60	169	18.3	1
CL185LPB	185	18.4	35	64	174	20	1
CL240LPB	240	21.2	41	80	180	23.1	1
CL300LPB	300	23.8	46	90	190	26	1
CL400LPB	400	26.8	50	100	200	28.1	1
CL500LPB	500	30.0	56	105	205	31	1
CL630LPB	630	34.0	64.4	115	215	37	1

All dimensions in mm. Subject to technical changes.

BELLMOUTH COPPER LUGS



HTA PART NUMBER	Conductor Size (mm ²)	Stud	ID Size	Palm Width	Barrel Length	Full Length	A/F Hex (mm)	Pack Qty			
CL10-6BM	10	M6	4.7	12	10	27	5.7	100			
CL10-8BM		M8		14		29					
CL10-10BM		M10		15		32					
CL10-12BM		M12		18	11	38					
CL16-6BM	16	M6	5.5	11	19	39	6.3	50			
CL16-8BM		M8		14		41					
CL16-10BM		M10		16		46					
CL16-12BM		M12		18		21			41	7.7	50
CL25-6BM	25	M6	7.1	13.5	21	44					
CL25-8BM		M8		16		48					
CL25-10BM		M10		18		21	45	9.2	50		
CL25-12BM		M12		20		51					
CL35-6BM	35	M6	8.4	16	21	46	10.4			50	
CL35-8BM		M8		18		52					
CL35-10BM		M10		21		24		54	11.5		25
CL35-12BM		M12		21		24		54			
CL50-6BM	50	M6	9.5	18	22	52					
CL50-8BM		M8		21		24	54				
CL50-10BM		M10		21		24	54				
CL50-12BM		M12		21		24	54				
CL70-6BM	70	M6	11.3	21	24	54	11.5	25			
CL70-8BM		M8		21		24			54		
CL70-10BM		M10		21		24			54		
CL70-12BM		M12		21		24			54		

All dimensions in mm. Subject to technical changes.



Lugs and Links

Copper Lugs

BELLMOUTH COPPER LUGS



HTA PART NUMBER	Conductor Size (mm ²)	Stud	ID Size	Palm Width	Barrel Length	Full Length	A/F Hex (mm)	Pack Qty
CL95-8BM	95	M8	13.5	25	27	60	14.2	25
CL95-10BM		M10						
CL95-12BM		M12						
CL120-10BM	120	M10	15.6	30	30	64	16.5	25
CL120-12BM		M12						
CL120-16BM		M16						
CL150-10BM	150	M10	16.7	32	30	71	18.3	20
CL150-12BM		M12				75		
CL185-10BM	185	M10	18.4	36	32	74	20	20
CL185-12BM		M12				79		
CL240-10BM	240	M10	21.2	41	38	92	23.1	10
CL240-12BM		M12						
CL240-16BM		M16						
CL300-16BM	300	M16	23.8	46	42	101	26	5

All dimensions in mm. Subject to technical changes.

BELLMOUTH CIRCUIT BREAKER LUGS NARROW PALM



HTA PART NUMBER	Conductor Size (mm ²)	Stud	ID Size	Palm Width	Barrel Length	Full Length	A/F Hex (mm)	Pack Qty
CLB35-6	35	M6	8.4	15	21	41	9.2	50
CLB50-6	50	M6	9.5	15	22	43	10.4	50
CLB50-10		M10		19		49		
CLB70-6	70	M6	11.3	17	24	45	11.5	25
CLB70-10		M10		19		51		
CLB95-8	95	M8	13.5	19	27	51	14.2	25
CLB95-10		M10				55		
CLB120-8	120	M8	15.6	19	30	61	16.5	25
CLB120-10		M10						
CLB150-10	150	M10	16.7	19	30	66	18.3	20
CLB185-10	185	M10	18.4	24.5	32	74	20	20
CLB240-10	240	M10	21.2	31	38	82	23.1	10
CLB240-12		M12						
CLB300-10	300	M10	23.8	31	42	87	26	5

All dimensions in mm. Subject to technical changes.

COPPER CRIMP LINKS



HTA PART NUMBER	Conductor Size (mm ²)	Stranding metric	ID Size	Full Length	A/F Hex	Pack Qty
CS1.5	1.5	1/0.50	1.8	22	-	100
CS2.5	2.5	7/0.67	2.4	22	-	100
CS4	4	7/0.85	3.1	22	-	100
CS6	6	7/1.04	3.8	22	4.4	100
CS10	10	7/1.35	4.7	22	5.7	100

All dimensions in mm. Subject to technical changes.



HTA PART NUMBER	Conductor Size (mm ²)	Stranding metric	ID Size	Full Length	A/F Hex (mm)	Pack Qty
CS16	16	7/1.70	5.5	44	6.3	50
CS25	25	19/1.35	7.1	47	7.7	50
CS35	35	19/1.53	8.4	47	9.2	50
CS50	50	19/1.78	9.5	47	10.4	50
CS70	70	19/2.14	11.3	50	11.5	25
CS95	95	37/1.78	13.4	54	14.2	25
CS120	120	37/2.03	15.6	65	16.5	25
CS150	150	37/2.25	16.7	65	18.3	20
CS185	185	37/2.52	18.4	65	20	20
CS240	240	61/2.25	21.2	90	23.1	10
CS300	300	61/2.52	23.8	90	26	5
CS400	400	61/2.82	26.8	90	28.1	1
CS500	500	61/3.20	30	112	30.1	1
CS630	630	127/2.52	34	112	34	1

All dimensions in mm. Subject to technical changes.

BI-METAL



HTA PART NUMBER	Conductor Size (mm ²)	Stud	ID Size	Palm Width	Barrel Length	Full Length	A/F Hex (mm)	Pack Qty			
BML16-10	16	10	5.5	20	32	75	9	1			
BML25-10	25		7.5					1			
BML25-12		12	1								
BML35-10	10	8.5	1								
BML35-12	35	12	9.5	24		115	13.2	1			
BML50-10	50	10						1			
BML50-12		12						1			
BML70-10	70	10						11.5	30	60	17.3
BML70-12		12	1								
BML95-10	95	10	13.5		35	120	22	1			
BML95-12		12						1			
BML120-10	120	10	15.5					30	60	17.3	1
BML120-12		12		1							
BML150-10	150	10	16.5	36		135	28.4				1
BML150-12		12									1
BML185-10	185	10	18.5					35	60	22	1
BML185-12		12									1
BML240-10	240	10	22		50	70	165				1
BML240-12		12									1
BML300-10	300	10	23.5					36	60	22	1
BML300-12		12									1
BML300		0		1							
BML400	400	0	26.5	50		70	165				39

All dimensions in mm. Subject to technical changes.



Crimp Tools

YYT8 - Uninsulated Terminal Crimper

- **Range:** 1.5mm², 2.5mm² - 4.0mm²
- Ratchet release feature
- Size: 266mm (L) x 66mm (W)



HD16L - Heavy Duty Crimper (Uninsulated Terminals)

- **Range:** 1.5mm² - 16.0mm²
- Ratchet release feature
- Length: 270mm



HD0650AU - Hex Crimper

- **Range:** 6/10/16/25/35/50mm²
- Hexagonal crimper with movable and rotating dies
- For tubular cable lugs and connectors
- Length: 380mm
- Dies included



HD06120AU - Hex Crimper

- **Range:** 6/10/16/25/35/50/70/95/120mm²
- Hexagonal crimper with movable and rotating dies
- For tubular cable lugs and connectors
- Length: 650mm
- Dies included



HYCP400 - Hand Hydraulic Crimper

- **Range:** 16mm² - 300mm²
- Automatic low/high - pressure conversion with
- Rapid/slow operating motion
- Heavy duty case included
- Pressure relief valve for overload protection
- Head rotates 180°
- Dimensions: 590 x 170mm
- Force at die face: 12 metric ton (700 bar)
- C-head opening: 32mm
- Dies sold separately



HYLEC32 - Battery Operated Hydraulic Crimper Kit

- **Range:** 16mm² - 300mm²
- 14,4 Volt Lithium-Ion battery powered
- Number of crimps per charge: 60
- 12.7 ton die force
- Head rotates 180°
- Dimensions: 385mm (L) x 307mm (H) x 74mm (W)
- Weight: 6.8Kg
- C-head opening: 32mm
- Dies sold separately
- Additional battery available (HYLEC32BATT)



Hydraulic Die Specification and Part No.

PART NO.	Die Number	A	B
DIECU16	K12-C16AF6.3	6.3	17.57
DIECU25	K12-C25AF7.7	7.7	17.57
DIECU35	K12-C35AF9.2	9.2	17.57
DIECU50	K12-C50AF10.4	10.4	17.57
DIECU70	K12-C70AF11.5	11.5	17.57
DIECU95	K12-C95AF14.2	14.2	17.57
DIECU120	K12-C120AF16.5	16.5	14.14
DIECU150	K12-C150AF18.3	18.3	14.14
DIECU185	K12-C185AF20.0	20.0	14.14
DIECU240	K12-C240AF23.1	23.1	10.2
DIECU300	K12-C300AF26.0	26.0	10.2

All dimensions in mm. Subject to technical changes.

