



# SmartBright LED Downlight DN029B

## DN029B G2 LED12/CCT PSR-E D150 CAU

SmartBright LED Downlight DN029B, 10.5 W, 1200 lm, 3000 K, 4000 K, 6500 K, White

The Philips SmartBright G2 LED downlight provides a professional and flexible solution for a wide variety of applications. Offering three selectable colour temperatures plus integrated dimming capability, the G2 downlight makes it really easy to create the perfect ambience for your unique environment. This affordable and quick to install fitting delivers high energy savings without compromising on light quality.

### Product data

General Information		Input Frequency	
Light source replaceable	No		50 or 60 Hz
Lighting Technology	LED	Power Consumption	10.5 W
		Power Factor (Fraction)	0.8
		Connection	Plug-in connector 2-pole
Light Technical		Temperature	
Luminous Flux	1,200 lm	Ambient temperature range	-20 to +40 °C
Correlated Color Temperature (Nom)	3000 4000 6500 K		
Luminous Efficacy (rated) (Nom)	114.00 lm/W	Controls and Dimming	
Color rendering index (CRI)	80	Dimmable	Yes
Light source color	3000/4000/6500		
Luminaire light beam spread	100°	Mechanical and Housing	
		Housing Material	Metal-Plastic
Operating and Electrical		Reflector material	Polycarbonate
Input Voltage	220 to 240 V	Optic material	Polycarbonate
Line Frequency	50 or 60 Hz		

# SmartBright LED Downlight DN029B

Fixation material	Stainless steel
Housing Color	White
Optical cover finish	Frosted
Overall length	114 mm
Overall width	114 mm
Overall height	61 mm
Overall diameter	190 mm
Dimensions (Height x Width x Depth)	61 x 114 x 114 mm

## Approval and Application

Ingress protection code	IP40/IP54 front
Mech. impact protection code	IK03 [0.3 J]
Protection class IEC	Safety class II

## Initial Performance (IEC Compliant)

Initial chromaticity	(3000K@, 0.4400, 0.4030; 4000K@0.37600.3656; 6500K@0.31300.3370) 6
Power consumption tolerance	+/-10%

## Over Time Performance (IEC Compliant)

Driver failure rate at 5000 h	1.2 %
Median useful life L70B50	30,000 h

## Product Data

Order product name	DN029B G2 LED12/CCT PSR-E D150 CAU
Full product name	DN029B G2 LED12/CCT PSR-E D150 CAU
Full product code	871951425187800
Local code description	DN029BL12CCT150
Order code	929002531619
Material Nr. (12NC)	929002531619
Local order code	DN029BL12CCT150
Numerator - Quantity Per Pack	1
EAN/UPC - Product/Case	8719514251878
Numerator - Packs per outer box	6
EAN/UPC - Case	8719514251885

## Dimensional drawing

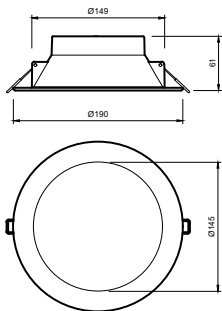

## Photometric data

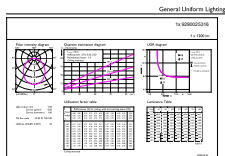

General Uniform Lighting - DN029B G2 LED12/CCT PSR-E D150 CAU

## General uniform lighting - DN029B G2 LED12/CCT PSR-E D150 CAU

# SmartBright LED Downlight DN029B

## Lifetime

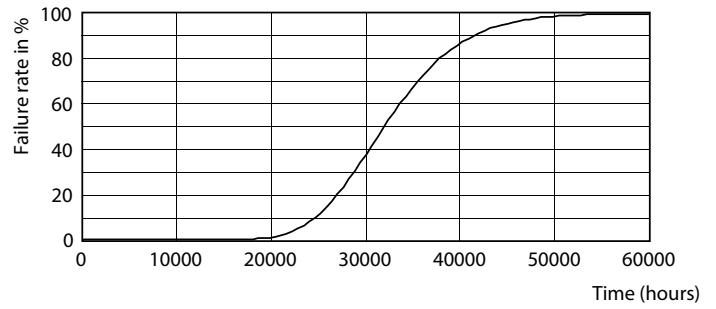
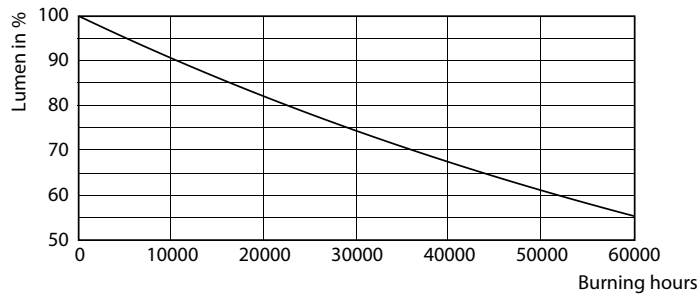

Lumen Maintenance Diagram - DN029B G2 LED12/CCT PSR-E D150 CAU

Life Expectancy Diagram - DN029B G2 LED12/CCT PSR-E D150 CAU

