



PRODUCT DATA

Pantha Plug® Nylon and Metal



The Pantha Plug® is a self-drilling; light duty anchor for plasterboard. It offers fast and easy installation and can also be removed quickly when required. Accommodates screws of many lengths.

Applications	Trades
<ul style="list-style-type: none"> • Wall mounting • Electrical fittings and control boxes • Light fixtures • Alarm systems • Brackets • Kitchen fittings 	<ul style="list-style-type: none"> • Plumbers • Electricians • Builders

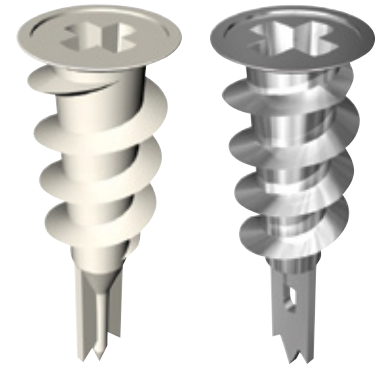

Pantha Plug® Metal

Material	Carbon Steel	
Finish	Zinc Plated	

Features

- Effective drill point for easy installation and penetration of plasterboard.
- Coarse thread profile to cut and grip plasterboard.
- Flat-low profile head allows for flush fixing.
- Phillips Drive (#2) for quick installation.

Part	QFind	Length	Diameter 1	Diameter 2	Diameter 3	Use with Screw Gauge	Phillips Drive	Pack Qty
		L (mm)	D ₁ (mm)	D ₂ (mm)	D ₃ (mm)			
MWPPM#080043	MWP128	43	6.5	7.7	11.8	8G*	#2	100

Pantha Plug® Nylon

*recommended

Material and Finish	Nylon	
----------------------------	-------	--

Part	QFind	Length	Diameter 1	Diameter 2	Diameter 3	Use with Screw Gauge	Phillips Drive	Pack Qty
		L (mm)	D ₁ (mm)	D ₂ (mm)	D ₃ (mm)			
MWPPP#080043	MWP129	43	6.9	8.2	14	8G*	#2	100

*recommended

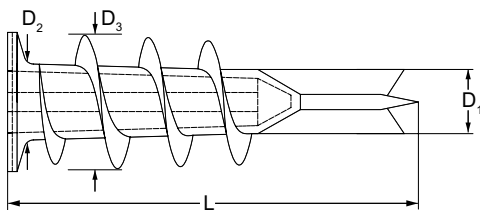

Installation

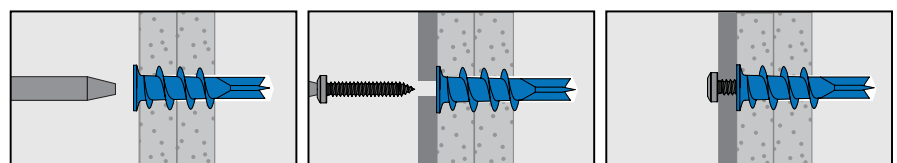

Disclaimer: While every reasonable effort has been made to ensure that this document is correct at the time of printing, Hobson Engineering, its agencies and employees, disclaim any and all liability to any person in respect of anything or the consequences of anything done or omitted to be done in reliance upon the whole or any part of this document.

Bolt Tension | Anti-Vibration | Product Reliability | Traceability

hobson.com.au **QUALITY FASTENERS SINCE 1935**



1911251DS