

Lock Double Bit DIN 3mm 316 Stainless Steel

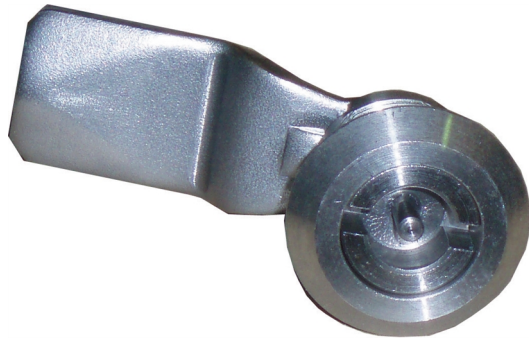

- AISI 316L (ASR/ADR/SRE) & 304 (HDW) pre-grained stainless steel body and door with 400 finish
- Corner formed enclosure door
- High cleanliness design means dirt, debris and bacteria cannot accumulate
- Compatible with MAS/MAD range of accessories
- Mounting plate marked at 10mm intervals for easy equipment positioning

Representative Photo Only
(actual product may vary based on configuration selections)

SPECIFICATIONS

IP Rating	IP66
Diameter, Lock	3 mm
Material, Lock	Stainless Steel, 316L material

REFERENCES

IECEX Certificate	-
Supplier Declaration of Conformity:	-
Installation Guide:	-
User Manual:	-
Manufacturer Datasheet:	-
Manufacturer Catalogue & Product Selection:	-

Catalogue No: **ALLS 316**

NVENT LOCK FLUSH ASR 316 STAINLESS STEEL DIN 3mm DOUBLE BIT

Enclosures and Climate Control > Standard Enclosures > Wall Mount Enclosures > Wall Mount Enclosures - Stainless Steel > Stainless Steel Accessories (see also Mild Steel Wall Mount Accessories) > Locks

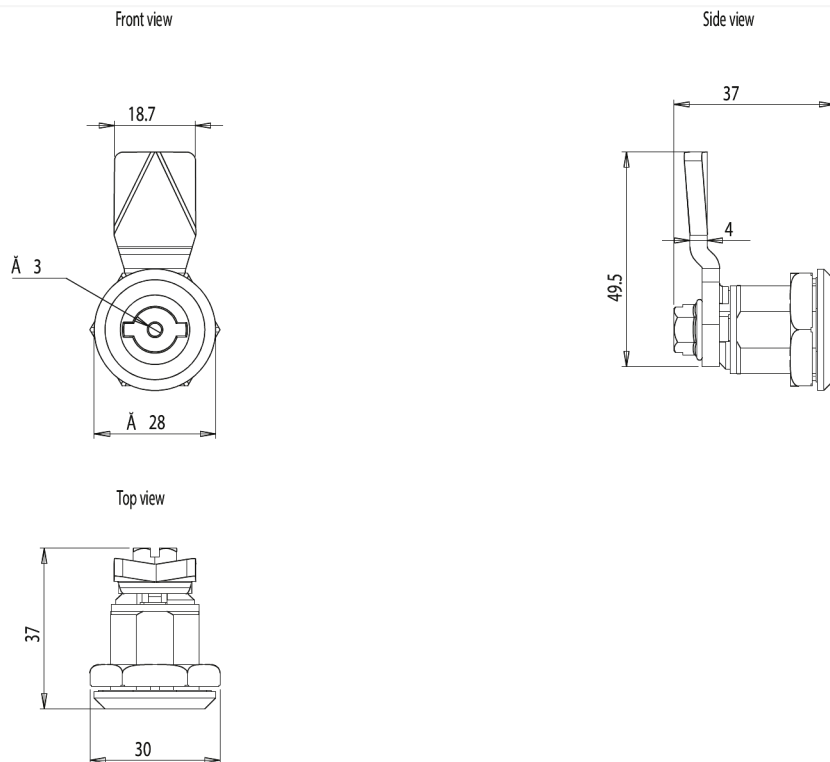

Dimension Diagram