

How to connect S110 Keystone 30M & 40M connectors to reach performance

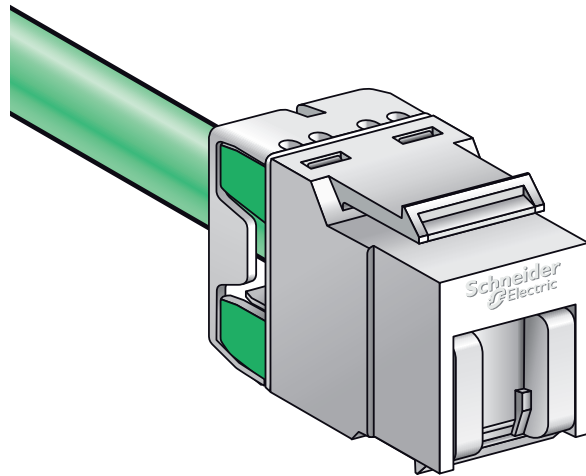

Cat 5e & 6 Cat 6A



S110



S110

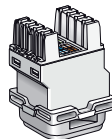

30M

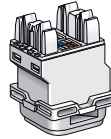

30M

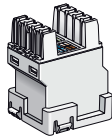

40M

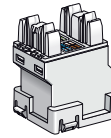

40M



PoE+
4P PoE+

Life Is On



V 3

With quick termination tool

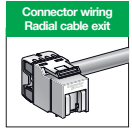
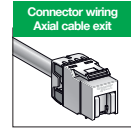
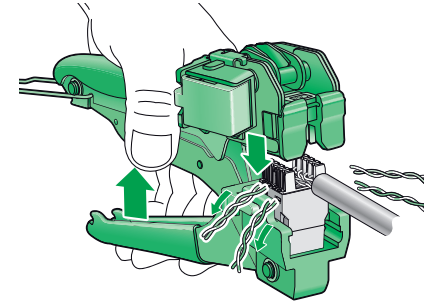

EIA-TIA 568B (100Ω)

5	4	A	6	3
5	4	B	6	3
8	7	B	1	2
8	7	A	1	2

EIA-TIA 568A (100Ω)

5	4	A	6	3
5	4	B	6	3
8	7	B	1	2
8	7	A	1	2



With punch down tool

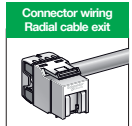
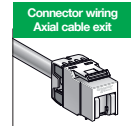

EIA-TIA 568B (100Ω)

5	4	A	6	3
5	4	B	6	3
8	7	B	1	2
8	7	A	1	2

EIA-TIA 568A (100Ω)

5	4	A	6	3
5	4	B	6	3
8	7	B	1	2
8	7	A	1	2



With quick termination tool

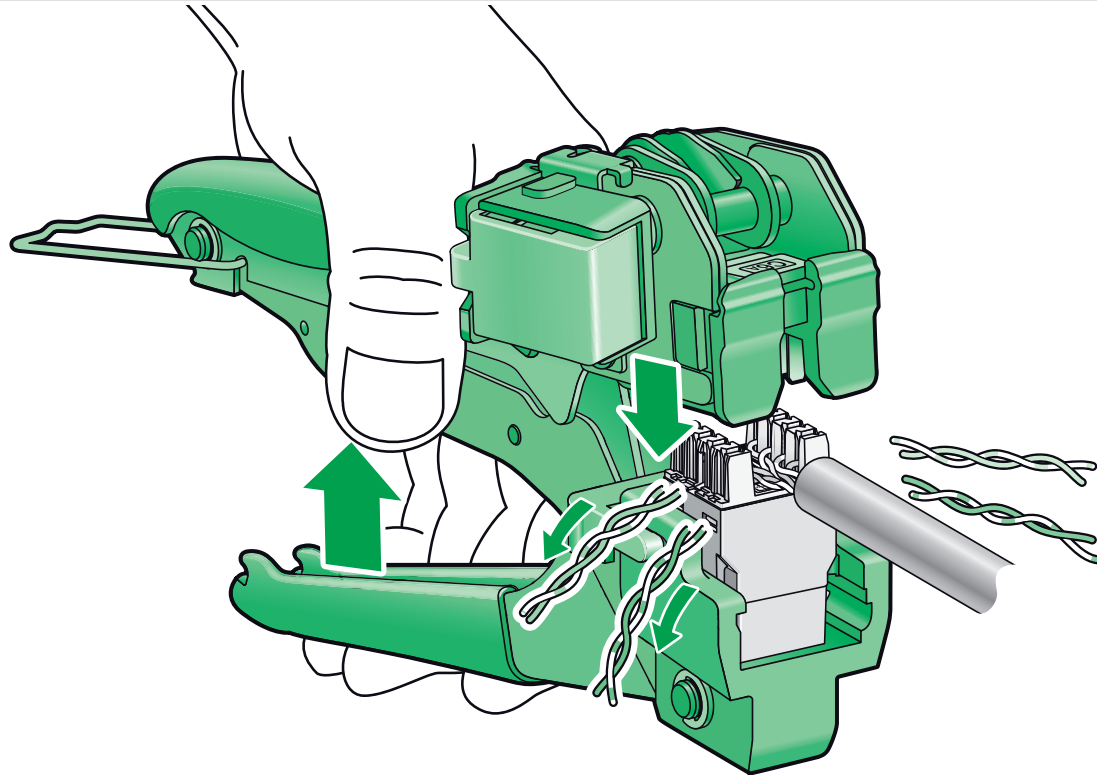

Cat 5e & 6

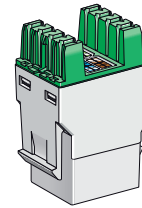

S110

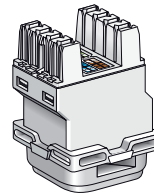

30M

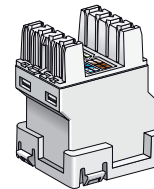

40M

Cat 6A

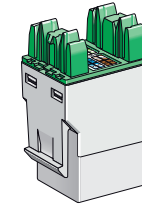

S110

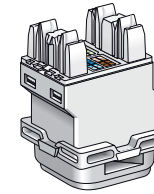

30M

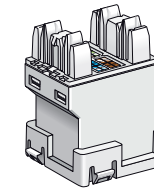

40M

Connector wiring
Axial cable exit

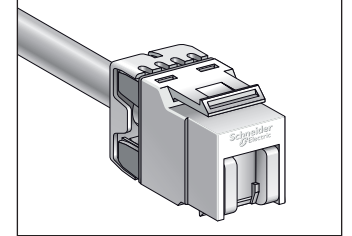

Connector wiring
Radial cable exit

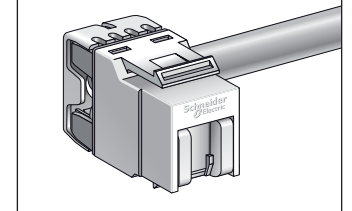

A

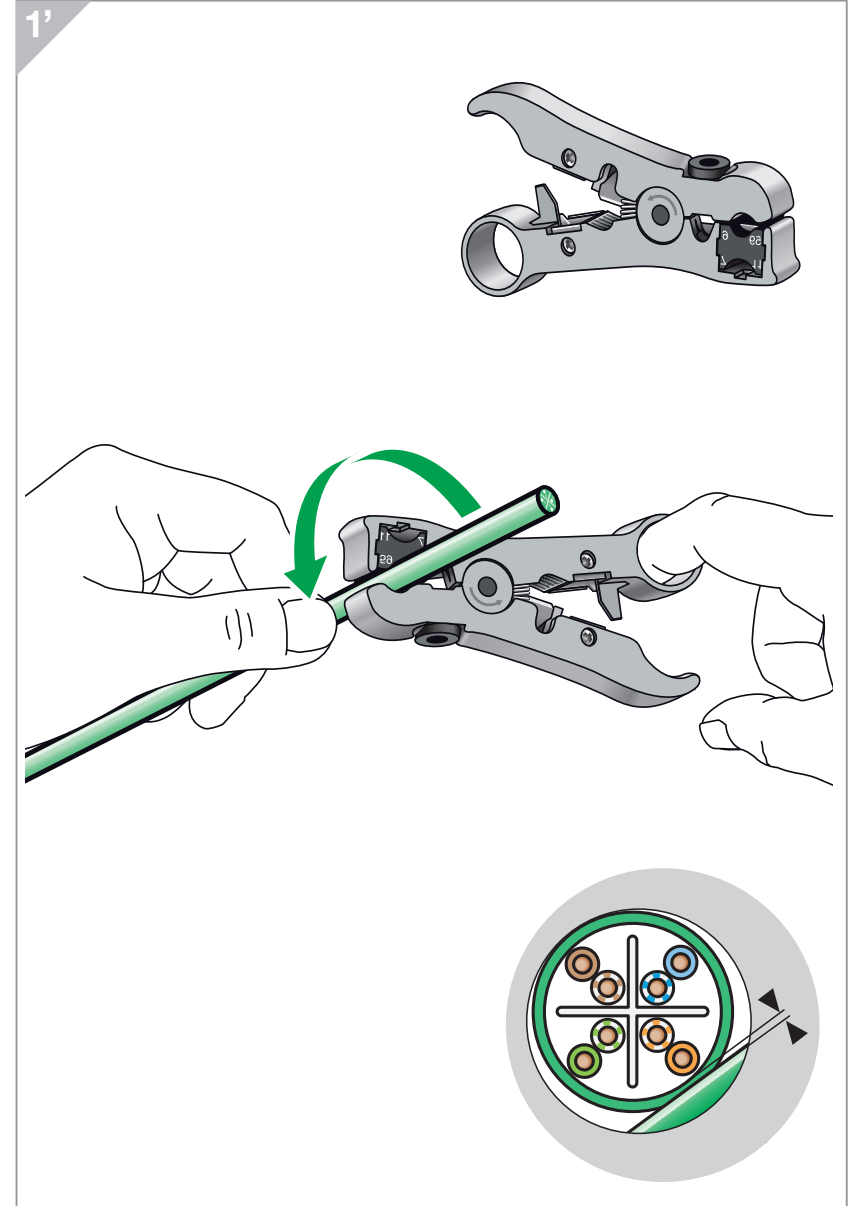
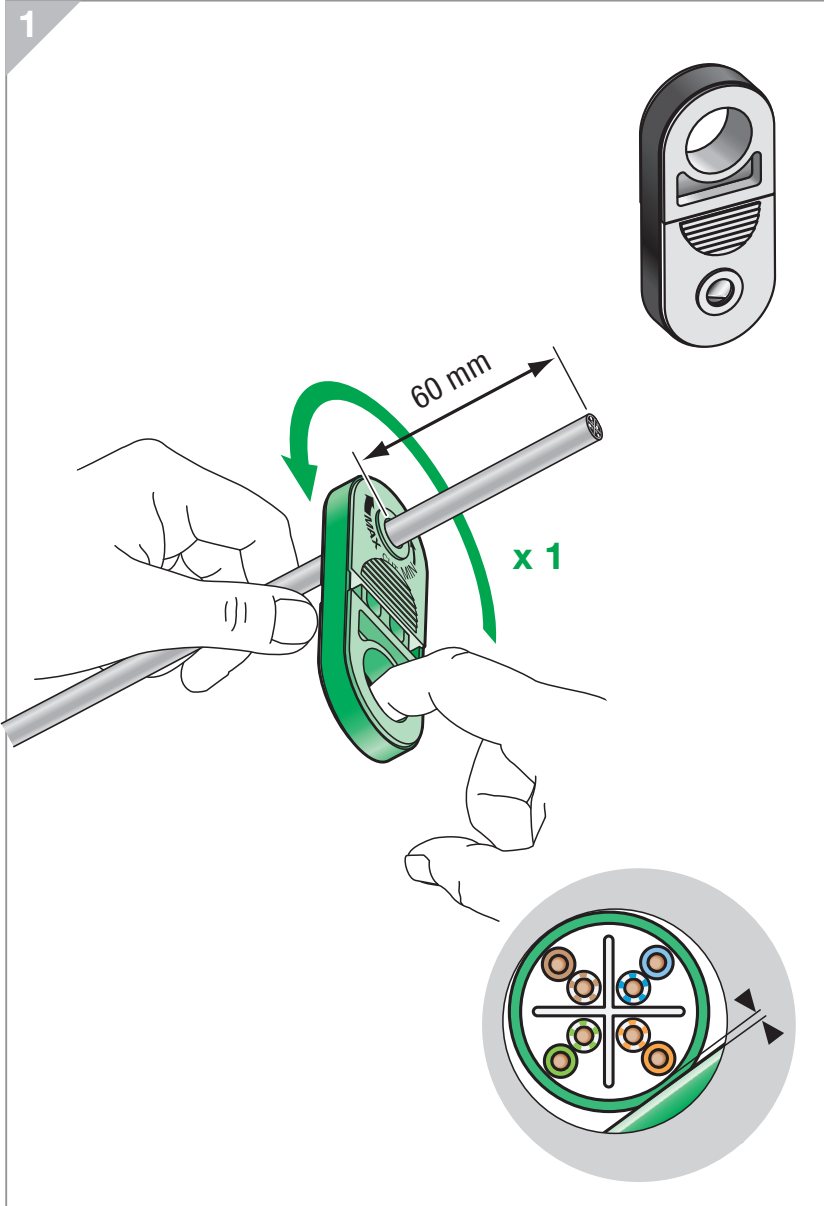
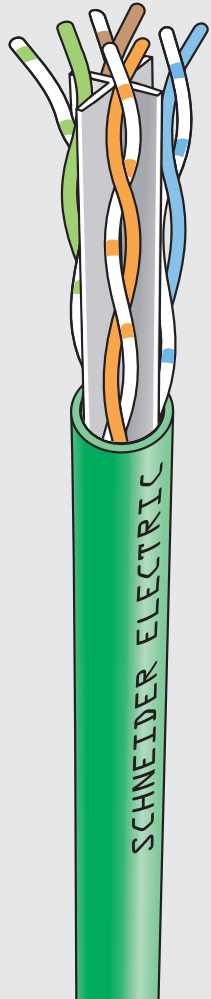

2

1

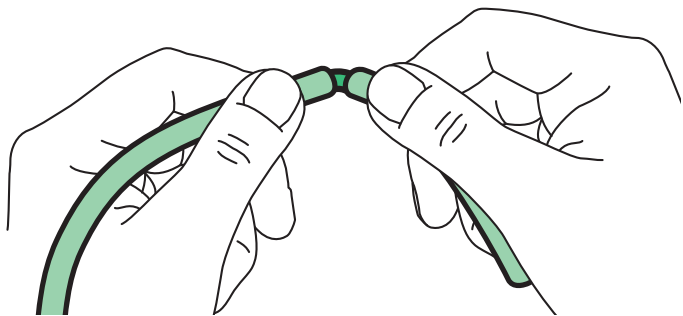

3

2

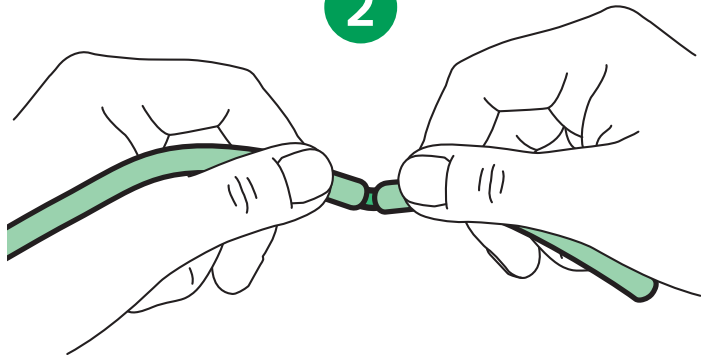

4

3

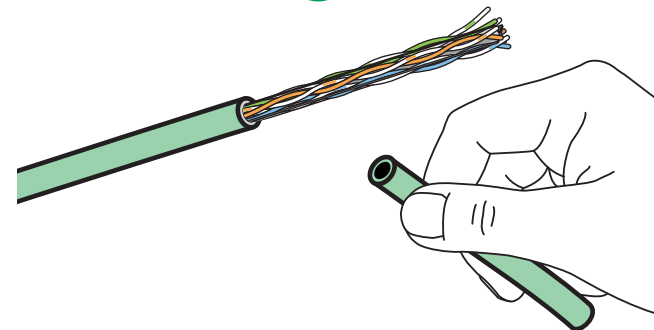

5

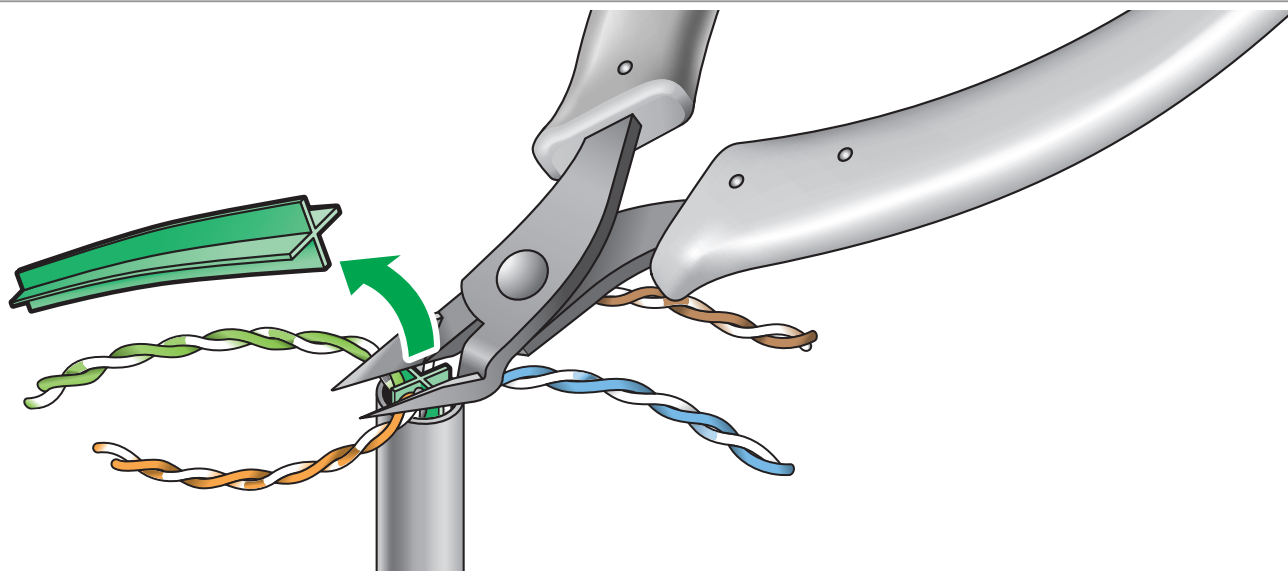
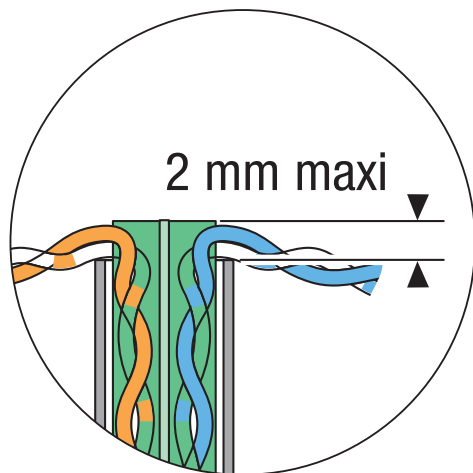

B Convention B

Cat 5e & 6

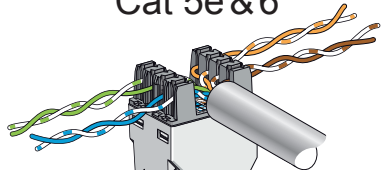

Cat 6A

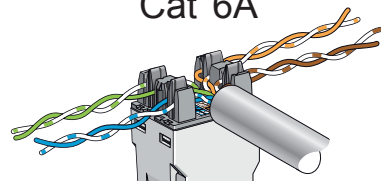

EIA-TIA 568B (100Ω)

3	3	2	2
6	6	1	1
A	B	B	A
4	4	7	7
5	5	8	8

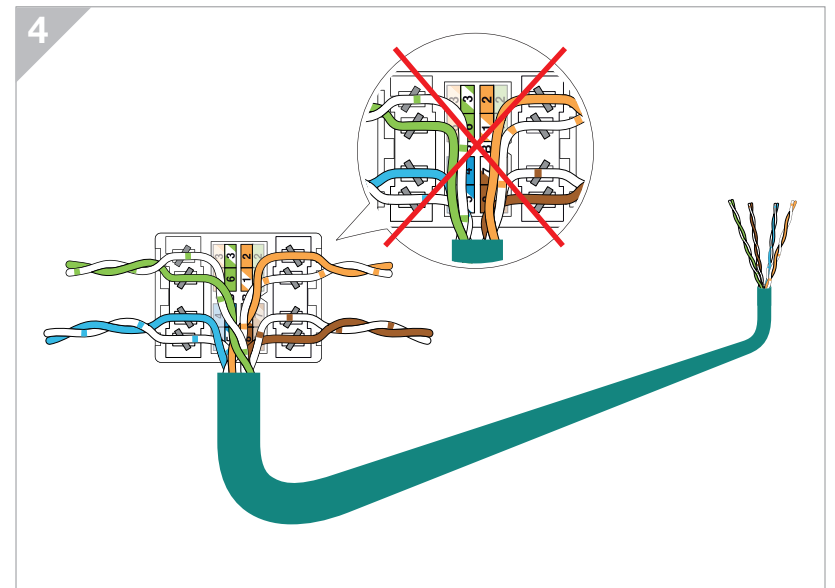
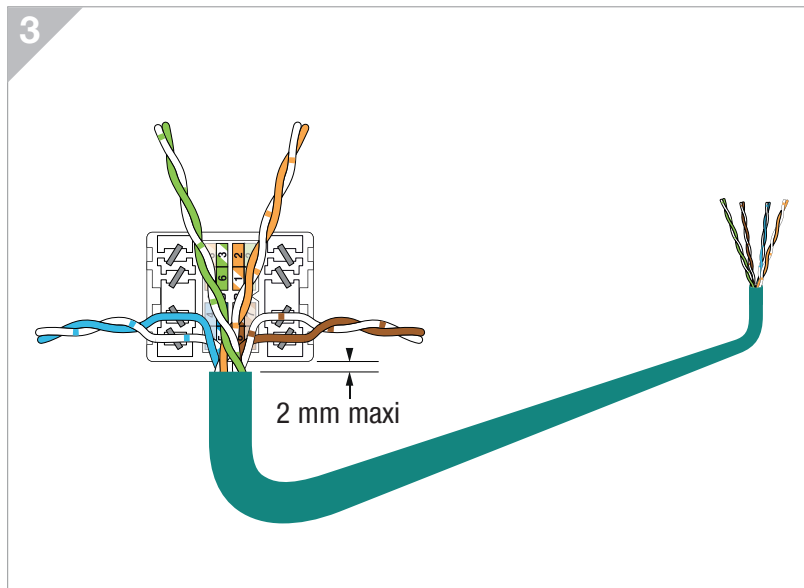
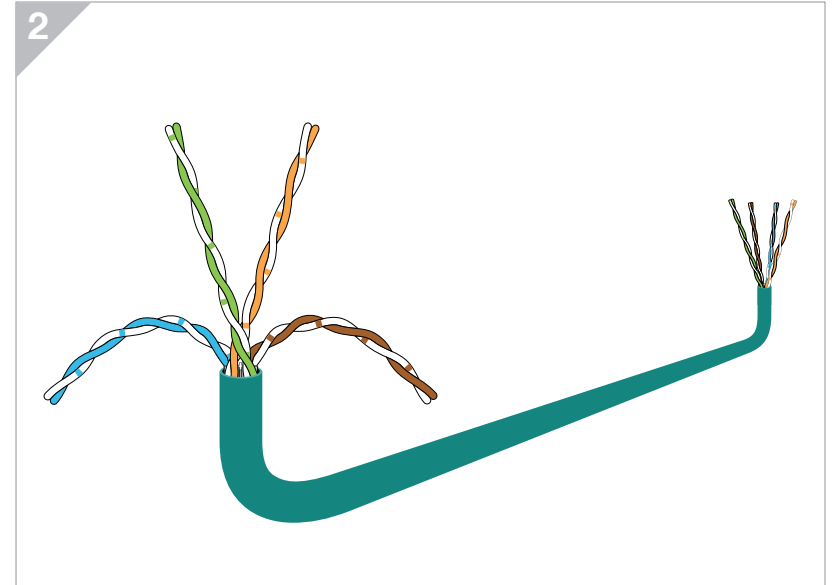
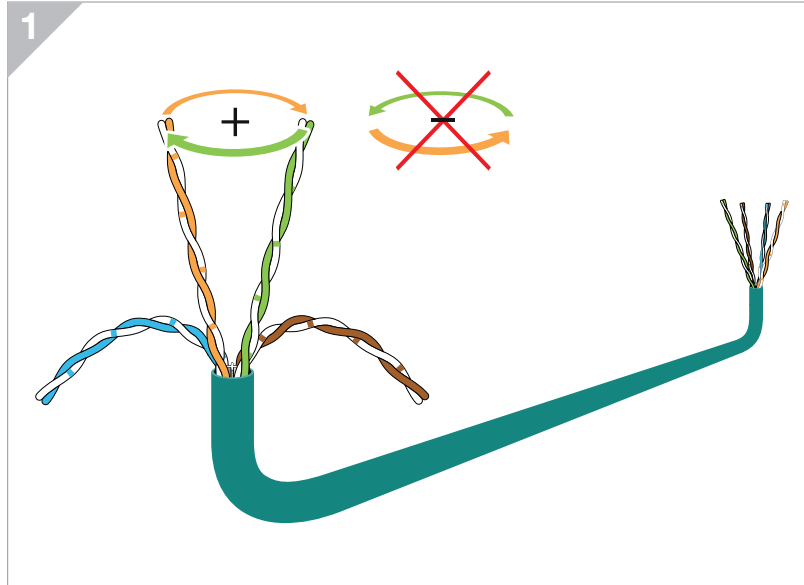

B Convention B

Cat 5e & 6

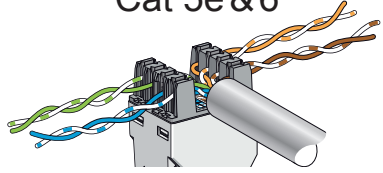

Cat 6A

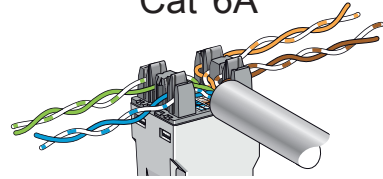

EIA-TIA 568B (100Ω)

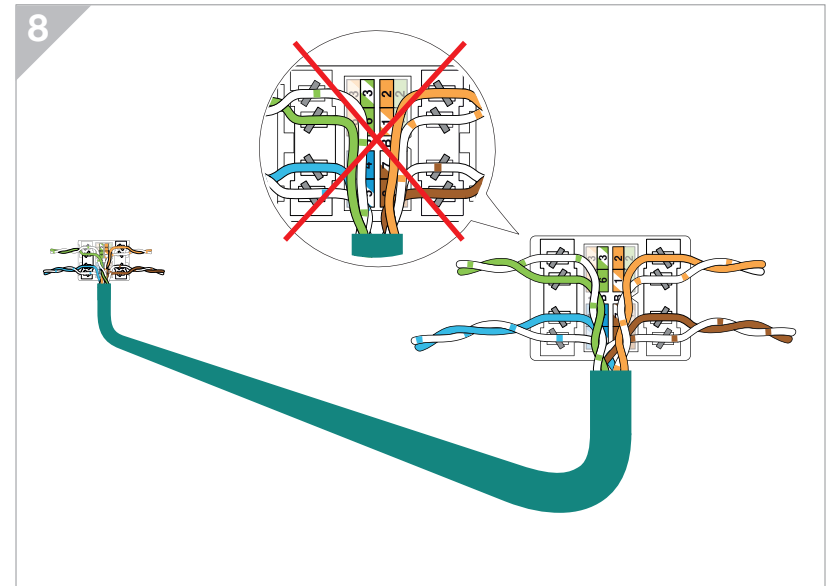
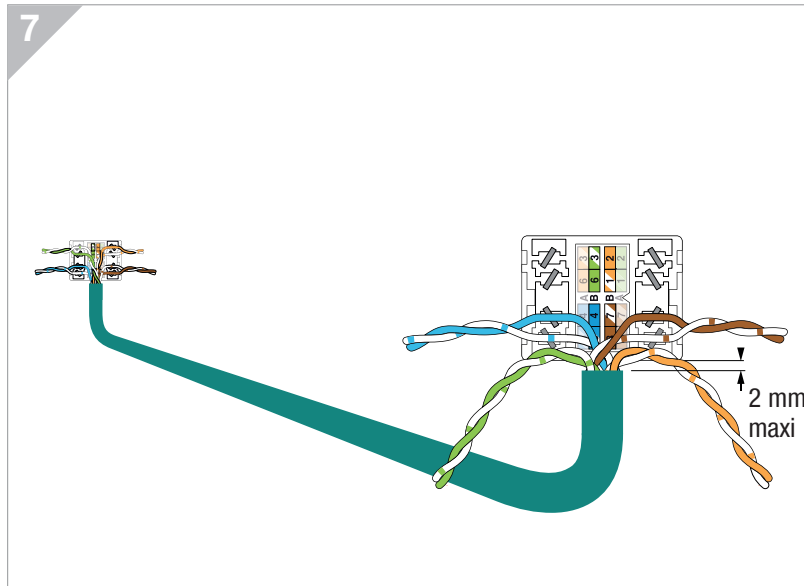
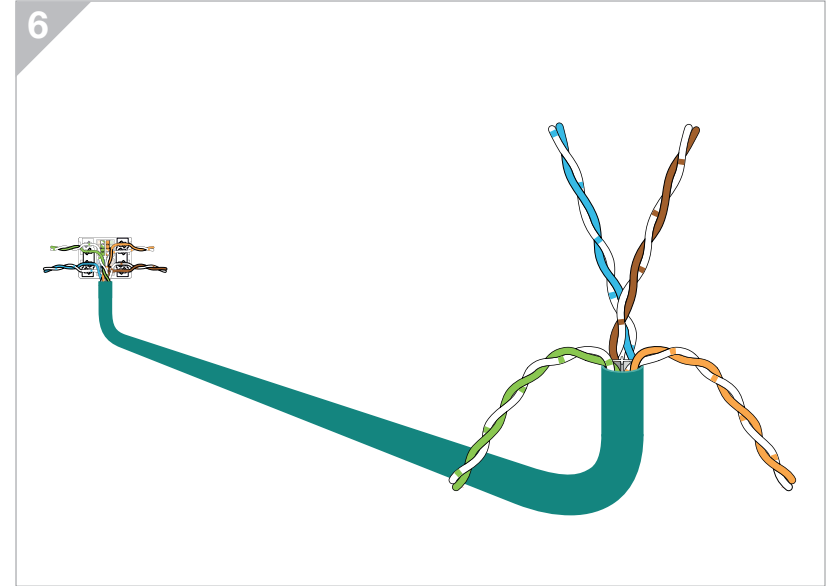
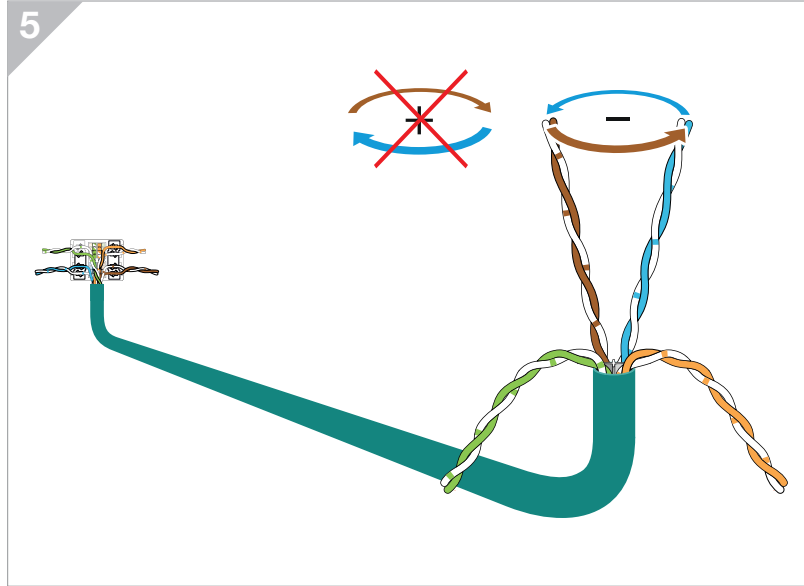

B Convention A

Cat 5e & 6

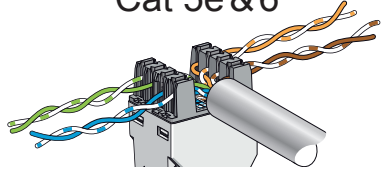

Cat 6A

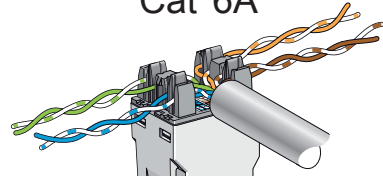

EIA-TIA 568A (100Ω)

5	4	A	6	3
5	4	B	6	3
8	7	B	1	2
8	7	A	1	2

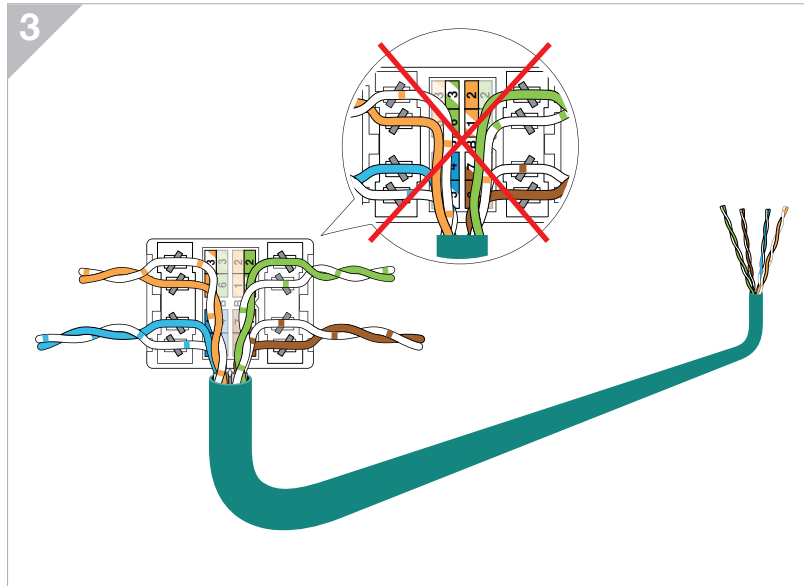
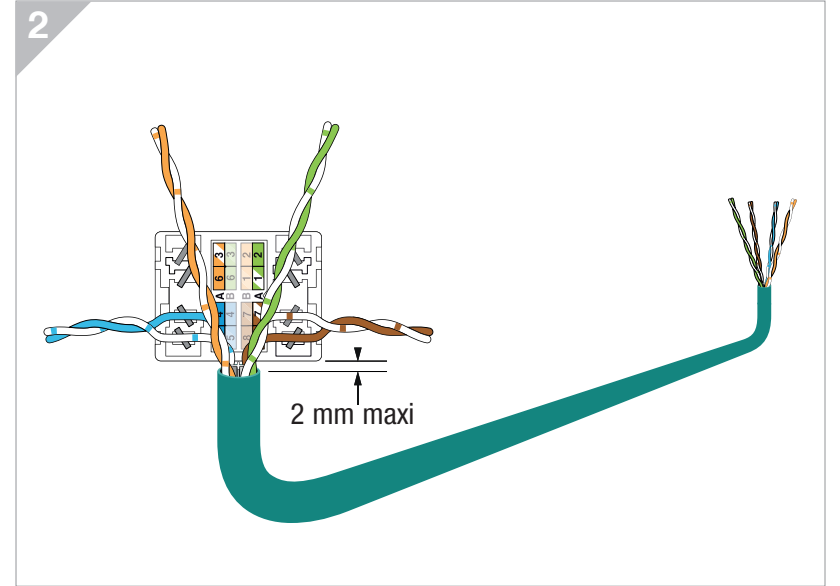
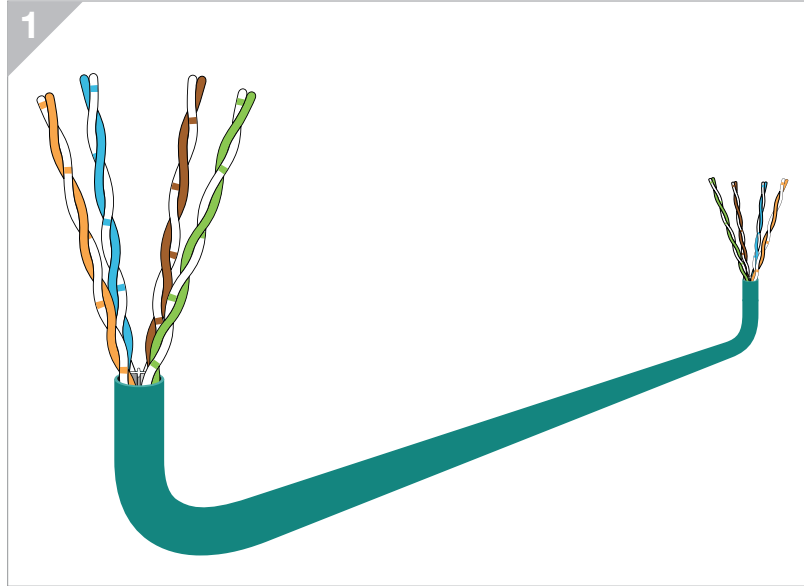

B Convention A

Cat 5e & 6

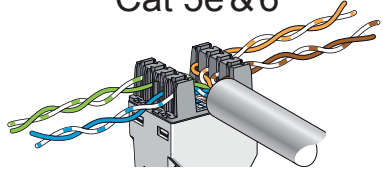

Cat 6A

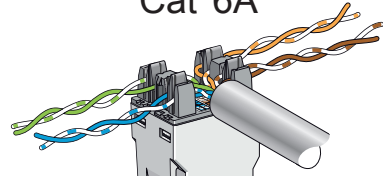

EIA-TIA 568A (100Ω)

5	4	A	6	3	B	6	3	B	1	2	A	7	2
5	4	A	6	3	B	6	3	B	1	2	A	7	2
8	7	B	1	2	A	7	2	B	8	8	8	8	8

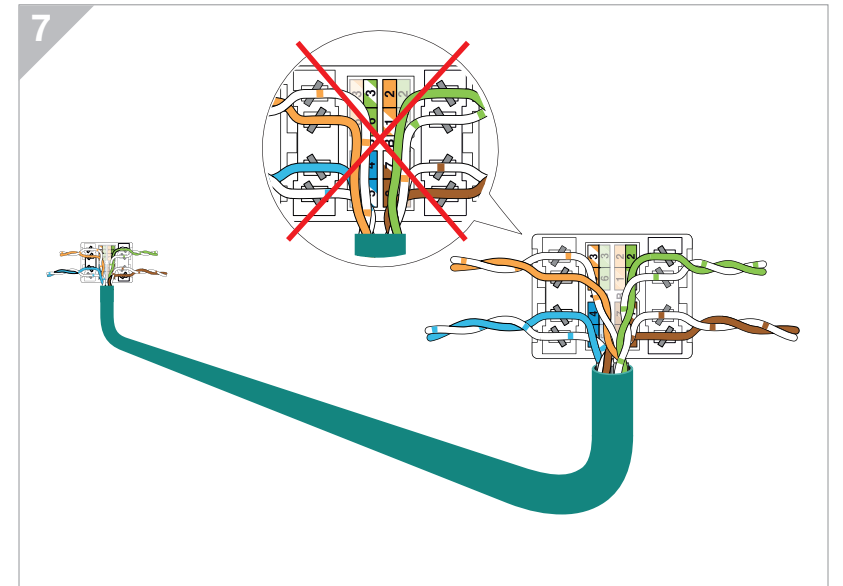
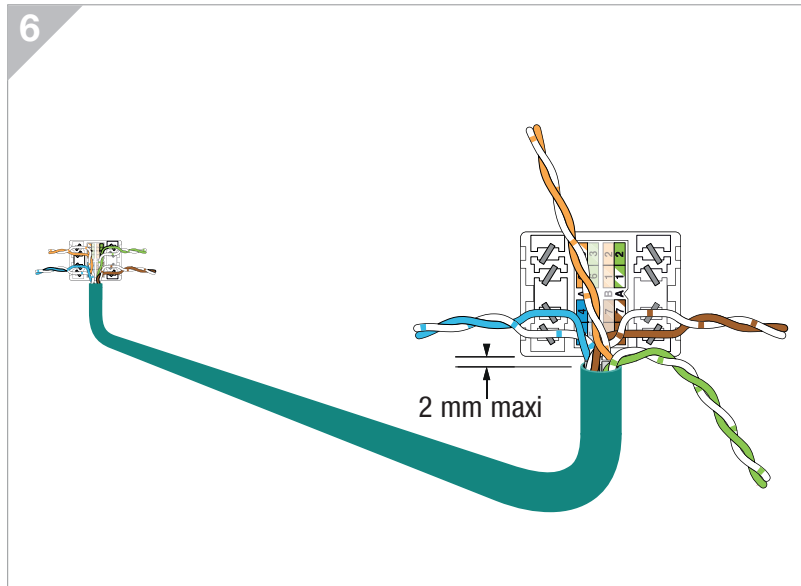
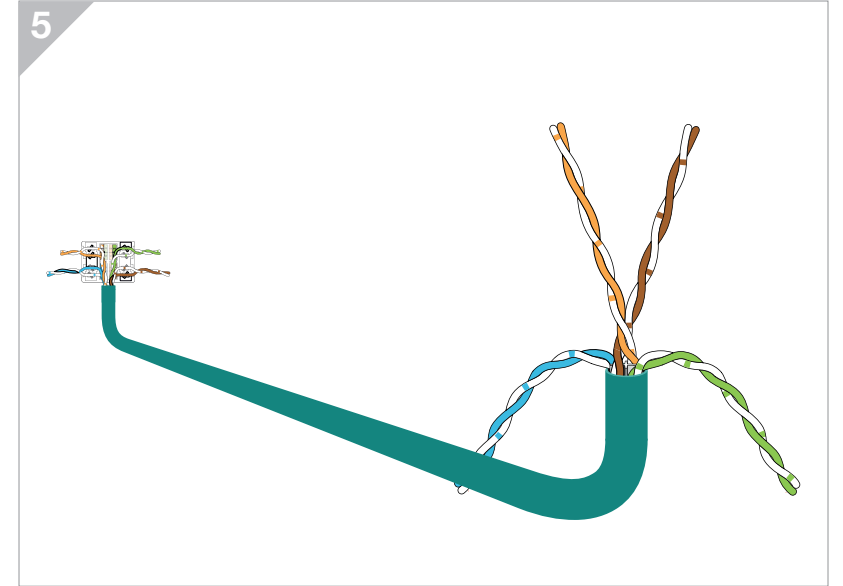
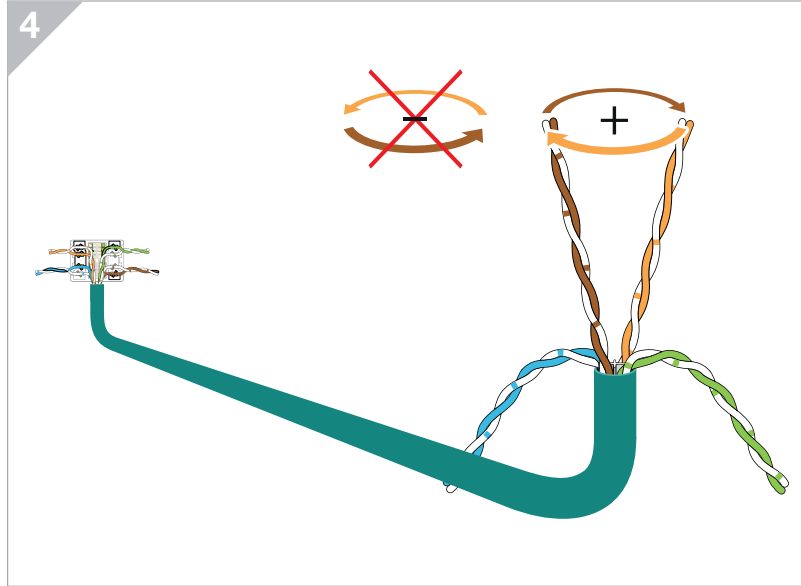



x1

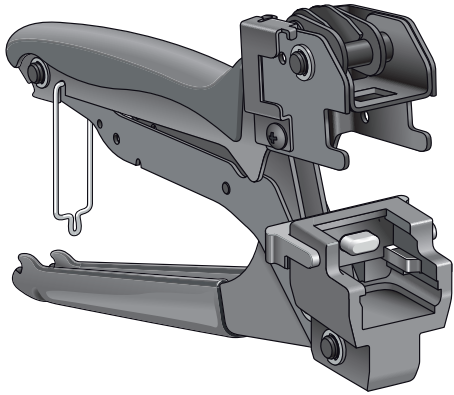

Cat 5e
&
Cat 6

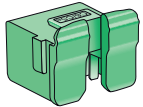

x1

Cat 6A

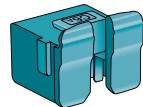

x1

Ref. TLQTB3



CAUTION

RISK OF HAND INJURY

- Tool has parts that can pinch/cut.
- Keep hands and fingers clear use protective cap and close the tool

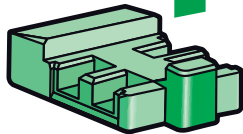
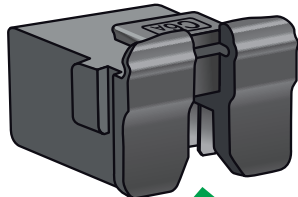

- Use protective cap

**Failure to follow
these instructions
may result in injury**

1

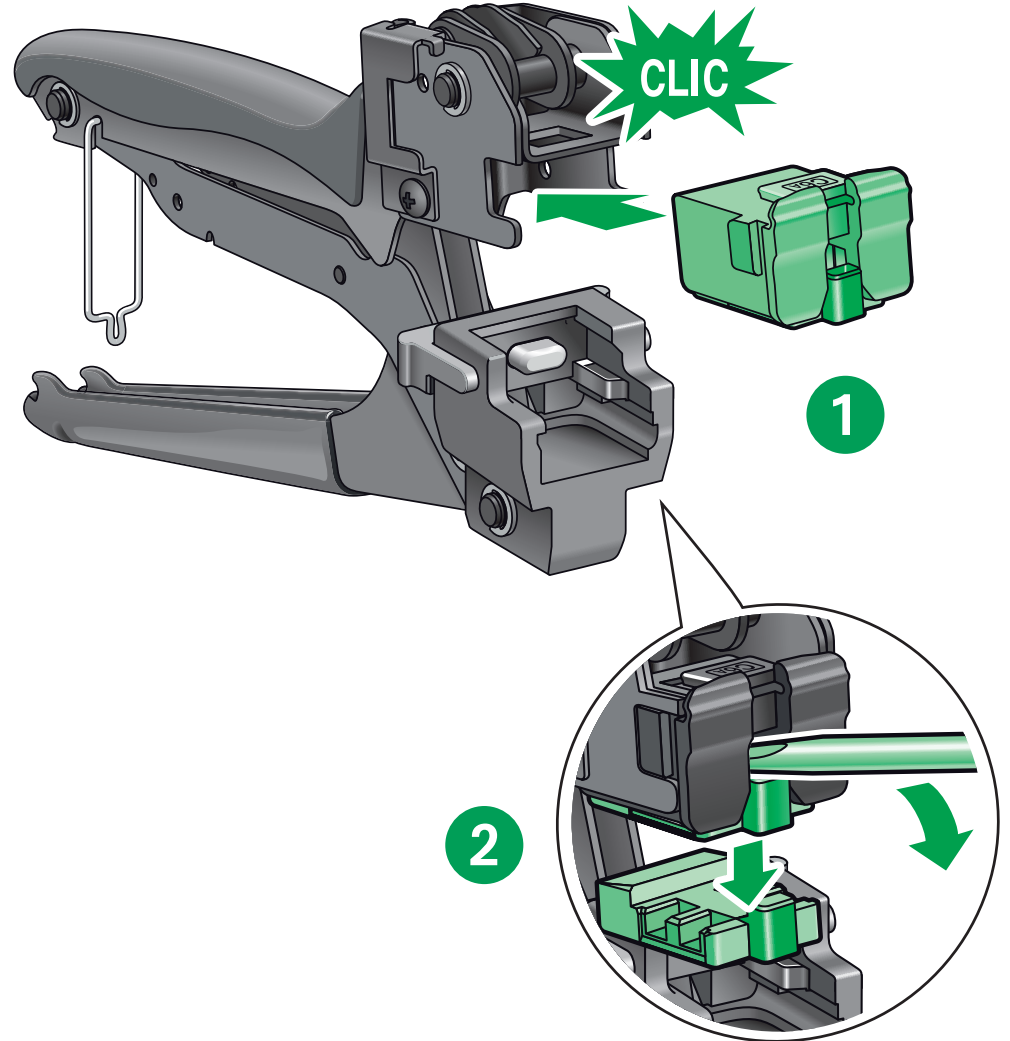

2



x1

Cat 5e & Cat 6

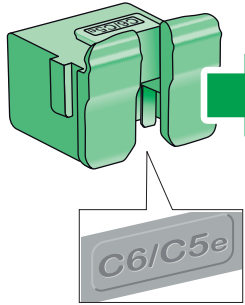

Cat 5e & Cat 6

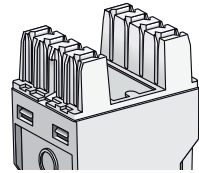

x1

Cat 6A

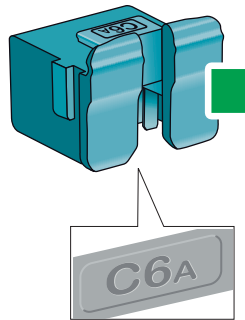

Cat 6A



Ref. TLQTB3CM

3

Replacement of cutting module

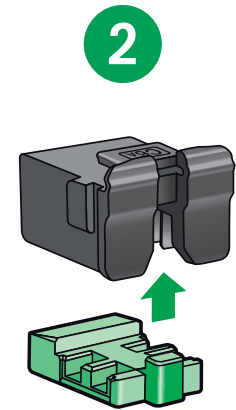
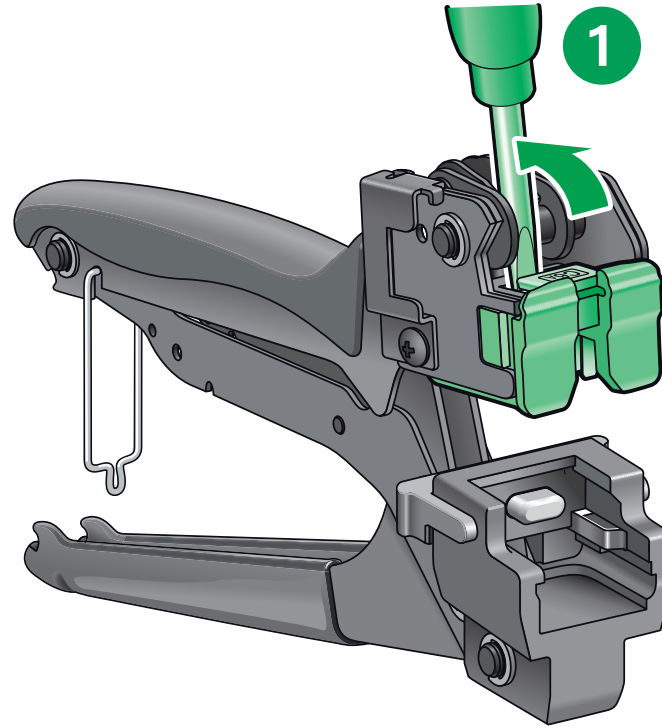

4

Mount of the cutting module

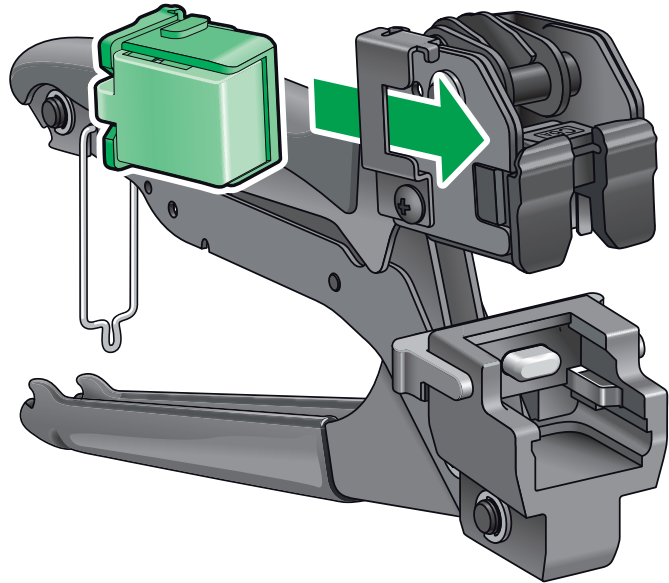

5

Dismount the cutting module

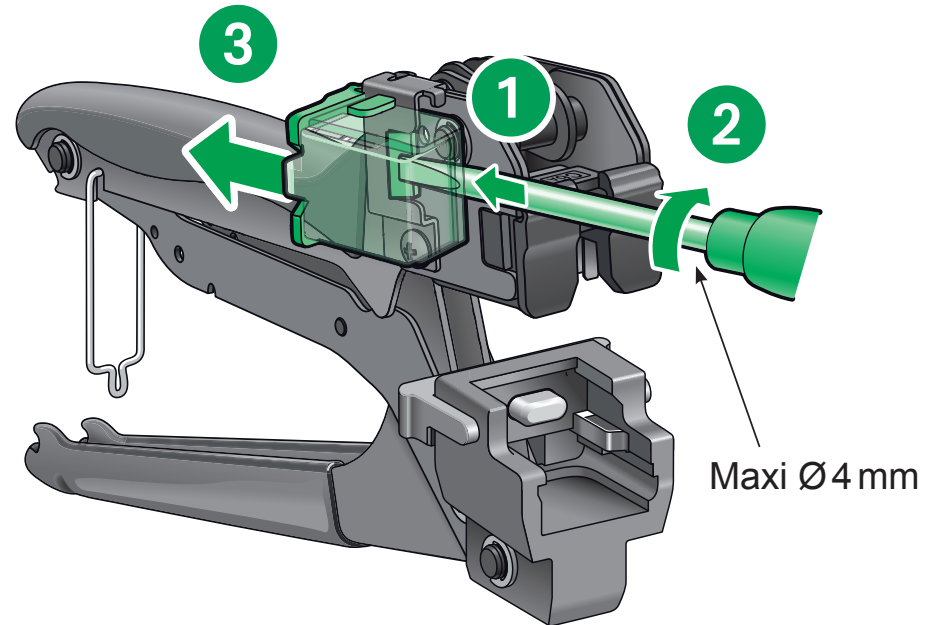

6

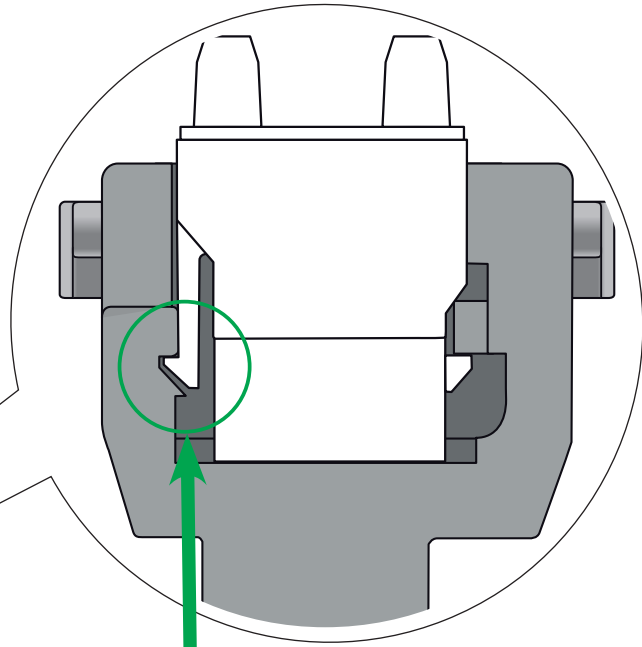
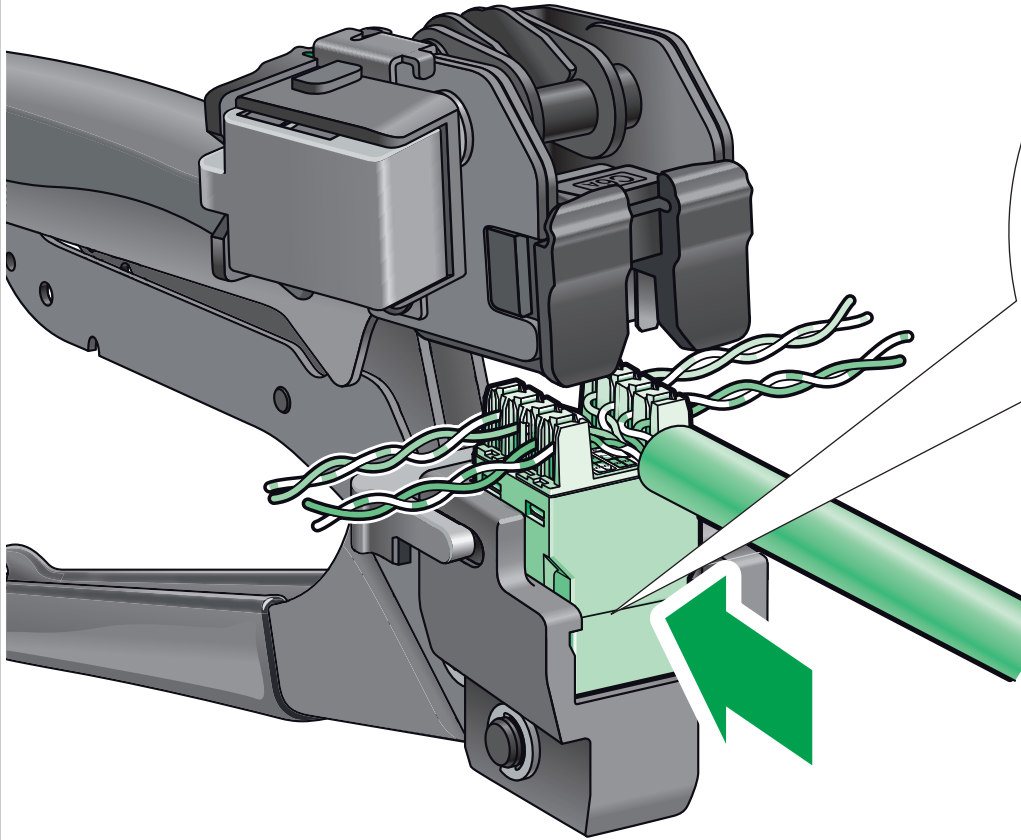

Cat 5e & 6

Cat 6A

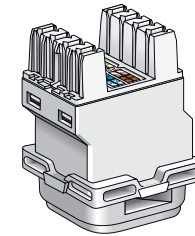

30M

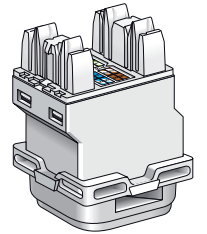

30M

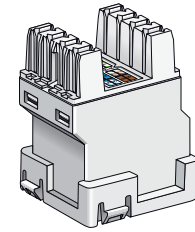

40M

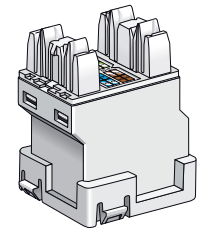

40M

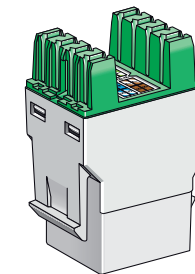

S110

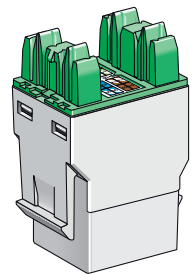

S110

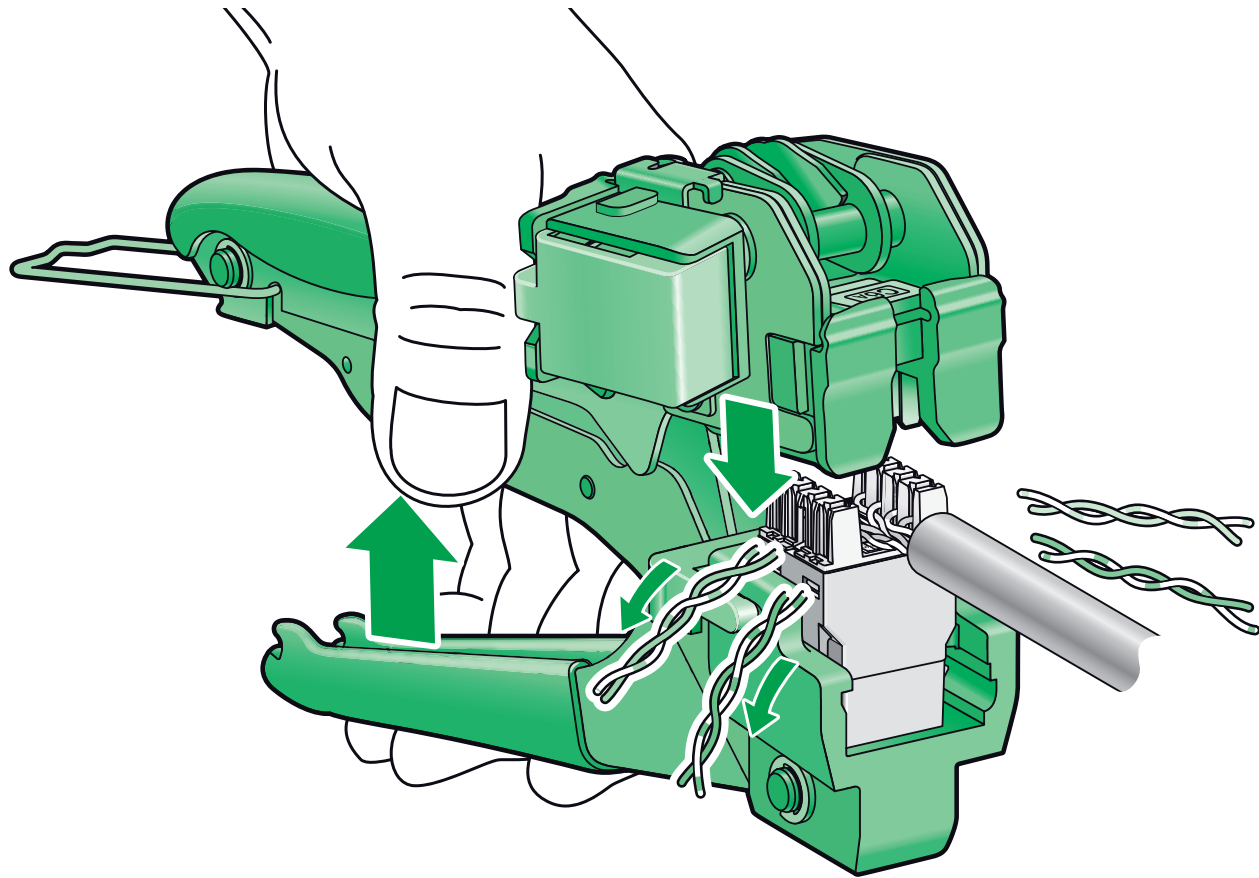

8

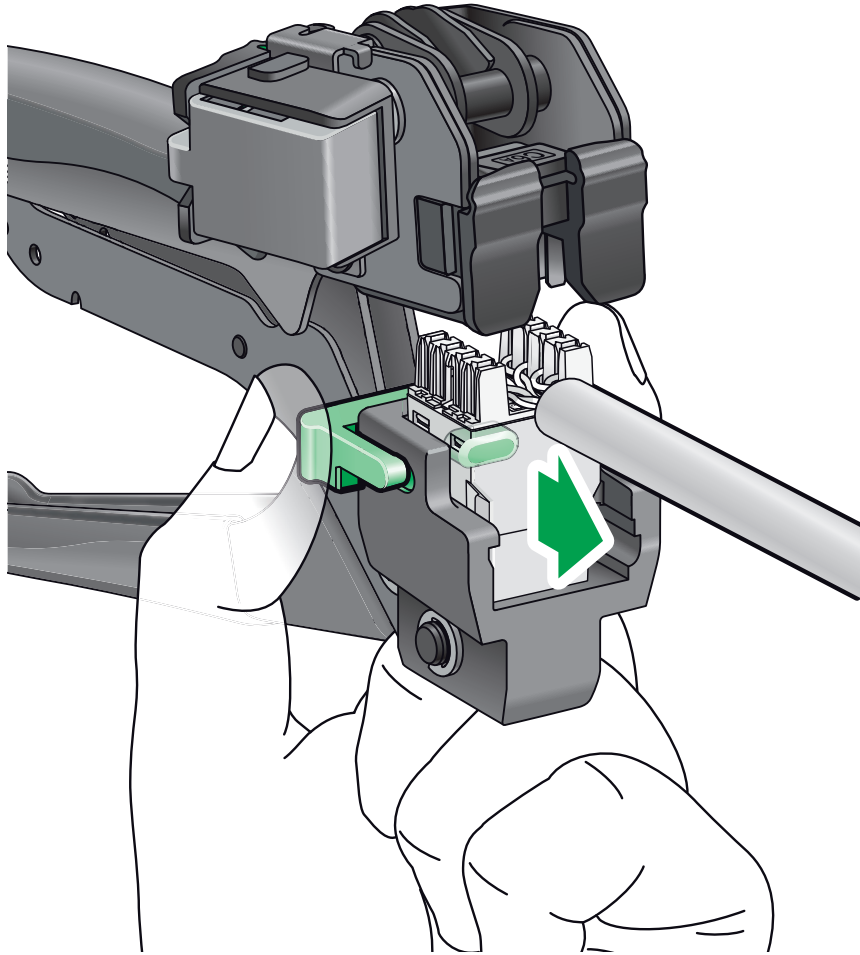

CAUTION

RISK OF HAND INJURY

- Tool has parts that can pinch/cut.
- Keep hands and fingers clear use protective cap and close the tool

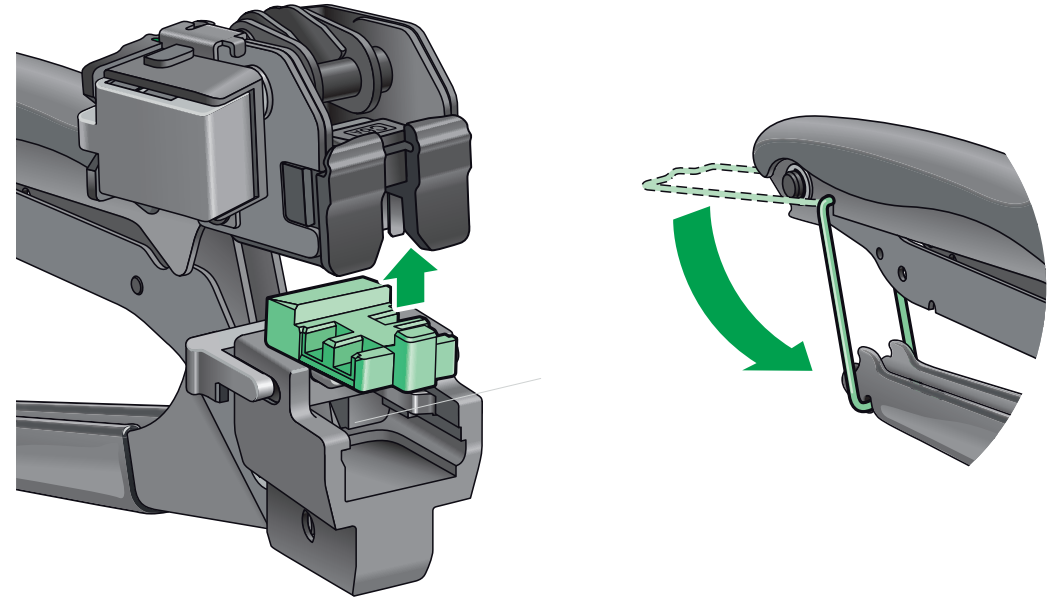

**Failure to follow these instructions
may result in injury**

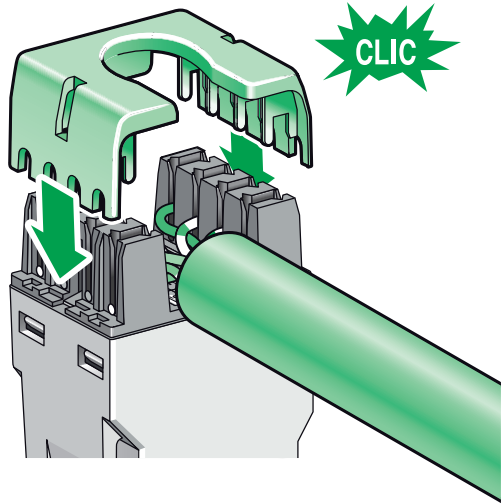
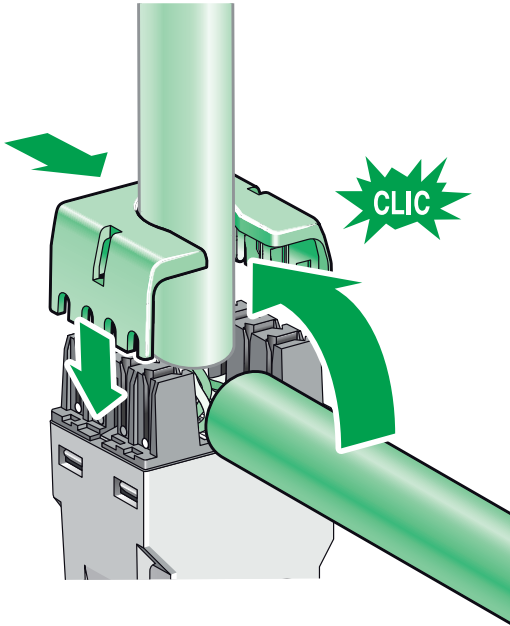
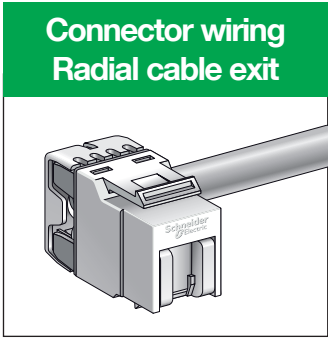
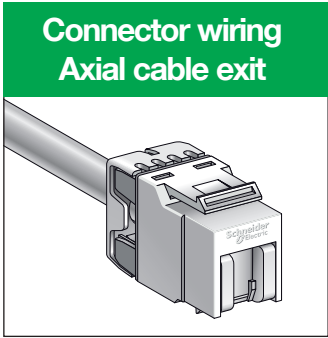

With punch down tool

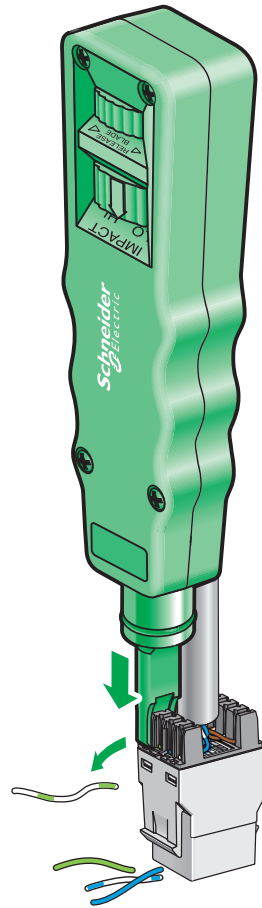

Cat 5e & 6

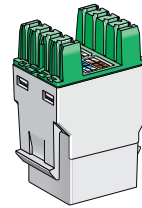

S110

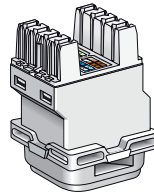

30M

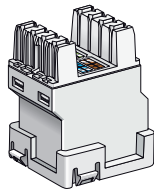

40M

Cat 6A

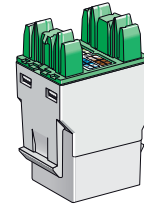

S110

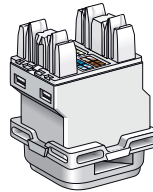

30M

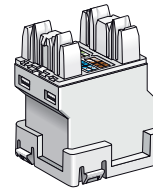

40M

Connector wiring
Axial cable exit

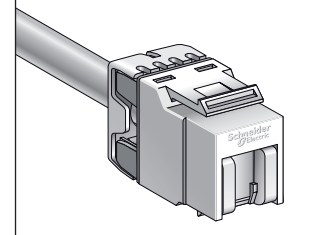

Connector wiring
Radial cable exit

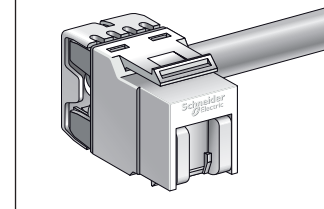

A

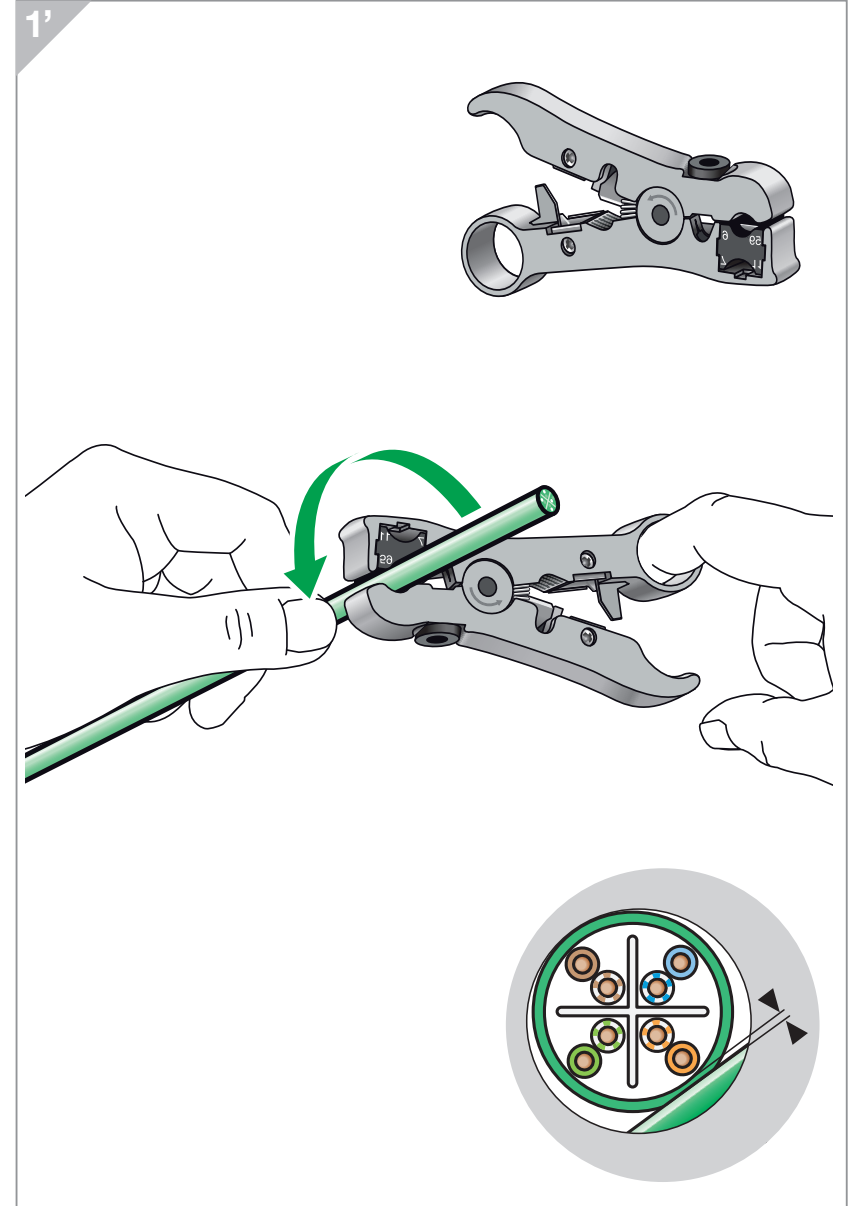
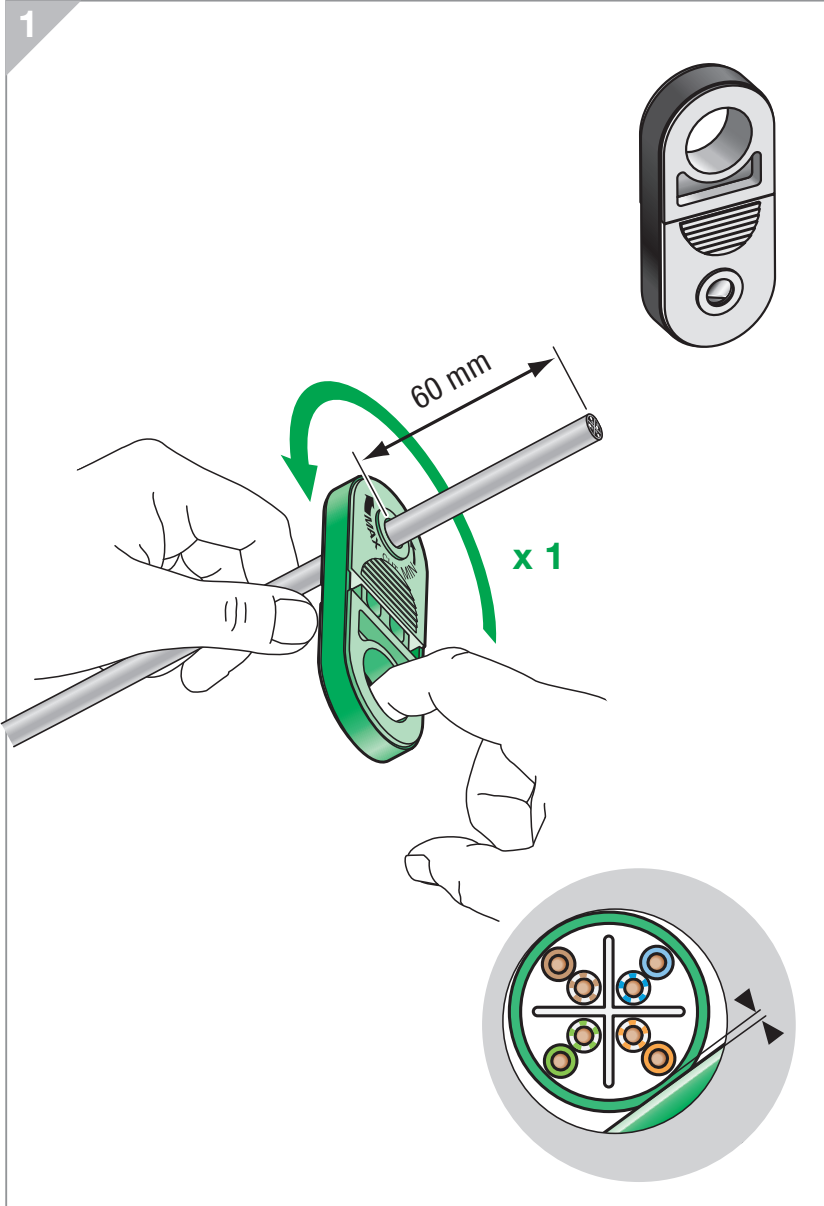
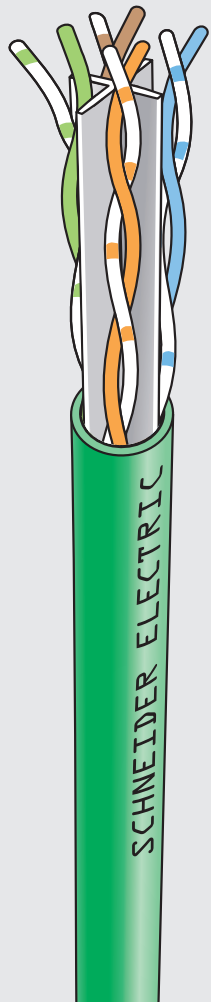

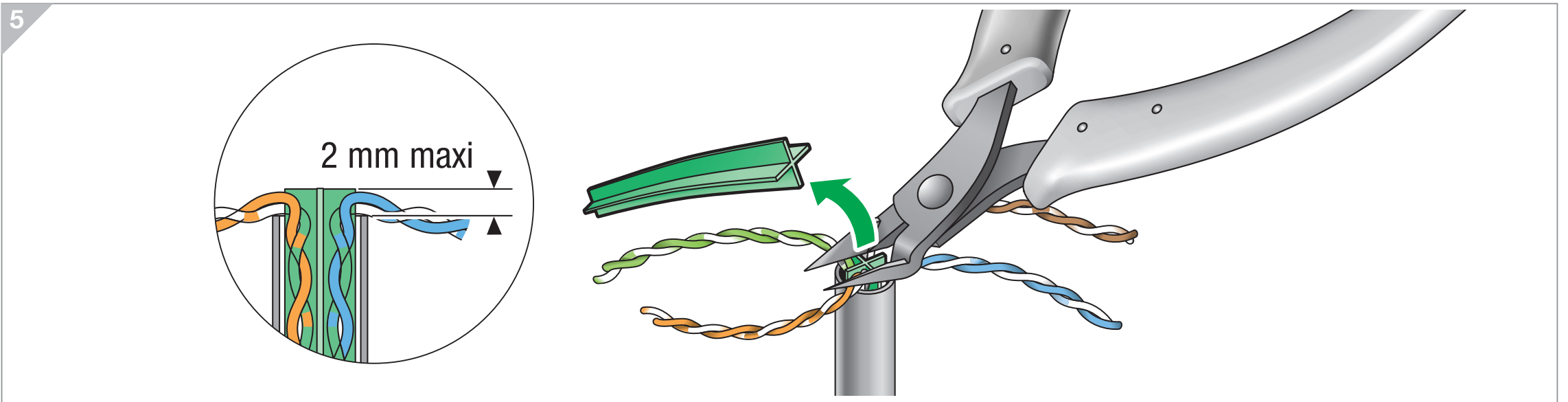
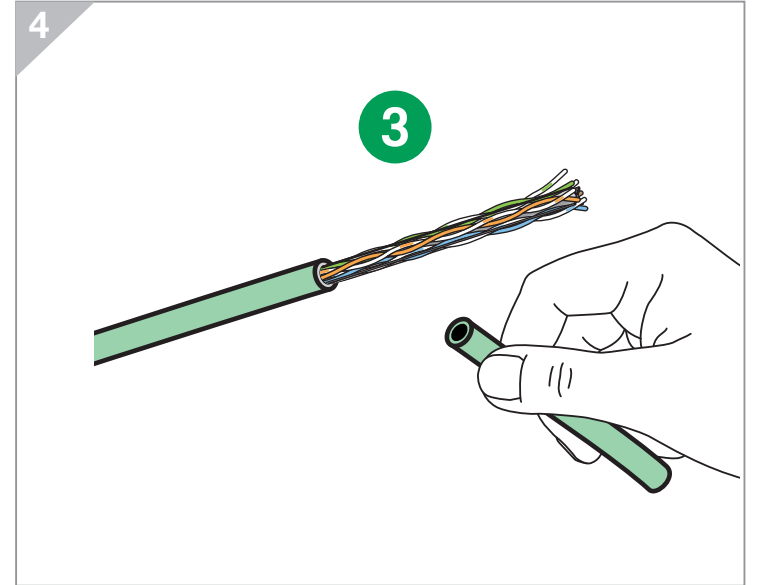
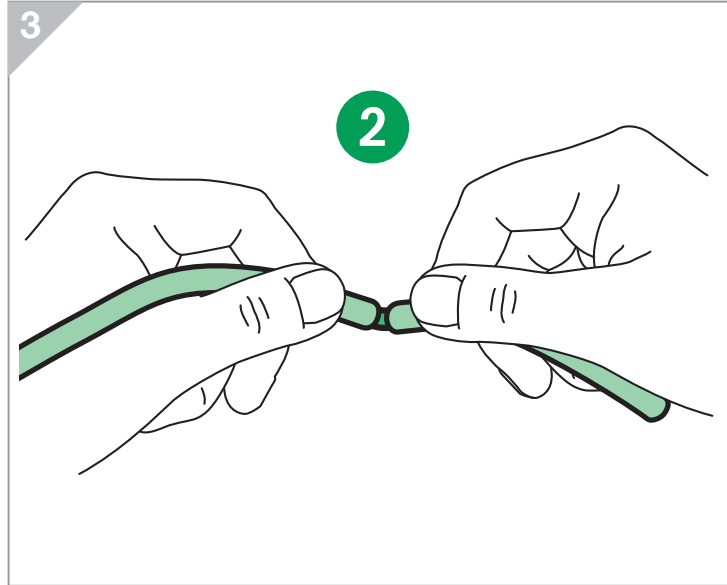
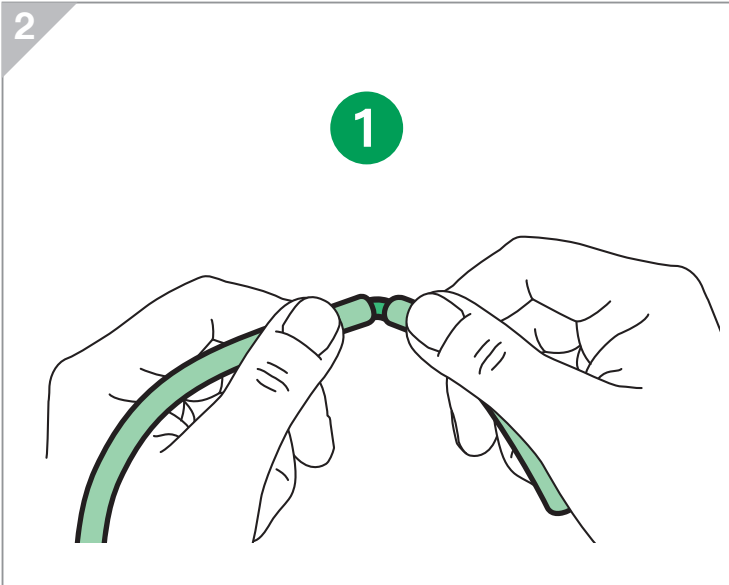

B Convention B

Cat 5e & 6

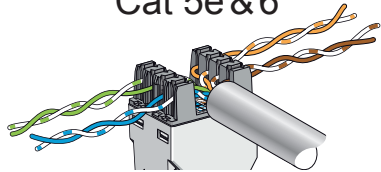

Cat 6A

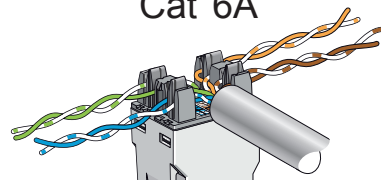

EIA-TIA 568B (100Ω)

3	3	2	2
6	6	1	1
A	B	B	A
4	4	7	7
5	5	8	8

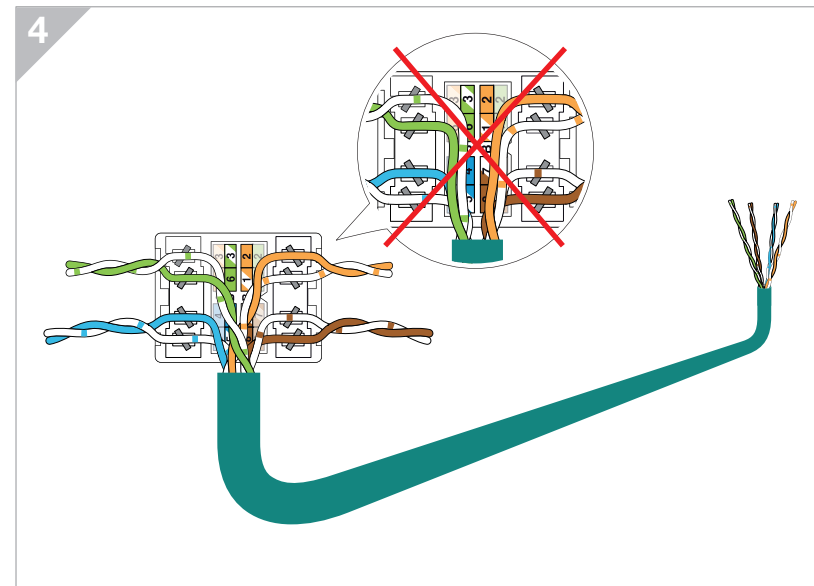
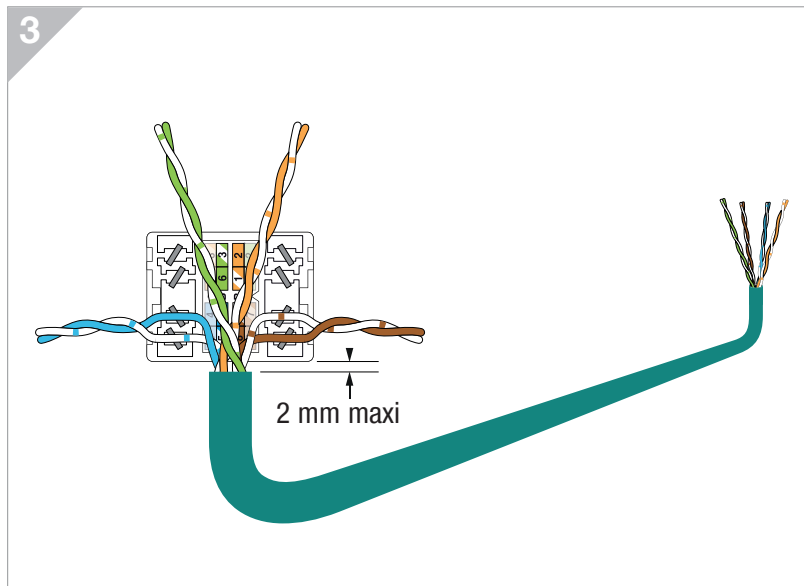
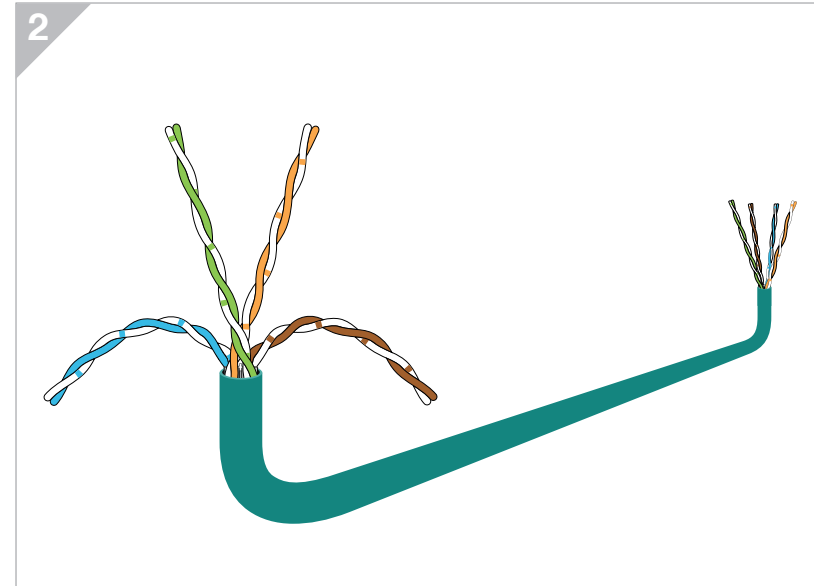
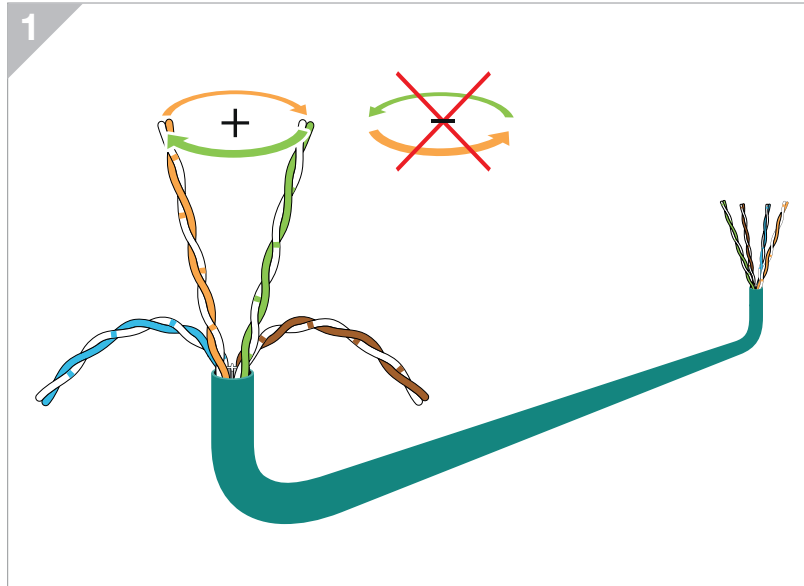

B

Convention B

Cat 5e & 6

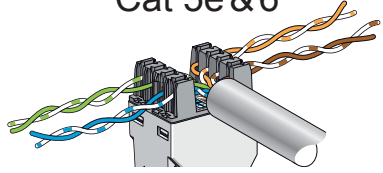

Cat 6A

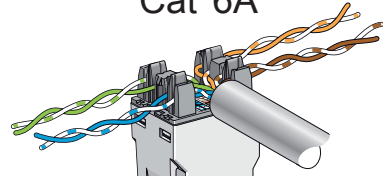

EIA-TIA 568B (100Ω)

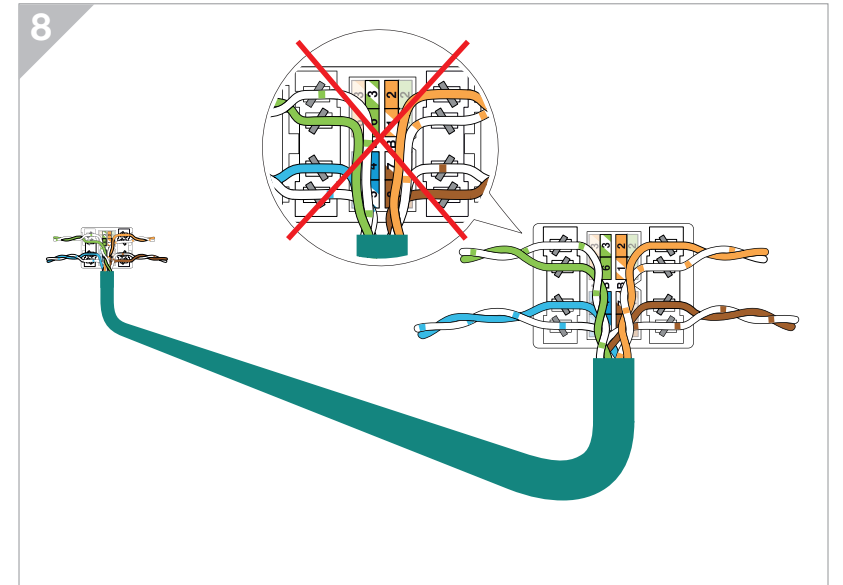
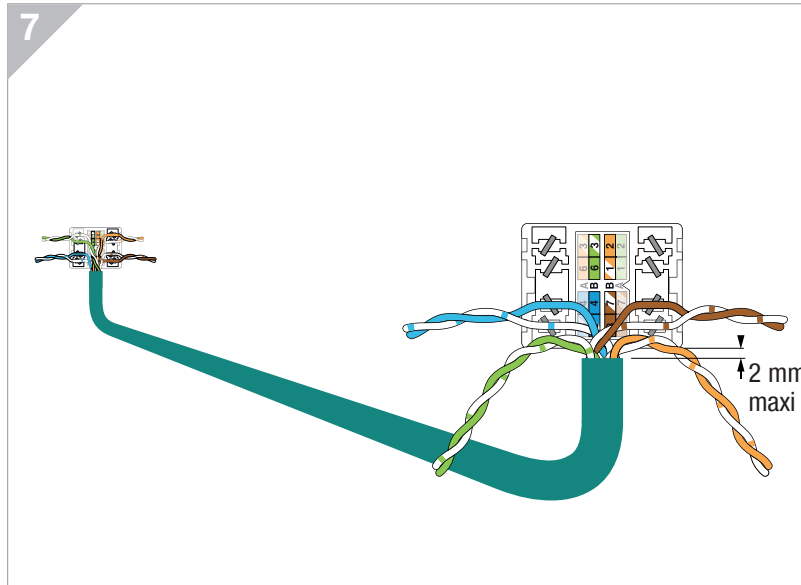
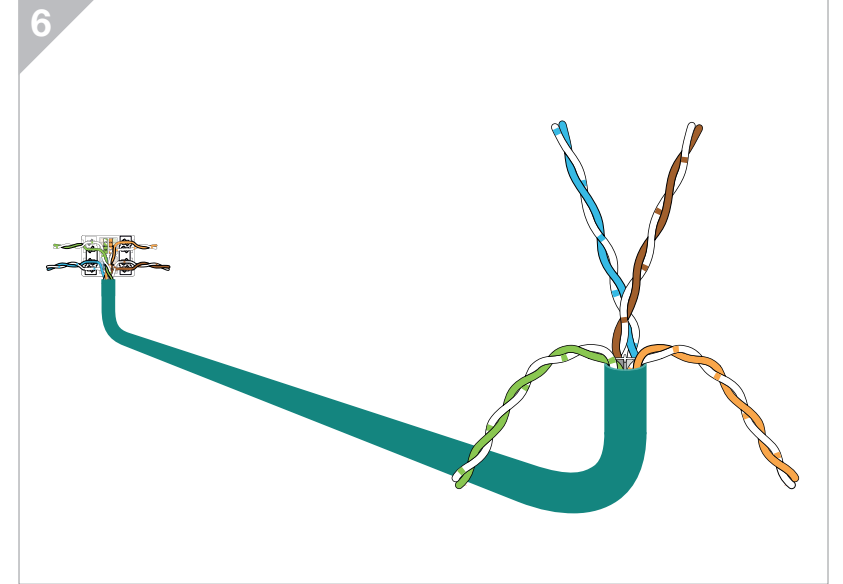
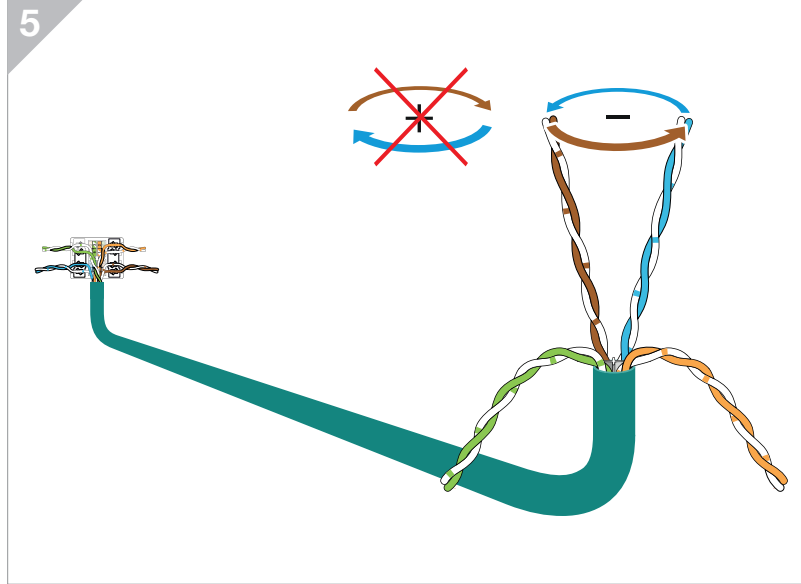

B Convention A

Cat 5e & 6

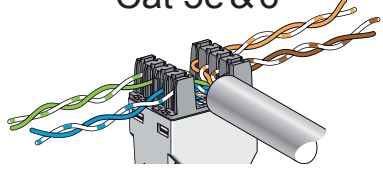

Cat 6A

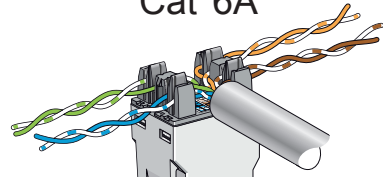

EIA-TIA 568A (100Ω)

5	4	A	6	3
5	4	B	6	3
8	7	B	1	2
8	7	A	1	2

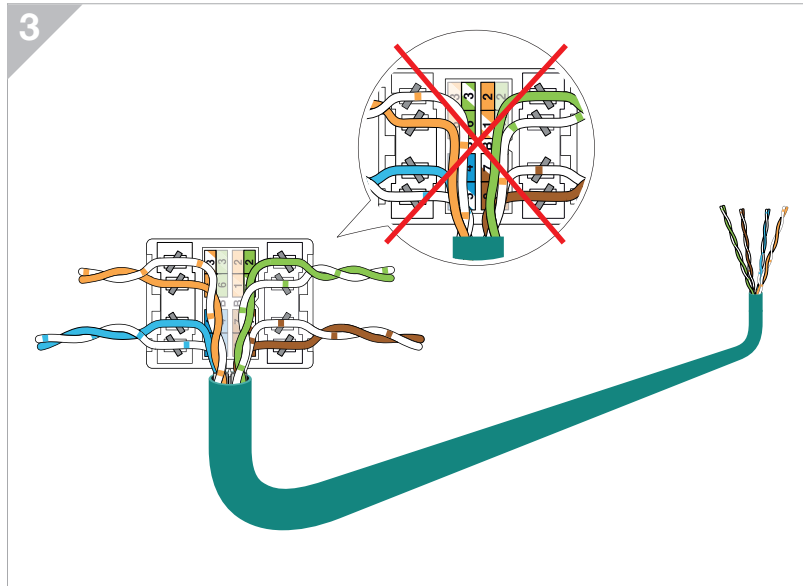
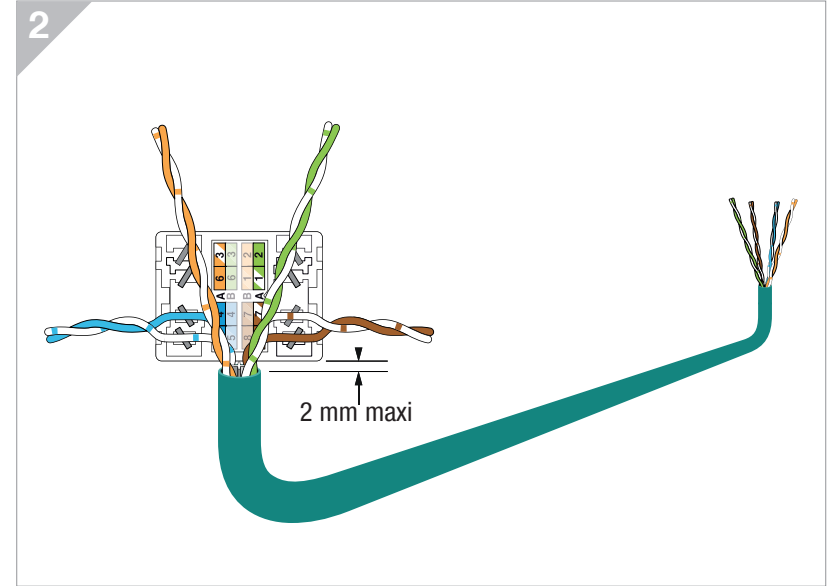
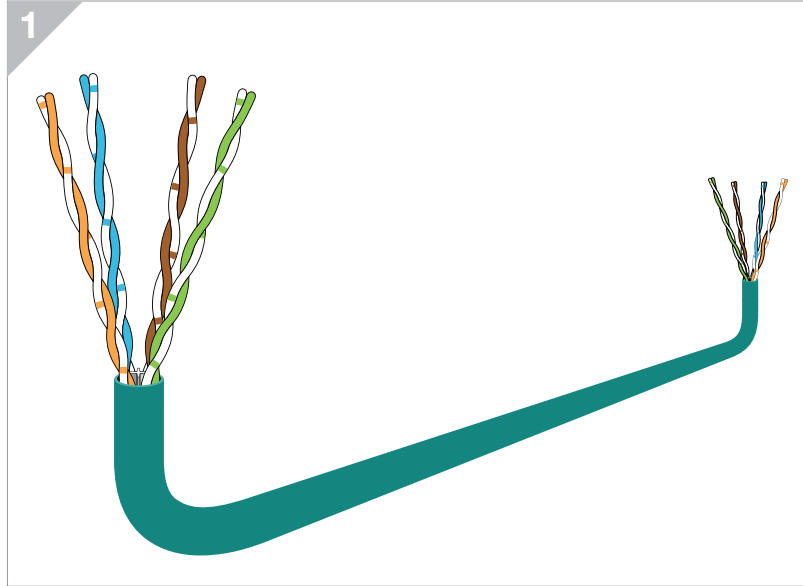

B Convention A

Cat 5e & 6

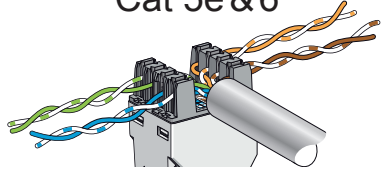

Cat 6A

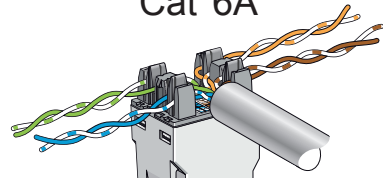

EIA-TIA 568A (100Ω)

5	4	A	6	3	B	6	3
8	7	B	1	2	A	1	2
8	7	A	1	2	B	1	2

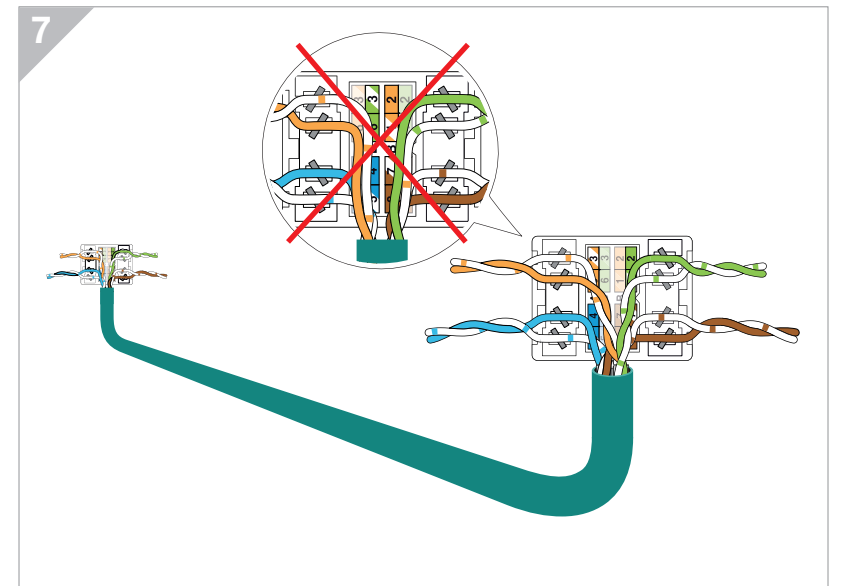
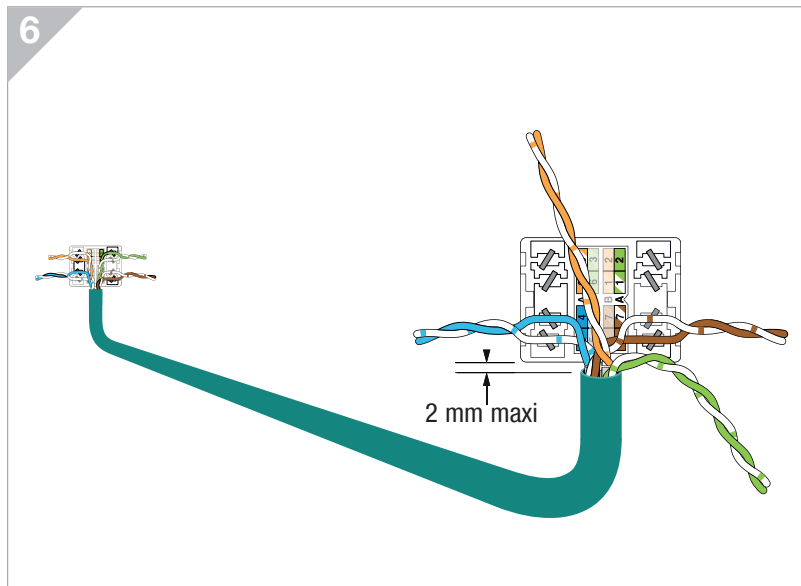
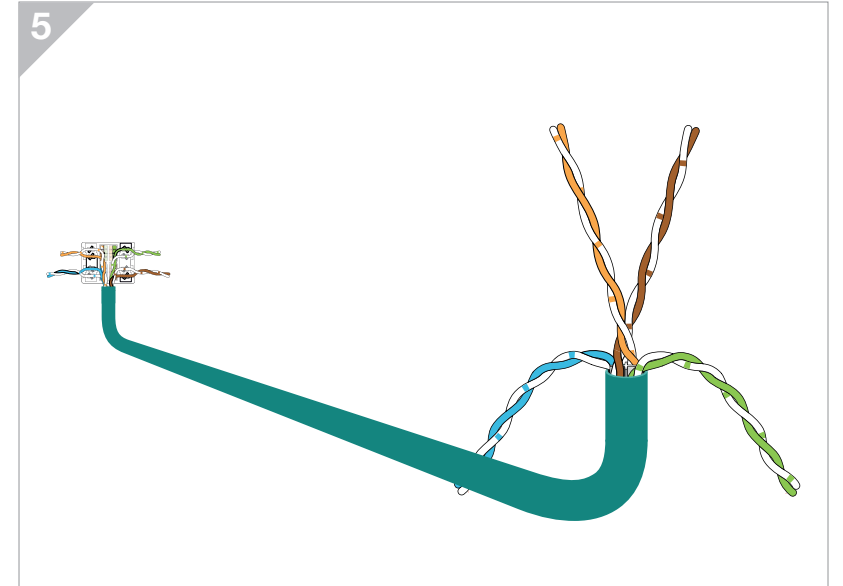
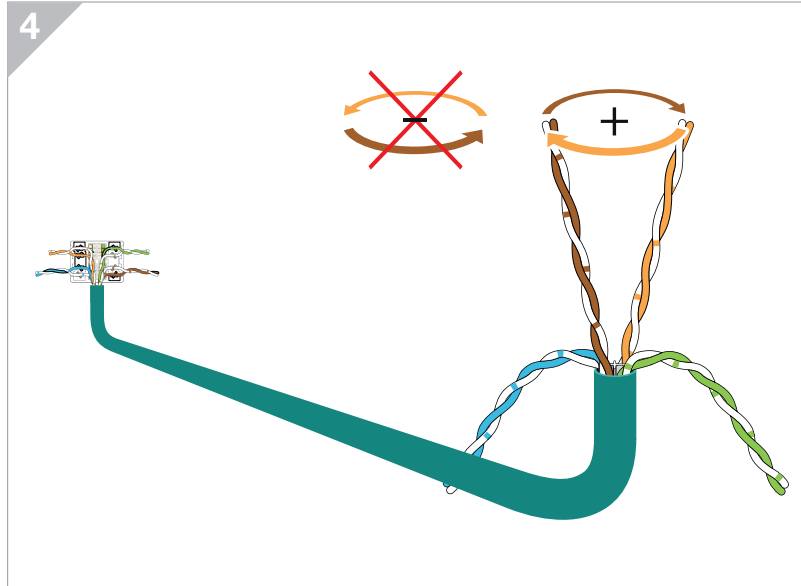



x1

Ref. ACTTRJ45PDT

CAUTION

RISK OF HAND INJURY

- This product must be connected with punch tool ACTTRJ45PDT
- Do not hold the RJ45 in hand during connection
- This product must be installed, connected and used in compliance with prevailing standard and/or installation regulations

Failure to follow these instructions may result in injury

1

Cat 5e & 6

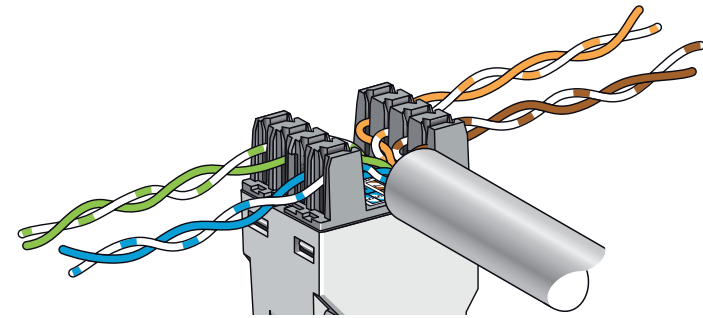

Cat 6A

