



## Main

|                             |   |
|-----------------------------|---|
| Range of product            | Modicon Momentum automation platform                          |
| Product or component type   | Modbus I/O module base  |
| Group of channels           | 1 group of 3 discrete outputs<br>1 group of 6 discrete inputs |
| Discrete input number       | 6   |
| Discrete output number      | 3   |
| Number of port              | 1   |
| Communication port protocol | Modbus  |
| Wiring mode                 | 2 or 4 wires  |

## Complementary

|                              |  |
|------------------------------|--|
| Discrete input logic         | Positive   |
| Discrete input voltage       | 0...132 V AC<br>120 V AC 47...63 Hz  |
| Input overvoltage protection | 200 V  |
| Voltage state 1 guaranteed   | $\geq 79$ V  |
| Voltage state 0 guaranteed   | $\leq 20$ V  |
| Current state 1 guaranteed   | $\geq 5.5$ mA  |
| Current state 0 guaranteed   | $\leq 1.9$ mA  |
| Discrete output logic        | Positive   |
| Discrete output voltage      | 120 V 47...63 Hz   |
| Discrete output current      | 0.5 mA per point<br>1.5 mA per module  |
| Voltage drop                 | $< 1.5$ V 0.5 A at state on  |
| Leakage current              | 1.9 mA AC 120 V  |
| Surge current                | $\geq 30$ mA   |
| Response time                | $< 12.3$ ms 60 Hz from state 1 to state 0 input circuit<br>$< 12.3$ ms 60 Hz from state 1 to state 0 output circuit<br>$< 12.5$ ms 60 Hz from state 0 to state 1 input circuit<br>$< 12.5$ ms 60 Hz from state 0 to state 1 output circuit |
| Communication port support   | RS485  |
| Transmission rate            | 19200 bit/s<br>9600 bit/s  |
| Data format                  | 7-bit ASCII<br>8-bit RTU   |
| Number of addresses          | 0...247  |
| Port timeout                 | 150 ms   |
| Marking                      | CE   |
| Electrical connection        | 2 connectors for removable terminal blocks   |
| Current consumption          | 125 mA 120 V   |
| Product weight               | 0.24 kg  |

## Environment

|                                       |   |
|---------------------------------------|---|
| product certifications                | CSA<br>UL                                       |
| protective treatment                  | TC  |
| resistance to electrostatic discharge | 4 kV contact IEC 801-2<br>8 kV on air IEC 801-2 |

The information provided in this documentation contains general descriptions and/or technical characteristics of the performance of the products contained herein. This documentation is not intended as a substitute for and is not to be used for determining suitability or reliability of these products for specific user applications. It is the duty of any such user or integrator to perform the appropriate and complete risk analysis, evaluation and testing of the products with respect to the relevant specific application or use thereof. Neither Schneider Electric Industries SAS nor any of its affiliates or subsidiaries shall be responsible or liable for misuse of the information contained herein.

|                                       |                                |
|---------------------------------------|--------------------------------|
| resistance to electromagnetic fields  | 10 V/m 80...1000 MHz IEC 801-3 |
| ambient air temperature for operation | 0...60 °C                      |
| ambient air temperature for storage   | -40...85 °C                    |
| relative humidity                     | 95 % without condensation      |
| operating altitude                    | <= 5000 m                      |

## Offer Sustainability

|                                  |   |
|----------------------------------|---|
| Sustainable offer status         | Green Premium product   |
| RoHS (date code: YYWW)           | Compliant - since 1350 - Schneider Electric declaration of conformity |
| REACH                            | Reference not containing SVHC above the threshold                     |
| Product environmental profile    | Available   |
| Product end of life instructions | Available   |

## Standard Adapter on a Discrete VAC Base

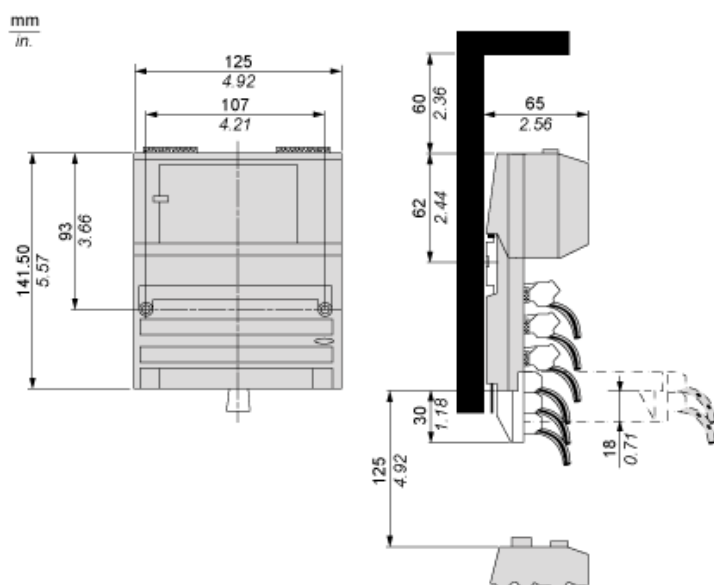

## Mounting on a Wall

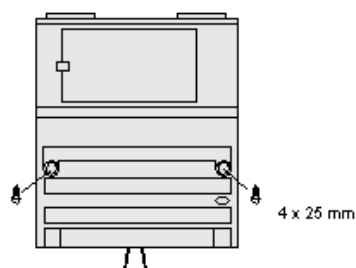

## External Wiring Diagram

### 2-Wire Devices

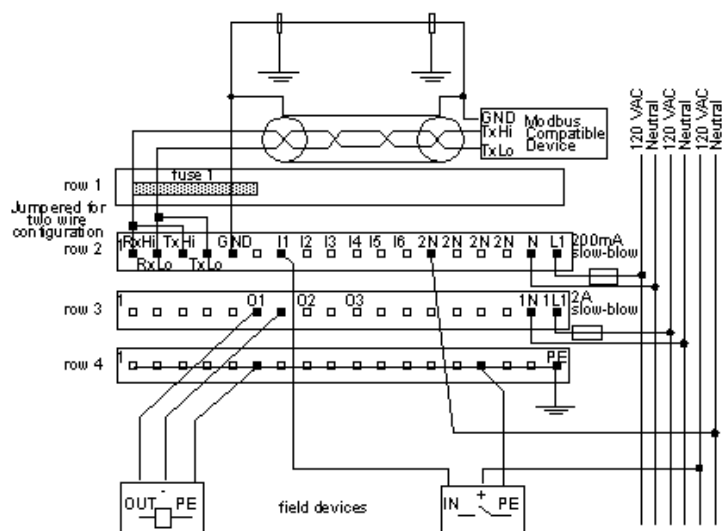

## Internal Pin Connections

Rows 1 through 3 show the internal connections between terminals on the I/O base. Row 4 shows the internal connections on the optional busbar.

