

Back-UPS™ SX3650CI User Manual

Inventory

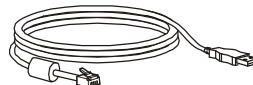
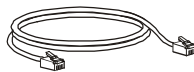
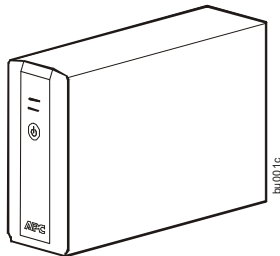

Important Safety Instructions

SAVE THESE INSTRUCTIONS - This manual contains important instructions that should be followed during installation and maintenance of the UPS and batteries.

- This UPS is intended for indoor use only.
- Connect the UPS power cable directly to a wall outlet. Do not use surge protectors or extension cords
- When grounding cannot be verified, disconnect the equipment from the AC power outlet before installing or connecting to other equipment. Reconnect the power cord after all connections are made.

⚠ CAUTION

RISK OF HYDROGEN SULPHIDE GAS AND EXCESSIVE SMOKE

- Replace the battery at least every 5 years or at the end of its service life, whichever is earlier.
- Replace the battery immediately when the UPS indicates battery replacement is necessary.
- Replace batteries with the same number and type of batteries as originally installed in the equipment.
- Replace the battery immediately when the UPS indicates a battery over-temperature condition, or when there is evidence of electrolyte leakage. Power off the UPS, unplug it from the AC input, and disconnect the batteries. Do not operate the UPS until the batteries have been replaced.

Failure to follow these instructions can result in minor or moderate injury and equipment damage.

For the recycling battery information, please go to apc.com/recycle

- CAUTION: Servicing of batteries should be performed or supervised by personnel knowledgeable about batteries and the required precautions.
- CAUTION: Do not dispose of batteries in a fire. The batteries may explode.
- CAUTION: Do not open or mutilate batteries. Released material is harmful to the skin and eyes. It may be toxic.
- CAUTION: Before replacing batteries, remove conductive jewelry such as chains, wrist watches, and rings. High energy through conductive materials could cause severe burns.
- CAUTION: Failed batteries can reach temperatures that exceed the burn thresholds for touchable surfaces.
- CAUTION: A battery can present a risk of electrical shock and high short-circuit current. The following precautions should be observed when working on batteries:
 - Disconnect the charging source prior to connecting or disconnecting battery terminals.
 - Do not wear any metal objects including watches and rings.
 - Do not lay tools or metal parts on top of batteries.
 - Use tools with insulated handles.
 - Wear rubber gloves and boots.
 - Determine if battery is either intentionally or inadvertently grounded. Contact with any part of a grounded battery can result in electric shock and burns by high short-circuit current. The risk of such hazards can be reduced if grounds are removed during installation and maintenance by a skilled person.
- This manual can be downloaded from APC by Schneider Electric Website www.apc.com

Place and Power On

- Place the Back-UPS to avoid:
 - Direct sunlight
 - Excessive heat
 - Excessive moisture

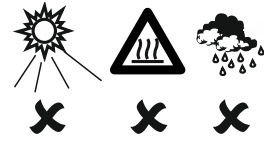

- Connect the battery by pulling the battery connector handle down, and then pushing it into the unit.

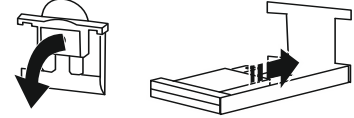

- Plug the Back-UPS SX3650CI power cord directly into a wall outlet; not into a surge protector or power strip.
 - Press the ON/OFF button to turn on the unit.
 - The green “Power On” indicator confirms that the Back-UPS is on and ready to provide protection.
 - The Back-UPS should charge for at least 10 hours to be sure sufficient runtime. The unit is being charged whenever it is connected to AC power, whether the unit is turned ON or OFF.

- ON/OFF button and LED status indicator
- Battery connector
- Circuit breaker
- Input power outlet
- Battery and surge protected outlets

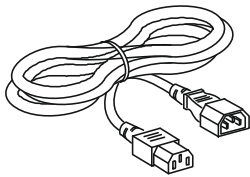

IEC jumper cable for PC connection

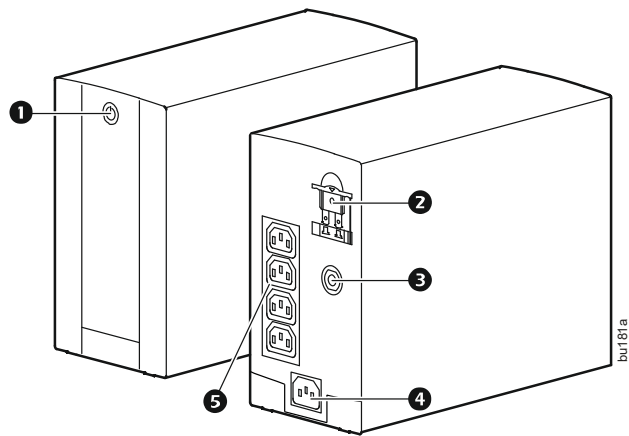

Adjust Transfer Voltage and Sensitivity Settings

Automatic Voltage Regulation boosts the AC voltage when it drops below specified levels. This allows the equipment plugged into the unit to operate during low voltage conditions, conserving the battery power in the event of a power cut.

The Back-UPS will switch to battery power if the input voltage level becomes too low for the Automatic Voltage Regulation to compensate, or if the AC power is distorted.

If the Back-UPS switches to battery power too frequently or too infrequently, adjust the transfer voltage and sensitivity settings:

- Be sure the Back-UPS is off. Plug it into AC power.
- Press and hold the ON/OFF button until the LED repeatedly flashes. The unit is now in Program Mode.
- Release the button. The LED will indicate the current setting by flashing once, twice, or three times per second, and emitting audible beeps.
- Press the ON/OFF button within two seconds to change the setting. Continue pressing the button until the desired setting is reached. If the button is not pressed within five seconds, the Back-UPS will exit the Program Mode.

No-load Shutdown

If the UPS is operating on battery power and detects that the connected equipment is using less than 15 W of energy for more than 15 minutes, it will shut down to conserve energy.

When the UPS is reconnected to AC power, the UPS will automatically switch on.

Note: Even if the UPS is OFF, it is still helping protect connected equipment from power surges.

LED Flashing	Audible Indicator	Voltage Sensitivity Setting	Input Voltage Range	No-load Shutdown	Description
Once per second	None	Low	140-300	Disabled	The Back-UPS will switch to battery power less often.
Once per second	4 beeps per second	Low	140-300	Enabled	The Back-UPS will switch to battery power less often.
Twice per second	None	Medium	140-300	Disabled	Use when the input AC power is normal, without any fluctuation in voltage levels.
Twice per second	4 beeps per second	Medium (factory default)	140-300	Enabled	Use when the input AC power is normal, without any fluctuation in voltage levels.
Three times per second	None	High	150-290	Disabled	The Back-UPS will switch to battery power during any small fluctuation in voltage.
Three times per second	4 beeps per second	High	150-290	Enabled	The Back-UPS will switch to battery power during any small fluctuation in voltage

Status Indicators and Alarms

LED Status Indicator	Audible Alarm	Condition
On	Off	On-line - UPS is supplying conditioned AC power to the load
On (Off during 4 beeps)	4 beeps repeated every 30 seconds	On-Battery - Back-UPS is supplying battery power
Flashing	Rapid Beeping (every 1/2 second)	Low Battery Alert - The UPS has 1.5 minutes of remaining battery power
Flashing	Constant tone	Bad Battery Detected - Battery needs to be charged, or is at end of life.
Off	Short beep every 4 seconds	Low Battery Shutdown - During On Battery operation the battery power was almost completely exhausted
Off	Constant Tone	On Battery Overload - Connected equipment requires more power than provided by the Back-UPS battery.
On	Constant Tone	On Line Overload - The power drawn by the connected equipment exceeds the power capacity of the battery backup
Flashing	Chirp every 2 seconds	Charger Status - Back-UPS has experienced an internal problem, but continues to power the load. Contact Schneider Electric IT (SEIT) Technical Support.
Off	Constant Tone	Charger Error - Back-UPS has detected an internal problem, and is no longer powering the load. Contact SEIT Technical Support

Specifications

Input	Voltage / Frequency	230 VAC nominal / 45-65 Hz
	Brownout Transfer / Over-voltage Transfer	160 ±8% VAC, typical / 280 VAC, typical
Output	UPS Capacity (total)	500 VA / 300 W
	Voltage On Battery	230 Vac rms
	Frequency - On Battery	50 Hz, 60 Hz ±1 Hz
	Transfer Time	50 Hz: 6ms typical, 10ms maximum 60 Hz: 5ms typical, 8ms maximum
Protection and Filter	AC Surge Protection	273 joules
	AC Input	Resettable circuit breaker

Battery	Type (maintenance-free)	Sealed, lead-acid battery
	Average Life	2 - 5 years depending on the number of discharge cycles and environmental temperature
	Typical Recharge Time	10 Hours
Physical	Net Weight	5.1 kg
	Dimensions (H x W x D)	18.55 cm x 11.5 cm x 21.3 cm
Environmental	Operating Temperature:	0° to 40°C (32° to 104° F)
	Storage temperature	-15° to 45°C (5° to 113°F)
	Humidity	0 to 95% relative humidity, non-condensing
	Pollution Degree	2
	International Protection Code	IP20
Electrical	Overvoltage category	II
	Applicable power grid distribution system	TN Power system
	Applicable standards	IEC 62040-1

Troubleshooting and Service

- Consult the Troubleshooting from the Schneider Electric Web site, www.apc.com.
- If the problem persists, contact Schneider Electric IT (SEIT) Customer Support through the Schneider Electric Web site, www.apc.com.
 - Note the model number and serial number and the date of purchase. The model and serial numbers are located on the rear panel of the unit and are available through the LCD display on select models.
 - Call SEIT Customer Support and a technician will attempt to solve the problem over the phone. If this is not possible, the technician will issue a Returned Material Authorization Number (RMA#).
 - If the unit is under warranty, the repairs are free.
 - Service procedures and returns may vary internationally. Refer to the Schneider Electric Web site for country specific instructions.
- Prepare to troubleshoot the problem over the phone. If this is not successful, and the unit is still under warranty, the Technical Support Representative will provide all necessary information to return the unit for replacement.

Battery Replacement

The battery in the Back-UPS SX3650CI is not user-replaceable. Contact SEIT Technical Support for a list of authorized service centers near you.

Warranty

Register your product on-line. <http://warranty.apc.com>

The standard warranty is two (2) years from the date of purchase. SEIT standard procedure is to replace the original unit with a factory reconditioned unit. Customers who must have the original unit back due to the assignment of asset tags and set depreciation schedules must declare such a need at first contact with an SEIT Technical Support representative. SEIT will ship the replacement unit once the defective unit has been received by the repair department, or cross-ship upon the receipt of a valid credit card number. The customer pays for shipping the unit to SEIT. SEIT pays ground freight transportation costs to ship the replacement unit to the customer.

Schneider Electric IT Customer Support Worldwide

For country specific customer support, go to the Schneider Electric Web site, www.apc.com.