



ET-S transformer

ET-S 15 LED 220-240V

High-frequency electronic transformer (60, 105 and 150 W versions available), operation with 12 V halogen lamps

Product data

General information	
Type Version	-
Lamp Type	LV Halogen
Number of Products on MCB (16A Type B) (Nom)	90
Automatic Restart	Yes
Operating and electrical	
Input Voltage	220 to 240 V
Input Frequency	50 to 60 Hz
Power Factor 100% Load (Nom)	0.98
Mains Voltage Performance (AC)	202...254V
Mains Voltage Safety (AC)	198...264V
Inrush Current Width	0.10 ms
Power Losses (Nom)	0.99 W
Inrush Current Peak (Max)	15 A
Output Voltage	11.3 V
Wiring	
Connector Type Input Terminals	Screw
Color Input Terminals	Orange
Connector Type Output Terminals	Screw
Cable Length From Device to Lamp	1.0 m
Wire Striplength	8.0-9.0 mm
Input Terminal Cross Section	0.75-1.50 mm ²

Output Terminal Cross Section	0.75-1.50 mm ²
System characteristics	
Rated Ballast-Lamp Power	15 W
Temperature	
T-Ambient (Max)	50 °C
T-Ambient (Min)	-20 °C
T-Case Maximum (Max)	65 °C
Approval and application	
Approval Marks	CE marking
Product data	
Full product code	694793910315700
Order product name	ET-S 15 LED 220-240V
EAN/UPC - Product	6947939103157
Order code	913710032479
Numerator - Quantity Per Pack	1
Numerator - Packs per outer box	50
Material Nr. (12NC)	913710032479
Net Weight (Piece)	0.072 kg

ET-S transformer

Dimensional drawing

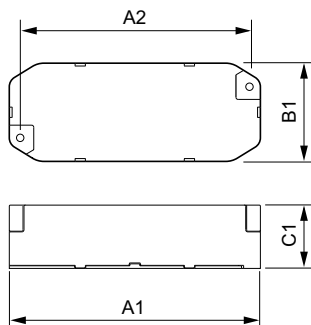

Product	D1	C1	B2	A1	A2	B1
ET-S 15 LED 220-240V	3.4 mm	29.0 mm	23.4 in	115.0 mm	105.0 mm	45.0 mm

ET-S 15 LED 220-240V

