

 **CLIPSAL**<sup>®</sup>

by **Schneider** Electric



Clipsal Saturn Zen<sup>™</sup>  
Three Speed  
Capacitive  
Fan Controller

**Z4060CSFM**  
Series



Installation Instructions

# Table of Contents

<b>WARNING</b> .....	<b>3</b>
<b>1.0 Product Range</b> .....	<b>3</b>
<b>2.0 Description</b> .....	<b>3</b>
<b>3.0 Features</b> .....	<b>3</b>
<b>4.0 Load Compatibility</b> .....	<b>4</b>
4.1 Controlling a Single Fan .....	4
Notice .....	4
4.2 Multiple Fans on a Single Controller .....	4
<b>5.0 Installation Instructions</b> .....	<b>5</b>
5.1 Connecting the Speed Controller .....	5
5.2 Mounting the Controller (Fan Only) .....	5
5.3 Unit Operation .....	5
5.4 Connecting the Speed Controller with a Light Switch .....	5
5.5 Mounting Orientation .....	6
<b>6.0 Compatible Airflow Ceiling Sweep Fans</b> .....	<b>6</b>
<b>7.0 Fan Installation Checklist</b> .....	<b>7</b>
<b>8.0 Electrical Specifications</b> .....	<b>7</b>
<b>9.0 Warranty Statement</b> .....	<b>8</b>

# ⚠ WARNING

## HAZARD OF ELECTRIC SHOCK OR ARC FLASH

This product must only be installed by a licensed electrical contractor or other persons authorised by legislation to work on the fixed wiring of any electrical installation.

**Failure to follow these instructions can result in death, serious injury or equipment damage.**

## 1.0 Product Range

**Z4060CSFM** Fan Speed Controller, 220-240V a.c., 50Hz, 75VA

**Z4061VF3CSF** Fan Speed Controller, 220-240V a.c., 50Hz, 75VA

## 2.0 Description

The Clipsal Z4060CSFM Series Three Speed Fan Controller is designed to provide discreet, linear speed control over small motor loads, including Clipsal's extensive range of Airflow Ceiling Sweep Fans.

The fan controller unit incorporates a three position rotary switch mechanism and a multi-tap capacitor block. This method of control overcomes the motor 'growl' (or buzzing noises) often emitted from fans controlled by other electronic (phase control) speed setters and ensures quiet operation of the fan motor.

The Z4060CSFM Series fan controller is suitable for use in any new installation, but is also retro-fittable, and may be used to replace a similar controller switch in any existing installation. This may also be used to replace many older style 'choke controllers'.

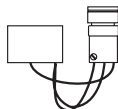

Z4060CSFM  
FAN MECHANISM

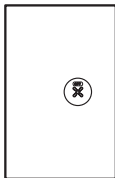

Z4061VF3CSF  
Z4000 SERIES  
SATURN ZEN PLATE

## 3.0 Features

- Three speed rotary fan controller
- Multi-tap capacitive attenuation block
- Three linear speed settings (Lo, Med, Hi)
- 75VA Rating
- Horizontal or vertical mounting options
- Suitable for use with ceiling sweep fans (split phase induction motors)
- Complies with Australian and International EMC Standards.

Switch Position	1	2	3
Speed Setting	Lo	Med	Hi
Capacitance Value	1.8uF	2.7uF	0
Approximate Speed*	100 rpm	200 rpm	275 rpm

\* Actual speed may vary slightly with respect to the specific fan model selected for the installation.

## 4.0 Load Compatibility

### 4.1 Controlling a Single Fan

The Z4060CSFM Series Three Speed Fan Controller may be used to operate a single Airflow Ceiling Sweep Fan.



## NOTICE

The three speed fan controller supplied with each fan is not suitable for controlling multiple fans. Failure to comply with this instruction will void any warranty associated with the product.

### 4.2 Multiple Fans on a Single Controller

Where multiple fans are required to be operated from a single speed controller, a Clipsal C-Thru® Universal Dimmer (sold separately) must be used.

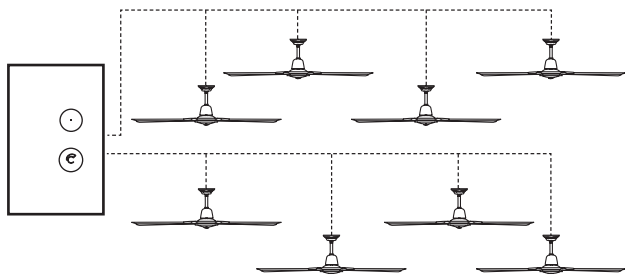

You can control up to eight Airflow Ceiling Sweep Fans using a Saturn Series Clipsal C-Thru® Universal Dimmer (catalogue number Z4062E450UD).

## 5.0 Installation Instructions

### 5.1 Connecting the Speed Controller

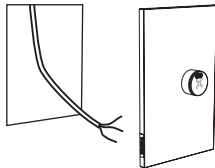
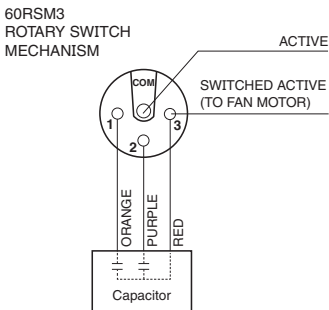

### 5.2 Mounting the Controller (Fan Only)

1. Remove the Control Knob.
2. Remove Saturn Zen fascia.
3. Orient Rotary Switch Mechanism in plate as required to suit Vertical or Horizontal Plate Mounting (refer to Mounting Orientation). "OFF" should be at the top.
4. Terminate cables as shown. Connect:
  - Active feed to Common Terminal
  - Switched Active / Fan to Terminal 3.
5. Fix capacitor block to Saturn Zen plate.
6. Fix plate to wall.
7. Fit fascia. Ensure that the appropriate number ring is installed (refer to Mounting Orientation). "OFF" should be at the top.
8. Fit control knob.
9. Apply power to circuit.
10. Test fan operation.

### 5.3 Unit Operation Test

Turn the knob to Speed 3 (Hi). This will start the fan spinning. Once the fan is spinning then you can select a lower speed if desired.

### 5.4 Connecting the Speed Controller with a Light Switch

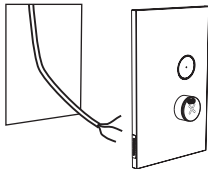
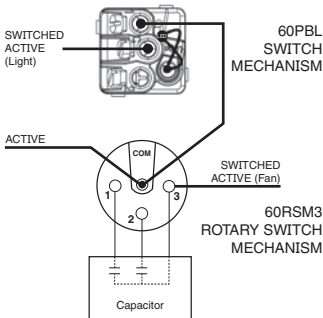

Requires additional components (supplied separately):

- 60PBL Switch Mechanism.
- Saturn Zen Two Gang Grid Plate. Connect as shown in the diagram.

## 5.5 Mounting Orientation

The Saturn Zen Series Fan Controller can be mounted either vertically or horizontally to suit your application. The rotary switch mechanism and the number ring will need to be set up accordingly.

Orient the 60RSM3. Rotate the switch mechanism with respect to the plate. Note that the terminal screws should be accessible from the top, in order to ensure that the OFF position of the speed controller is at the top when the plate is installed. Remove the mech and rotate through 90° if required.

Select the corresponding position to suit your application with the fascia button and fit to the Saturn Zen fascia.

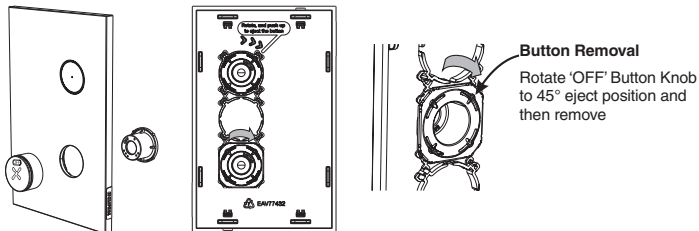

**NOTE**  
OFF should be located at the top of the plate when installed, for either Horizontal or Vertical application.

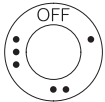
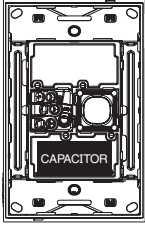
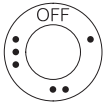
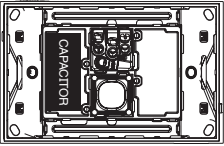
EXAMPLE: Vertical Mount	EXAMPLE: Horizontal Mount
<p><b>Vertical Number Ring</b></p>  <p>The OFF speed setting should <b>always</b> be located at the TOP POSITION of the knob as illustrated (where OFF is).</p> 	<p><b>Horizontal Number Ring</b></p>  <p>The OFF speed setting should <b>always</b> be located at the TOP POSITION of the knob as illustrated (where OFF is).</p> 

### Fan Controller Knob Different Status

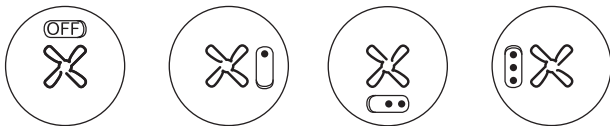

## 6.0 Compatible Airflow Ceiling Sweep Fans

All Airflow Ceiling Sweep Fans are compatible with the Z4060CSFM Series Three Speed Fan Controller, including: ACES36 Series, ACES48 Series, ACES56 Series, ACES36J Series, ACES48J Series, ACES56J Series, AFLR48 Series, 4HS1200 Series, 4HS1400 Series, 4JH1200 Series and 4JH1400 Series.

## 7.0 Fan Installation Checklist

The below guidelines should be followed to help ensure quiet operation:

1. Ensure all bolts and screws are properly tightened when assembling fan.
  2. Check fit of support hook to rubber support insulator. If loose, fit rubber sheathing provided to ensure neat fit.
  3. Place rubber washers supplied between support insulator and support insulator brackets for tight fit.
  4. Prevent loose split pins from rattling by covering with small piece of insulation tape or other suitable method.
  5. Ensure top and bottom cowls are securely fixed and slightly clear of ceiling and fan motor.
- \* A few minutes spent checking the above, will in most cases help ensure silent operation of the fan.

## 8.0 Electrical Specifications

Parameter	Value
Nominal Operating Voltage	220 - 240V a.c.
Nominal Operating Frequency	50 Hz
Maximum Load	75VA (Limit ONE ceiling sweep fan only per controller)
Speed Control Technique	Capacitive Attenuation
Compatible Loads	 Ceiling fans (split-phase induction motors)
Operating Temperature Range	0 to 40°C
Operating Humidity Range	10 to 90% R.H.
Mounting Centres	84mm Australian Pattern Plate
EMC Emission Compliance	AS/NZS CISPR 15:2002
Test Conditions @ 25°C ± 5°C	
No User Serviceable Parts Inside	

## 9.0 Warranty Statement

1. The benefits conferred herein are in addition to, and in no way shall be deemed to derogate; either expressly or by implication, any or all other rights and remedies in respect to the Clipsal product, which the consumer has under the Commonwealth Trade Practices Act or any other similar State or Territory Laws.
2. The warrantor is Schneider Electric.
3. This Clipsal product is guaranteed against faulty workmanship and materials for a period of two (2) years from the date of installation.
4. Schneider Electric reserves the right, at its discretion, to either repair free of parts and labour charges, replace or offer refund in respect to any article found to be faulty due to materials, parts or workmanship.
5. This warranty is expressly subject to the Clipsal product being installed, wired, tested, operated and used in accordance with the manufacturer's instructions.
6. All costs of a claim shall be met by Schneider Electric, however should the product that is the subject of the claim be found to be in good working order all such costs shall be met by the claimant.
7. When making a claim the consumer shall forward the Clipsal product to the nearest office of Schneider Electric with adequate particulars of the defect within 28 days of the fault occurring. The product should be returned securely packed, complete with details of the date and place of purchase, description of load, and circumstances of malfunction.

---

**Schneider Electric (Australia) Pty Ltd**

**clipsal.com**

Contact us: [clipsal.com/feedback](http://clipsal.com/feedback)

National Customer Care Enquiries:

**Tel 1300 2025 25**

**Fax 1300 2025 56**

Schneider Electric (Australia) Pty Ltd reserves the right to change specifications, modify designs and discontinue items without incurring obligation and whilst every effort is made to ensure that descriptions, specifications and other information in this catalogue are correct, no warranty is given in respect thereof and the company shall not be liable for any error therein.

© 2014 Schneider Electric. All Rights Reserved.

Trademarks are owned by Schneider Electric Industries SAS or its affiliated companies.