



PRODUCT DATA

Threaded Rod Class 4.6 Zinc Plated

The threaded rod conforms to DIN 975 and the installation as a tie-down rod should be carried out according to AS 1684.3

Applications	
•	Suspension of mechanical-electrical services
•	Fire protection systems and HVAC
•	Internal ceiling support

Material	4.6	ISO Property Class 4.6 UTS
-----------------	------------	----------------------------

Finish	Z/P	Zinc Plated (RoHS Compliant)
---------------	------------	------------------------------



Additional lengths available for specialised applications:

- **M12, M16** x 2440mm, 2570mm, 2700mm, and 3600mm
- **M30, M36** x 1200mm, 1400mm



Part Prefix	Nominal Size	Pitch	Stress Area	Min. Proof Load	Safe Working Load*	Available Finish	
	(mm)					(mm)	(mm ²)
ASMSZCM	3	0.50	5.00	1.13	23	✓	-
ASMSZCM	4	0.70	8.80	1.98	40	✓	-
ASMSZCM	5	0.80	14.20	3.20	65	✓	-
ASMSZCM	6	1.00	20.10	4.52	92	✓	✓
ASMSZCM	8	1.25	36.60	8.24	168	✓	✓
ASMSZCM	10	1.50	58.00	13.00	265	✓	✓
ASMSZCM	12	1.75	84.30	19.00	387	✓	✓
ASMSZCM	16	2.00	157.00	35.30	720	✓	✓
ASMSZCM	20	2.50	245.00	55.10	1123	✓	✓
ASMSZCM	24	3.00	353.00	79.40	1619	✓	✓
ASMSZCM	30	3.50	561.00	126.00	2569	✓	✓
ASMSZCM	36	4.00	817.00	184.00	3751	✓	✓
ASMSZCM	42	4.50	1121.00	252.20	5142	✓	✓
ASMSZCM	48	5.00	1473.00	331.40	6756	✓	✓

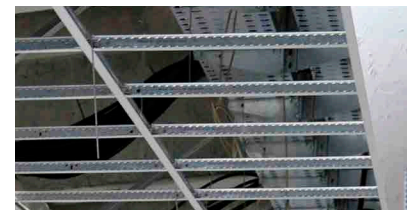

Suspension of ducting for heating/ventilation/air conditioning

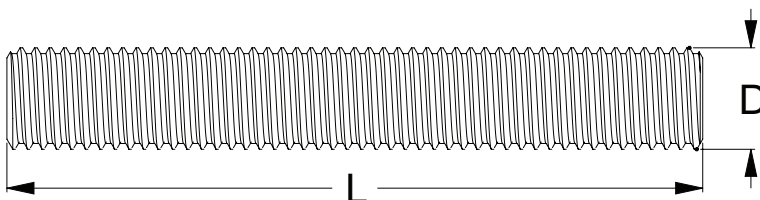

* A safety factor of 5 has been used to calculate safe working loads. The safe working loads are provided for design capacity in a static tensile condition. An additional safety factor should be applied to allow for dynamic loading

Disclaimer: While every reasonable effort has been made to ensure that this document is correct at the time of printing, Hobson Engineering®, its agencies and employees, disclaim any and all liability to any person in respect of anything or the consequences of anything done or omitted to be done in reliance upon the whole or any part of this document.

Product and Service Reliability | Traceability | Accredited

hobson.com.au **QUALITY FASTENERS SINCE 1935**

