

Catalogue No: **PF 1060**

ELDON FS PLINTH M/STEEL RAL 7022 FRONT+BACK H100 x W600mm

Enclosures and Climate Control > Standard Enclosures > Floor Standing Enclosures > Floor Standing Enclosures - Mild Steel > Floor Standing Enclosure Accessories - Suitable for Mild Steel and Stainless Steel > Plinth - Front/rear Pieces, Mild Steel



PLINTH M/STEEL RAL 7022 FRONT+BACK H100 x W600mm ELDON FS



Representative Photo Only
(actual product may vary based on configuration selections)

SPECIFICATIONS

Width	600 mm
Width, Enclosure	600 mm width
Height, Plinth	100 mm height

REFERENCES

IECEX Certificate	-
Supplier Declaration of Conformity:	-
Installation Guide:	-
User Manual:	-
Manufacturer Datasheet:	-
Manufacturer Catalogue & Product Selection:	-

Catalogue No: **PF 1060**

ELDON FS PLINTH M/STEEL RAL 7022 FRONT+BACK H100 x W600mm

Enclosures and Climate Control > Standard Enclosures > Floor Standing Enclosures > Floor Standing Enclosures - Mild Steel > Floor Standing Enclosure Accessories - Suitable for Mild Steel and Stainless Steel > Plinth - Front/rear Pieces, Mild Steel



Front view

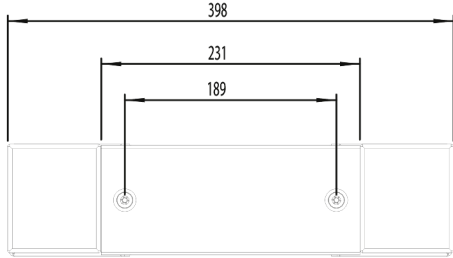

Side view

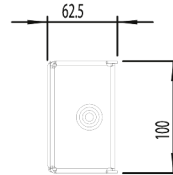

Rear view

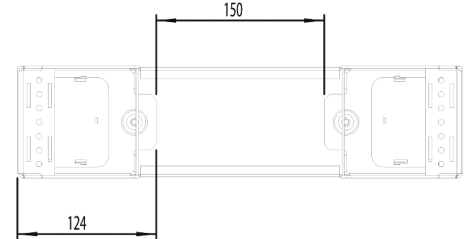

Top view

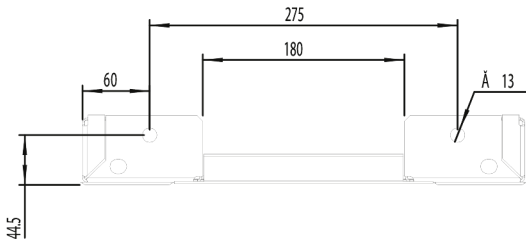

Dimension Diagram