

Catalogue No: MKD16124R5

ENCLOSURE F/STANDING COMPACT M/STEEL IP55 H1600xW1200xD400mm

Enclosures and Climate Control > Standard Enclosures > Floor Standing Enclosures > Floor Standing Enclosures - Mild Steel > Mild Steel - MKD (Double Door Compact)



Representative Photo Only
(actual product may vary based on configuration selections)

Enclosure Floor Standing Compact Mild Steel IP55 H1600xW1200xD400mm Double Door

- Powder coated mild steel RAL 7035 provides a good level of corrosion resistance in indoor applications
- Fully welded (IP55 and IK10) resulting in exceptional strength and rigidity
- Large range of accessories including plinths, baying kits, fan covers, rain hoods, lifting devices and locks ensuring suitable for a wide range of industry segments and application
- Meets standards and approvals including CE, CSA, GL, KEMA, UL and Lloyd's Register

SPECIFICATIONS

Product Series	MKD Compact (Double Door)
Material, Body / Housing	Powder Coated Mild Steel material
Material thickness, body / housing	1.35 mm
Colour, Body / Housing	Light Grey (RAL 7035) colour
Finish, body / housing	Ripple body/housing
Details, body / housing	Four times folded and seam-welded frame. Integrated double row hole pattern.
Height	1600 mm
Width	1200 mm
Depth	400 mm
Weight	163 kg
Material, door	Powder Coated Mild Steel
Material thickness, door	2 mm
Colour, Door	Light Grey (RAL 7035) door
Finish, Door	Ripple door
Details, door	Mounted with four hinges. Includes door frame with 25mm hole pattern. Standard doors cannot be reversed. Separate doors to be ordered for left hand locking.
Material, Mounting Plate / Bracket	Zinc Galvanized Steel
Material Thickness, Mounting Plate / Bracket	2.7 mm
Details, Mounting Plate / Bracket	Double folded and slides into position. Adjustable in depth by steps of 25mm with the MPD02 accessory. Supplied outside of the enclosure packaging.
Material, Gland Plate	Zinc Galvanized Steel
Material Thickness, Gland Plate	1 mm
Colour, Gland Plate	Light Grey (RAL 7035) gland plate
Finish, Gland Plate	Ripple gland plate
Details, Gland Plate	Consists of three pieces.

Catalogue No: **MKD16124R5**

ENCLOSURE F/STANDING COMPACT M/STEEL IP55 H1600xW1200xD400mm

Enclosures and Climate Control > Standard Enclosures > Floor Standing Enclosures > Floor Standing Enclosures - Mild Steel > Mild Steel - MKD (Double Door Compact)



Roof Panel	1.35mm painted steel. Removable.
Rear Panel	1.35mm painted steel. Fitted by M6 torx screws. Standard facilities for rear door mounting.
Material, Gasket / Seal	PUR / PU material
Details, earthing	All panels are earthed through their fittings and are equipped with a separate earthing stud.
IP Rating	IP55
IK Rating	IK10
Lock Type	DIN - 4 Point Locking type
Diameter, Lock	3 mm
Material, Lock	Plastic material
NEMA Enclosure Class (NEMA 250:2003)	Type 12 Type 13
Bayable?	No
Door Load Capacity	80 kg
Enclosure Load Capacity	575 kg
Delivery Details	Body with fitted door, rear panel, roof panel, bottom plates, mounting plate and door frame. Delivery also includes earthing bolts. Delivered on a pallet with width identical with the enclosure. All packing material is recyclable.
Notes	1600mm wide enclosure comes with 2 x rear panels and mounting plate fixed inside
Standards Compliance	NEMA 250:2003
Certifications	CE C-UL KEMA UL
Shipping Approvals	Lloyd's Register of Shipping

REFERENCES

IECEX Certificate	-
Supplier Declaration of Conformity:	-
Installation Guide:	-
User Manual:	-
Manufacturer Datasheet:	-
Manufacturer Catalogue & Product Selection:	-

Catalogue No: MKD16124R5

ENCLOSURE F/STANDING COMPACT M/STEEL IP55 H1600xW1200xD400mm

Enclosures and Climate Control > Standard Enclosures > Floor Standing Enclosures > Floor Standing Enclosures - Mild Steel > Mild Steel - MKD (Double Door Compact)



Universal support plate

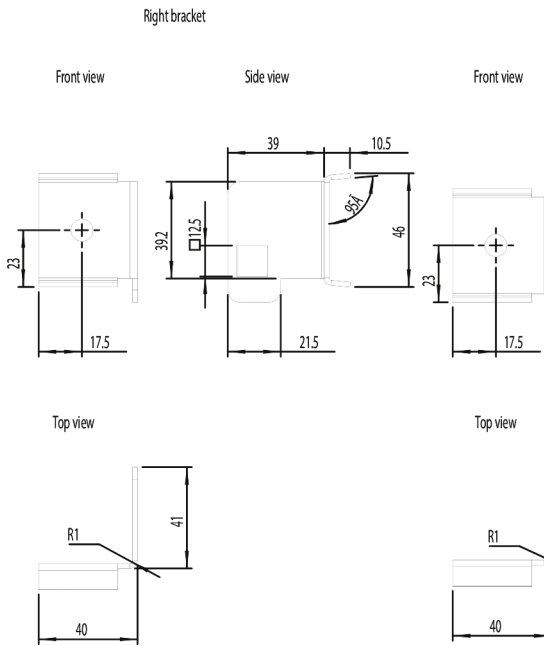

Square profile guide

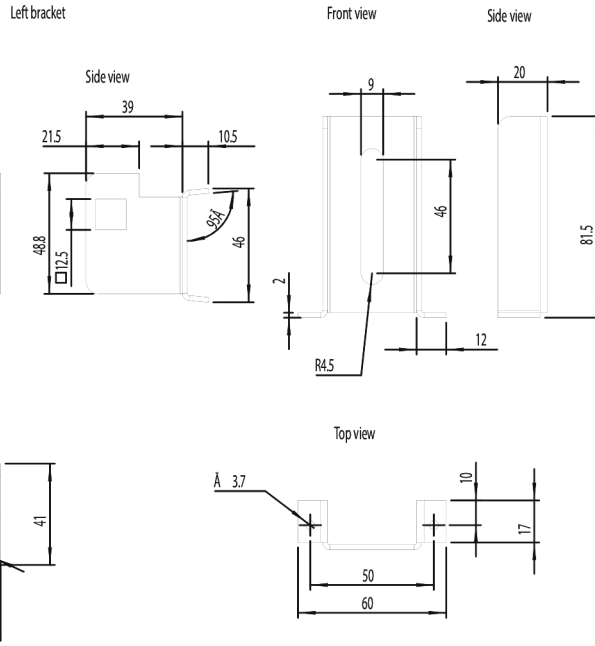

Sliding nut M8

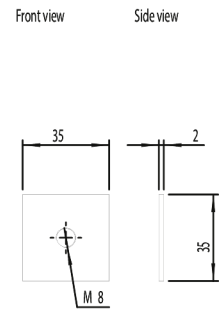

Dimension Diagram