

Catalogue No: **CA7-9E-01-24VDC**
CONTACTOR 4kW 3P 24V DC COIL 1NC AUXILIARY

Motor Control and Drives > Motor Starting and Protection > Contactors > Sprecher + Schuh Contactors > CA7
 Contactors 4 to 55kW > 3 Pole Contactors with DC Coil

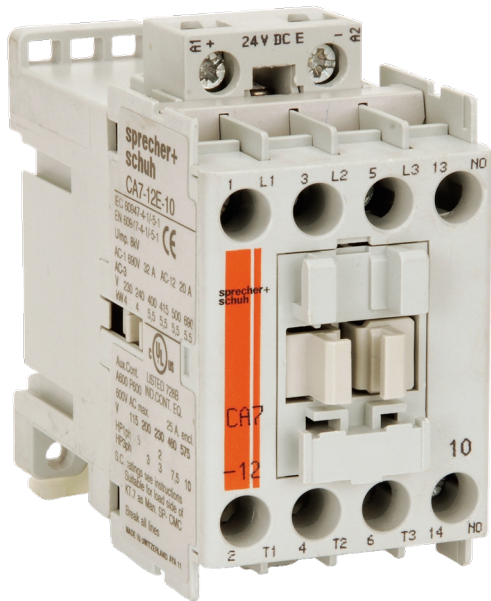

Contactor 3 pole 9A 4kW 1N/C Auxiliary 24V DC Coil

Representative Photo Only
 (actual product may vary based on configuration selections)

SPECIFICATIONS

| | |
|---|--------------------|
| Product Series | CA7-09 |
| Component Type Motor Control and Drives | Standard Contactor |
| Ie, Rated Operational Current, AC-1, 415V, 40°C | 32 A@415V,40°C |
| kW Rating, AC-3, 415V, 60°C | 4 kW @415V, 60°C |
| Ie, Rated Operational Current, AC-3, 415V, 60°C | 9 A@415V,60°C |
| kW Rating, AC-3, 690V, 60°C | 4 kW @690V, 60°C |
| Ie, Rated Operational Current, AC-3, 690V, 60°C | 5 A@690V,60°C |
| Number of Poles | 3 |
| Contact Configuration, Main Poles | 3 NO main poles |
| Contact Configuration, Auxiliary | 1 NC auxiliary |
| Coil Type | Electronic type |
| Coil Consumption Hold-in VA AC coiled contactors | 2.7 VA 9.5 |
| Coil Consumption Pickup VA AC coiled contactors | 75 VA |
| Coil Consumption Pickup W Ave/Peak DC Electronic coiled contactors 12VDC | 10 W 17 |
| Coil Consumption Pickup W Ave/Peak DC Electronic coiled contactors 24VDC | 10 W 17 |
| Coil Consumption Pickup W Ave/Peak DC Electronic coiled contactors 36-48VDC | 10 W 17 |
| Coil Consumption Pickup W Ave/Peak DC Electronic coiled contactors 48-72VDC | 10 W 17 |
| Coil Consumption Pickup W Ave/Peak DC Electronic coiled contactors 110-125VDC | 12 W 19 |
| Coil Consumption Pickup W Ave/Peak DC Electronic coiled contactors 220-250VDC | 14 W 22 |
| Coil Consumption Hold-in W DC coiled contactors 12VDC | 1.7 W |
| Coil Consumption Hold-in W DC coiled contactors 24VDC | 1.7 W |
| Coil Consumption Hold-in W DC coiled contactors 36-48VDC | 1.7 W 1.9 |

Catalogue No: **CA7-9E-01-24VDC**
CONTACTOR 4kW 3P 24V DC COIL 1NC AUXILIARY

Motor Control and Drives > Motor Starting and Protection > Contactors > Sprecher + Schuh Contactors > CA7
 Contactors 4 to 55kW > 3 Pole Contactors with DC Coil



| | |
|--|--------------|
| Coil Consumption Hold-in W DC coiled contactors 48-72VDC | 1.7 W 1.9 |
| Coil Consumption Hold-in W DC coiled contactors 110-125VDC | 2 W 2.1 |
| Coil Consumption Hold-in W DC coiled contactors 220-250VDC | 2.7 W 3 |
| Integrated Aux | 1 N/C |
| Coil Voltage, DC, Nom | 24 V DC |
| IP Rating | IP20 |

REFERENCES

| | |
|---|---|
| IECEX Certificate | - |
| Supplier Declaration of Conformity: | - |
| Installation Guide: | - |
| User Manual: | - |
| Manufacturer Datasheet: | - |
| Manufacturer Catalogue & Product Selection: | - |

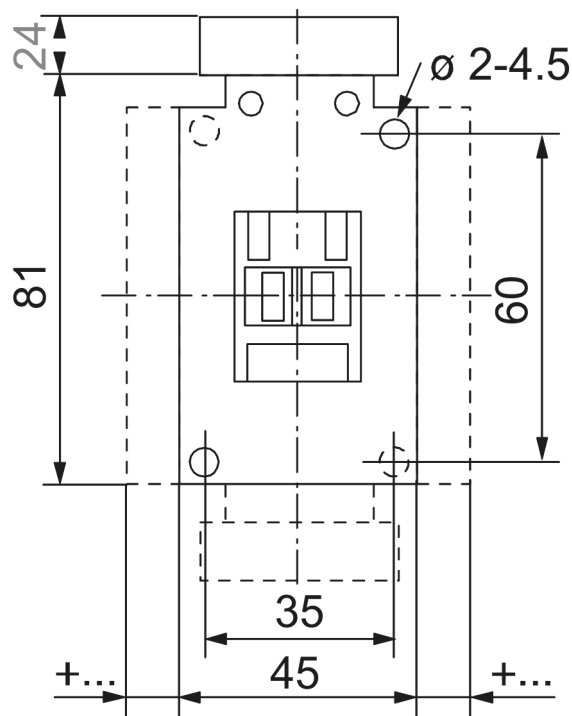

Dimension Diagram