

# Catalogue No: CA7-30E-00-24VDC

## CONTACTOR 15kW 3P 24V DC COIL

Motor Control and Drives > Motor Starting and Protection > Contactors > Sprecher + Schuh Contactors > CA7  
Contactors 4 to 55kW > 3 Pole Contactors with DC Coil



Contactor 3 pole 30A 15kW 24V DC Coil

Representative Photo Only  
(actual product may vary based on configuration selections)

### SPECIFICATIONS

Product Series	CA7-30
Component Type Motor Control and Drives	Standard Contactor
Ie, Rated Operational Current, AC-1, 415V, 40°C	65 A@415V,40°C
kW Rating, AC-3, 415V, 60°C	15 kW @415V, 60°C
Ie, Rated Operational Current, AC-3, 415V, 60°C	30 A@415V,60°C
kW Rating, AC-3, 690V, 60°C	15 kW @690V, 60°C
Ie, Rated Operational Current, AC-3, 690V, 60°C	18 A@690V,60°C
Number of Poles	3
Contact Configuration, Main Poles	3 NO main poles
Coil Type	Electronic type
Coil Consumption Hold-in VA AC coiled contactors	3.1 VA 12.3
Coil Consumption Pickup VA AC coiled contactors	105 VA
Coil Consumption Pickup W Ave/Peak DC Electronic coiled contactors 12VDC	10 W 17
Coil Consumption Pickup W Ave/Peak DC Electronic coiled contactors 24VDC	10 W 17
Coil Consumption Pickup W Ave/Peak DC Electronic coiled contactors 36-48VDC	10 W 17
Coil Consumption Pickup W Ave/Peak DC Electronic coiled contactors 48-72VDC	10 W 17
Coil Consumption Pickup W Ave/Peak DC Electronic coiled contactors 110-125VDC	12 W 19
Coil Consumption Pickup W Ave/Peak DC Electronic coiled contactors 220-250VDC	14 W 22
Coil Consumption Hold-in W DC coiled contactors 12VDC	1.7 W
Coil Consumption Hold-in W DC coiled contactors 24VDC	1.7 W
Coil Consumption Hold-in W DC coiled contactors 36-48VDC	1.7 W 1.9
Coil Consumption Hold-in W DC coiled contactors 48-72VDC	1.7 W 1.9

# Catalogue No: **CA7-30E-00-24VDC**

## CONTACTOR 15kW 3P 24V DC COIL

Motor Control and Drives > Motor Starting and Protection > Contactors > Sprecher + Schuh Contactors > CA7  
Contactors 4 to 55kW > 3 Pole Contactors with DC Coil



Coil Consumption Hold-in W DC coiled contactors 110-125VDC	2 W 2.1
Coil Consumption Hold-in W DC coiled contactors 220-250VDC	2.7 W 3
Integrated Aux	No Auxiliary Contacts
Coil Voltage, DC, Nom	24 V DC
Coil Pickup Voltage, min	70 %Un min
Coil Pickup Voltage, max	125 %Un max
IP Rating	IP20

### REFERENCES

IECEx Certificate	-
Supplier Declaration of Conformity:	-
Installation Guide:	-
User Manual:	-
Manufacturer Datasheet:	-
Manufacturer Catalogue & Product Selection:	-

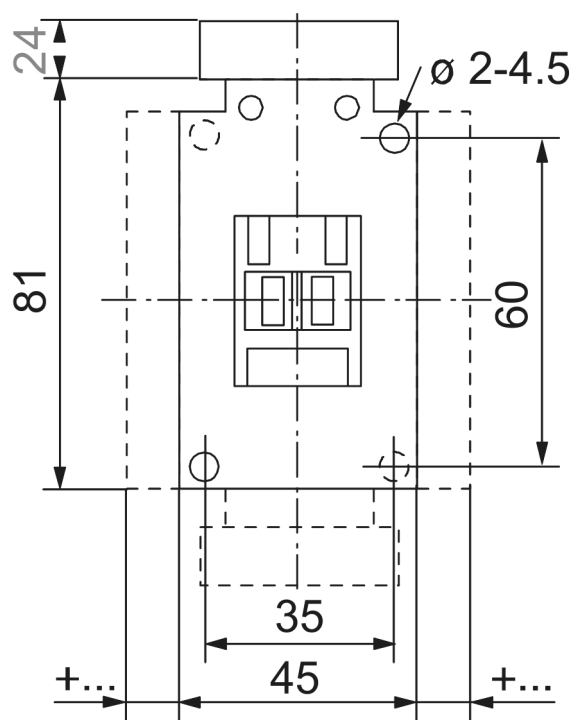

Dimension Diagram

Catalogue No: **CA7-30E-00-24VDC**

**CONTACTOR 15kW 3P 24V DC COIL**

Motor Control and Drives > Motor Starting and Protection > Contactors > Sprecher + Schuh Contactors > CA7  
Contactors 4 to 55kW > 3 Pole Contactors with DC Coil



### Mounting Position

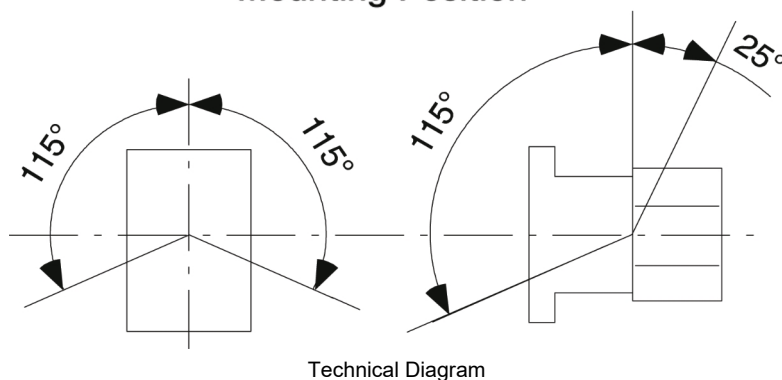

Technical Diagram