

Stopper Plugs, Adaptors, Reducers, Breather/Drain Plugs



747, 757 & 767 STOPPER PLUGS

TECHNICAL DATA

COMPONENT APPROVED STOPPER PLUGS DESIGNED TO CLOSE UNUSED CABLE ENTRY HOLES IN EXPLOSION PROTECTED EQUIPMENT. VERSIONS AVAILABLE WITH & WITHOUT INTEGRAL 'O' RING SEAL, AND FOR INDUSTRIAL OR SAFE AREA USE.

APPROVAL DETAIL

ATEX APPROVAL : SIRA 01ATEX1284U
 IECEx APPROVAL : SIRA IEC Ex SIR07.0056X
 COMPLIANCE : EN / IEC 60079-0, EN / IEC 60079-1, EN / IEC 60079-7, EN 50281 / IEC 61241-0 & IEC 61241-1
 HAZARDOUS AREA CODE OF PROTECTION :
 Ⓢ II 2 GD Ex d IIC / Ex e II COMPONENT ZONE 1, ZONE 2, ZONE 21, & ZONE 22 - GAS GROUPS IIA, IIB, IIC, Ex tD IEC Ex : Ex d I / Ex e I / Ex d IIC / Ex e II / Ex tD A21 IP6X

ADDITIONAL APPROVALS HELD

ABS, DNV & LLOYDS

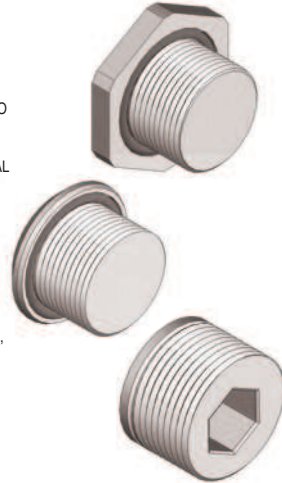

Thread Size	Ordering Reference		
	747 Recessed (Type A *)	757 Hex head	767 Round Head
M16	747FAM15	757DM15	767DM15
M20	747FAM25	757DM25	767DM25
M25	747FAM35	757DM31	767DM35
M32	747FAM45	757DM45	767DM45
M40	747FAM55	757DM55	767DM55
M50	747FAM65	757DM65	767DM65
M63	747FAM75	757DM75	767DM75
M75	747FAM85	757DM85	767DM85

Note*: Type A non tamper proof stopper plugs are externally secured by allen key

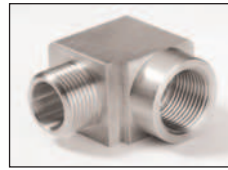

787 RIGHT ANGLED ADAPTOR

TECHNICAL DATA

COMPONENT APPROVED RIGHT ANGLED ADAPTOR DESIGNED TO PROTECT CABLES WHEN INSTALLED IN CONFINED SPACES WHERE THE CABLE MAY OTHERWISE BE SUBJECT TO EXCESSIVE BENDING STRESS, AND OFFERS A MEANS OF CONNECTION WHERE THE CABLE CANNOT BE INSTALLED IN THE USUAL PERPENDICULAR FASHION. VERSIONS AVAILABLE WITH HAZARDOUS AREA CERTIFICATION AND ALSO FOR INDUSTRIAL OR SAFE AREA USE.

APPROVAL DETAIL

ATEX APPROVAL : SIRA 01ATEX1284U
 IECEx APPROVAL : IEC Ex SIR07.0055U
 COMPLIANCE : EN / IEC 60079-0, EN / IEC 60079-1, EN / IEC 60079-7, EN 50281 / IEC 61241-0 & IEC 61241-1

HAZARDOUS AREA CODE OF PROTECTION :

Ⓢ II 2 GD Ex d IIC / Ex e II COMPONENT ZONE 1, ZONE 2, ZONE 21, & ZONE 22 - GAS GROUPS IIA, IIB, IIC, Ex tD IEC Ex : Ex d I / Ex e I / Ex d IIC / Ex e II / Ex tD A21 IP6X

ADDITIONAL APPROVALS HELD

ABS, DNV & LLOYDS

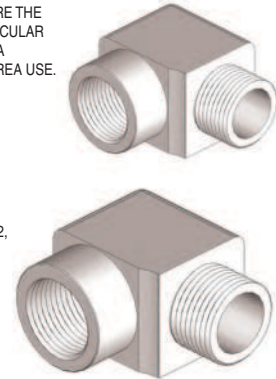

Thread Size	Ordering Reference
M20 x M20	787DM2M25
M25 x M25	787DM3M35
M32 x M32	787DM4M45
M40 x M40	787DM5M55
M50 x M50	787DM6M65
M63 x M63	787DM7M75
M75 x M75	787DM8M85

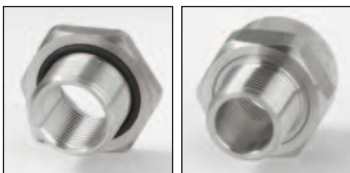

737 ADAPTORS AND REDUCERS

TECHNICAL DATA

COMPONENT APPROVED ADAPTORS & REDUCERS DESIGNED TO CONVERT THREAD FORMS AND SIZES BETWEEN EXPLOSION PROTECTED EQUIPMENT AND CABLE ENTRY DEVICES. VERSIONS AVAILABLE WITH & WITHOUT INTEGRAL 'O' RING SEAL, AND ALSO FOR INDUSTRIAL OR SAFE AREA USE.

APPROVAL DETAIL

ATEX APPROVAL : SIRA 01ATEX1284U
 IECEx APPROVAL : IEC Ex SIR07.0052X
 COMPLIANCE : EN / IEC 60079-0, EN / IEC 60079-1, EN / IEC 60079-7, EN 50281 / IEC 61241-0 & IEC 61241-1
 HAZARDOUS AREA CODE OF PROTECTION :
 Ⓢ II 2 GD Ex d IIC / Ex e II COMPONENT ZONE 1, ZONE 2, ZONE 21, & ZONE 22 - GAS GROUPS IIA, IIB, IIC, Ex tD IEC Ex : Ex d I / Ex e I / Ex d IIC / Ex e II / Ex tD A21 IP6X

ADDITIONAL APPROVALS HELD

ABS, DNV & LLOYDS

Virtually any thread conversion imaginable can be supplied.

Please see page 13 for common sizes and how to order.

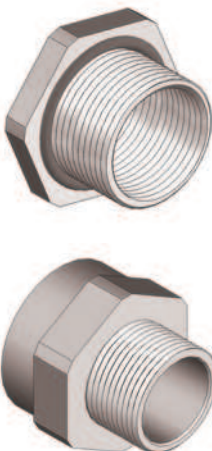

Note : These products comply with the corresponding AS/NZS 60079 standards which are identical to the IEC 60079 compliance standards detailed above.

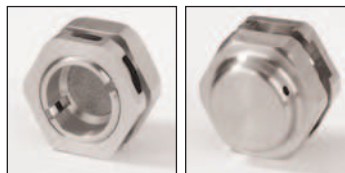

781 BREATHER DRAIN PLUG

TECHNICAL DATA

COMPONENT APPROVED BREATHER DRAIN PLUG FOR USE WITH INCREASED SAFETY Ex e APPARATUS THAT IS SUSCEPTIBLE TO CONDENSATION OR PRONE TO MOISTURE COLLECTION OR INGRESS DURING NORMAL OPERATION.

VERSIONS AVAILABLE IN BRASS, ALUMINIUM, STAINLESS STEEL, OR NON-METALLIC.

APPROVAL DETAIL

ATEX APPROVAL : SIRA 01ATEX1284U
 IECEx APPROVAL : IEC Ex SIR07.0054U
 COMPLIANCE : EN / IEC 60079-0, EN / IEC 60079-7, EN 50281 / IEC 61241-0 & IEC 61241-1

HAZARDOUS AREA CODE OF PROTECTION :

Ⓢ II 2 GD Ex e II, COMPONENT ZONE 1, ZONE 2, ZONE 21, & ZONE 22 - GAS GROUPS IIA, IIB, IIC IEC Ex : Ex e II / Ex tD A21 IP6X INGRESS PROTECTION : IP66

ADDITIONAL APPROVALS HELD

ABS, DNV & LLOYDS

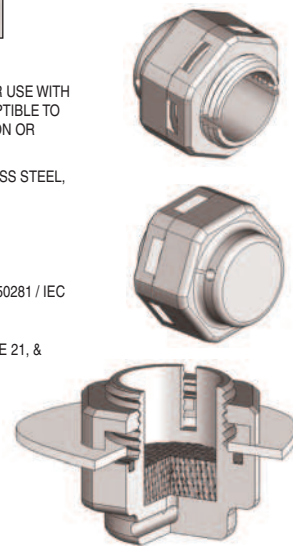

Size	Ordering Reference	
	Nickel Plated Brass	Stainless Steel
M20	781EM25	781EM24
M25	781EM35	781EM24



CMP 737 THREAD CONVERSION ADAPTOR & REDUCER - STANDARD SIZE SELECTION TABLE

CMP 737 THREAD CONVERSION ADAPTOR & REDUCER - STANDARD SIZE SELECTION TABLE

MALE THREAD		FEMALE THREAD																																	
SIZE	ORDERING CODE DEFINITION (**)	M1	M2	M3	M4	M5	M6	M7	M8	PTA	P1	P2	P3	P4	P5	P6	P7	P8	P9	T1	T2	T3	T4	T5	T6	T7	T8	B1	B2	B3	B4	B5	B6	B7	B8
		M16	M20	M25	M32	M40	M50	M63	M75	PG7	PG9	PG11	PG13.5	PG16	PG21	PG29	PG36	PG42	PG48	1/2" NPT	3/4" NPT	1" NPT	1 1/4" NPT	1 1/2" NPT	2" NPT	2 1/2" NPT	3" NPT	1/2" BSPP	3/4" BSPP	1" BSPP	1 1/4" BSPP	1 1/2" BSPP	2" BSPP	2 1/2" BSPP	3" BSPP
M16	M1	■																																	
M20	M2		■																																
M25	M3			■																															
M32	M4				■																														
M40	M5					■																													
M50	M6						■																												
M63	M7							■																											
M75	M8								■																										
PG7	P1A									■																									
PG9	P1										■																								
PG11	P2											■																							
PG13.5	P3												■																						
PG16	P4													■																					
PG21	P5														■																				
PG29	P6															■																			
PG36	P7																■																		
PG42	P8																	■																	
PG48	P9																		■																
1/2" NPT	T1																			■															
3/4" NPT	T2																				■														
1" NPT	T3																					■													
1 1/4" NPT	T4																						■												
1 1/2" NPT	T5																							■											
2" NPT	T6																								■										
2 1/2" NPT	T7																									■									
3" NPT	T8																										■								
1/2" BSPP	B1																																		
3/4" BSPP	B2																																		
1" BSPP	B3																																		
1 1/4" BSPP	B4																																		
1 1/2" BSPP	B5																																		
2" BSPP	B6																																		
2 1/2" BSPP	B7																																		
3" BSPP	B8																																		

How to Compile Ordering Codes

Type - Protection - Male Size(**) - Female Size(**) - Material

Examples :

737-D-M2-M3-5 = M20 x M25 Adaptor, Nickel Plated Brass

737-D-B2-M3-4 = 3/4" BSPP x M25 Adaptor, Stainless Steel

737-D-M3-M2-4 = M25 x M20 Adaptor, Stainless Steel

KEY:

IEC Ex CERTIFIED REDUCER

IEC Ex CERTIFIED ADAPTOR

INDUSTRIAL ADAPTOR / REDUCER

Letter D following Type 737 = Dual Certified Ex d / Ex e.
Suffix 5 = Nickel Plated Brass. Suffix 4 = Stainless Steel.