

Catalogue No: 3PS3A3NE01

3PS32 APPLIANCE INLET 3P+N+E 50A (AC23 32A) 440V AC

Plugs, Sockets and Switches > Isolating Plugs and Sockets > Isolating Plugs and Sockets > Proconnect Plugs and Sockets > 50A Disconnect Plugs and Sockets (3PS32 Series) > Appliance Inlets



Representative Photo Only
(actual product may vary based on configuration selections)

3PS32 Appliance Inlet 3P+N+E

- Available in five sizes including 30A, 50A, 90A, 150A and 250A (Maximum current rating to IEC60309)
- 3, 4 and 5 pin configurations with optional pilot pins, silver alloy tipped for low voltage drop and high arc resistance
- AC23 rating for making and breaking high inductive loads
- Connect and disconnect under load, eliminates the need for switching
- Interlocked socket and appliance inlet with 24 insert settings (Factory Set) preventing mismatching for a safe and reliable connection
- High ingress protection and exceptional impact resistance, IP66 / IK 08
- Resistance to most industrial chemicals, detergents and exposure to UV light
- Range of angled wall boxes, incline sleeves and handles for all plug and socket combinations

SPECIFICATIONS

| | |
|--|--|
| Product Series | 3PS |
| Component Type Plugs And Sockets | Appliance Inlet |
| Contacts (Poles) | 3P + N + E |
| Ie, Rated Operational Current, AC-23, 440V | 32 A@440V |
| Ie, Rated Operational Current, max | 50 A,max |
| M Rating (AS 3133) | M250 AS 3133 |
| Ue, Rated Operational Voltage, AC, min | 380 V AC |
| Ue, Rated Operational Voltage, AC, max | 440 V AC |
| IP Rating | IP66 |
| IK Rating | IK08 |
| Wire / Conductor Size (Max) | 16 mm ² |
| Wire / Conductor Size, Flex Cable, Max | 10 mm ² max |
| Diameter, Cable Jacket, Min | 8 mm |
| Diameter, Cable Jacket, Max | 22 mm |
| Strip Length, Insulation | 17 mm |
| Strip Length, Sheathing | 37 mm |
| Tightening Torque, Nominal | 2.72 Nm |
| Material, Body / Housing | Nylon / PA6 / PA66 (Polyamide 6) material |
| Material, Contacts | Silver-Plated Copper Alloy material |
| Material, Screws / Fastening | Stainless Steel Screws/Fastening |
| Depth | 70.5 mm |
| Weight | 0.23 kg |
| Operating Temperature, Min | -30 °C min |
| Operating Temperature, Max | 60 °C max |
| Standards Compliance | AS/NZS 3947.3 IEC 60309-1 IEC 60529 IEC 60947-3 |

Catalogue No: **3PS3A3NE01**

3PS32 APPLIANCE INLET 3P+N+E 50A (AC23 32A) 440V AC

Plugs, Sockets and Switches > Isolating Plugs and Sockets > Isolating Plugs and Sockets > Proconnect Plugs and Sockets > 50A Disconnecter Plugs and Sockets (3PS32 Series) > Appliance Inlets



| REFERENCES | |
|---|---|
| IECEX Certificate | - |
| Supplier Declaration of Conformity: | - |
| Installation Guide: | - |
| User Manual: | - |
| Manufacturer Datasheet: | - |
| Manufacturer Catalogue & Product Selection: | - |

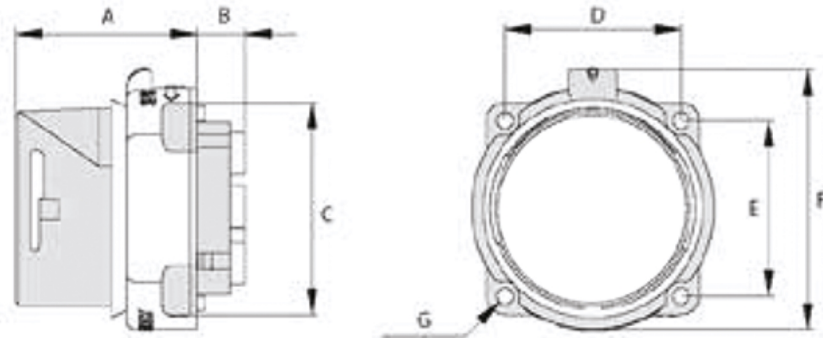

| Series | A | B | C θ | D | E | F | G θ | kg |
|---------------|------|------|------|----|----|-------|-----|------|
| 3PS16 | 49.5 | 13 | 57 | 48 | 48 | 71 | 4.5 | 0.14 |
| 3PS32 | 54.5 | 16 | 69 | 55 | 55 | 82.4 | 4.5 | 0.23 |
| 3PS63 | 62.5 | 25.5 | 80 | 66 | 66 | 96.4 | 5.5 | 0.39 |
| 3PS125 | 77 | 24 | 99.5 | 81 | 81 | 122.5 | 5.5 | 0.75 |
| 3PS200 | 82 | 37 | 116 | 98 | 98 | 137 | 5.5 | 1.48 |

Dimension Diagram