

Catalogue No: 3PS1A3NE01

3PS16 APPLIANCE INLET 3P+N+E 30A (AC23 16A) 440V AC

Plugs, Sockets and Switches > Isolating Plugs and Sockets > Isolating Plugs and Sockets > Proconnect Plugs and Sockets > 30A Disconnecter Plugs and Sockets (3PS16 Series) > Appliance Inlets



Representative Photo Only
(actual product may vary based on configuration selections)

3PS16 Appliance Inlet 3P+N+E

- Available in five sizes including 30A, 50A, 90A, 150A and 250A (Maximum current rating to IEC60309)
- 3, 4 and 5 pin configurations with optional pilot pins, silver alloy tipped for low voltage drop and high arc resistance
- AC23 rating for making and breaking high inductive loads
- Connect and disconnect under load, eliminates the need for switching
- Interlocked socket and appliance inlet with 24 insert settings (Factory Set) preventing mismatching for a safe and reliable connection
- High ingress protection and exceptional impact resistance, IP66 / IK 08
- Resistance to most industrial chemicals, detergents and exposure to UV light
- Range of angled wall boxes, incline sleeves and handles for all plug and socket combinations

SPECIFICATIONS

Product Series	3PS
Component Type Plugs And Sockets	Appliance Inlet
Contacts (Poles)	3P + N + E
Ie, Rated Operational Current, AC-23, 440V	16 A@440V
Ie, Rated Operational Current, max	30 A,max
M Rating (AS 3133)	M200 AS 3133
Ue, Rated Operational Voltage, AC, min	380 V AC
Ue, Rated Operational Voltage, AC, max	440 V AC
IP Rating, Outlet	IP66 Outlet
IP Rating, Outlet and Inlet	IP66 Outlet&Inlet
IK Rating	IK08
Wire / Conductor Size (Max)	10 mm ²
Wire / Conductor Size, Flex Cable, Max	6 mm ² max
Diameter, Cable Jacket, Min	7 mm
Strip Length, Insulation	13 mm
Strip Length, Sheathing	33 mm
Tightening Torque, Nominal	1.6 Nm
Material, Body / Housing	Nylon / PA6 / PA66 (Polyamide 6) material
Material, Contacts	Silver-Plated Copper Alloy material
Material, Screws / Fastening	Stainless Steel Screws/Fastening
Depth	62.5 mm
Weight	0.14 kg
Operating Temperature, Min	-30 °C min
Operating Temperature, Max	60 °C max
Standards Compliance	AS/NZS 3947.3 IEC 60309-1 IEC 60529 IEC 60947-3

Catalogue No: **3PS1A3NE01**

3PS16 APPLIANCE INLET 3P+N+E 30A (AC23 16A) 440V AC

Plugs, Sockets and Switches > Isolating Plugs and Sockets > Isolating Plugs and Sockets > Proconnect Plugs and Sockets > 30A Disconnect Plugs and Sockets (3PS16 Series) > Appliance Inlets



REFERENCES	
IECEX Certificate	-
Supplier Declaration of Conformity:	-
Installation Guide:	-
User Manual:	-
Manufacturer Datasheet:	-
Manufacturer Catalogue & Product Selection:	-

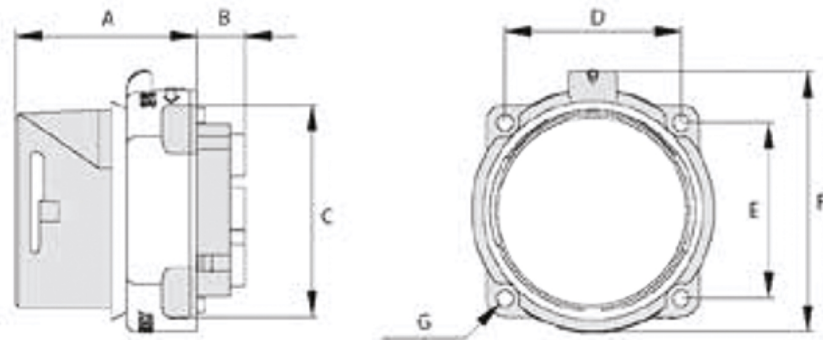

Series	A	B	C θ	D	E	F	G θ	kg
3PS16	49.5	13	57	48	48	71	4.5	0.14
3PS32	54.5	16	69	55	55	82.4	4.5	0.23
3PS63	62.5	25.5	80	66	66	96.4	5.5	0.39
3PS125	77	24	99.5	81	81	122.5	5.5	0.75
3PS200	82	37	116	98	98	137	5.5	1.48

Dimension Diagram