

# Catalogue No: **TZS-24**

## ELR TOROID CLOSED CORE 24mm

Power Distribution and Protection > Earth Leakage Protection > Earth Leakage Relays > Terasaki TZS range of Earth Leakage Relays and Toroids > TZS Earth Leakage Toroid



### Earth Leakage Toroid to suit TZS relay. 24mm internal diameter

- Suits TZS Series Earth Leakage Relays
- Internal diameter 15-100 mm
- Closed core models



Representative Photo Only  
(actual product may vary based on configuration selections)

#### SPECIFICATIONS

Product Series	TZS
Component Type Power Distribution & Protection	Toroid
Component Type Transformer	Closed-core Transformer
Details, Transformer	Suits TZS range of earth leakage relays
I <sub>e</sub> , Rated Operational Current, max	115 A <sub>max</sub>
I <sub>Δn</sub> , Leakage Current, Min	30 mA
Diameter, Internal	24 mm
Mounting	Screw Fixing
Terminal Type	Screw Terminal(s)
Wire / Conductor Size (Max)	22 mm <sup>2</sup>
Width	58 mm
Height	72 mm
Depth	28 mm
Weight	0.3 kg

#### REFERENCES

IECEx Certificate	-
Supplier Declaration of Conformity:	-
Installation Guide:	-
User Manual:	-
Manufacturer Datasheet:	-
Manufacturer Catalogue & Product Selection:	-

# Catalogue No: **TZS-24**

## ELR TOROID CLOSED CORE 24mm

Power Distribution and Protection > Earth Leakage Protection > Earth Leakage Relays > Terasaki TZS range of Earth Leakage Relays and Toroids > TZS Earth Leakage Toroid

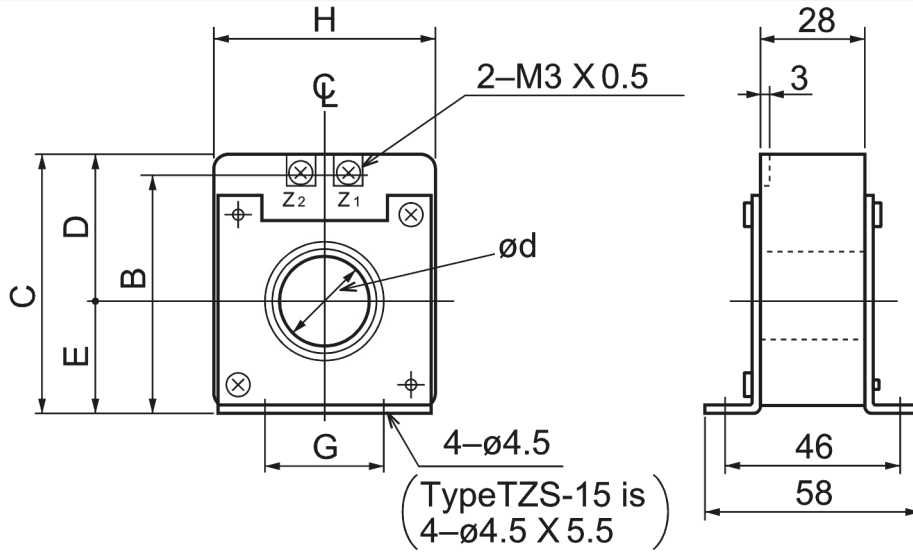

ZCT Type	$\phi d$	A	B	C	D	E	F	G	H
TZS-15	15	—	55	60	32	28	—	25	46
TZS-24	24	—	67	72	40	32	—	34	58

Dimension Diagram