

Catalogue No: **N1 160**

FUSE gG DIN SIZE 1 500V AC 160A

Power Distribution and Protection > Fuse Isolators and Fuse Gear > Fuses and Fuse Holders > NHP Fuses and Fuse Holders > DIN Fuse Links 500V AC > 500V gG Size 1



Representative Photo Only
(actual product may vary based on configuration selections)

Fuse DIN Size1 160A

- Complies with AS/NZS 60269.2.1:2005 and IEC 60269-2-1
- 120 kA fault interruption capacity
- Type gG for general, cable, line and motor protection
- Sizes: 000,1,2,3, and 4
- Dimensions according to DIN43 620 parts 1-4
- Fuses include a RED blown fuse indicator in top of fuse body
- Lead-free contact blades
- Non- isolated standard applications metal gripping lugs
- Low temperature rise
- Low power losses
- 500 V AC rated

SPECIFICATIONS

Product Series	DIN
Component Type Fuse-gear	Fuse Link
Fuse Characteristic Type(s)	gG
Fuse Cartridge Size	1 size
Un, Nominal Operational Voltage, AC	500 V AC
Ue, Rated Operational Voltage, AC, max	500 V AC
Ue, Rated Operational Voltage, DC, max	440 V DC
Current, Breaking Capacity at Un	120 kA @Un
Power Dissipation, Max	11.2 W
Height	35 mm
Width	28 mm
Depth	135 mm
Weight	0.25 kg
Standards Compliance	AS/NZS 60269-2-1 IEC 60269-2-1 EN 60269-2-1 HD 60269-2
Certifications	CE



Catalogue No: **N1 160**

FUSE gG DIN SIZE 1 500V AC 160A

Power Distribution and Protection > Fuse Isolators and Fuse Gear > Fuses and Fuse Holders > NHP Fuses and Fuse Holders > DIN Fuse Links 500V AC > 500V gG Size 1

NHP

REFERENCES

IECEx Certificate -

Supplier Declaration of
Conformity: -

Installation Guide: -

User Manual: -

Manufacturer Datasheet: -

Manufacturer Catalogue
& Product Selection: -

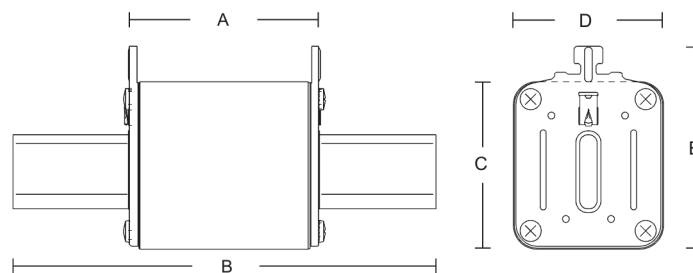

Series	Size Reference	A Body Length	B Body + Tags	C Body Height	D Body Width	E Body Height + Gripping Lugs
N000 6 – 125	000	49.0	78.0	40.0	21.0	52.5
N00 125 – 160	00	49.0	78.0	48.0	30.0	58.5
N1 16 – 160	1	65.0	135.0	46.0	28.0	65.0
N1 200 – 250	1	65.0	135.0	46.0	46.0	58.5
N2 36 – 160	2	65.0	150.0	46.0	28.0	72.5
N2 200 – 250	2	65.0	150.0	47.5	47.5	70.0
N2 300 – 400	2	65.0	150.0	56.0	56.0	71.0
N3 315 – 400	3	68.0	150.0	56.5	57.0	84.0
N3 425 – 630	3	66.0	150.0	66.5	67.0	84.0
N4 800	4	90	203	110	105	121
N4 900	4	90	203	110	105	121
N4 1000	4	90	203	110	105	121
N4 1250	4	90	203	110	105	121
N4 1600	4	90	203	110	105	121

Dimension Diagram