

# Catalogue No: **ABS 381913 G**

## TERMINAL BOX SOLID ABS IP66/67 H190 x W380 x D130mm GREY

Enclosures and Climate Control > Standard Enclosures > Terminal Boxes > Thermoplastic Terminal Boxes > Solid Range > Solid ABS Enclosures with Grey Cover (Mounting Plates Sold Separately)



### Enclosure Terminal Box Solid ABS IP66/67 Grey W380xH190xD130mm

- IP66/67 rated, PC: IK08 (side surface) IK09 (front surface), ABS: IK08
- Halogen free, impact resistant polycarbonate or ABS
- Totally insulated, polyurethane gasket and polyamide screws
- Grey RAL 7035 coloured base with option of transparent or grey cover
- RoHS compliant

Representative Photo Only  
(actual product may vary based on configuration selections)

#### SPECIFICATIONS

Product Series	Solid
Material, Body / Housing	ABS material
Height	188 mm
Width	378 mm
Depth	130 mm
Depth, Base	100 mm
IK Rating	IK08
IP Rating	IP66 IP67
Colour, Body / Housing	Light Grey (RAL 7035) colour
Colour, Cover	Grey colour
Electrical Insulation	Totally insulated
Halogen Free	Yes
UV Rating	Indoor Use Only
Glow Wire Rating	IEC 60695-2-1 650°C
Material, Gasket / Seal	PUR / PU material
Material, Screws / Fastening	Polyamide Screws/Fastening
Standards Compliance	EN 60529 EN 60950 EN 62208:2003 EN 62262 IEC 60695-2-1 650°C
Certifications	GOST-R RoHS

# Catalogue No: **ABS 381913 G**

## TERMINAL BOX SOLID ABS IP66/67 H190 x W380 x D130mm GREY

Enclosures and Climate Control > Standard Enclosures > Terminal Boxes > Thermoplastic Terminal Boxes > Solid Range > Solid ABS Enclosures with Grey Cover (Mounting Plates Sold Separately)



### REFERENCES

IECEX Certificate -

Supplier Declaration of Conformity: -

Installation Guide: -

User Manual: -

Manufacturer Datasheet: -

Manufacturer Catalogue & Product Selection: -

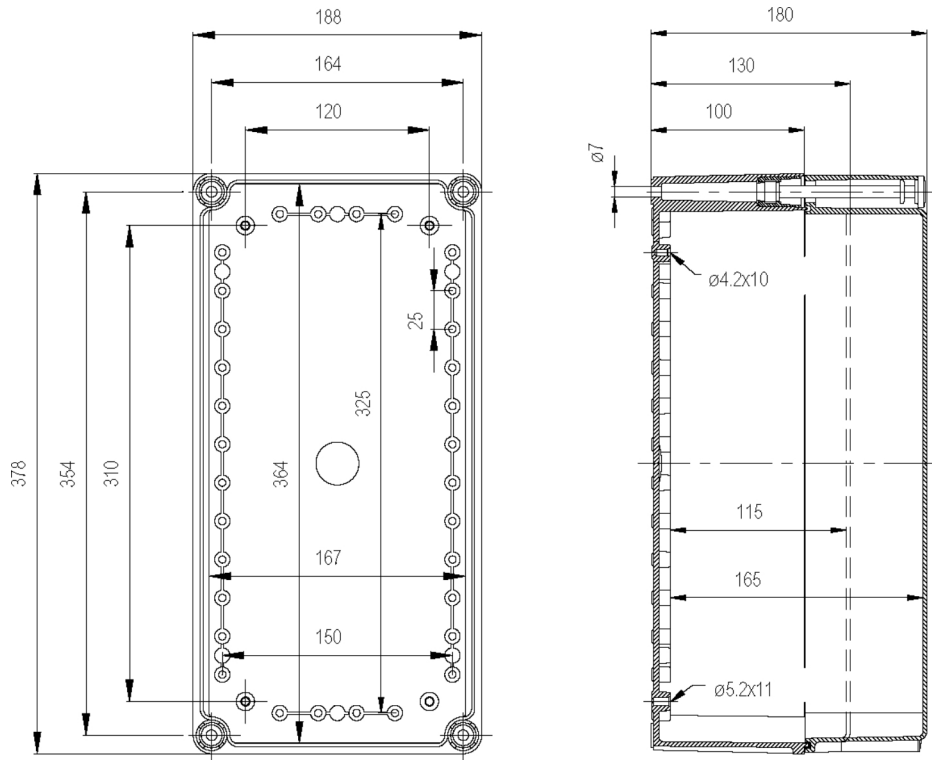

Dimension Diagram