

Surface Finish

Available Finish

Hot Dip Galvanised
Stainless Steel

Code

H
S

Ordering

- Sold in pack quantities.

Note

- Stainless steel products are manufactured against firm orders only and are non returnable.

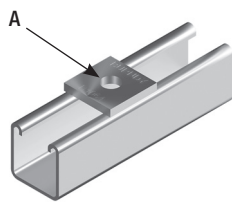

Ordering Code	A	Wt/kg
B1062	M8	0.071
B1063	M10	0.065
B1064	M12	0.064
B1964	M16	0.064

B1062 to B1964

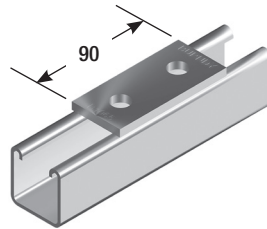

B1065 Wt 0.16 kg

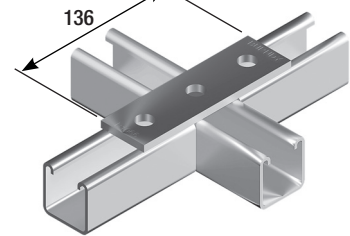

B1066 Wt 0.24 kg

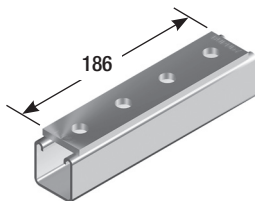

B1067 Wt 0.32 kg

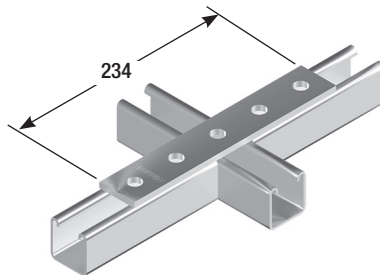

B1941 Wt 0.43 kg

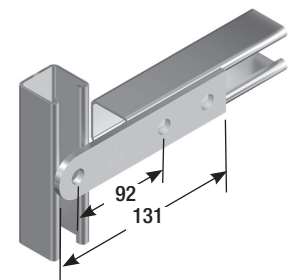

B2324 Wt 0.34 kg

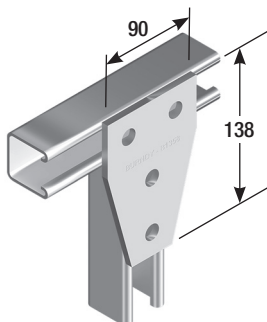

B1358 Wt 0.48 kg

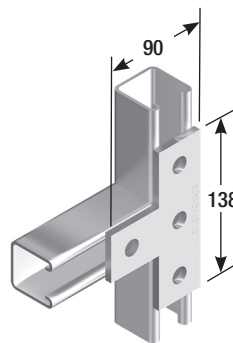

B1031 Wt 0.34 kg

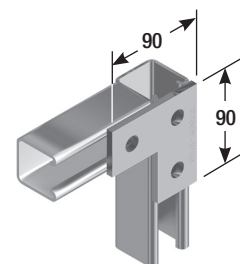

B1036 Wt 0.25 kg

channel

fasteners

cantilever brackets

channel fittings

tray systems

steel cable ladders

aluminium cable ladders

covers

Surface Finish

Available Finish

Hot Dip Galvanised
Stainless Steel

Code

H
S

Ordering

- Sold in pack quantities.

Note

- Stainless steel products are manufactured against firm orders only and are non returnable.

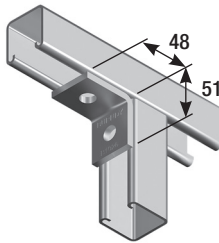

B1026

▶ Wt 0.17 kg

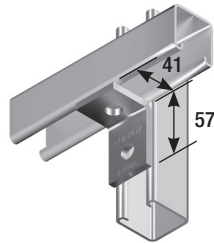

B1068

▶ Wt 0.17 kg

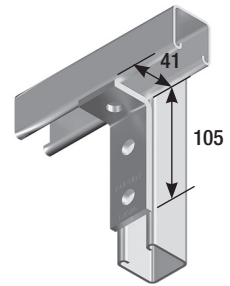

B1326

▶ Wt 0.24 kg

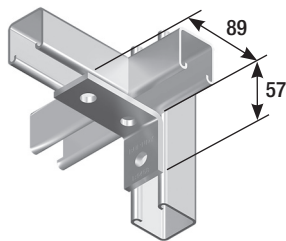

B1458

▶ Wt 0.24 kg

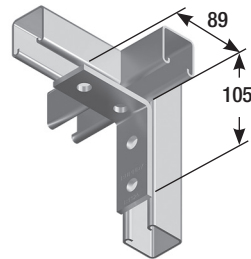

B1325

▶ Wt 0.33 kg

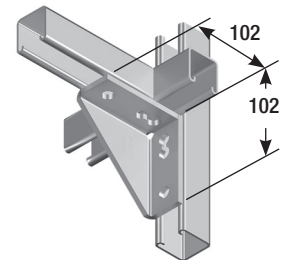

B2484

▶ Wt 0.61 kg

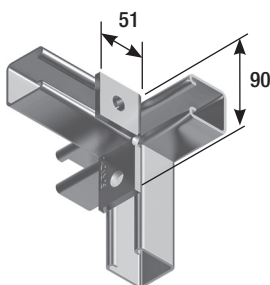

B1037

▶ Wt 0.25 kg

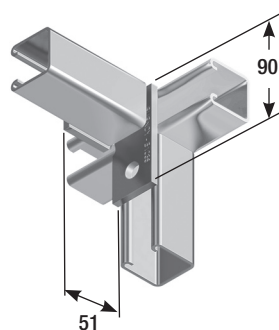

B1038

▶ Wt 0.25 kg

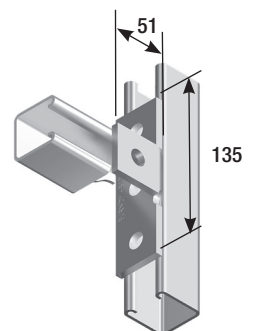

B1033

▶ Wt 0.32 kg

Surface Finish	Available Finish	Code
	Hot Dip Galvanised	H
	Stainless Steel	S

Ordering - Sold in pack quantities.

Note - Stainless steel products are manufactured against firm orders only and are non returnable.

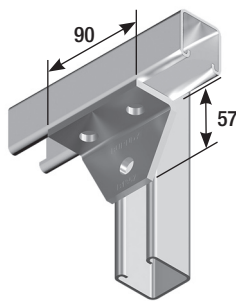

B1357 Wt 0.33 kg

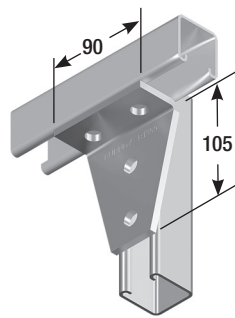

B1359 Wt 0.48 kg

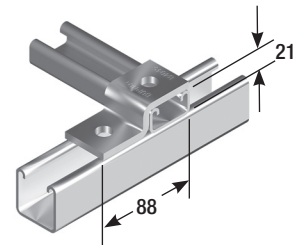

B4045 Wt 0.25 kg

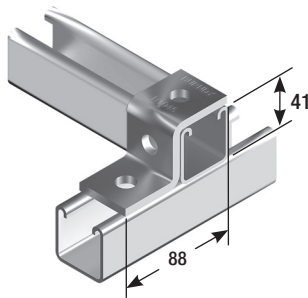

B1045 Wt 0.24 kg

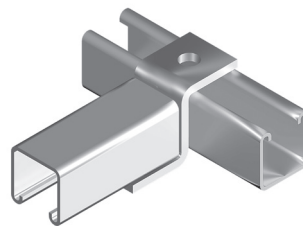

B1347 Wt 0.24 kg

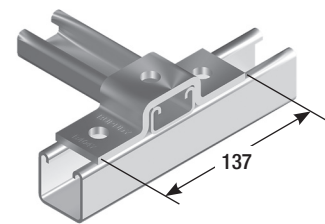

B4047 Wt 0.30 kg

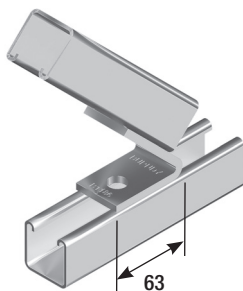

B1186 Wt 0.26 kg

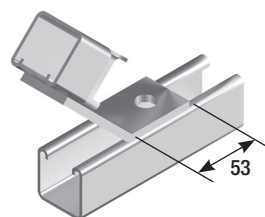

B1546 Wt 0.26 kg

channel

fasteners

cantilever brackets

channel fittings

tray systems

steel cable ladders

aluminium cable ladders

covers

Surface Finish

Available Finish

Hot Dip Galvanised
Stainless Steel

Code

H
S

Ordering

- Sold in pack quantities.

Note

- Stainless steel products are manufactured against firm orders only and are non returnable.

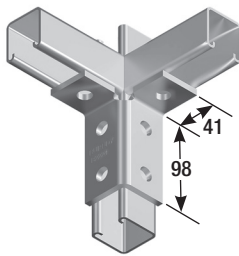

B2224

▶ Wt 0.55 kg

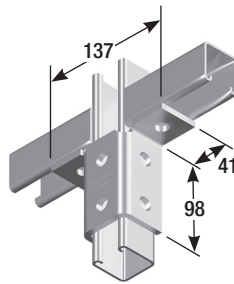

B2346

▶ Wt 0.67 kg

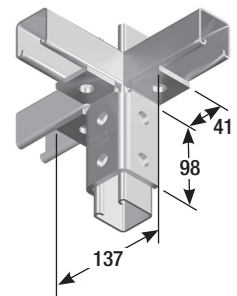

B2228

▶ Wt 0.85 kg

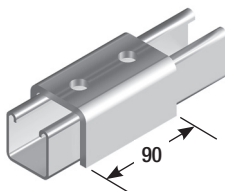

B1376

▶ Wt 0.56 kg

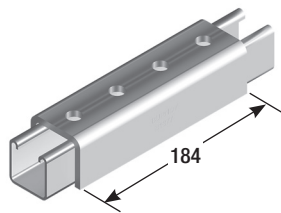

B1377

▶ Wt 1.15 kg

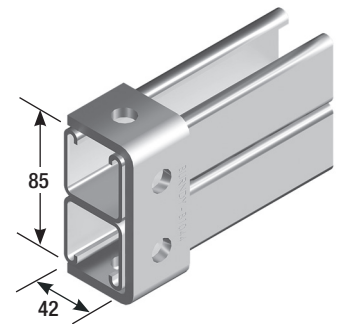

B1044

▶ Wt 0.30 kg

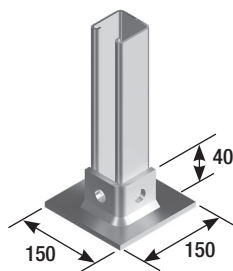

B2072S1

▶ Wt 0.65 kg

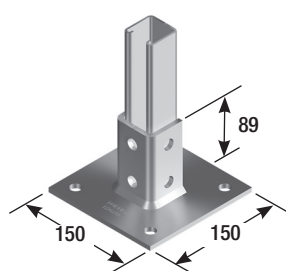

B2072A

▶ Wt 1.64 kg

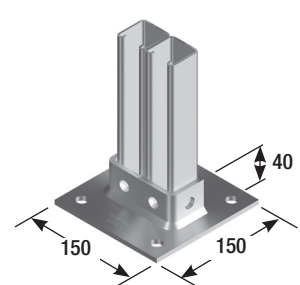

B2073

▶ Wt 1.40 kg

Surface Finish

Available Finish

- Hot Dip Galvanised
- Stainless Steel

Code

- H
- S

Ordering

- Sold in pack quantities.

Note

- Stainless steel products are manufactured against firm orders only and are non returnable.

Packaged with HS1260 and HN12 for assembly.

Fasteners for assembly onto channel must be ordered separately.

- 4 x B1010
- 4 x HS1225

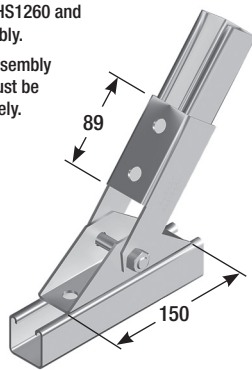

B2815

▶ Wt 1.39 kg

Packaged with HS1260 and HN12 for assembly.

Fasteners for assembly onto channel must be ordered separately.

- 4 x B1010
- 4 x HS1225

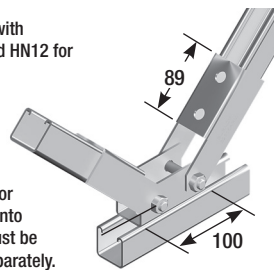

B2815D

▶ Wt 2.27 kg

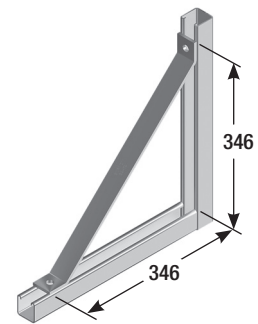

B2452

▶ Wt 0.72 kg

Note: Must be used in pairs.

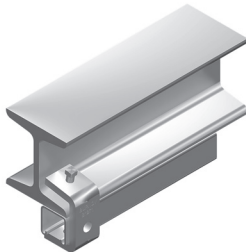

B1271

▶ Wt 0.43 kg

Note: Must be used in pairs.

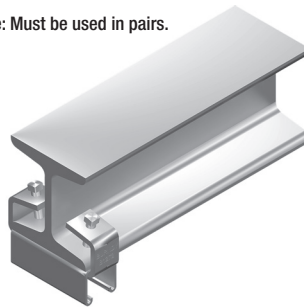

B1272

▶ Wt 0.18 kg

Note: Must be used in pairs.

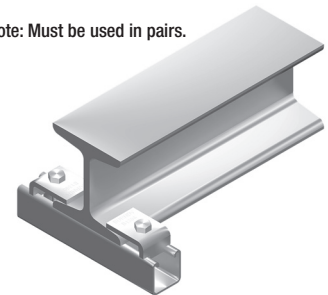

Fasteners for assembly must be ordered separately.

- 1 x B1010
- 1 x HS1225

B1386

▶ Wt 0.12 kg

Note: Must be used in pairs.

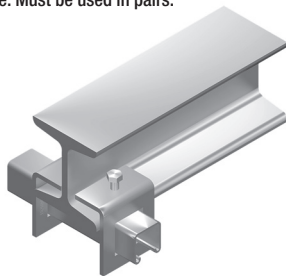

B1796

▶ Wt 0.49 kg

Note: Must be used in pairs.

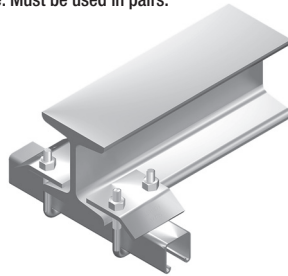

B2785

▶ Wt 0.41 kg

Note: Must be used in pairs.

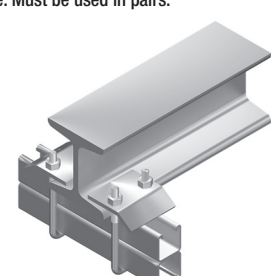

B2786

▶ Wt 0.46 kg

channel

fasteners

cantilever brackets

channel fittings

tray systems

steel cable ladders

aluminium cable ladders

covers

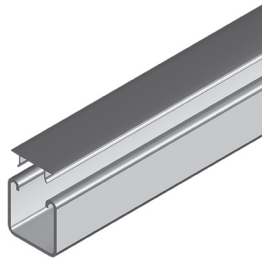

Sold in three metre lengths.

B1184

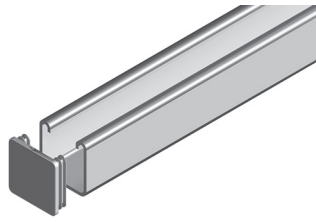

B1180

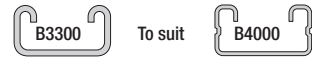
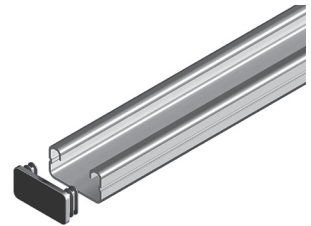

B3380

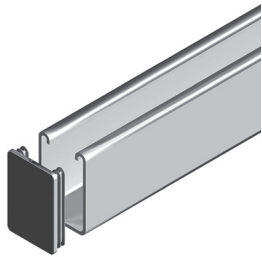

Suits B5500 channel.

B5580

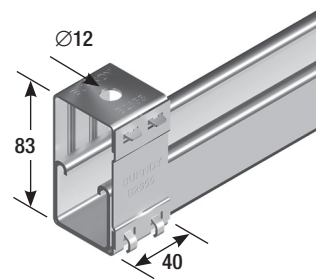

Hole diameter to suit M10 threaded rod.

B2855



Wt 0.18 kg

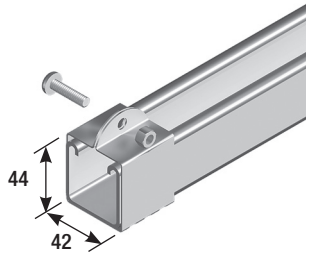

Supplied complete with PS625 and HN6 for assembly.

B2539



Wt 0.11 kg

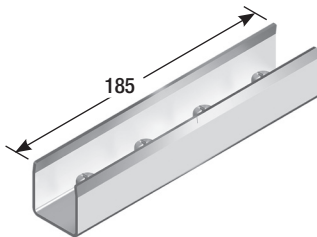

Joiner is designed to fit inside of the channel and is supplied with grub screws for fixing.

B922



Wt 0.30 kg

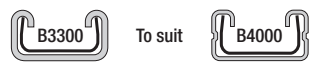
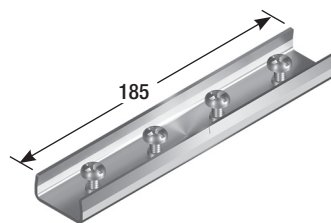

Joiner is designed to fit inside of the channel and is supplied with grub screws for fixing.

B422



Wt 0.18 kg

Available Finish

- Hot Dip Galvanised
- Stainless Steel

Note

- Stainless steel products are manufactured against firm orders only and are non returnable.
- Minimum order quantity of 50.
- Sold in pack quantities.

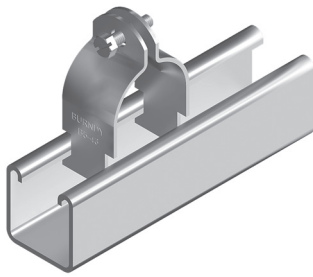

Supplied complete with screw

B5 Cable and Pipe Clamps

Product Code	Generic Reference	weight kg
B5-8	2024	0.04
B5-11	2025	0.04
B5-14	2026	0.04
B5-17	2027	0.04
B5-19	2028	0.05
B5-21	2029	0.05
B5-25	2030	0.05
B5-27	-	0.05
B5-29	2031	0.07
B5-32	2032	0.07
B5-34	2033	0.08
B5-38	2034	0.08
B5-43	2035	0.09
B5-48	2037	0.12
B5-51	2038	0.12
B5-54	2039	0.13
B5-57	2040	0.13
B5-60	2041	0.14
B5-64	2042	0.14
B5-67	2043	0.15
B5-70	2044	0.15
B5-73	2045	0.16
B5-76	2046	0.16
B5-79	2047	0.17

- H Hot Dip Galvanised
- S Stainless Steel



Sold in 20 metre rolls

B2600 Isolation Strip

Product Code	Generic Reference	weight kg
B5-83	2048	0.17
B5-86	2049	0.18
B5-89	2050	0.18
B5-92	2051	0.19
B5-95	2052	0.19
B5-98	2053	0.20
B5-102	2054	0.21
B5-105	2055	0.21
B5-108	2056	0.21
B5-111	2057	0.22
B5-114	2058	0.22
B5-117	2059	0.23
B5-121	2060	0.23
B5-127	2062	0.24
B5-133	2064	0.25
B5-140	2066	0.27
B5-146	2068	0.28
B5-152	2070	0.28
B5-160	2070-62	0.30
B5-165	2070-64	0.31
B5-171	2070-66	0.32
B5-178	2070-70	0.33
B5-191	2070-74	0.35
B5-203	2070-80	0.37

- H Hot Dip Galvanised
- S Stainless Steel

channel

fasteners

cantilever brackets

channel fittings

tray systems

steel cable ladders

aluminium cable ladders

covers

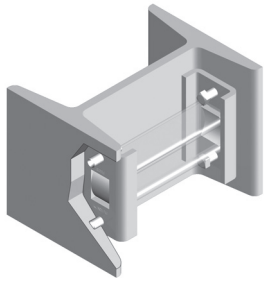

The data is based on a B1000 Channel.

B3087

▶ Wt: 0.84 kg

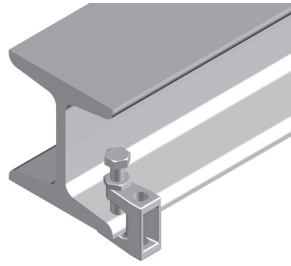

Suits M10 threaded rod.

BC10H

▶ Wt: 0.18 kg

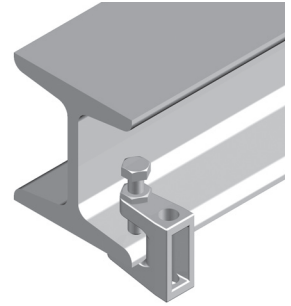

Suits M12 threaded rod.

BC12H

▶ Wt: 0.25 kg



Available in zinc plated finish only.
Suits M10 threaded rod only.

PC10Z

▶ Wt: 0.05 kg



Available in zinc plated finish only.

B2749

▶ Wt: 0.44 kg

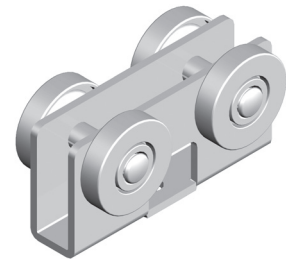

Available in zinc plated finish only.

B2750

▶ Wt: 0.23 kg

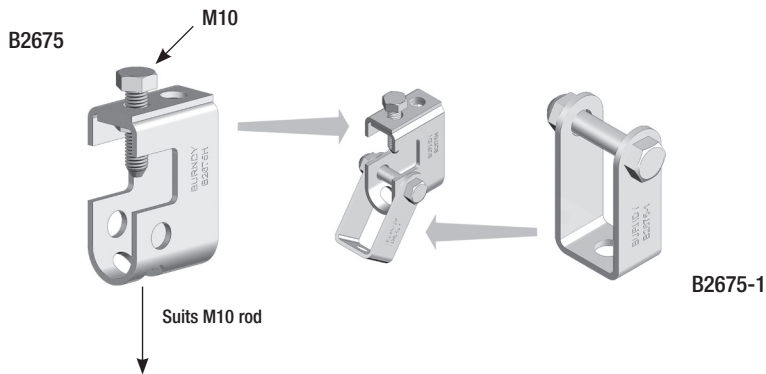

B2675

▶ Wt: 0.19 kg

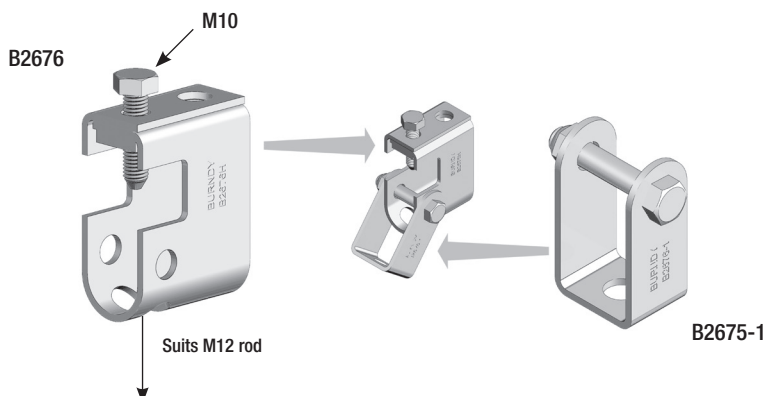

B2676

▶ Wt: 0.26 kg