

KMS-EX 1000V - Universal Cable Stripper for External Insulation

APPLICATION RANGE	Ø > 25mm
INSULATION THICKNESS	0 - 5 mm
SUGGESTED APPLICATION	PVC / Rubber

Technical Characteristics

- Designed to strip outer sheath from MV and LV cables
- Longitudinal and circular cuts
- Designed to strip both ends and midspan
- Stripping without cutting what is below
- Interchangeable two-sided blade
- Snap closure mechanism (KMS-EX only)

Additional Features Model KMS-EX

- Suitable for work on live parts up to 1000V AC Under 1500V DC
- Model KMS-EX 1000V is also designed for very low temperature uses, down to -40°C

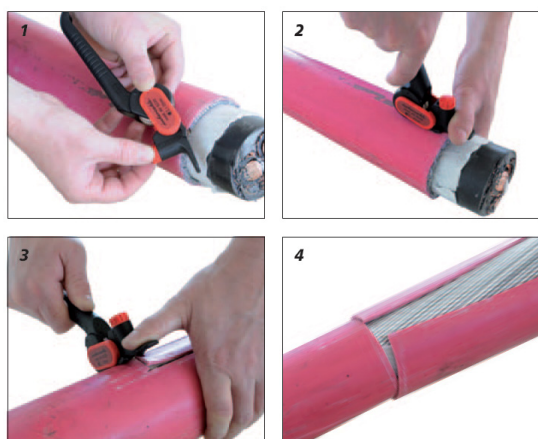

- NO DAMAGING OF BELOW SURFACE
- LONG LASTING PRECISE INTERCHANGEABLE TWO SIDED BLADE

Ordering Information

DESCRIPTION	ORDER NO.	DIMENSIONS	WEIGHT
Set	KMS-EX	160 x 35 x 65mm	200g
Spare blade	KMS BLADE	-	-

SET Equipment

- Plastic case to contain the tool and its instructions for use KMS-EX

*Note: Do not use on live conductor unless following appropriate live line working procedures with the correct protective equipment

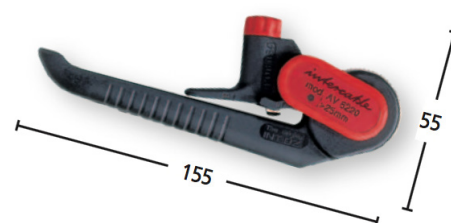

Universal cable stripper KMS-EX

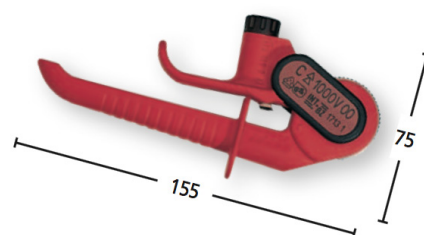

Universal cable stripper KMS-EX 1000V



AMS 1000V-Set-1713 0

In support of our policy of continuous product improvement we reserve the right to change materials and specifications without notice. Drawings, where used, are not to scale. All dimensions are in millimetres and sizes given are approximate. Where possible, technical MSDS data sheets are made available on the website. All products should be installed and used in accordance with manufacturer's instructions provided. Warning: products may be the subject of registered designs and patents. Refer to website for terms and conditions on warranty.