

5.3 METAL CONDUIT ACCESSORIES

5.3.1 CONDUIT VICE - ANACONDA

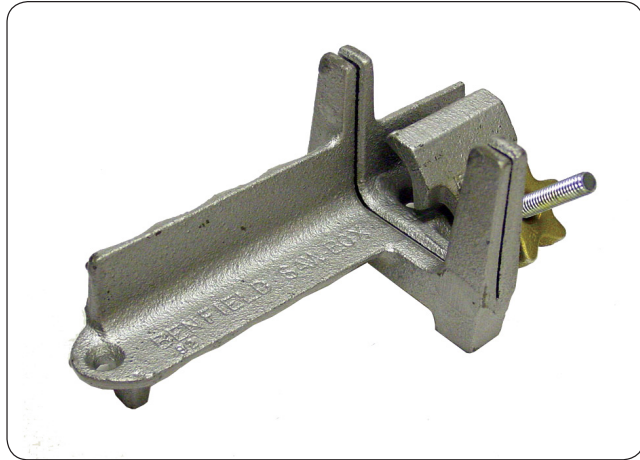

PART NUMBER: ANACONDA-VICE

FEATURES:

- Free standing or bench mountable
- Ideal for use with Anaconda flexible metal conduit
- Used to make precision cuts on conduit
- Portable
- Clamp holds conduit in place, wriggle-free
- Cuts up to 63mm (2") OD max conduit

5.3.2 BRASS REDUCERS - ALCO



FEATURES:

- Unplated brass female reducers
- Suitable for use with Anaconda flexible metal conduit
- Ideal for connecting two lengths of consecutive sized conduit together
- Available for 16mm to 50mm conduit
- Not suitable for use in hazardous areas

SPECIFICATIONS:

PART NUMBER	MOUNTING THREAD DIAMETER X PITCH	TOTAL LENGTH	THREAD LENGTH	DIAMETER ACROSS POINTS	BOX QTY
ALCBCR2016	M20 x 1.5 – M16 x 1.5	21	16	24	10
ALCBCR2520	M25 x 1.5 – M20 x 1.5	21	16	29	10
ALCBCR3225	M32 x 1.5 – M25 x 1.5	25	20	36	5
ALCBCR4032	M40 x 1.5 – M32 x 1.5	25	20	44	5
ALCBCR5040	M50 x 1.5 – M40 x 1.5	25	20	55	2
ALCBCR6350	M63 x 1.5 – M50 x 1.5	25	20	67	1

All dimensions in mm unless otherwise specified.

5.3.3 STAINLESS STEEL LOCKNUT - WATTMASTER



FEATURES:

- Ideal for fastening conduit fittings
- Made from Stainless Steel grade 316
- Suitable for Wattmaster range of conduit fittings

SPECIFICATIONS:

PART NUMBER	DESCRIPTION	MATERIAL	MOUNTING THREAD DIAMETER X PITCH	WIDTH	BOX QTY
LN-M16-SS	16mm Locknut	Stainless Steel	M16 X 1.5	19	10
LN-M20-SS	20mm Locknut	Stainless Steel	M20 X 1.5	24	10
LN-M25-SS	25mm Locknut	Stainless Steel	M25 X 1.5	30	10
LN-M32-SS	32mm Locknut	Stainless Steel	M32 X 1.5	36	10
LN-M40-SS	40mm Locknut	Stainless Steel	M40 X 1.5	46	10
LN-M50-SS	50mm Locknut	Stainless Steel	M50 X 1.5	60	10
LN-M63-SS	63mm Locknut	Stainless Steel	M63 X 1.5	70	1

All dimensions in mm unless otherwise specified.