

Spec Sheet: IPD Safeclick Fuse Fittings

- Self cleaning, self aligning base contacts
- Clip-in fuse links, no tools required for fuse replacement
- Full shrouded contacts, IP20 degree of protection
- DIN rail mounting with easy to remove carrier
- Made from flame retardant thermoplastic

Standards

Australian Standard AS60269 and BS88 Part 6



Range

<i>Rated current (Ie)</i>	32A
<i>Rated voltage (Ue)</i>	550V
<i>Rated peak withstand current</i>	80kA
<i>Rated impulse withstand voltage (Uimp)</i>	8kV
<i>Screw mounting size (all)</i>	M5
<i>Weight 1P (Front wire)</i>	0.1kg
<i>Max Cable Size (front / rear)</i>	16mm ²
<i>Maximum tightening torque (front)</i>	1.5-2Nm
<i>Fuse type (suit all)</i>	NS_

Rated Current (A)	Type of Connection	Colour	Pack Quantity	Catalogue Number	
20A	Front Wire Bases	Black	10	SC20H	
		White		SC20HWH	
32A	Front Wire Bases	Black		5	SC32H
		White			SC32HWH
	Back Wire Base	Black	SC32BW		
	Busbar / Front, 1 Stud	Black	SC32BHA		
	2 Stud Rear, 2 stud	Black	SC32P		
	2 Stud Rear, 2 stud	White	SC32PWH		
	Solid Neutral Link – suit white base	-	10	SC20/32LINK	
Accessories					
-	Protective Boots – suit rear stud mod	Black		RS20/32S	
80/120 ¹⁾	12P Busbar, 27mm centres	Grey	1	SCBB12	

¹⁾ 80A when end feed, 120A when center feed

Dimensions

Front Wire (type H)

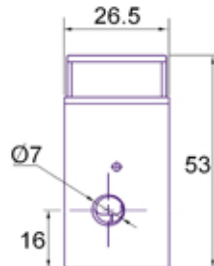
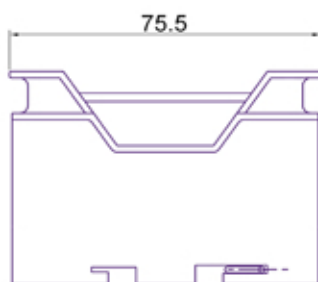

2 Stud Rear (type P)

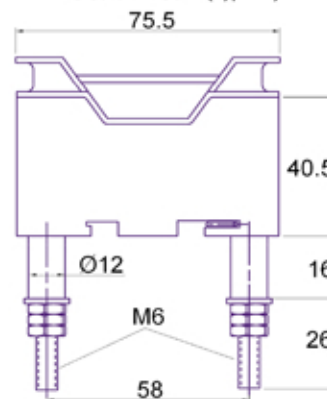

Front / Stud (type BHA)

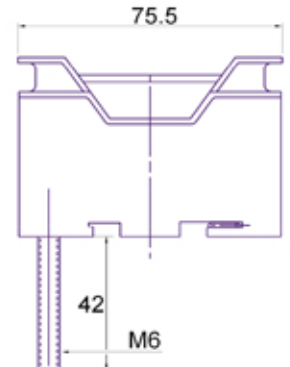

Rear Wire (Type BW)

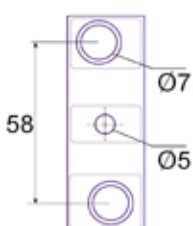

Rear View

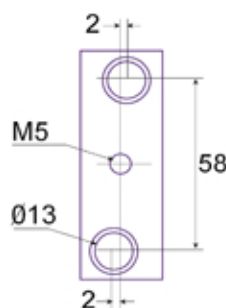

**Panel Drilling
Rear Wire & Rear Stud
(front view)**

Spec Sheet: Insulated Busbars

Pin type insulated busbar ideal for IPD Safe-Clip fuse holders

- Available in 27mm pitch.
- High temperature resistance and low flammability.
- Self-extinguishing and Halogen-free.
- Reduce shock hazard and reduce installation time.

Applications

- Safe-Clip fuse holders – control panels.



Ratings

Rated voltage: (Ui)	400V
High voltage strength:	3kV
Rated Conditional Short-cct Current	25kA
With maximum fuse (A)	100A
Standard:	VDE 0606/9.77
Max Busbar Current (End Feed)	80A
Max Busbar Current (Centre Feed)	120A
Cross-section of bar (mm²)	16mm ²
Pitch	27mm
Material	Copper
546288 (Max Cable size)	25mm ²

Rated Current (A)	Rated AC Voltage (V AC)	Poles	Pack Quantity	Catalogue Number
80 / 120	400	12	1	SCBB12
80 / 12	400	37	1	SCBB37
115	600	1	1	546288

Dimensions

546288

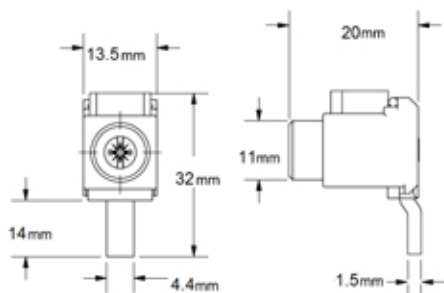

SCBB Series

