



Monarch IP - Stainless Steel Multiple Application Enclosure Systems

Index

[Dimension Sheet](#)

[Dimension Sheet – Viewing Window](#)

[Catalogue Information](#)

[Leaflet](#)

Web Links

[Monarch IP SS Information Page](#)

[Ask a question / Send us an enquiry](#)

[Information about B&R](#)

[Local Sales Team Phone Numbers](#)



DIMENSION SHEET

MONARCH IP

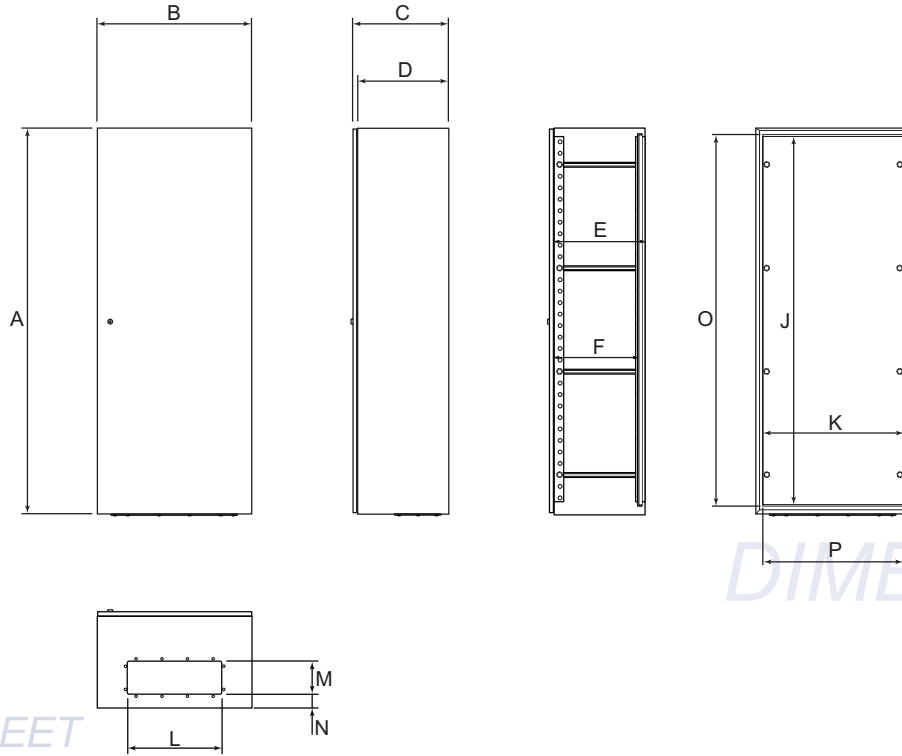

DIMENSION SHEET

Stainless Steel Enclosures

Catalogue Number	External Dimensions				Internal Depth		Mounting Pan		Gland Plate			Opening Size	
	A	B	C	D	E	F	J	K	L	M	N	O	P
IP09051/S	300	200	175	149	171	145	250	150	—	—	—	255	155
IP13091/S	400	300	175	149	171	145	350	250	—	—	—	355	255
IP13132/S	400	400	270	244	266	231	320	340	—	—	—	340	340
IP13212/S	400	600	270	244	266	231	320	540	—	—	—	340	540
IP21132/S	600	400	270	244	266	231	520	340	—	—	—	540	340
IP21212/S	600	600	270	244	266	231	520	540	—	—	—	540	540
IP21292/S	600	800	270	244	266	231	520	740	—	—	—	540	740
IP29212/S	800	600	270	244	266	231	720	540	—	—	—	740	540
IP37212/S	1000	600	270	244	266	231	920	540	—	—	—	940	540
IP45212/S	1200	600	270	244	266	231	1120	540	—	—	—	1140	540
IP13214/S	400	600	400	374	380	361	320	540	490	170	73	340	540
IP21214/S	600	600	400	374	380	361	520	540	490	170	73	540	540
IP21294/S	600	800	400	374	380	361	520	740	490	170	73	540	740
IP25254/S	700	700	400	374	380	361	620	640	490	170	73	640	640
IP29214/S	800	600	400	374	380	361	720	540	490	170	73	740	540
IP29294/S	800	800	400	374	380	361	720	740	490	170	73	740	740
IP37254/S	1000	700	400	374	380	361	920	640	490	170	73	940	640
IP37294/S	1000	800	400	374	380	361	920	740	490	170	73	940	740
IP45214/S	1200	600	400	374	380	361	1120	540	490	170	73	1140	540
IP45294/S	1200	800	400	374	380	361	1120	740	490	170	73	1140	740
IP61214/S	1600	600	400	374	380	361	1520	540	490	170	73	1540	540
IP61294/S	1600	800	400	374	380	361	1520	740	490	170	73	1540	740
IP69214/S	1800	600	400	374	380	361	1720	540	490	170	73	1740	540
IP69294/S	1800	800	400	374	380	361	1720	740	490	170	73	1740	740
IP77214/S	2000	600	400	374	380	361	1920	540	490	170	73	1940	540
IP77294/S	2000	800	400	374	380	361	1920	740	490	170	73	1940	740
IP21295/S	600	800	500	474	480	461	520	740	490	170	73	540	740
IP45215/S	1200	600	500	474	480	461	1120	540	490	170	73	1140	540
IP45295/S	1200	800	500	474	480	461	1120	740	490	170	73	1140	740
IP61215/S	1600	600	500	474	480	461	1520	540	490	170	73	1540	540
IP61295/S	1600	800	500	474	480	461	1520	740	490	170	73	1540	740
IP69215/S	1800	600	500	474	480	461	1720	540	490	170	73	1740	540
IP69295/S	1800	800	500	474	480	461	1720	740	490	170	73	1740	740
IP77215/S	2000	600	500	474	480	461	1920	540	490	170	73	1940	540
IP77295/S	2000	800	500	474	480	461	1920	740	490	170	73	1940	740
IP77216/S	2000	600	600	574	580	561	1920	540	490	170	73	1940	540
IP77296/S	2000	800	600	574	580	561	1920	740	490	170	73	1940	740



DIMENSION SHEET

CHANNEL IRON PLINTH – MONARCH IP

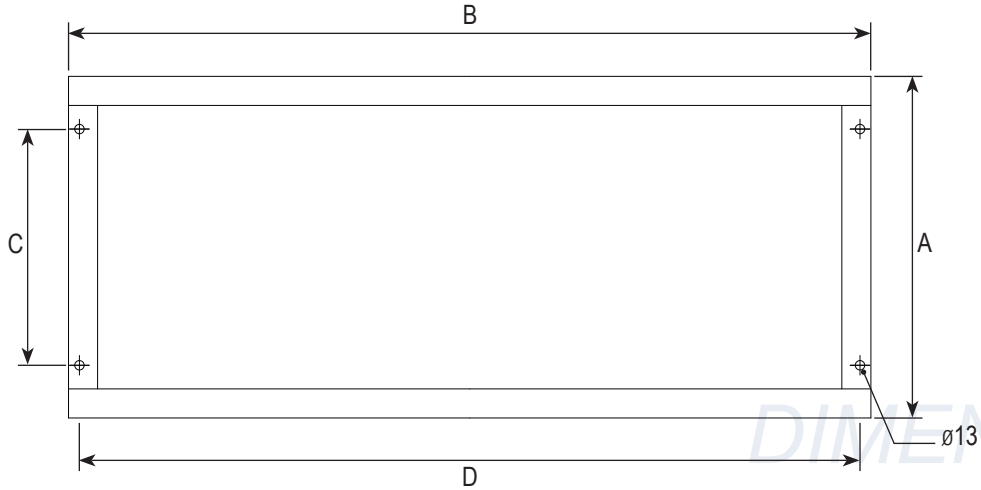

DIMENSION SHEET

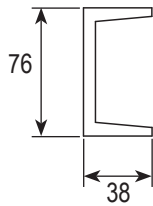

DIMENSION SHEET

Catalogue Number	External Dimensions			
	A	B	C	D
IPPC212	241	600	176	570
IPPC214	371	600	225	570
IPPC294	371	800	225	770
IPPC424	371	1200	225	1170
IPPC584	371	1600	225	1570
IPPC215	471	600	325	570
IPPC295	471	800	325	770
IPPC425	471	1200	325	1170
IPPC505	471	1400	325	1370
IPPC585	471	1600	325	1570
IPPC216	571	600	425	570
IPPC296	571	800	425	770

ON SHEET

DIMENSION SHEET



DIMENSION SHEET

MONARCH IP – VIEWING WINDOW

Image A:

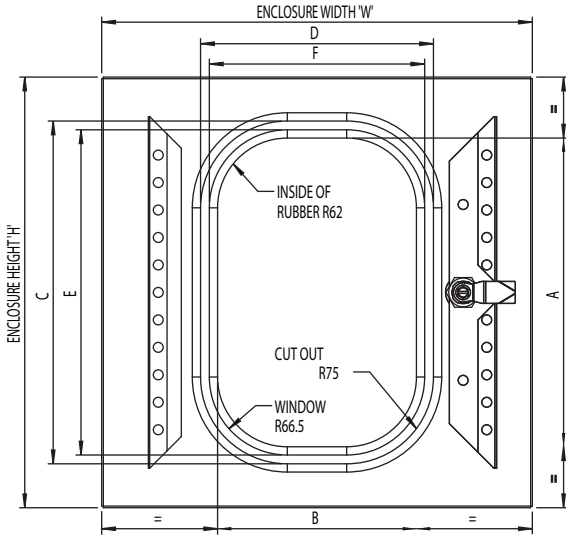

Door Inside View

Image B:

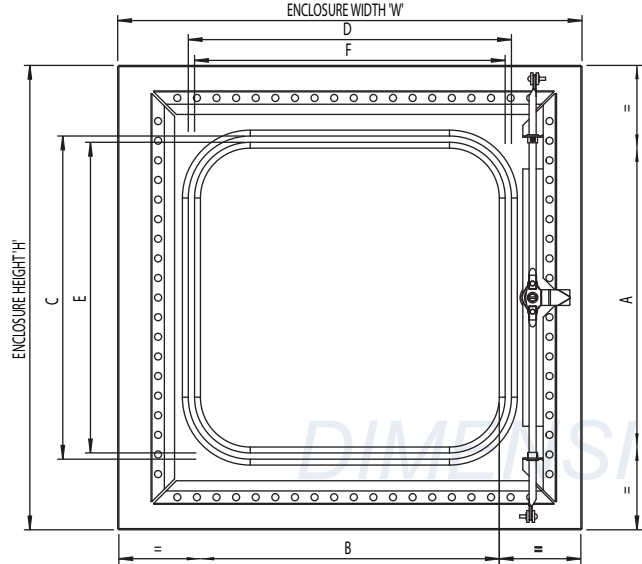

Door Inside View

DIMENSION SHEET

Table A:

Catalogue Number	Enclosure Size		Viewing Area		Cutout Size		Window Size	
	Height	Width	A	B	C	D	E	F
IP2121 IP2121/S	400	400	288	188	312	212	296	196
IP2113 IP2113/S	600	400	488	188	512	212	496	196

Table B:

Catalogue Number	Enclosure Size		Viewing Area		Cutout Size		Window Size	
	Height	Width	A	B	C	D	E	F
IP1321	400	600	188	388	212	412	196	396
IP2121 IP2121/S	600	600	388	388	412	412	396	396
IP2921 IP2921/S	800	600	588	388	612	412	596	396
IP2129	600	800	388	588	412	612	396	596
IP2525	700	700	488	488	512	512	496	496
IP2929	800	800	588	588	612	612	596	596
IP3721 IP3721/S	1000	600	788	388	812	412	796	396
IP3725	1000	700	788	488	812	512	796	496
IP3729/S	1000	800	788	588	812	612	796	596
IP45212	1200	600	988	388	1012	412	996	396
IP4529 IP4529/S	1200	800	988	588	1012	612	996	596
IP6121	1600	600	1388	388	1412	412	1396	396
IP6129	1600	800	1388	588	1412	612	1396	596
IP6921	1800	600	1588	388	1612	412	1596	396
IP6929 IP6929/S	1800	800	1588	588	1612	612	1596	596
IP7721	2000	600	1788	388	1812	412	1796	396
IP7729	2000	800	1788	588	1812	612	1796	596

ON SHEET

HEET

HEET



Monarch IP

Industrial Enclosure & Switchboard Building System

brenclosures.com.au/ip.htm



Monarch IP Features

- Many mounting options, providing the flexibility to install equipment in almost any position
- Wide range of accessories available for added versatility in equipment application
- Approvals
 - CE marked
 - Lloyds
- Materials
 - Body - see tables
 - Body thickness - see tables
 - Gasket - polyurethane
- Surface finish - powdercoated
- Protection rating - IP66

The Monarch IP is the top of the range general purpose enclosure and switchboard building system. Designed to be the ultimate in flexibility, the Monarch IP is a modular range of robust enclosures with a range



of accessories to suit almost every requirement. The Monarch IP range is suitable for small motor control applications, lighting, CT metering and smaller switchboard applications.

Inclusions

'C' rail mountings (4 rails on heights up to 800 mm and 8 rails on larger), gland plate (fitted internally or externally on all but 175 and 270 mm deep stainless units), 7 mm square turnbuckle lock (IP020 on zinc coated steel/aluminium and black powdercoated lock with stainless steel insert on stainless steel) on units below 1600 mm high and lockable 'L' handles (IP050) on others, 3 point locking on units of 600 mm high and above, removable back on units above 270 mm deep, door rails, earth strap kit.



Monarch IP Selection Guide

Catalogue No	Nominal Dimensions# (mm)			Usable Depth (mm)	Materials		
	Height	Width	Depth				
IP09051/S*	300	200	175	135		•	
IP13091/S*	400	300	175	135		•	
IP13132*	400	400	270	230	•	•	•
IP21132*	600	400	270	230	•	•	•
IP13212*	400	600	270	230	•	•	•
IP21212*	600	600	270	230	•	•	•
IP29212*	800	600	270	230	•	•	•
IP37212*	1000	600	270	230	•	•	•
IP45212*	1200	600	270	230	•	•	•
IP21292*	600	800	270	230	•	•	•
IP13214	400	600	400	360	•	•	•
IP21214	600	600	400	360	•	•	•
IP29214	800	600	400	360	•	•	•
IP45214	1200	600	400	360	•	•	•
IP61214	1600	600	400	360	•	•	•
IP69214	1800	600	400	360	•	•	•
IP77214	2000	600	400	360	•	•	•
IP25254	700	700	400	360	•	•	•
IP37254	1000	700	400	360	•	•	•
IP21294	600	800	400	360	•	•	•
IP29294	800	800	400	360	•	•	•
IP37294	1000	800	400	360	•	•	•
IP45294	1200	800	400	360	•	•	•
IP61294	1600	800	400	360	•	•	•
IP69294	1800	800	400	360	•	•	•
IP77294	2000	800	400	360	•	•	•
IP29215	800	600	500	460	•	•	•
IP45215	1200	600	500	460	•	•	•
IP61215	1600	600	500	460	•	•	•
IP69215	1800	600	500	460	•	•	•
IP77215	2000	600	500	460	•	•	•
IP21295	600	800	500	460	•	•	•
IP45295	1200	800	500	460	•	•	•
IP61295	1600	800	500	460	•	•	•
IP69295	1800	800	500	460	•	•	•
IP77295	2000	800	500	460	•	•	•
IP29216	800	600	600	560	•	•	•
IP45216	1200	600	600	560	•	•	•
IP61216	1600	600	600	560	•	•	•
IP77216	2000	600	600	560	•	•	•
IP77296	2000	800	600	560	•	•	•

* Stainless steel version of these models do not come with gland plate as standard

Plus 7 mm for aluminium enclosures



Zinc coated steel. See page 66 & 67 for thickness, weights and material specific accessories.



316 stainless steel (add "/S" to the end of the part number). See page 68 & 69 for thickness, weights and material specific accessories.



Aluminium (add "/A" to the end of the part number). See page 70 for thickness and weights.

Internal & General Accessories – See foldout



Monarch IP – 316 Stainless Steel Industrial Enclosure & Switchboard Building System

316 Stainless Steel Thickness & Weights

	IP09051/S	IP13091/S	IP13132/S	IP13212/S	IP13214/S	IP21132/S	IP21212/S	IP21214/S	IP21292/S	IP21294/S	IP21295/S	IP25254/S	IP29212/S	IP29214/S	IP29215/S	IP29216/S	IP29294/S	IP37212/S	IP37254/S	IP37294/S	IP45212/S	
Material thickness - 316 stainless steel (mm)	1.2	1.2	1.5	1.5	1.5	1.5	1.5	1.5	1.5	1.5	1.5	1.5	1.5	1.5	1.5	1.5	1.5	1.5	1.5	1.5	1.5	1.5
Weight (kg)	4.2	6.5	12.1	16.0	19.8	16.0	20.9	25.4	25.8	31.0	35.0	31.3	25.8	31.0	35.0	39.0	37.6	30.7	40.4	44.3	35.6	

Monarch IP Accessories - 316 Stainless Steel Specific

See foldout sections at the back of this catalogue for internal and general accessories.

Accessories below are specific to the 316 stainless steel enclosure material.

Product	Description	Catalogue No	IP09051/S	IP13091/S	IP13132/S	IP13212/S	IP13214/S	IP21132/S	IP21212/S	IP21214/S	IP21292/S	IP21294/S	IP21295/S	IP25254/S	IP29212/S	IP29214/S	IP29215/S	IP29216/S	IP29294/S	IP37212/S	IP37254/S	IP37294/S	IP45212/S		
Rainhood - 316 stainless steel	30x200x189mm	IPRH051/S	•																						
	30x300x189mm	IPRH091/S		•																					
	30x400x284mm	IPRH132/S			•			•																	
	30x600x284mm	IPRH212/S				•			•							•						•		•	
	30x600x414mm	IPRH214/S					•			•							•								
	30x600x514mm	IPRH215/S																•							
	30x600x614mm	IPRH216/S																	•						
	30x700x414mm	IPRH254/S														•							•		
	30x800x284mm	IPRH292/S										•													
	30x800x414mm	IPRH294/S											•									•		•	
	30x800x514mm	IPRH295/S												•											
	30x800x614mm	IPRH296/S																							
Gland plate - 316 stainless steel	320x110x1.5mm	IPGS31			•			•																	
	480x160x1.5mm	IPGS41				•			•		•				•						•			•	
	530x210x1.5mm	IPGS52					•			•		•	•	•		•				•		•	•	•	
Plinth - access - 316 stainless steel	200x600x374mm	IPPH214/S						•		•						•									
	200x600x474mm	IPPH215/S															•								
	200x600x574mm	IPPH216/S																•							
	200x800x374mm	IPPH294/S										•								•			•		
	200x800x474mm	IPPH295/S											•												
200x800x574mm	IPPH296/S																								
Vent kit - external	130x130mm	IPVK/S	•	•	•	•	•	•	•	•	•	•	•	•	•	•	•	•	•	•	•	•	•	•	
Vent hood - 316 stainless steel	to suit FAN/FIL12* 300mm high	IPVH12/S		•	•	•	•	•	•	•	•	•	•	•	•	•	•	•	•	•	•	•	•	•	
	to suit FAN/FIL25* 400mm high	IPVH25/S								•		•	•	•		•	•	•	•			•	•		
	to suit FAN/FIL35* 475mm high	IPVH35/S											•				•	•							
Wall mounting brackets (pack of 4)	316 stainless steel	MEB/S	•	•	•	•	•	•	•	•	•	•	•	•	•	•	•	•	•	•	•	•	•	•	
Universal mounting brackets (pack of 4)	316 stainless steel	IPWM/S	•	•	•	•	•	•	•	•	•	•	•	•	•	•	•	•	•	•	•	•	•	•	

* See page 108 for information on fans and filters.



316 Stainless Steel Thickness & Weights

	IP45214/S	IP45215/S	IP45216/S	IP45294/S	IP45295/S	IP61214/S	IP61215/S	IP61216/S	IP61294/S	IP61295/S	IP69214/S	IP69215/S	IP69294/S	IP69295/S	IP77214/S	IP77215/S	IP77216/S	IP77294/S	IP77295/S	IP77296/S
Material thickness - 316 stainless steel (mm)	1.5	1.5	1.5	1.5	1.5	1.5	1.5	1.5	1.5	1.5	1.5	1.5	1.5	1.5	1.5	1.5	1.5	1.5	1.5	1.5
Weight (kg)	42.2	47.3	52.3	50.9	56.5	53.4	59.5	65.6	64.3	70.9	59.0	65.6	70.9	78.1	64.6	71.8	78.9	77.6	85.3	93.0

Monarch IP Accessories - 316 Stainless Steel Specific

See foldout sections at the back of this catalogue for internal and general accessories.

Accessories below are specific to the 316 stainless steel enclosure material.

Product	Description	Catalogue No	IP45214/S	IP45215/S	IP45216/S	IP45294/S	IP45295/S	IP61214/S	IP61215/S	IP61216/S	IP61294/S	IP61295/S	IP69214/S	IP69215/S	IP69294/S	IP69295/S	IP77214/S	IP77215/S	IP77216/S	IP77294/S	IP77295/S	IP77296/S		
Rainhood - 316 stainless steel	30x200x189 mm	IPRH051/S																						
	30x300x189 mm	IPRH091/S																						
	30x400x284 mm	IPRH132/S																						
	30x600x284 mm	IPRH212/S																						
	30x600x414 mm	IPRH214/S	•					•					•				•							
	30x600x514 mm	IPRH215/S		•					•					•				•						
	30x600x614 mm	IPRH216/S			•						•													
	30x700x414 mm	IPRH254/S																						
	30x800x284 mm	IPRH292/S																						
	30x800x414 mm	IPRH294/S					•				•				•						•			
30x800x514 mm	IPRH295/S						•				•				•						•			
30x800x614 mm	IPRH296/S																					•		
Gland plate - 316 stainless steel	320x110x1.5 mm	IPGS31																						
	480x160x1.5 mm	IPGS41	•					•	•				•	•				•	•	•				
	530x210x1.5 mm	IPGS52				•	•				•	•			•	•					•	•	•	
Plinth - access - 316 stainless steel	200x600x374 mm	IPPH214/S	•					•					•					•						
	200x600x474 mm	IPPH215/S		•					•					•					•					
	200x600x574 mm	IPPH216/S			•					•										•				
	200x800x374 mm	IPPH294/S				•					•				•						•			
	200x800x474 mm	IPPH295/S					•					•				•						•		
200x800x574 mm	IPPH296/S																					•		
Vent kit - external	130x130 mm	IPVK/S	•	•	•	•	•	•	•	•	•	•	•	•	•	•	•	•	•	•	•	•	•	
Vent hood - 316 stainless steel	to suit FAN/FIL12* 300mm high	IPVH12/S	•	•	•	•	•	•	•	•	•	•	•	•	•	•	•	•	•	•	•	•	•	
	to suit FAN/FIL25* 400mm high	IPVH25/S	•	•	•	•	•	•	•	•	•	•	•	•	•	•	•	•	•	•	•	•	•	
	to suit FAN/FIL35* 475mm high	IPVH35/S		•	•		•		•		•		•		•		•		•		•		•	
Wall mounting brackets (pack of 4)	316 stainless steel	MEB/S	•	•	•	•	•	•	•	•	•	•	•	•	•	•	•	•	•	•	•	•	•	
Universal mounting brackets (pack of 4)	316 stainless steel	IPWM/S	•	•	•	•	•	•	•	•	•	•	•	•	•	•	•	•	•	•	•	•	•	

* See page 108 for information on fans and filters.

Monarch IP

General Purpose Enclosures - IP66



The Monarch IP is the top of the range general purpose enclosure and switchboard building system. Designed to be the ultimate in flexibility, the Monarch IP is a modular range of robust enclosures with a range of accessories to suit almost every requirement.

Protected to IP66 and manufactured from 316 Stainless Steel, the IP range is suitable for small motor control applications, lighting, CT metering and smaller switchboard applications. Zincanneal steel and aluminium (in project quantities) are also available to suit other applications.

Size Range Summary

Model	IP09051/S	IP13091/S	IP13132/S	IP21132/S	IP13212/S	IP21212/S	IP29212/S	IP37212/S	IP45212/S	IP21292/S
Height	300	400	400	600	400	600	800	1000	1200	600
Width	200	300	400	400	600	600	600	600	600	800
Depth	175	175	270	270	270	270	270	270	270	270

Model	IP13214/S	IP21214/S	IP29214/S	IP45214/S	IP61214/S	IP69214/S	IP77214/S	IP25254/S	IP37254/S	IP21294/S
Height	400	600	800	1200	1600	1800	2000	700	1000	600
Width	600	600	600	600	600	600	600	700	700	800
Depth	400	400	400	400	400	400	400	400	400	400

Model	IP29294/S	IP37294/S	IP45294/S	IP61294/S	IP69294/S	IP77294/S	IP29215/S	IP45215/S	IP61215/S	IP69215/S
Height	800	1000	1200	1600	1800	2000	800	1200	1600	1800
Width	800	800	800	800	800	800	600	600	600	600
Depth	400	400	400	400	400	400	500	500	500	500

Model	IP77215/S	IP21295/S	IP45295/S	IP61295/S	IP69295/S	IP77295/S	IP77216/S	IP77296/S
Height	2000	600	1200	1600	1800	2000	2000	2000
Width	600	800	800	800	800	800	600	800
Depth	500	500	500	500	500	500	600	600

Monarch IP Features

- Protection rating of IP66 certified by NATA to ensure protection against dust and water in demanding conditions
- 316 stainless steel, corrosion resistant construction with an N4 surface finish for durability and to minimise 'tea staining' in a harsh Australian climate
- 115° opening door and gland plate as standard for ease of access to internal systems
- Specially designed gutter system that helps extend the life of the gasket whilst preventing water entering the enclosure
- Polyurethane gasket foamed in place to ensure sealing, protecting internal equipment
- Earthing strap supplied with each enclosure for additional safety
- Many mounting options, providing the flexibility to install equipment in almost any position
- Wide range of accessories available for added versatility in equipment application
- Optional viewing window for monitoring equipment operation

Approvals
CE marked
Lloyds

Materials
Body - 316 stainless steel
Body Thickness - 1.2/1.5mm
Gasket - Polyurethane

Surface Finish - N4

Protection Rating - IP66

Guides
Material selection - page 290

Also of interest
Smaller sizes - page 94

Drawing
Page 273

Inclusions

White mounting pan, 'C' rail mountings, gland plate on all but 175 and 270 series enclosures, earth strap kit, door rails.

Accessories Summary

Mounting pans, insulating panels, escutcheons, shelves, plinths, rainhood, vent kits, climate control, lifting brackets, mounting brackets, door stay kit, internal lights, plan and schedule holder, various lock options, rails and rail kits.

Monarch IP Enclosures & Dimensions

Model	Dimensions (mm)			Usable Depth (mm)	Material Thickness (mm)	Weight (kg)
	Height	Width	Depth			
IP09051/S	300	200	175	135	1.2	4.2
IP13091/S	400	300	175	135	1.2	6.5
IP13132/S	400	400	270	230	1.2	12.1
IP21132/S	600	400	270	230	1.5	16.0
IP13212/S	400	600	270	230	1.2	16.0
IP21212/S	600	600	270	230	1.5	20.9
IP29212/S	800	600	270	230	1.5	25.8
IP37212/S	1000	600	270	230	1.5	30.7
IP45212/S	1200	600	270	230	1.5	35.6
IP21292/S	600	800	270	230	1.5	25.8
IP13214/S	400	600	400	360	1.5	19.8
IP21214/S	600	600	400	360	1.5	25.4
IP29214/S	800	600	400	360	1.5	31.0
IP45214/S	1200	600	400	360	1.5	42.2
IP61214/S	1600	600	400	360	1.5	53.4
IP69214/S	1800	600	400	360	1.5	59.0
IP77214/S	2000	600	400	360	1.5	64.6
IP25254/S	700	700	400	360	1.5	31.3
IP37254/S	1000	700	400	360	1.5	40.4
IP21294/S	600	800	400	360	1.5	31.0
IP29294/S	800	800	400	360	1.5	37.6
IP37294/S	1000	800	400	360	1.5	44.3
IP45294/S	1200	800	400	360	1.5	50.9
IP61294/S	1600	800	400	360	1.5	64.3
IP69294/S	1800	800	400	360	1.5	70.9
IP77294/S	2000	800	400	360	1.5	77.6
IP29215/S	800	600	500	460	1.5	35.0
IP45215/S	1200	600	500	460	1.5	47.3
IP61215/S	1600	600	500	460	1.5	59.5
IP69215/S	1800	600	500	460	1.5	65.6
IP77215/S	2000	600	500	460	1.5	71.8
IP21295/S	600	800	500	460	1.5	35.0
IP45295/S	1200	800	500	460	1.5	56.5
IP61295/S	1600	800	500	460	1.5	70.9
IP69295/S	1800	800	500	460	1.5	78.1
IP77295/S	2000	800	500	460	1.5	85.3
IP77216/S	2000	600	600	560	1.5	78.9
IP77296/S	2000	800	600	560	1.5	93.0

Monarch IP Accessories

Metal Mounting Pans

Mounting pans are very simple to install using the existing rails supplied as part of the Monarch IP enclosure. They are manufactured from 2 mm thick pretreated mild steel with a gloss white powdercoat finish.

Catalogue Number	To suit enclosures Height x Width (mm)	Mounting Pan Dimensions (mm)		
		Height	Width	Thickness
IPMP0905	300 x 200	250	150	2
IPMP1309	400 x 300	350	250	2
IPMP1313	400 x 400	320	340	2
IPMP1321	400 x 600	320	540	2
IPMP2113	600 x 400	520	340	2
IPMP2121	600 x 600	520	540	2
IPMP2129	600 x 800	520	740	2
IPMP2525	700 x 700	620	640	2
IPMP2921#	800 x 600	720	540	2
IPMP2929#	800 x 800	720	740	2
IPMP3721#	1000 x 600	920	540	2
IPMP3725#	1000 x 700	920	640	2
IPMP3729#	1000 x 800	920	740	2
IPMP4521#	1200 x 600	1120	540	2
IPMP4529#	1200 x 800	1120	740	2
IPMP6121*	1600 x 600	1520	540	2
IPMP6129*	1600 x 800	1520	740	2
IPMP6921*	1800 x 600	1720	540	2
IPMP6929*	1800 x 800	1720	740	2
IPMP7721*	2000 x 600	1920	540	2
IPMP7729*	2000 x 800	1920	740	2

Mounting pan features single return on sides and single return on top for extra rigidity.

* Mounting pan features double return on sides and single return on top for extra rigidity.



Insulated Mounting Pans

Insulated mounting pans are provided where use of a metallic pan is not acceptable. Manufactured from black laminated phenolic material, and supplied with all fixings, the insulated mounting pan is easy to install and use.

Catalogue Number	To suit enclosures Height x Width (mm)	Mounting Pan Dimensions (mm)		
		Height	Width	Thickness
IPFP0905	300 x 200	250	150	6
IPFP1309	400 x 300	350	250	6
IPFP1313	400 x 400	320	340	6
IPFP1321	400 x 600	320	540	6
IPFP2113	600 x 400	520	340	6
IPFP2121	600 x 600	520	540	6
IPFP2129	600 x 800	520	740	6
IPFP2525	700 x 700	620	640	6
IPFP2921	800 x 600	720	540	6
IPFP2929	800 x 800	720	740	6
IPFP3721	1000 x 600	920	540	6
IPFP3725	1000 x 700	920	640	8
IPFP3729	1000 x 800	920	750	8
IPFP4521	1200 x 600	1120	540	8
IPFP4529	1200 x 800	1120	740	8



Monarch IP Accessories

Double Hinged Insulating Panels

Double hinged insulating panels are mainly used for metering applications. They provide a functional, alternative mounting solution for equipment installation requirements.

Catalogue Number	To suit enclosures Height x Width (mm)	Mounting Pan Dimensions (mm)		
		Height	Width	Thickness
IPHP1313	400 x 400	320	325	6
IPHP1321	400 x 600	320	525	6
IPHP2113	600 x 400	520	325	6
IPHP2121	600 x 600	520	525	6
IPHP2129	600 x 800	520	725	6
IPHP2421	Partial Height	595	525	6
IPHP2429	Partial Height	595	725	6
IPHP2525	700 x 700	620	625	6
IPHP2921	800 x 600	720	525	6
IPHP2929	800 x 800	720	725	6
IPHP3229	Partial Height	795	725	6
IPHP3721	1000 x 600	920	525	6
IPHP3725	1000 x 700	920	625	8
IPHP3729	1000 x 800	920	725	8
IPHP4521	1200 x 600	1120	525	8
IPHP4529	1200 x 800	1120	725	8



Hinged Escutcheons

For mounting internal controls and accessories, B&R provides a comprehensive range of hinged escutcheons. They can be mounted singularly or with two or more fitted into the enclosure. Fitting requires universal rail kit (see page 115).

Catalogue Number	To suit enclosures Height x Width (mm)	Mounting Pan Dimensions (mm)		
		Height	Width	Thickness
IPHE1313	400 x 400*	324.5	319.5	18
IPHE1321	400 x 600*	319.5	524.5	18
IPHE2113	600 x 400*	524.5	319.5	18
IPHE2121	600 x 600*	524.5	519.5	18
IPHE2129	600 x 800*	524.5	719.5	18
IPHE2421	Partial Height	599.5	519.5	18
IPHE2429	Partial Height	599.5	719.5	18
IPHE2525	700 x 700*	624.5	619.5	18
IPHE2921	800 x 600*	724.5	519.5	18
IPHE2929	800 x 800*	724.5	719.5	18
IPHE3221	Partial Height	799.5	519.5	18
IPHE3229	Partial Height	799.5	719.5	18
IPHE3721	1000 x 600*	924.5	519.5	18
IPHE3725	1000 x 700*	924.5	619.5	18
IPHE3729	1000 x 800*	924.5	719.5	18
IPHE4521	1200 x 600*	1124.5	519.5	18
IPHE4529	1200 x 800*	1124.5	719.5	18
IPHE6121	1600 x 600*	1524.5	519.5	18
IPHE6129	1600 x 800*	1524.5	719.5	18
IPHE6921	1800 x 600*	1724.5	519.5	18
IPHE6929	1800 x 800*	1724.5	719.5	18
IPHE7721	2000 x 600	1924.5	519.5	18
IPHE7729	2000 x 800	1924.5	719.5	18



* Can be fitted to larger enclosures if a partial escutcheon is required, as shown to the right.

Monarch IP Accessories (continued)

Fixed Escutcheons

Fixed escutcheons are used for fitting internal controls and accessories. They form a second tier mounting arrangement, in front of the mounting pan. Fitting requires universal rail kit (see page 116).

Catalogue Number	Part No. of Rail Kit Required for Installation	Dimensions (mm)		
		Height	Width	Depth
IPFE1308	N/A Use IPUV	324.5	199.5	18
IPFE1313	IPRK1313	324.5	324.5	18
IPFE1316	N/A Use IPUV	324.5	399.5	18
IPFE1321	IPRK1321	324.5	524.5	18
IPFE1329	N/A Use IPUV	324.5	724.5	18
IPFE1616	N/A Use IPUV	399.5	399.5	18
IPFE2108	N/A Use IPUV	524.5	199.5	18
IPFE2113	IPRK2113	524.5	324.5	18
IPFE2116	N/A Use IPUV	524.5	399.5	18
IPFE2121	IPRK2121	524.5	524.5	18
IPFE2129	IPRK2129	524.5	724.5	18
IPFE2408	N/A Use IPUV	599.5	199.5	18
IPFE2413	N/A Use IPUV	599.5	324.5	18
IPFE2416	N/A Use IPUV	599.5	399.5	18
IPFE2421	N/A Use IPUV	599.5	524.5	18
IPFE2429	N/A Use IPUV	599.5	724.5	18
IPFE2525	IPRK2525	624.5	624.5	18
IPFE2908	N/A Use IPUV	724.5	199.5	18
IPFE2916	N/A Use IPUV	724.5	399.5	18
IPFE2921	IPRK2921	724.5	524.5	18
IPFE2929	IPRK2929	724.5	724.5	18
IPFE3208	N/A Use IPUV	799.5	199.5	18
IPFE3213	N/A Use IPUV	799.5	324.5	18
IPFE3216	N/A Use IPUV	799.5	399.5	18
IPFE3221	N/A Use IPUV	799.5	524.5	18
IPFE3229	N/A Use IPUV	799.5	724.5	18
IPFE3708	N/A Use IPUV	924.5	199.5	18
IPFE3713	N/A Use IPUV	924.5	324.5	18
IPFE3716	N/A Use IPUV	924.5	399.5	18
IPFE3721	IPRK3721	924.5	524.5	18
IPFE3725	IPRK3725	924.5	624.5	18
IPFE3729	IPRK3729	924.5	724.5	18
IPFE4508	N/A Use IPUV	1124.5	199.5	18
IPFE4513	N/A Use IPUV	1124.5	324.5	18
IPFE4516	N/A Use IPUV	1124.5	399.5	18
IPFE4521	IPRK4521	1124.5	524.5	18
IPFE4529	IPRK4529	1124.5	724.5	18



Monarch IP Accessories

Gland Plates

Gland plates are designed for efficient and flexible fitting and installation of cable glands.

Catalogue Number	Material	Dimensions (mm)			To suit enclosures Width (mm)
		Width	Depth	Thickness	
IPGB31	Brass	320	110	6	400
IPGS31	Stainless Steel	320	110	1.6	
IPGB41	Brass	480	160	6	600
IPGS41	Stainless Steel	480	160	1.6	
IPGB52	Brass	530	210	6	700, 800
IPGS52	Stainless Steel	530	210	1.6	



Shelves

White powdercoat shelving made from 1.6mm Zinccanear® steel, and complete with knockouts for cabling and all fittings. Shelves are designed for use as segregation panels for switchboard applications or mounting fixed equipment.

Catalogue Number	To suit enclosure Width x Depth (mm)	Dimensions (mm)	
		Width	Depth
IPSH211	600 x 175	563	105
IPSH212	600 x 270	563	160
IPSH214	600 x 400	563	290
IPSH215	600 x 500	563	390
IPSH216	600 x 600	563	490
IPSH254	700 x 400	663	290
IPSH292	800 x 270	763	160
IPSH294	800 x 400	763	290
IPSH295	800 x 500	763	390



Channel Iron Plinth

Hot dipped galvanised, 75 mm high plinths provide a rugged floor mounting option for the Monarch IP range.

Catalogue Number	To suit enclosures Width x Depth (mm)	Dimensions (mm)		
		Height	Width	Depth
IPPC212	600 X 270	75	600	250
IPPC214	600 x 400	75	600	371
IPPC215	600 x 500	75	600	471
IPPC216	600 x 600	75	600	571
IPPC254	700 x 400	75	700	371
IPPC294	800 x 400	75	800	371
IPPC295	800 x 500	75	800	471
IPPC296	800 x 600	75	800	571
IPPC424	1200 x 400	75	1200	371
IPPC425	1200 x 500	75	1200	471
IPPC505	1400 x 500	75	1400	471
IPPC584	1600 x 400	75	1600	371
IPPC585	1600 x 500	75	1600	471



Non-metallic

General Purpose

Stainless Steel

Mining & Hazardous

Switchboard Building

Datacoms

Climate Control

Technical Drawings

Enclosure Selection

Monarch IP Accessories (continued)

Access Plinth - Stainless Steel

An access plinth provides a secure ground mount base, with the flexibility of accessing the cabling within the base, and entering the gland plate on the enclosure.

Catalogue Number	To suit enclosures Width x Depth (mm)	Dimensions (mm)		
		Height	Width	Depth
IPPH214/S	600 x 400	200	600	374
IPPH215/S	600 x 500	200	600	474
IPPH216/S	600 x 600	200	600	574
IPPH294/S	800 x 400	200	800	374
IPPH295/S	800 x 500	200	800	474
IPPH296/S	800 x 600	200	800	574

Standard Fixing Brackets

Allows for easy installation of 'C' rails and escutcheon rails. These items come in packs of 10.

Catalogue Number	Description	Pack Quantity
IPTO	C Rail take off bracket	10
IPCJ	C Rail joining bracket	10
IPCB	C Rail clamp bracket	10
IPEJ	Escutcheon Rail joining bracket	10



Rainhoods - Stainless Steel

Rainhoods are designed to shed water from the top of the enclosure, and to prevent water from pooling on the enclosure top. They include a overhang of 14mm.

Catalogue Number	To suit enclosures Width x Depth (mm)	Dimensions (mm)		Slope Angle (Degrees)
		Width	Depth	
IPRH051/S	200 x 175	200	189	3
IPRH091/S	300 x 175	300	189	3
IPRH132/S	400 x 270	400	284	2
IPRH211/S	600 x 175	600	189	2
IPRH212/S	600 x 270	600	284	2
IPRH214/S	600 x 400	600	414	1.4
IPRH215/S	600 x 500	600	514	1.1
IPRH216/S	600 x 700	600	614	0.9
IPRH254/S	700 x 400	700	414	1.4
IPRH292/S	800 x 270	800	284	2
IPRH294/S	800 x 400	800	414	1.4
IPRH295/S	800 x 500	800	514	1.1
IPRH296/S	800 x 700	800	614	0.9



Monarch IP Accessories

External Vent Kit

Ensures that the enclosure does not become excessively hot by allowing natural circulation of air. The vent kit includes a gasket, insert filter and fittings. Note that by the nature of this item the enclosure will not be rated to IP66 when fitted with a vent kit. See page 117 for climate control equipment and vent hoods.

Catalogue Number	Description	Dimensions
IPVK/S	External vent kit - 316 Stainless Stl	130 x 130 mm (suits cutout 80 x 80 mm)



Lifting Brackets

For ease of installation and where the enclosure may be moved. Lifting brackets ensure that the enclosure is not damaged when lifted, and is moved safely.

Catalogue Number	Description	Pack Quantity
LEB/12	Lifting eye bolt	2

Mounting Brackets

For ease of installation and fixing to the mounting surface. Mounting brackets ensure optimum installation and safety.

Catalogue Number	Description	Mounting Style	Pack Quantity
IPWM/S	Stainless Steel 1.5 mm bracket	Floor	4
MEB/S	Stainless Steel 2 mm bracket	Wall	4



Door Stay

For ease of installation of equipment and maintenance. The door stay ensures that the door remains open even in windy weather, for the safety of people working on the equipment.

Catalogue Number	Description
IPDS	Left or right handed door stay kit



Plan Holder

Designed to hold a standard A4 document to ensure that it is kept clean and conveniently placed. Typically this would hold detailed procedures, diagrams etc.

Catalogue Number	Description
IPPLN	Plastic A4 plan holder



Non-metallic

General Purpose

Stainless Steel

Mining & Hazardous

Switchboard Building

Datacoms

Climate Control

Technical Drawings

Enclosure Selection

Monarch IP Accessories (continued)

Light Kits

For safety and to ensure easy installation and maintenance of equipment. The light kit comes complete with on-off switch, bracket, rail and fittings required for installation.

Catalogue Number	Description
IPLTK06	Light kit - 600 mm wide
IPLTK08	Light kit - 800 mm wide



Schedule Holder

To ensure that maintenance schedules are always displayed prominently, the schedule holder has been designed to be fitted to the enclosure door rail.

Catalogue Number	Description
IPLC40	Schedule holder - 40 lines
LCH60	Schedule holder - 60 lines
LCH78	Schedule holder - 78 lines
IPLC150	Schedule holder - 150 lines



Locks

For security and ease of opening, B&R offers the following locks for the Monarch IP enclosure.

Catalogue Number	Description
IP020/S	Stainless steel turnbuckle lock
IP111	Non lockable wing knob
IP030	Lockable wing knob - standard key code 92268
IP040	Lockable 'T' handle - standard key code 92268
IP050	Lockable 'L' handle - standard key code 92268
IP052	Padlockable 'L' handle
IP060/S	Padlockable swing handle - stainless steel



Spare Keys

Spare or replacement keys for the locks above.

Catalogue Number	Description
SKU	Three way moulded key to suit 7 mm square, 7 mm triangle and 5 mm double-bit
SK3	Spare key for lockable handles
SK7	Die cast 7 mm square key for IP020 & NI020



Night Latch Kit

Bracket that fits inside the enclosure to enable a Lockwood deadbolt type lock to be fitted.

Catalogue Number	Description
IPNLK	Night latch kit to suit lockwood deadbolt

Monarch IP Accessories

Fittings & Fixing Accessories

All brackets and fittings are supplied as a set, packed in economical quantities.

Catalogue Number	Description	Pack Quantity
IPCN06	M6 Foam Back Nut	20
IPCN08	M8 Foam Back Nut	20
IPCG06	M6 Cage Nut	20
IPCG08	M8 Cage Nut	20
IPN06	M6 Hex Nut	20
IPN08	M8 Hex Nut	20
IPTO616	M6 x 16 Taptite Screw	20
IPBO830	M8 x 30 Hexhead Bolt	20
IPBO825	M8 x 25 Hexhead Bolt	20
IPBO812	M8 x 12 Hexhead Bolt	20
IPBO625	M6 x 25 Hexhead Bolt	20
IPBO612	M6 x 12 Hexhead Bolt	20
IPWGLG	M8 Sealing Washer	20
IPWGSM	M6 Sealing Washer	20
IPSPW6	M6 Spring Washer	20
IPSPW8	M8 Spring Washer	20
IPWF06	M6 Flat Washer	20
IPWF08	M8 Flat Washer	20
IPWS06	M6 Star Washer	20
IPWS08	M8 Star Washer	20
IPOR06	M6 Sealing Ring	20
IPP06	M6 Hole Plug	20
IPP10	M10 Hole Plug	20



Standard Rails - C Section Rail

C section rails can be used to fit additional accessories, rails etc. into the enclosure. See page 112 for standard fixing brackets.

Catalogue Number	Description	Length (mm)
IPCR01	—	137
IPCR02	to suit 270 deep enclosures	232
IPCR03	to suit 400 deep enclosures	360
IPCR04	to suit 500 deep enclosures	460
IPCR05	to suit 600 deep enclosures	560
IPCR07	—	760
IPCR09	—	960
IPCR	—	3400



Non-metallic

General Purpose

Stainless Steel

Mining & Hazardous

Switchboard Building

Datacoms

Climate Control

Technical Drawings

Enclosure Selection

Monarch IP Accessories (continued)

Escutcheon Rail

Escutcheon rail are used where two escutcheons meet in the enclosure. See page 112 for standard fixing brackets.

Catalogue Number	Description	Length (mm)
IPER05	Escutcheon rail	525
IPER07	Escutcheon rail	725
IPER19	Escutcheon rail	1975



Universal Rail Kits (UV)

Universal rail kits are used to install both fixed and hinged escutcheons.

Catalogue Number	To suit enclosures Height x Width (mm)	Dimensions (mm)	
		Height	Width
IPRK1313	400 x 400	375	325
IPRK1321	400 x 600	375	525
IPRK1329	400 x 800	375	725
IPRK2113	600 x 400	575	325
IPRK2121	600 x 600	575	525
IPRK2129	600 x 800	575	725
IPRK2525	700 x 700	675	625
IPRK2921	800 x 600	775	525
IPRK2929	800 x 800	775	725
IPRK3721	1000 x 600	975	525
IPRK3725	1000 x 700	975	625
IPRK3729	1000 x 800	975	725
IPRK4521	1200 x 600	1175	525
IPRK4529	1200 x 800	1175	725
IPRK6121	1600 x 600	1575	525
IPRK6129	1600 x 800	1575	725
IPRK6921	1800 x 600	1775	525
IPRK6929	1800 x 800	1775	725
IPRK7721	2000 x 600	1975	525
IPRK7729	2000 x 800	1975	725



Universal Rail (UV)

Universal rails are designed for mounting equipment inside an enclosure. This is provided in the fixed lengths shown and can be cut to suit.

Catalogue Number	Description	Length (mm)
IUV	Universal Rail - 25 mm pitch	1975
UV1	Universal Rail - 20 mm pitch	1984
UV19	19" Racking Rail	1975



Monarch IP Accessories

DIN Rail

DIN rails are used for mounting DIN switchgear and accessories into the enclosure. It is available for all models in aluminium, steel and slotted designs.

Catalogue Number	Description	Length (mm)
IPDN03	Aluminium DIN Rail	360
IPDN05	Aluminium DIN Rail	560
IPDN07	Aluminium DIN Rail	760
DIN35/15AL	35 x 15mm Aluminium DIN Rail	2000
DIN35/7.5	35mm Steel DIN Rail	2000
DIN35/7.5SL	35mm Profile Steel Slotted DIN Rail	2000
DINSB	Rail Angle Support Bracket for DIN Rail	—



Busbar Rail

The busbar rail is a rail profile especially designed for the installation of B&R's range of TT101S and BR10 bus bar supports (see page 151-152).

Catalogue Number	Description	Length (mm)
TT201R	Galvabond® steel busbar rail	764

Climate Control

B&R supply a wide variety of climate control equipment to suit almost any application. For full details please see the climate control section of this catalogue starting on page 188. The below shows typical selections only.

Catalogue Number	Description	Dimensions (mm)			Power (W)
		Height	Width	Depth	
TX-FAN23BN0A	Fan – External, Output 110m ³ /h	250	250	111	20
TX-FAN25BN0A	Fan – External, Output 230m ³ /h	250	250	119	56
TX-FAN35BN0A	Fan – External, Output 550m ³ /h	325	325	151	90
TX-FIL25XN0A	Filter – Suits 110 or 230m ³ /h output fan	250	250	30	—
TX-FIL35XN0A	Filter – Suits 550m ³ /h output fan	325	325	30	—
TX-EGO10BM1A	Air Conditioner – Side mounted, 1050W cooling capacity	783	348	213	570
TX-MIX36BX0A	Heat Exchanger (air-air) – Side mounted 36W/K cooling	771	316	93	140



Vent Hoods

Vent hoods have been designed for the range of fans and filters on the previous page, and ensure that the fan is both protected mechanically, and further help protect from water and dust ingress.

Catalogue Number	Description	To suit
IPVH12/S	Vent Hood - 316 Stainless Steel	FAN/FIL12
IPVH25/S	Vent Hood - 316 Stainless Steel	FAN/FIL23 FAN/FIL25
IPVH35/S	Vent Hood - 316 Stainless Steel	FAN/FIL35

Non-metallic

General Purpose

Stainless Steel

Mining & Hazardous

Switchboard Building

Datacoms

Climate Control

Technical Drawings

Enclosure Selection



MULTIPLE APPLICATION
ENCLOSURE SYSTEMS

MONARCH IP 66

The Monarch IP is the top of the range general purpose enclosure and switchboard building system.

Designed to be the ultimate in flexibility, the Monarch IP is a modular range of robust enclosures with a range of accessories to suit almost every requirement. The standard range includes body and door rails with 'C' rails and fittings, and gland plates on all but the 175 and 270 mm deep enclosures.

Protected to IP66 and manufactured from 316 stainless steel, you can be sure that internal components are securely protected from the outside environment.

Water is prevented from entering the enclosure on opening by a specially design guttering system



Robust locking system

Polyurethane gasket

Huge range of accessories

Contact your local B&R office for details
www.brenclosures.com.au

TECHNICAL INFORMATION

The Monarch IP includes a door, body and 'C' rails as well as a gland plate on all units of 400mm depth and above and 3 point locking on larger units as standard. A huge range of additional accessories are also available, details of which can be obtained from your local supplier.



Model	Dimensions (mm)			Usable Depth (mm)
	Height	Width	Depth	
IP09051/S	300	200	175	135
IP13091/S	400	300	175	135
IP13132/S	400	400	270	230
IP21132/S	600	400	270	230
IP13212/S	400	600	270	230
IP21212/S	600	600	270	230
IP21292/S	600	800	270	230
IP37212/S	1000	600	270	230
IP45212/S	1200	600	270	230
IP29212/S	800	600	270	230
IP13214/S	400	600	400	360
IP21214/S	600	600	400	360
IP29214/S	800	600	400	360
IP45214/S	1200	600	400	360
IP61214/S	1600	600	400	360
IP69214/S	1800	600	400	360
IP77214/S	2000	600	400	360
IP25254/S	700	700	400	360
IP37254/S	1000	700	400	360
IP21294/S	600	800	400	360
IP29294/S	800	800	400	360
IP37294/S	1000	800	400	360
IP45294/S	1200	800	400	360
IP61294/S	1600	800	400	360
IP69294/S	1800	800	400	360
IP77294/S	2000	800	400	360
IP29215/S	800	600	500	460
IP45215/S	1200	600	500	460
IP61215/S	1600	600	500	460
IP69215/S	1800	600	500	460
IP77215/S	2000	600	500	460
IP21295/S	600	800	500	460
IP45295/S	1200	800	500	460
IP61295/S	1600	800	500	460
IP69295/S	1800	800	500	460
IP77295/S	2000	800	500	460
IP29216/S	800	600	600	560
IP45216/S	1200	600	600	560
IP61216/S	1600	600	600	560
IP77216/S	2000	600	600	560
IP77296/S	2000	800	600	560

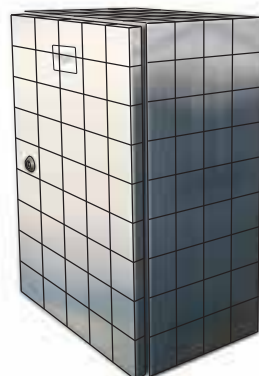

SALES OFFICES

Queensland (Brisbane)
Ph 07 3714 1000

Queensland (Townsville)
Ph 07 4775 6255

New South Wales (Sydney)
Ph 02 9687 0077

New South Wales (Newcastle)
Ph 02 4961 4433

Victoria (Melbourne)
Ph 03 8588 8400

South Australia (Adelaide)
Ph 08 8243 1166

Western Australia (Perth)
Ph 08 9248 9744

Tasmania (Launceston)
Ph 03 6331 5545

Northern Territory (Darwin)
Ph 08 8947 0870

