



## Monarch IP Multiple Application Enclosure Systems

### **Index**

[Dimension Sheet](#)

[Dimension Sheet – Viewing Window](#)

[Catalogue Information](#)

[Leaflet](#)

### **Web Links**

[Monarch IP Information Page](#)

[Ask a question / Send us an enquiry](#)

[Information about B&R](#)

[Local Sales Team Phone Numbers](#)



DIMENSION SHEET

# MONARCH IP

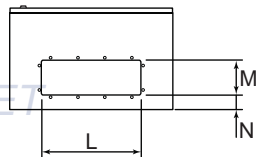
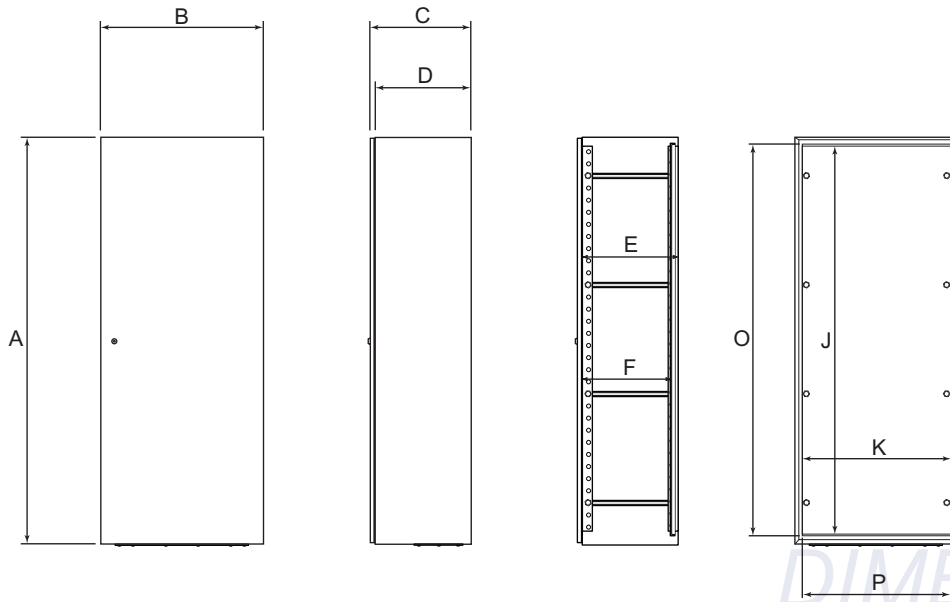

## Powdercoated Enclosures

Catalogue Number	External Dimensions				Internal Depth		Mounting Pan		Gland Plate			Opening Size	
	A	B	C	D	E	F	J	K	L	M	N	O	P
IP13132	400	400	270	244	266	231	320	340	280	70	25	340	340
IP13212	400	600	270	244	266	231	320	540	440	120	25	340	540
IP21132	600	400	270	244	266	231	520	340	280	70	25	540	340
IP21212	600	600	270	244	266	231	520	540	440	120	25	540	540
IP21292	600	800	270	244	266	231	520	740	440	120	25	540	740
IP29212	800	600	270	244	266	231	720	540	440	120	25	740	540
IP37212	1000	600	270	244	266	231	920	540	440	120	25	940	540
IP45212	1200	600	270	244	266	231	1120	540	440	120	25	1140	540
IP13214	400	600	400	374	380	361	320	540	490	170	73	340	540
IP21214	600	600	400	374	380	361	520	540	490	170	73	540	540
IP21294	600	800	400	374	380	361	520	740	490	170	73	540	740
IP25254	700	700	400	374	380	361	620	640	490	170	73	640	640
IP29214	800	600	400	374	380	361	720	540	490	170	73	740	540
IP29294	800	800	400	374	380	361	720	740	490	170	73	740	740
IP37254	1000	700	400	374	380	361	920	640	490	170	73	940	640
IP45214	1200	600	400	374	380	361	1120	540	490	170	73	1140	540
IP45294	1200	800	400	374	380	361	1120	740	490	170	73	1140	740
IP61214	1600	600	400	374	380	361	1520	540	490	170	73	1540	540
IP61294	1600	800	400	374	380	361	1520	740	490	170	73	1540	740
IP69214	1800	600	400	374	380	361	1720	540	490	170	73	1740	540
IP69294	1800	800	400	374	380	361	1720	740	490	170	73	1740	740
IP77214	2000	600	400	374	380	361	1920	540	490	170	73	1940	540
IP77294	2000	800	400	374	380	361	1920	740	490	170	73	1940	740
IP21295	600	800	500	474	480	461	520	740	490	170	73	540	740
IP29215	800	600	500	474	480	461	720	540	490	170	73	740	540
IP45215	1200	600	500	474	480	461	1120	540	490	170	73	1140	540
IP45295	1200	800	500	474	480	461	1120	740	490	170	73	1140	740
IP61215	1600	600	500	474	480	461	1520	540	490	170	73	1540	540
IP61295	1600	800	500	474	480	461	1520	740	490	170	73	1540	740
IP69215	1800	600	500	474	480	461	1720	540	490	170	73	1740	540
IP69295	1800	800	500	474	480	461	1720	740	490	170	73	1740	740
IP77215	2000	600	500	474	480	461	1920	540	490	170	73	1940	540
IP77295	2000	800	500	474	480	461	1920	740	490	170	73	1940	740
IP77216	2000	600	600	574	580	561	1920	540	490	170	73	1940	540
IP77296	2000	800	600	574	580	561	1920	740	490	170	73	1940	740



DIMENSION SHEET

# CHANNEL IRON PLINTH – MONARCH IP

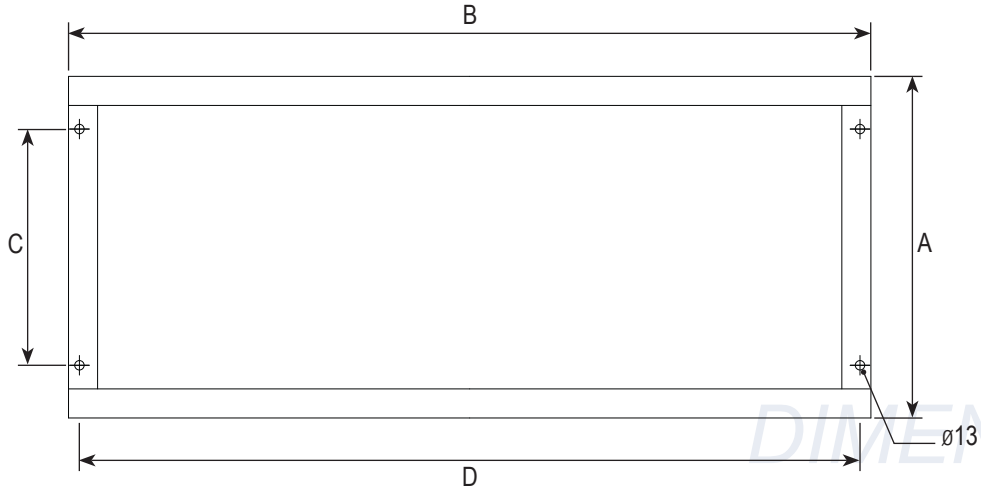

DIMENSION SHEET

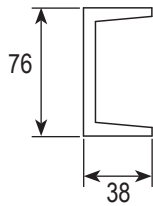

DIMENSION SHEET

Catalogue Number	External Dimensions			
	A	B	C	D
IPPC212	241	600	176	570
IPPC214	371	600	225	570
IPPC294	371	800	225	770
IPPC424	371	1200	225	1170
IPPC584	371	1600	225	1570
IPPC215	471	600	325	570
IPPC295	471	800	325	770
IPPC425	471	1200	325	1170
IPPC505	471	1400	325	1370
IPPC585	471	1600	325	1570
IPPC216	571	600	425	570
IPPC296	571	800	425	770

ON SHEET

DIMENSION SHEET



DIMENSION SHEET

# MONARCH IP – VIEWING WINDOW

Image A:

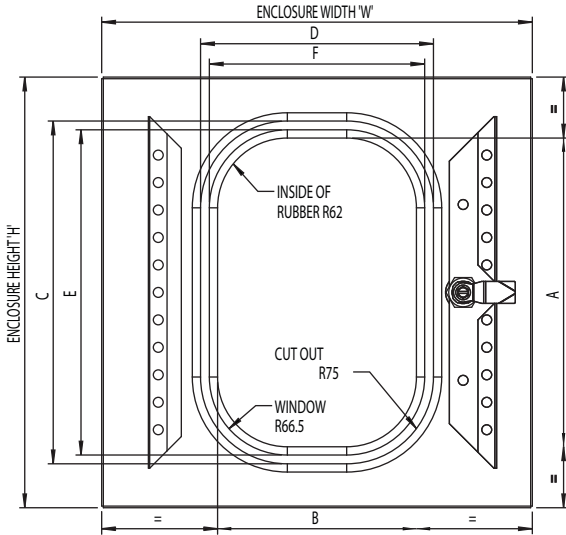

Door Inside View

Image B:

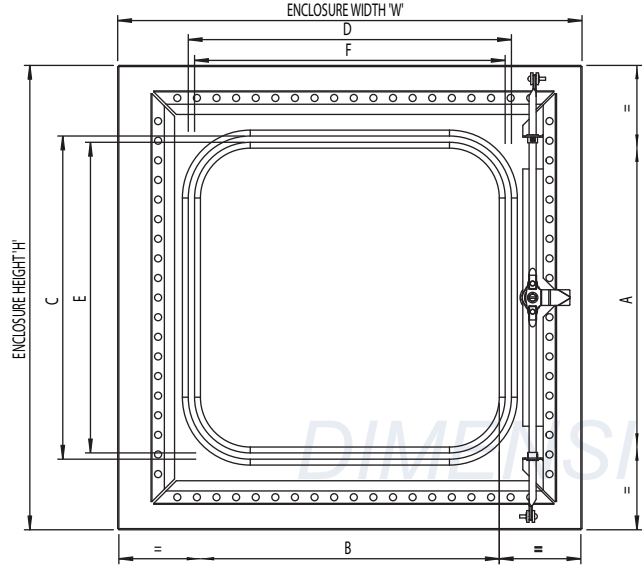

Door Inside View

DIMENSION SHEET

Table A:

Catalogue Number	Enclosure Size		Viewing Area		Cutout Size		Window Size	
	Height	Width	A	B	C	D	E	F
IP2121 IP2121/S	400	400	288	188	312	212	296	196
IP2113 IP2113/S	600	400	488	188	512	212	496	196

Table B:

Catalogue Number	Enclosure Size		Viewing Area		Cutout Size		Window Size	
	Height	Width	A	B	C	D	E	F
IP1321	400	600	188	388	212	412	196	396
IP2121 IP2121/S	600	600	388	388	412	412	396	396
IP2921 IP2921/S	800	600	588	388	612	412	596	396
IP2129	600	800	388	588	412	612	396	596
IP2525	700	700	488	488	512	512	496	496
IP2929	800	800	588	588	612	612	596	596
IP3721 IP3721/S	1000	600	788	388	812	412	796	396
IP3725	1000	700	788	488	812	512	796	496
IP3729/S	1000	800	788	588	812	612	796	596
IP45212	1200	600	988	388	1012	412	996	396
IP4529 IP4529/S	1200	800	988	588	1012	612	996	596
IP6121	1600	600	1388	388	1412	412	1396	396
IP6129	1600	800	1388	588	1412	612	1396	596
IP6921	1800	600	1588	388	1612	412	1596	396
IP6929 IP6929/S	1800	800	1588	588	1612	612	1596	596
IP7721	2000	600	1788	388	1812	412	1796	396
IP7729	2000	800	1788	588	1812	612	1796	596

ON SHEET

HEET

HEET



# Monarch IP

## Industrial Enclosure & Switchboard Building System

brenclosures.com.au/ip.htm



### Monarch IP Features

- Many mounting options, providing the flexibility to install equipment in almost any position
- Wide range of accessories available for added versatility in equipment application
- Approvals
  - CE marked
  - Lloyds
- Materials
  - Body - see tables
  - Body thickness - see tables
  - Gasket - polyurethane
- Surface finish - powdercoated
- Protection rating - IP66

The Monarch IP is the top of the range general purpose enclosure and switchboard building system. Designed to be the ultimate in flexibility, the Monarch IP is a modular range of robust enclosures with a range



of accessories to suit almost every requirement. The Monarch IP range is suitable for small motor control applications, lighting, CT metering and smaller switchboard applications.

### Inclusions

'C' rail mountings (4 rails on heights up to 800 mm and 8 rails on larger), gland plate (fitted internally or externally on all but 175 and 270 mm deep stainless units), 7 mm square turnbuckle lock (IP020 on zinc coated steel/aluminium and black powdercoated lock with stainless steel insert on stainless steel) on units below 1600 mm high and lockable 'L' handles (IP050) on others, 3 point locking on units of 600 mm high and above, removable back on units above 270 mm deep, door rails, earth strap kit.



## Monarch IP Selection Guide

Catalogue No	Nominal Dimensions# (mm)			Usable Depth (mm)	Materials		
	Height	Width	Depth				
IP09051/S*	300	200	175	135		•	
IP13091/S*	400	300	175	135		•	
IP13132*	400	400	270	230	•	•	•
IP21132*	600	400	270	230	•	•	•
IP13212*	400	600	270	230	•	•	•
IP21212*	600	600	270	230	•	•	•
IP29212*	800	600	270	230	•	•	•
IP37212*	1000	600	270	230	•	•	•
IP45212*	1200	600	270	230	•	•	•
IP21292*	600	800	270	230	•	•	•
IP13214	400	600	400	360	•	•	•
IP21214	600	600	400	360	•	•	•
IP29214	800	600	400	360	•	•	•
IP45214	1200	600	400	360	•	•	•
IP61214	1600	600	400	360	•	•	•
IP69214	1800	600	400	360	•	•	•
IP77214	2000	600	400	360	•	•	•
IP25254	700	700	400	360	•	•	•
IP37254	1000	700	400	360	•	•	•
IP21294	600	800	400	360	•	•	•
IP29294	800	800	400	360	•	•	•
IP37294	1000	800	400	360	•	•	•
IP45294	1200	800	400	360	•	•	•
IP61294	1600	800	400	360	•	•	•
IP69294	1800	800	400	360	•	•	•
IP77294	2000	800	400	360	•	•	•
IP29215	800	600	500	460	•	•	•
IP45215	1200	600	500	460	•	•	•
IP61215	1600	600	500	460	•	•	•
IP69215	1800	600	500	460	•	•	•
IP77215	2000	600	500	460	•	•	•
IP21295	600	800	500	460	•	•	•
IP45295	1200	800	500	460	•	•	•
IP61295	1600	800	500	460	•	•	•
IP69295	1800	800	500	460	•	•	•
IP77295	2000	800	500	460	•	•	•
IP29216	800	600	600	560	•	•	•
IP45216	1200	600	600	560	•	•	•
IP61216	1600	600	600	560	•	•	•
IP77216	2000	600	600	560	•	•	•
IP77296	2000	800	600	560	•	•	•

\* Stainless steel version of these models do not come with gland plate as standard

# Plus 7 mm for aluminium enclosures



Zinc coated steel. See page 66 & 67 for thickness, weights and material specific accessories.



316 stainless steel (add "/S" to the end of the part number). See page 68 & 69 for thickness, weights and material specific accessories.



Aluminium (add "/A" to the end of the part number). See page 70 for thickness and weights.

Internal & General Accessories – See foldout



# Monarch IP – Zinc Coated Steel

## Industrial Enclosure & Switchboard Building System

### Zinc Coated Steel Thickness & Weights

	IP13132	IP13212	IP13214	IP21132	IP21212	IP21214	IP21292	IP21294	IP21295	IP25254	IP29212	IP29214	IP29215	IP29216	IP29294	IP37212	IP37254	IP45212	IP45214	IP45215
Material thickness - zinc coated steel (mm)	1.2	1.2	1.6	1.6	1.6	1.6	1.6	1.6	1.6	1.6	1.6	1.6	1.6	1.6	1.6	1.6	1.6	1.6	1.6	1.6
Weight (kg)	12.9	17.0	21.1	17.0	22.3	27.1	27.5	33.1	37.3	33.3	27.5	33.1	37.3	41.6	40.1	32.7	43.1	38.0	45.0	50.4

### Monarch IP Accessories - Zinc Coated Steel Specific

See foldout sections at the back of this catalogue for internal and general accessories.

Accessories below are specific to the zinc coated steel enclosure material.

Product	Description	Catalogue No	IP13132	IP13212	IP13214	IP21132	IP21212	IP21214	IP21292	IP21294	IP21295	IP25254	IP29212	IP29214	IP29215	IP29216	IP29294	IP37212	IP37254	IP45212	IP45214	IP45215	
Rainhood - zinc coated steel	30 mm high	IPRH132	•			•																	
	30 mm high	IPRH212		•			•						•						•		•		
	30 mm high	IPRH214			•			•						•								•	
	30 mm high	IPRH215														•							
	30 mm high	IPRH254										•								•			
	30 mm high	IPRH292							•														
	30 mm high	IPRH294								•								•					
	30 mm high	IPRH295									•												
Gland plate - zinc coated steel	320 x 110 x 1.6 mm	IPGP31	•			•																	
	480 x 160 x 1.6 mm	IPGP41		•	•		•	•					•	•				•	•		•	•	
	530 x 210 x 1.6 mm	IPGP52								•	•	•					•		•			•	•
Plinth - access - steel	200 x 600 x 374 mm	IPPH214			•			•						•								•	
	200 x 600 x 474 mm	IPPH215													•								•
	200 x 600 x 574 mm	IPPH216														•							
	200 x 800 x 374 mm	IPPH294								•								•					
	200 x 800 x 474 mm	IPPH295									•												
	200 x 800 x 574 mm	IPPH296																					
Vent kit - external	130 x 130 mm	IPVK	•	•	•	•	•	•	•	•	•	•	•	•	•	•	•	•	•	•	•	•	•
	to suit FAN/FIL12* 300mm high	IPVH12		•	•	•	•	•	•	•	•	•	•	•	•	•	•	•	•	•	•	•	•
	to suit FAN/FIL25* 400mm high	IPVH25								•		•	•	•		•	•	•	•	•	•	•	•
Vent hood - zinc coated steel	to suit FAN/FIL35* 475mm high	IPVH35											•				•	•				•	•
	316 stainless steel	MEB/S	•	•	•	•	•	•	•	•	•	•	•	•	•	•	•	•	•	•	•	•	•
Universal mounting brackets (pack of 4)	zinc coated steel	IPWM	•	•	•	•	•	•	•	•	•	•	•	•	•	•	•	•	•	•	•	•	•

\* See page 108 for information on fans and filters.



## Zinc Coated Steel Thickness & Weights

	IP45216	IP45294	IP45295	IP61214	IP61215	IP61216	IP61294	IP61295	IP69214	IP69215	IP69294	IP69295	IP77214	IP77215	IP77216	IP77294	IP77295	IP77296
Material thickness - zinc coated steel (mm)	1.6	1.6	1.6	1.6	1.6	1.6	1.6	1.6	1.6	1.6	1.6	1.6	1.6	1.6	1.6	1.6	1.6	1.6
Weight (kg)	55.8	54.3	60.3	56.9	63.5	70.0	68.5	75.6	62.9	70.0	75.6	83.3	68.9	76.5	84.2	82.7	90.9	99.2

## Monarch IP Accessories - Zinc Coated Steel Specific

See foldout sections at the back of this catalogue for internal and general accessories.

Accessories below are specific to the zinc coated steel enclosure material.

Product	Description	Catalogue No	IP45216	IP45294	IP45295	IP61214	IP61215	IP61216	IP61294	IP61295	IP69214	IP69215	IP69294	IP69295	IP77214	IP77215	IP77216	IP77294	IP77295	IP77296
			Rainhood - zinc coated steel	30 mm high	IPRH132															
	30 mm high	IPRH212																		
	30 mm high	IPRH214				*					*				*					
	30 mm high	IPRH215	*				*	*				*				*				
	30 mm high	IPRH254																		
	30 mm high	IPRH292																		
	30 mm high	IPRH294		*					*				*					*		
	30 mm high	IPRH295			*					*				*					*	
Gland plate - zinc coated steel	320x110x1.6mm	IPGP31																		
	480x160x1.6mm	IPGP41	*			*	*	*			*	*			*	*	*			
	530x210x1.6mm	IPGP52	*	*	*			*	*	*			*	*			*	*	*	*
Plinth - access - steel	200x600x374mm	IPPH214				*					*				*					
	200x600x474mm	IPPH215					*					*				*				
	200x600x574mm	IPPH216	*					*									*			
	200x800x374mm	IPPH294		*					*				*					*		
	200x800x474mm	IPPH295			*					*				*					*	
	200x800x574mm	IPPH296																		*
Vent kit - external	130x130mm	IPVK	*	*	*	*	*	*	*	*	*	*	*	*	*	*	*	*	*	*
	to suit FAN/FIL12 300mm high	IPVH12	*	*	*	*	*	*	*	*	*	*	*	*	*	*	*	*	*	*
Vent hood - zinc coated steel	to suit FAN/FIL25 400mm high	IPVH25		*	*	*	*	*	*	*	*	*	*	*	*	*	*	*	*	*
	to suit FAN/FIL35 475mm high	IPVH35		*	*	*	*	*	*	*	*	*	*	*	*	*	*	*	*	*
Wall mounting brackets (pack of 4)	316 stainless steel	MEB/S	*	*	*	*	*	*	*	*	*	*	*	*	*	*	*	*	*	*
Universal mounting brackets (pack of 4)	zinc coated steel	IPWM	*	*	*	*	*	*	*	*	*	*	*	*	*	*	*	*	*	*

\* See page 108 for information on fans and filters.



# Monarch IP

## General Purpose Enclosures - IP66



The Monarch IP is the top of the range general purpose enclosure and switchboard building system. Designed to be the ultimate in flexibility, the Monarch IP is a modular range of robust enclosures with a range of accessories to suit almost every requirement. The range includes body and door rails with 'C' rails, fittings, and gland plates.

Protected to IP66 and manufactured from Zinccanneal® Steel, the IP range is suitable for small motor control applications, lighting, CT metering and smaller switchboard applications. 316 stainless steel and aluminium (in project quantities) are also available to suit other applications.

### Size Range Summary

Model	IP13132	IP21132	IP13212	IP21212	IP29212	IP37212	IP45212	IP21292	IP13214
Height	400	600	400	600	800	1000	1200	600	400
Width	400	400	600	600	600	600	600	800	600
Depth	270	270	270	270	270	270	270	270	400

Model	IP21214	IP29214	IP45214	IP61214	IP69214	IP77214	IP25254	IP37254	IP21294
Height	600	800	1200	1600	1800	2000	700	1000	600
Width	600	600	600	600	600	600	700	700	800
Depth	400	400	400	400	400	400	400	400	400

Model	IP29294	IP45294	IP61294	IP69294	IP77294	IP29215	IP45215	IP61215	IP69215
Height	800	1200	1600	1800	2000	800	1200	1600	1800
Width	800	800	800	800	800	600	600	600	600
Depth	400	400	400	400	400	500	500	500	500

Model	IP77215	IP21295	IP45295	IP61295	IP69295	IP77295	IP77216	IP77296
Height	2000	600	1200	1600	1800	2000	2000	2000
Width	600	800	800	800	800	800	600	800
Depth	500	500	500	500	500	500	600	600

### Monarch IP Features

- Protection rating of IP66 certified by NATA to ensure ultimate protection against dust and water in demanding conditions
- Zinccanneal® steel, corrosion resistant construction with a powdercoated paint finish for extra durability in the harsh Australian climate
- 115° opening door and gland plate as standard for ease of access to internal systems
- Specially designed gutter system that helps extend the life of the gasket whilst preventing water entering the enclosure
- Polyurethane gasket foamed in place to ensure sealing, protecting internal equipment
- Earthing strap supplied for additional safety
- Many mounting options, providing the flexibility to install equipment in almost any position
- Wide range of available accessories for added versatility in equipment application
- Optional viewing window for monitoring equipment operation

### Approvals

CE marked  
Lloyds

### Materials

Body - Zinccanneal® steel  
Body Thickness - 1.2/1.6 mm  
Gasket - Polyurethane

Surface Finish - Powdercoat  
RAL7032

Protection Rating - IP66

### Guides

Material selection - page 290

### Also of interest

Smaller sizes - page 62  
Lower IP rating - page 58  
Stainless Steel - page 106

### Drawing

Page 272

## Inclusions

'C' rail mountings (4 rails on heights up to 800 mm and 8 rails on larger), gland plate (fitted internally or externally), 7 mm square turnbuckle lock (IP020) on units below 1600 mm high and lockable 'L' handles (IP050) on others, 3 point locking on units of 600 mm high and above, removable back on units above 270 mm deep, earth strap kit

## Accessories Summary

Mounting pans, insulating panels, escutcheons, shelves, plinths, rainhood, gland plate, vent kits, lifting brackets, mounting brackets, door stay, internal lights, plan and schedule holder, various lock options, rails and rail kits, climate control and hoods.

## Monarch IP Enclosures & Dimensions

Model	Dimensions (mm)			Usable Depth (mm)	Material Thickness (mm)	Weight (kg)
	Height	Width	Depth			
IP13132	400	400	270	230	1.2	12.9
IP21132	600	400	270	230	1.6	17.0
IP13212	400	600	270	230	1.2	17.0
IP21212	600	600	270	230	1.6	22.3
IP29212	800	600	270	230	1.6	27.5
IP37212	1000	600	270	230	1.6	32.7
IP45212	1200	600	270	230	1.6	38.0
IP21292	600	800	270	230	1.6	27.5
IP13214	400	600	400	360	1.6	21.1
IP21214	600	600	400	360	1.6	27.1
IP29214	800	600	400	360	1.6	33.1
IP45214	1200	600	400	360	1.6	45.0
IP61214	1600	600	400	360	1.6	56.9
IP69214	1800	600	400	360	1.6	62.9
IP77214	2000	600	400	360	1.6	68.9
IP25254	700	700	400	360	1.6	33.3
IP37254	1000	700	400	360	1.6	43.1
IP21294	600	800	400	360	1.6	33.1
IP29294	800	800	400	360	1.6	40.1
IP45294	1200	800	400	360	1.6	54.3
IP61294	1600	800	400	360	1.6	68.5
IP69294	1800	800	400	360	1.6	75.6
IP77294	2000	800	400	360	1.6	82.7
IP29215	800	600	500	460	1.6	37.3
IP45215	1200	600	500	460	1.6	50.4
IP61215	1600	600	500	460	1.6	63.5
IP69215	1800	600	500	460	1.6	70.0
IP77215	2000	600	500	460	1.6	76.5
IP21295	600	800	500	460	1.6	37.3
IP45295	1200	800	500	460	1.6	60.3
IP61295	1600	800	500	460	1.6	75.6
IP69295	1800	800	500	460	1.6	83.3
IP77295	2000	800	500	460	1.6	90.9
IP77216	2000	600	600	560	1.6	84.2
IP77296	2000	800	600	560	1.6	99.2



3 point locking



Removable Hinge

Non-metallic

General Purpose

Stainless Steel

Mining & Hazardous

Switchboard Building

Datacoms

Climate Control

Technical Drawings

Enclosure Selection

## Monarch IP Accessories

### Metal Mounting Pans

Mounting pans are very simple to install using the existing rails supplied as part of the Monarch IP enclosure. They are manufactured from 2 mm thick pretreated mild steel with a gloss white powdercoat finish.

Catalogue Number	To suit enclosures Height x Width (mm)	Mounting Pan Dimensions (mm)		
		Height	Width	Thickness
IPMP1313	400 x 400	320	340	2
IPMP1321	400 x 600	320	540	2
IPMP2113	600 x 400	520	340	2
IPMP2121	600 x 600	520	540	2
IPMP2129	600 x 800	520	740	2
IPMP2525	700 x 700	620	640	2
IPMP2921#	800 x 600	720	540	2
IPMP2929#	800 x 800	720	740	2
IPMP3721#	1000 x 600	920	540	2
IPMP3725#	1000 x 700	920	640	2
IPMP3729#	1000 x 800	920	740	2
IPMP4521#	1200 x 600	1120	540	2
IPMP4529#	1200 x 800	1120	740	2
IPMP6121*	1600 x 600	1520	540	2
IPMP6129*	1600 x 800	1520	740	2
IPMP6921*	1800 x 600	1720	540	2
IPMP6929*	1800 x 800	1720	740	2
IPMP7721*	2000 x 600	1920	540	2
IPMP7729*	2000 x 800	1920	740	2

\* Mounting pan features double return on sides and single return on top for extra rigidity.

# Mounting pan features single return on sides.



### Insulated Mounting Pans

Insulated mounting pans are provided where use of a metallic pan is not acceptable. Manufactured from black laminated phenolic material, and supplied with all fixings, the insulated mounting pan is easy to install and use.

Catalogue Number	To suit enclosures Height x Width (mm)	Mounting Pan Dimensions (mm)		
		Height	Width	Thickness
IPFP1313	400 x 400	320	340	6
IPFP1321	400 x 600	320	540	6
IPFP2113	600 x 400	520	340	6
IPFP2121	600 x 600	520	540	6
IPFP2129	600 x 800	520	740	6
IPFP2525	700 x 700	620	640	6
IPFP2921	800 x 600	720	540	6
IPFP2929	800 x 800	720	740	6
IPFP3721	1000 x 600	920	540	6
IPFP3725	1000 x 700	920	640	8
IPFP3729	1000 x 800	920	750	8
IPFP4521	1200 x 600	1120	540	8
IPFP4529	1200 x 800	1120	740	8



## Monarch IP Accessories

### Double Hinged Insulating Panels

Double hinged insulating panels are mainly used for metering applications. The panels provide a functional, alternative mounting solution for equipment installation requirements.

Catalogue Number	To suit enclosures Height x Width (mm)	Mounting Pan Dimensions (mm)		
		Height	Width	Thickness
IPHP1313	400 x 400	320	325	6
IPHP1321	400 x 600	320	525	6
IPHP2113	600 x 400	520	325	6
IPHP2121	600 x 600	520	525	6
IPHP2129	600 x 800	520	725	6
IPHP2421	Partial Height x 600	595	525	6
IPHP2429	Partial Height x 800	595	725	6
IPHP2525	700 x 700	620	625	6
IPHP2921	800 x 600	720	525	6
IPHP2929	800 x 800	720	725	6
IPHP3229	Partial Height x 800	795	725	6
IPHP3721	1000 x 600	920	525	6
IPHP3725	1000 x 700	920	625	8
IPHP3729	1000 x 800	920	725	8
IPHP4521	1200 x 600	1120	525	8
IPHP4529	1200 x 800	1120	725	8



### Hinged Escutcheons

For mounting internal controls and accessories, B&R provides a comprehensive range of hinged escutcheons. They can be mounted singularly or with two or more fitted into the enclosure. Fitting requires Universal Rail Kit (see page 80).

Catalogue Number	To suit enclosures Height x Width (mm)	Mounting Pan Dimensions (mm)		
		Height	Width	Depth
IPHE1313	400 x 400*	324.5	319.5	18
IPHE1321	400 x 600*	319.5	524.5	18
IPHE2113	600 x 400*	524.5	319.5	18
IPHE2121	600 x 600*	524.5	519.5	18
IPHE2129	600 x 800*	524.5	719.5	18
IPHE2421	Partial Height x 600	599.5	519.5	18
IPHE2429	Partial Height x 800	599.5	719.5	18
IPHE2525	700 x 700*	624.5	619.5	18
IPHE2921	800 x 600*	724.5	519.5	18
IPHE2929	800 x 800*	724.5	719.5	18
IPHE3221	Partial Height x 600	799.5	519.5	18
IPHE3229	Partial Height x 800	799.5	719.5	18
IPHE3721	1000 x 600*	924.5	519.5	18
IPHE3725	1000 x 700*	924.5	619.5	18
IPHE3729	1000 x 800*	924.5	719.5	18
IPHE4521	1200 x 600*	1124.5	519.5	18
IPHE4529	1200 x 800*	1124.5	719.5	18
IPHE6121	1600 x 600*	1524.5	519.5	18
IPHE6129	1600 x 800*	1524.5	719.5	18
IPHE6921	1800 x 600*	1724.5	519.5	18
IPHE6929	1800 x 800*	1724.5	719.5	18
IPHE7721	2000 x 600	1924.5	519.5	18
IPHE7729	2000 x 800	1924.5	719.5	18

\* Can be fitted to larger enclosures if a partial escutcheon is required, as shown.



Non-metallic

General Purpose

Stainless Steel

Mining & Hazardous

Switchboard Building

Datascams

Climate Control

Technical Drawings

Enclosure Selection

## Monarch IP Accessories (continued)

### Fixed Escutcheons

Fixed escutcheons are used for fitting internal controls and accessories. They form a second tier mounting arrangement, in front of the mounting pan. Fitting requires Universal Rail Kit (see page 80).

Catalogue Number	Part No. of Rail Kit Required for Installation	Dimensions (mm)		
		Height	Width	Depth
IPFE1308	N/A – Use IPUV	324.5	199.5	18
IPFE1313	IPRK1313	324.5	324.5	18
IPFE1316	N/A – Use IPUV	324.5	399.5	18
IPFE1321	IPRK1321	324.5	524.5	18
IPFE1329	N/A – Use IPUV	324.5	724.5	18
IPFE1616	N/A – Use IPUV	399.5	399.5	18
IPFE2108	N/A – Use IPUV	524.5	199.5	18
IPFE2113	IPRK2113	524.5	324.5	18
IPFE2116	N/A – Use IPUV	524.5	399.5	18
IPFE2121	IPRK2121	524.5	524.5	18
IPFE2129	IPRK2129	524.5	724.5	18
IPFE2408	N/A – Use IPUV	599.5	199.5	18
IPFE2413	N/A – Use IPUV	599.5	324.5	18
IPFE2416	N/A – Use IPUV	599.5	399.5	18
IPFE2421	N/A – Use IPUV	599.5	524.5	18
IPFE2429	N/A – Use IPUV	599.5	724.5	18
IPFE2525	IPRK2525	624.5	624.5	18
IPFE2908	N/A – Use IPUV	724.5	199.5	18
IPFE2916	N/A – Use IPUV	724.5	399.5	18
IPFE2921	IPRK2921	724.5	524.5	18
IPFE2929	IPRK2929	724.5	724.5	18
IPFE3208	N/A – Use IPUV	799.5	199.5	18
IPFE3221	N/A – Use IPUV	799.5	524.5	18
IPFE3229	N/A – Use IPUV	799.5	724.5	18
IPFE3708	N/A – Use IPUV	924.5	199.5	18
IPFE3713	N/A – Use IPUV	924.5	324.5	18
IPFE3716	N/A – Use IPUV	924.5	399.5	18
IPFE3721	IPRK3721	924.5	524.5	18
IPFE3725	IPRK3725	924.5	624.5	18
IPFE3729	IPRK3729	924.5	724.5	18
IPFE4508	N/A – Use IPUV	1124.5	199.5	18
IPFE4513	N/A – Use IPUV	1124.5	324.5	18
IPFE4516	N/A – Use IPUV	1124.5	399.5	18
IPFE4521	IPRK4521	1124.5	524.5	18
IPFE4529	IPRK4529	1124.5	724.5	18



## Monarch IP Accessories

### Shelves

White powdercoated shelving made from 1.6 mm Zinccanear® steel, and complete with knockouts for cabling and all fittings. Shelves are designed for use as segregation panels for switchboard applications or mounting fixed equipment.

Catalogue Number	To suit enclosure Width x Depth (mm)	Dimensions (mm)	
		Width	Depth
IPSH211	600 x 175	563	105
IPSH212	600 x 270	563	160
IPSH292	800 x 270	763	160
IPSH214	600 x 400	563	290
IPSH254	700 x 400	663	290
IPSH294	800 x 400	763	290
IPSH215	600 x 500	563	390
IPSH295	800 x 500	763	390
IPSH216	600 x 600	563	490
IPSH296	800 x 600	763	490



### Channel Iron Plinth

Hot dipped galvanised, 75 mm high plinths provide a rugged floor mounting option for the Monarch IP range.

Catalogue Number	To suit enclosures Width x Depth (mm)	Dimensions (mm)		
		Height	Width	Depth
IPPC212	600 X 270	75	600	241
IPPC214	600 x 400	75	600	371
IPPC294	800 x 400	75	800	371
IPPC424	1200 x 400	75	1200	371
IPPC584	1600 x 400	75	1600	371
IPPC215	600 x 500	75	600	471
IPPC295	800 x 500	75	800	471
IPPC425	1200 x 500	75	1200	471
IPPC505	1400 x 500	75	1400	471
IPPC585	1600 x 500	75	1600	471
IPPC216	600 x 600	75	600	571
IPPC296	800 x 600	75	800	571



### Access Plinth - Powdercoat

An access plinth provides a secure ground mount base, with the flexibility of accessing the cabling within the base, and entering the gland plate on the enclosure.

Catalogue Number	To suit enclosures Width x Depth (mm)	Dimensions (mm)		
		Height	Width	Depth
IPPH214	600 x 400	200	600	374
IPPH294	800 x 400	200	800	374
IPPH215	600 x 500	200	600	474
IPPH295	800 x 500	200	800	474
IPPH295/3	800 x 500	300	800	474
IPPH216	600 x 600	200	600	574
IPPH296	800 x 600	200	800	574

Non-metallic

General Purpose

Stainless Steel

Mining & Hazardous

Switchboard Building

Datascams

Climate Control

Technical Drawings

Enclosure Selection

## Monarch IP Accessories (continued)

### Mounting Base

Catalogue Number	To suit enclosures Width x Depth (mm)	Dimensions (mm)		
		Height	Width	Depth
IPPB214	600 x 400	50	600	374
IPPB294	800 x 400	50	800	374
IPPB295	800 x 500	80	800	474
IPPB216	600 x 600		600	574
IPPB296	800 x 600		800	574

### Rainhoods - Powdercoated Steel

Rainhoods are designed to shed water from the top on the enclosure, and to prevent water from pooling on the enclosure top. They include an overhang of 14 mm.

Catalogue Number	To suit enclosures Width x Depth (mm)	Dimensions (mm)		Slope Angle (Degrees)
		Width	Depth	
IPRH132	400 x 270	400	284	2
IPRH212	600 x 270	600	284	2
IPRH292	800 x 270	800	284	2
IPRH214	600 x 400	600	414	1.4
IPRH254	700 x 400	700	414	1.4
IPRH294	800 x 400	800	414	1.4
IPRH215	600 x 500	600	514	1.1
IPRH295	800 x 500	800	514	1.1
IPRH216	600 x 600	600	614	0.9
IPRH296	800 x 600	800	614	0.9



### Gland Plates

Gland plates are designed for efficient and flexible fitting and installation of cable glands. They can be fitted either internally or externally.

Catalogue Number	Material	Dimensions (mm)			To suit enclosures of Width (mm)
		Width	Depth	Thickness	
IPGB31	Brass	320	110	6	400
IPGP31	Zincanneal® Steel	320	110	1.6	
IPGB41	Brass	480	160	6	600
IPGP41	Zincanneal® Steel	480	160	1.6	
IPGB52	Brass	530	210	6	700, 800
IPGP52	Zincanneal® Steel	530	210	1.6	



### External Vent Kit

Ensures that the enclosure does not become excessively hot by allowing natural circulation of air. The vent kit includes a gasket, insert filter and fittings. Note that by the nature of this item, the enclosure will then not be rated to IP66. See page 81 for more climate control equipment and vent hoods.

Catalogue Number	Description	Dimensions
IPVK	External Vent Kit - Powdercoat	130 x 130 mm (suits cutout 80 x 80 mm)



## Monarch IP Accessories

### Standard Fixing Brackets

Allows for easy installation on 'C' rails and escutcheon rails. These items are supplied in packs of 10.

Catalogue Number	Description	Pack Quantity
IPTO	C Rail take off bracket	10
IPCJ	C Rail joining bracket	10
IPCB	C Rail clamp bracket	10
IPEJ	Escutcheon Rail joining bracket	10



### Lifting Brackets

For ease of installation and where the enclosure may be moved. Lifting brackets ensure that the enclosure is not damaged when lifted, and is moved safely.

Catalogue Number	Description	Pack Quantity
LEB/12	Lifting Eye Bolt	2



### Mounting Brackets

For ease of installation and fixing to the mounting surface. B&R mounting brackets ensure optimum installation and safety.

Catalogue Number	Description	Mounting Style	Pack Quantity
IPWM	Powdercoat 2mm bracket	Floor	4
IPWM/S	Stainless Steel 1.5mm bracket	Floor	4
MEB/S	Stainless Steel 2mm bracket	Wall	4



### Door Stay

For ease of installation maintenance of equipment. The door stay ensures that the door remains open even in windy weather, for the safety of people working on the equipment.

Catalogue Number	Description
IPDS	Left or Right handed Door Stay kit

### Plan Holder

Designed to hold a standard A4 document to ensure that it is kept clean and conveniently placed. Typically this would hold detailed procedures, diagrams etc.

Catalogue Number	Description
IPPLN	Plastic A4 Plan Holder





## Monarch IP Accessories (continued)

### Light Kits

For safety and to ensure easy installation and maintenance of equipment. The light kit comes complete with on-off switch, bracket, rail and fittings required for installation.

Catalogue Number	Description
IPLTK06	Light Kit - 600mm wide
IPLTK08	Light Kit - 800mm wide



### Schedule Holder

To ensure that maintenance schedules are always displayed prominently, the B&R schedule holder has been designed to be fitted to the enclosure door rail.

Catalogue Number	Description
IPLC40	Schedule Holder - 40 lines
LCH60	Schedule Holder - 60 lines
LCH78	Schedule Holder - 78 lines
IPLC150	Schedule Holder - 150 lines



### Locks

For security and ease of opening, B&R offers the following locks for the Monarch IP enclosure.

Catalogue Number	Description
IP020	Standard Turnbuckle Lock
IP020/S	Stainless Steel Turnbuckle Lock
IP111	Non Lockable Wing Knob
IP030	Lockable Wing Knob - standard key code 92268
IP030/L003	Lockable Wing Knob - standard key code L003
IP040	Lockable 'T' Handle - standard key code 92268
IP050	Lockable 'L' Handle - standard key code 92268
IP050/L003	Lockable 'L' Handle - standard key code L003
IP052	Padlockable 'L' Handle
IP060	Padlockable Swing Handle - chrome finish



## Monarch IP Accessories

### Spare Keys

Spare or replacement keys for the locks below.

Catalogue Number	Description
SKU	Three way moulded key to suit 7 mm square, 7 mm triangle and 5 mm double-bit
SK3	Spare key for lockable handles (92268 & EK333)
SK7	Die cast 7 mm square key for IP020
SK8	Die cast 3 way key to suit 8 mm square, 8 mm triangle and 3 mm double-bit



### Night Latch Kit

Bracket only which fits inside the enclosure to enable a Lockwood deadbolt type lock to be fitted.

Catalogue Number	Description
IPNLK	Night Latch Kit to suit Lockwood Deadbolt

### Fittings & Fixing Accessories

All brackets and fittings are supplied as a set, packed in economical quantities.

Catalogue Number	Description	Pack Quantity
IPCN06	M6 Foam Back Nut	20
IPCN08	M8 Foam Back Nut	20
IPCG06	M6 Cage Nut	20
IPCG08	M8 Cage Nut	20
IPN06	M6 Hex Nut	20
IPN08	M8 Hex Nut	20
IPTO616	M6 x 16 Taptite Screw	20
IPBO830	M8 x 30 Hexhead Bolt	20
IPBO825	M8 x 25 Hexhead Bolt	20
IPBO812	M8 x 12 Hexhead Bolt	20
IPBO625	M6 x 25 Hexhead Bolt	20
IPBO612	M6 x 12 Hexhead Bolt	20
IPWGLG	M8 Sealing Washer	20
IPWGSM	M6 Sealing Washer	20
IPSPW6	M6 Spring Washer	20
IPSPW8	M8 Spring Washer	20
IPWF06	M6 Flat Washer	20
IPWF08	M8 Flat Washer	20
IPWS06	M6 Star Washer	20
IPWS08	M8 Star Washer	20
IPOR06	M6 Sealing Ring	20
IPP06	M6 Hole Plug	20
IPP10	M10 Hole Plug	20
IPP13	M13 Hole Plug	20



Non-metallic

General Purpose

Stainless Steel

Mining & Hazardous

Switchboard Building

Datacoms

Climate Control

Technical Drawings

Enclosure Selection

## Monarch IP Accessories (continued)

### Standard Rails - C Section Rail

C section rails can be used to fit additional accessories, rails etc. into the enclosure. See page 77 for standard fixing brackets.

Catalogue Number	Description	Length (mm)
IPCR01		137
IPCR02	to suit 270 deep enclosures	232
IPCR03	to suit 400 deep enclosures	360
IPCR04	to suit 500 deep enclosures	460
IPCR05	to suit 600 deep enclosures	560
IPCR07		760
IPCR09		960
IPCR		3400



### Escutcheon Rail

Escutcheon rail is used where two escutcheons meet in the enclosure. See page 77 for standard fixing brackets.

Catalogue Number	Description	Length (mm)
IPER05	Escutcheon rail	525
IPER07	Escutcheon rail	725
IPER19	Escutcheon rail	1975



### Universal Rail Kits (UV)

Universal rail kits are used to install both fixed and hinged escutcheons and come complete with 4 rails and fixings.

Catalogue Number	To suit enclosures Height x Width	Dimensions (mm)	
		Height	Width
IPRK1313	400 x 400	375	325
IPRK1321	400 x 600	375	525
IPRK2113	600 x 400	575	325
IPRK2121	600 x 600	575	525
IPRK2129	600 x 800	575	725
IPRK2525	700 x 700	675	625
IPRK2921	800 x 600	775	525
IPRK2929	800 x 800	775	725
IPRK3721	1000 x 600	975	525
IPRK3725	1000 x 700	975	625
IPRK3729	1000 x 800	975	725
IPRK4521	1200 x 600	1175	525
IPRK4529	1200 x 800	1175	725
IPRK6121	1600 x 600	1575	525
IPRK6129	1600 x 800	1575	725
IPRK6921	1800 x 600	1775	525
IPRK6929	1800 x 800	1775	725
IPRK7721	2000 x 600	1975	525
IPRK7729	2000 x 800	1975	725



## Monarch IP Accessories

### Universal Rail (UV)

Universal rail is designed for mounting equipment inside an enclosure. This is provided in the fixed lengths shown and can be cut to suit.

Catalogue Number	Description	Length (mm)
IPIUV	Universal Rail - 25mm pitch	1975
UV1	Universal Rail - 20mm pitch	1984
UV19	19" Racking Rail - suitable for cage nuts, 1RU pitch	1975



### DIN Rail

DIN rail is used for mounting DIN switchgear and accessories into the enclosure. It is available for all models in aluminium, steel and slotted designs.

Catalogue Number	Description	Length (mm)
IPDN03	Aluminium DIN Rail	360
IPDN05	Aluminium DIN Rail	560
IPDN07	Aluminium DIN Rail	760
DIN35/15AL	35 x 15mm Aluminium DIN Rail	2000
DIN35/7.5	35mm Steel DIN Rail	2000
DIN35/7.5SL	35mm Profile Steel Slotted DIN Rail	2000
DINSB	Rail Angle Support Bracket for DIN Rail	—



### Busbar Rail

The busbar rail is a rail profile especially designed for the installation of B&R's range of TT101S and BR10 bus bar supports (see page 151 and 152).

Catalogue Number	Description	Length (mm)
TT201R	Galvabond® steel busbar rail	764



### Climate Control

B&R supply a wide variety of climate control equipment to suit almost any application. For full details please see the climate control section of this catalogue starting on page 188. The below shows typical selections only.

Catalogue Number	Description	Dimensions (mm)			Power (W)
		Height	Width	Depth	
TX-FAN23BN0A	Fan – External, Output 110m³/h	250	250	111	20
TX-FAN25BN0A	Fan – External, Output 230m³/h	250	250	119	56
TX-FAN35BN0A	Fan – External, Output 550m³/h	325	325	151	90
TX-FIL25XN0A	Filter – Suits 110 or 230m³/h output fan	250	250	30	—
TX-FIL35XN0A	Filter – Suits 550m³/h output fan	325	325	30	—
TX-EGO10BM1A	Air Conditioner – Side mounted, 1050W cooling capacity	783	348	213	570
TX-MIX36BX0A	Heat Exchanger (air-air) – Side mounted 36W/K cooling	771	316	93	140



### Vent Hoods

Vent hoods have been designed for the range of fans and filters on the previous page, and ensure that the fan is both protected mechanically, and further help protect from water and dust ingress.

Catalogue Number	Description	To suit
IPVH12	Vent Hood - Zincanneal Steel	FAN/FIL12
IPVH25	Vent Hood - Zincanneal Steel	FAN/FIL23 & FAN/FIL25
IPVH35	Vent Hood - Zincanneal Steel	FAN/FIL35

Non-metallic

General Purpose

Stainless Steel

Mining & Hazardous

Switchboard Building

Datacoms

Climate Control

Technical Drawings

Enclosure Selection



MULTIPLE APPLICATION  
ENCLOSURE SYSTEMS

# MONARCH IP



Huge range of accessories available  
(Rainhoods sold separately)

Water is prevented from entering the enclosure on opening by a specially designed guttering system

Easy access with a reversible door opening to 115°, and gland plates supplied as standard on larger units

Corrosion resistant zinc coated steel with powdercoat paint finish

The Monarch IP is the top of the range general purpose enclosure and switchboard building system. Designed to be the ultimate in flexibility, the Monarch IP is a modular range of robust enclosures with a range of accessories to suit almost every requirement.

The standard range includes an extremely flexible mounting system utilising 'C' rails attached to body rails. This allows any accessories mounted inside the enclosure to be moved to the optimum position for the installation. The mounting pan is also fitted to these rails, so can be brought forward to allow more cabling space behind the pan.

A huge range of accessories is available for the Monarch IP, so that standard parts can be used for almost all applications. These include metal, insulated and hinged mounting pans, escutcheons, rail kits, vent kits, rails, rain hoods, shelves, plinths, locks etc.

Protected to IP66 and manufactured from robust zinc coated steel, you can be sure that all internal components are securely protected from the outside environment.

Contact your local B&R office for details  
[www.brenclosures.com.au](http://www.brenclosures.com.au)

## TECHNICAL INFORMATION

The Monarch IP includes a door, body and 'C' rails as well as a gland plate and 3 point locking on larger units as standard. A huge range of additional accessories are also available, details of which can be obtained from your local supplier.

Model	Dimensions (mm)			Usable Depth (mm)
	Height	Width	Depth	
IP13132	400	400	270	230
IP21132	600	400	270	230
IP13212	400	600	270	230
IP21212	600	600	270	230
IP21292	600	800	270	230
IP37212	1000	600	270	230
IP45212	1200	600	270	230
IP29212	800	600	270	230
IP13214	400	600	400	360
IP21214	600	600	400	360
IP29214	800	600	400	360
IP45214	1200	600	400	360
IP61214	1600	600	400	360
IP69214	1800	600	400	360
IP77214	2000	600	400	360
IP25254	700	700	400	360
IP37254	1000	700	400	360
IP21294	600	800	400	360
IP29294	800	800	400	360
IP45294	1200	800	400	360
IP61294	1600	800	400	360
IP69294	1800	800	400	360
IP77294	2000	800	400	360
IP29215	800	600	500	460
IP45215	1200	600	500	460
IP61215	1600	600	500	460
IP69215	1800	600	500	460
IP77215	2000	600	500	460
IP21295	600	800	500	460
IP45295	1200	800	500	460
IP61295	1600	800	500	460
IP69295	1800	800	500	460
IP77295	2000	800	500	460
IP29216	800	600	600	560
IP45216	1200	600	600	560
IP61216	1600	600	600	560
IP77216	2000	600	600	560
IP77296	2000	800	600	560

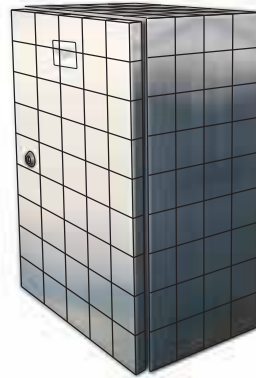

## SALES OFFICES

Queensland (Brisbane)  
Ph 07 3714 1000

Queensland (Townsville)  
Ph 07 4775 6255

New South Wales (Sydney)  
Ph 02 9687 0077

New South Wales (Newcastle)  
Ph 02 4961 4433

Victoria (Melbourne)  
Ph 03 8588 8400

South Australia (Adelaide)  
Ph 08 8243 1166

Western Australia (Perth)  
Ph 08 9248 9744

Tasmania (Launceston)  
Ph 03 6331 5545

Northern Territory (Darwin)  
Ph 08 8947 0870