

## Cover plates and grids with cover plates



XL770/1PL



XL770/3GPL

Pack	Cat No	Description
		Available in various colour and metallic finishes - please refer to colour options page at the back of this Section for details of codes and surcharges. Please note that not all plates are available in every colour and/or metallic finish. Not all plates have been listed, however, plates are available for all products.
		<b>Standard size switch cover plate only</b> Plate size: 73 x 117mm. Mounting centres: 84mm. Plates available for all Excel products (not all listed). Can be used for horizontal and vertical switches.
10	XL770/0PL	Blank cover plate only
10	XLP770/0PL	Blank cover plate only <b>(Gloss)</b>
10	XL770/1PL	Cover plate only for 1 gang switch
10	XLP770/1PL	Cover plate only for 1 gang switch <b>(Gloss)</b>
10	XL770/2PL	Cover plate only for 2 gang switch
10	XLP770/2PL	Cover plate only for 2 gang switch <b>(Gloss)</b>
10	XL770/3PL	Cover plate only for 3 gang switch
10	XLP770/3PL	Cover plate only for 3 gang switch <b>(Gloss)</b>
10	XL770/4PL	Cover plate only for 4 gang switch
10	XLP770/4PL	Cover plate only for 4 gang switch <b>(Gloss)</b>
10	XL770/5PL	Cover plate only for 5 gang switch
10	XLP770/5PL	Cover plate only for 5 gang switch <b>(Gloss)</b>
10	XL770/6PL	Cover plate only for 6 gang switch
10	XLP770/6PL	Cover plate only for 6 gang switch <b>(Gloss)</b>

Pack	Cat No	Description
		<b>Standard size grids and cover plate only (no mechs)</b> Plate size: 73 x 117mm. Mounting centres: 84mm. Colour surcharges might apply - please see Colour options and surcharges page. Please note that not all plates are available in every colour. Not all plates have been listed, however, plates are available for all Excel products.
10	XL770/1GPL	1 gang standard size grid & cover plate only
10	XLP770/1GPL	1 gang standard size grid & cover plate only <b>(Gloss)</b>
10	XL770/2GPL	2 gang standard size grid & cover plate only
10	XLP770/2GPL	2 gang standard size grid & cover plate only <b>(Gloss)</b>
10	XL770/3GPL	3 gang standard size grid & cover plate only
10	XLP770/3GPL	3 gang standard size grid & cover plate only <b>(Gloss)</b>
10	XL770/4GPL	4 gang standard size grid & cover plate only
10	XLP770/4GPL	4 gang standard size grid & cover plate only <b>(Gloss)</b>
10	XL770/5GPL	5 gang standard size grid & cover plate only
10	XLP770/5GPL	5 gang standard size grid & cover plate only <b>(Gloss)</b>
10	XL770/6GPL	6 gang standard size grid & cover plate only
10	XLP770/6GPL	6 gang standard size grid & cover plate only <b>(Gloss)</b>
		<b>Architrave switch cover plate only (matt only)</b> Plate size: 35 x 84mm. Mounting centres: 70mm
20	XLA770/1PL	Cover plate only for 1 gang switch
20	XLA770/2PL	Cover plate only for 2 gang switch
20	XLA770/3PL	Cover plate only for 3 gang switch
20	XLA770/4PL	Cover plate only for 4 gang switch

# Colour Options for the Excel Range

# Section 2

## How to order

Excel Range is available in various colours and metallic finishes. When ordering add ordering code/s to the end of Cat. No.

e.g. XLP777BU, XL777BLMS

Please note: Not all colours and/or metallic finishes are available on all products. Please check when ordering. Minimum quantities may apply.

<b>XLP</b> High Gloss Cover Plate	Gloss Finish Colours Available					
	White <b>WE</b>	Cream <b>CR</b>	Beige <b>BE</b>	Mist Grey <b>MG</b>	Brown <b>BR</b>	Black <b>BL</b>

<b>XL</b> Regular Cover Plate	Matt Finish Colours Available								
	White <b>WE</b>	Cream <b>CR</b>	Beige <b>BE</b>	Mist Grey <b>MG</b>	Brown <b>BR</b>	Black <b>BL</b>	Red <b>RED</b>	Blue <b>BU</b>	Green <b>GR</b>

	Metallic Finishes Available					
	Polished Silver <b>PS</b>	Matt Silver <b>MS</b>	Stainless Steel* <b>SS</b>	Stone Metal <b>SM</b>	Brushed Brass* <b>BB</b>	Polished Brass <b>PB</b>

\*Solid Metal

Single powerpoints

XL787

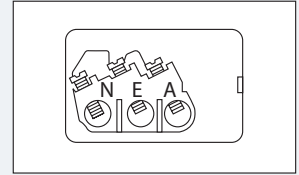
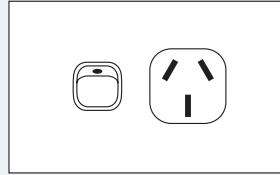

XL787/20

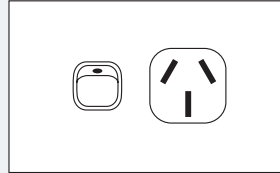

XL787/25

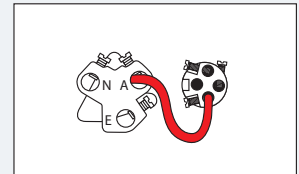
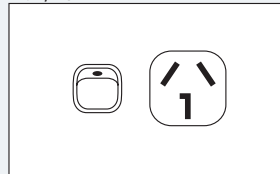

XL787/32

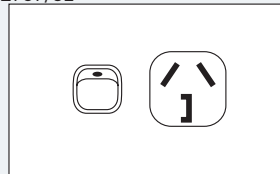

Cat No.

XL787

Plate size: 117 x 73mm.  
Mounting centres: 84mm

XL787/20

Plate size: 117 x 73mm.  
Mounting centres: 84mm

XL787/25

Plate size: 117 x 73mm.  
Mounting centres: 84mm

XL787/32

Plate size: 117 x 73mm.  
Mounting centres: 84mm

Single powerpoints with extra switch

XL787X

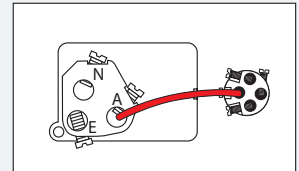
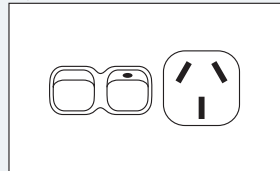

XL787X

Plate size: 117 x 73mm.  
Mounting centres: 84mm

Single powerpoints with 2 extra switches

XL787/2X

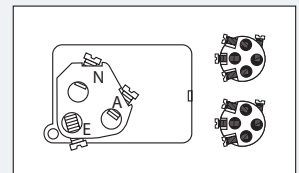
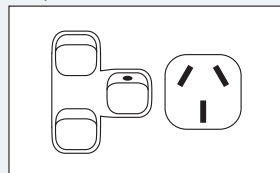

XL787/2X

Plate size: 117 x 73mm.  
Mounting centres: 84mm

Vertical single powerpoint

XLV787

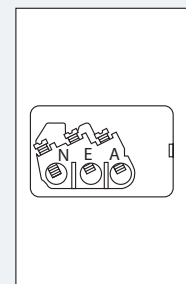
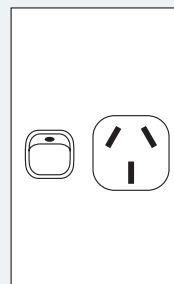

XLV787

Plate size: 73 x 117mm.  
Mounting centres: 84mm

## Vertical single powerpoints with extra switch

Cat No.

XLV787X

Plate size: 70 x 114mm.  
Mounting centres: 84mm

XLV787X

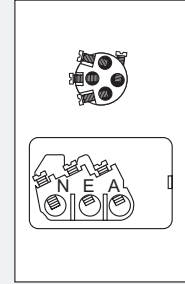
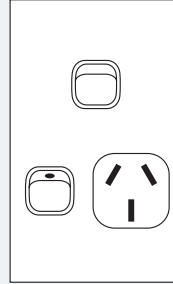

## Vertical single powerpoints with 2 extra switches

XLV787/2X

Plate size: 73 x 117mm.  
Mounting centres: 84mm

XLV787/2X

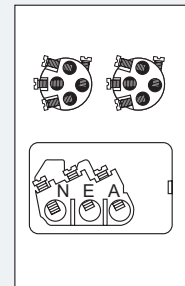
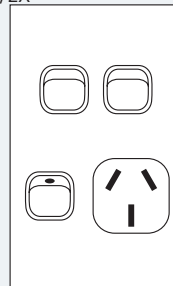

## Double powerpoints

XL777

Plate size: 117 x 73mm.  
Mounting centres: 84mm

XL777

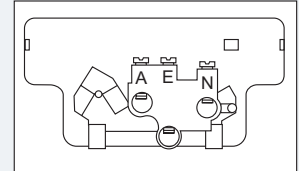
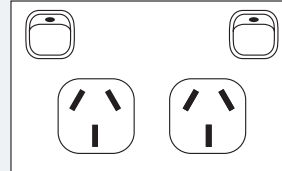

## Double powerpoints with extra switch

XL777X

Plate size: 117 x 73mm.  
Mounting centres: 84mm

XL777X

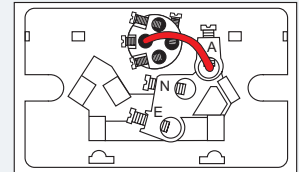
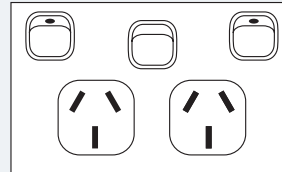

## Vertical double powerpoints

XLV777

Plate size: 73 x 117mm.  
Mounting centres: 84mm

XLV777

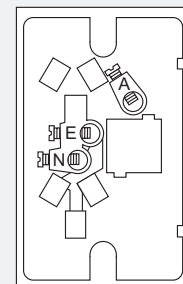
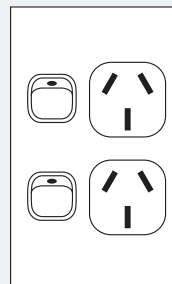

## Vertical double powerpoints with extra switch

Cat No.

XLV777X

Plate size: 73 x 117mm.  
Mounting centres: 84mm

XLV777X

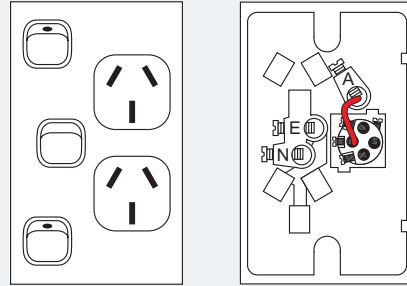

## Electresafe powerpoints, 10mA tripping

XL777EL10

Plate size: 117 x 73mm.  
Mounting centres: 84mm

XL777EL10

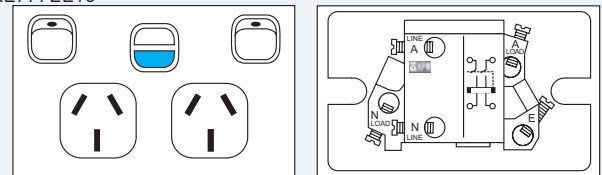

## Electresafe powerpoints, 30mA tripping

XL777EL30

Plate size: 117 x 73mm.  
Mounting centres: 84mm

XL777EL30

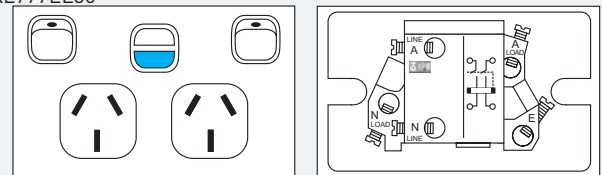

## Power brown out monitor

XL787B

Plate size: 117 x 73mm.  
Mounting centres: 84mm

XL787B

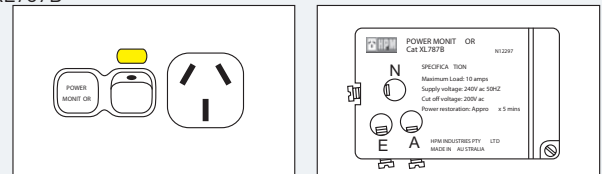

## Surge protecting double powerpoints

XL777PA

Plate size: 117 x 73mm.  
Mounting centres: 84mm

XL777PA

