

# instant heat 2 and 4 - ducted



2 heat lamp model: **Cat R622D1**  
4 heat lamp model: **Cat R622D2**

combination light, heater  
and ducted exhaust fan for  
bathrooms and ensuites



- Instant heat at the flick of a switch
- HPM Excel switch plate included
- Suitable for low roof or inter-floor spaces
- Ducting to outside prevents condensation damage to the ceiling
- Built-in draft-stopper improves household energy efficiency
- 5 year warranty on materials and workmanship
- 2 year warranty on infra red lamps

## specifications

### Instant heat 2-ducted

**Supply voltage:** 230-240V a.c. 50Hz  
**Max rating:** 630W  
**Motor rating:** 20W (centrifugal)  
**Heat lamps:** 2 x 275W  
**Light lamps:** 1 x 60W ES  
**Flexi le ducting:** 100mm dia x 3m  
**Air movement:** 120m<sup>3</sup>/hr with 3m ducting  
**Projection into wall/ceiling:** 200mm  
**Face protrusion:** 40mm  
**Rotor diameter:** 120mm  
**Hole cut-out size:** 335 x 180mm  
**Weight:** 3.0kg  
**IP rating:** NA

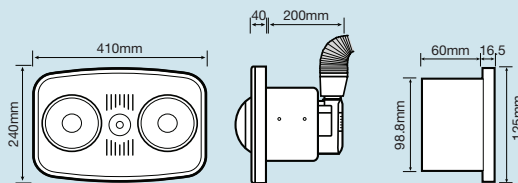

### Instant heat 4-ducted

**Supply voltage:** 230-240V a.c. 50Hz  
**Max rating:** 1240W  
**Motor rating:** 40W (centrifugal)  
**Heat lamps:** 4 x 275W  
**Light lamps:** 1 x 100W ES  
**Flexi le ducting:** 100mm dia x 3m  
**Air movement:** 240m<sup>3</sup>/hr with 3m ducting  
**Projection into wall/ceiling:** 210mm  
**Face protrusion:** 40mm  
**Rotor diameter:** 160mm  
**Hole cut-out size:** 310 x 310mm  
**Weight:** 4.5kg  
**IP rating:** NA

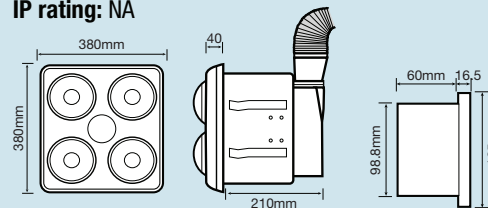

## installation

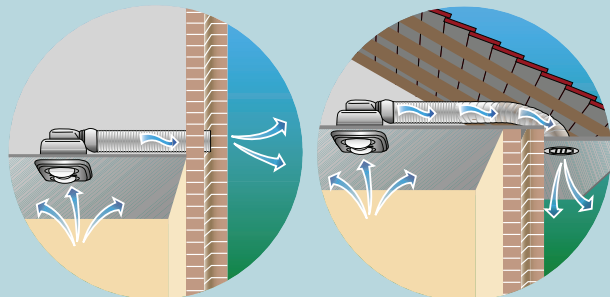

**Note:** Increasing ducting length may decrease performance, efficiency and product life span.

Multi storey  
application

Standard roof  
application