

⚠️ DANGER / 危险

HAZARD OF ELECTRIC SHOCK, EXPLOSION, OR ARC FLASH
 Disconnect all power before servicing equipment.
Failure to follow these instructions will result in death or serious injury.

可能有触电、爆炸或者电弧灼伤的危险
 在此电力设备上工作时 请先切断所有电源。
 不遵循上述规定将可能导致人员伤亡。

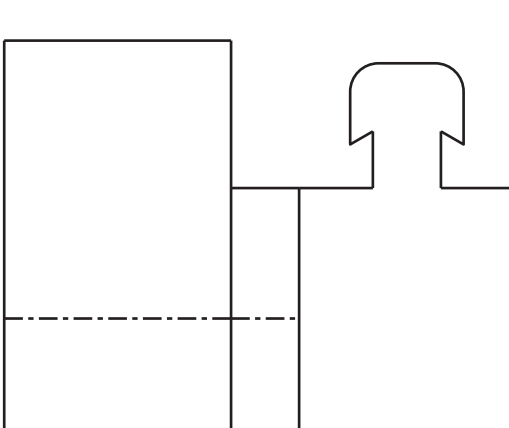

				AWG		
		[mm ²]	[mm ²]			
d	LC1D093/D123/ DT203/D0983	10 mm 3/8"	1...2,5	1...2,5	AWG14-18 CU 75°C Solid or Stranded	3,5 mm
	LC1D183/D253/ DT253/D1283	10 mm 3/8"	1...4	1...4	AWG10-18 CU 75°C Solid or Stranded	4 mm
	LC1D323	10 mm 3/8"	1...4	1...4	-	4 mm
l	LC1DT323/DT403/ D1883/D2583	13 mm 1/2"	1...10	-	AWG10-14 CU 75°C Solid AWG8-14 CU 75°C Stranded	4 mm
	LC1D●●3	8 mm 5/16"	1...2,5	1...2,5	AWG14-18 CU 75°C Solid or Stranded	3,5 mm

"For Motor Starting Use Schneider Electric Overload Relay Series LR".
 电动机启动请使用施耐德电气LR系列热过载继电器

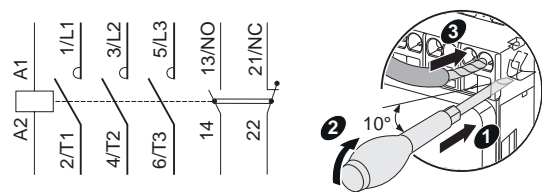

3P AC TeSys D contactors are grade 3 (LC1D09 -> LC1D18) and grade 2 (LC1D25 -> LC1D38) according to GB 21518. Maximum power consumption lower than 9.5 VA.
 根据GB 21518标准, 三相 TeSys D 系列交流接触器能效等级为3级(LC1D09 -> LC1D18)和2级(LC1D25 -> LC1D38), 产品最大吸持功率低于9.5VA

Schneider Electric Limited
 Stafford Park 5
 Telford, TF3 3BL
 United Kingdom
 www.se.com/uk



Schneider Electric Industries SAS
 35, rue Joseph Monier - CS 30323
 F - 92506 Rueil Malmaison Cedex
 www.se.com/contact

© 2021 Schneider Electric
 All rights reserved.

W9 1378322 0211 A08
 04/2021

