

Standard Cover

The most common type used because they afford maximum protection to cables at the lowest cost.

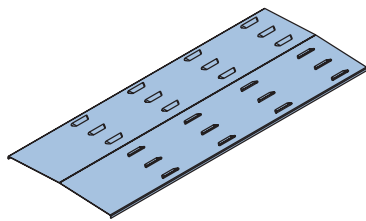

Ventilated Cover

Should be used wherever reasonable protection for cables is required and where there is also a primary requirement to allow for the escape of heat generated by cables.

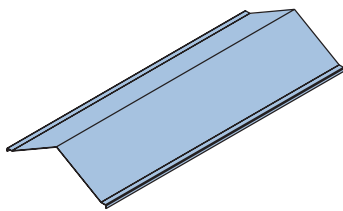

Peaked Cover

Used in very dusty situations where the self-cleaning effect of sloping sides prevents excessive dust accumulations. The larger air-space above the cables also assists with the dissipation of heat.

Ladder Covers

Covers are normally specified where protection is required:

1. To safeguard against damage to cables and insulation from falling objects - dropped tools, discarded cigarettes, sparks or solid materials.
2. Covers protect cable insulation and fixings (plastic ties etc.) from harmful effects of ultra-violet light and/or weathering deterioration.
3. In areas where high levels of airborne particles are present, covers prevent accumulation of dust or other debris on cables which may cause heat build up, fire hazards or absorb moisture, which may shorten the life of the installation.

Availability

Standard flat covers are available for all Unistrut cable ladder systems. Standard length is 3m. Straight peaked or ventilated covers are available to special order.

Material

Steel Systems: Galvabond, hot-dip galvanised steel sheet to AS 1397.

Aluminium Systems: Aluminium alloy 5005. Suitable for marine applications and compatible with the 6106-T6 used in ladders.

Steel Covers - Standard

Type	Ladder Width	Part No.
12A/12B	150	LEE6013
12A/12B	300	LEE6033
12A/12B	450	LEE6043
12A/12B	600	LEE6063
16A	150	LEG6013
16A	300	LEG6033
16A	450	LEG6043
16A	600	LEG6063
20B, 20C	150	LEK6013
20B, 20C	300	LEK6033
20B, 20C	450	LEK6043
20B, 20C	600	LEK6063
20B-RI, 20C-RI	150	LEM6013
20B-RI, 20C-RI	300	LEM6033
20B-RI, 20C-RI	450	LEM6043
20B-RI, 20C-RI	600	LEM6063

Aluminium Covers - Standard

Type	Ladder Width	Part No.
12A, 20A, 20C	150	LAM6013
12A, 20A, 20C	300	LAM6033
12A, 20A, 20C	450	LAM6043
12A, 20A, 20C	600	LAM6063