

 **CLIPSAL**<sup>®</sup>

by **Schneider** Electric

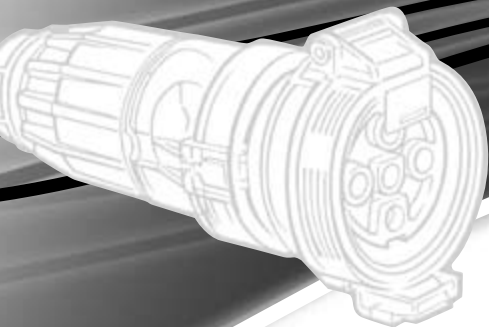

**10-20A and 32-50A**  
**IP66**

**56CSC and 56PO** Series

**56** **SERIES**<sup>™</sup>

Wiring Instructions

## 10-20 AMP

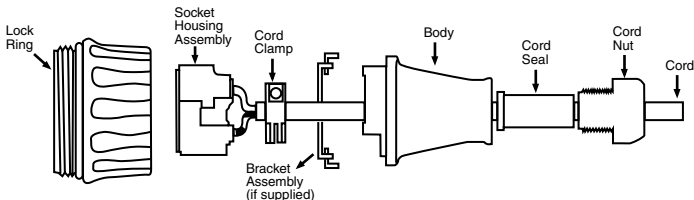

Blue (or Black) to Terminal **N**

Green/Yellow Stripes (or Green) to Terminal **E**

Brown (or Red) to Terminal **A**

## Stripping Detail

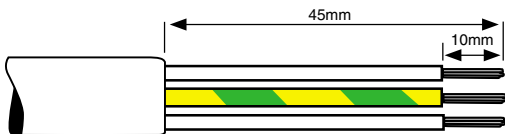

## Wiring Instructions

- Strip flexible cord as shown, pass through gland nut, bracket assembly (for PO only), thrust washer, cord gland and cover. **Depending on cable size, remove the required internal segments of the cord gland to achieve a close fit around the outside diameter of the flexible cord. This is to maintain the IP rating.**
- Loosen cord clamp and pass through to a position where cord clamp will secure on outer sheathing of flexible cord.
- Place appropriate conductors into plug pin, housing assembly terminals and tighten screws on bared ends of conductor to ensure good electrical and mechanical contact.
- Tighten cord clamp to secure flexible cord. Check Green/Yellow Earth conductor is in terminal marked **E** (⊕).
- Pull excess cord from cover until socket housing seats itself within cover. Tighten assembly screws to secure socket assembly in cover.
- Slide gland nut, cord gland and thrust washer down cord and screw into position on cover, to ensure unit is sealed.

**NOTE:** These instructions are the same for the extension sockets/appliance connectors and pendant outlets, and are designed for use with ordinary duty or heavy duty flexible cords and cables.

Minimum acceptable cable outside diameter = 5mm.

Maximum acceptable cable outside diameter = 16mm.

## 32-50 AMP

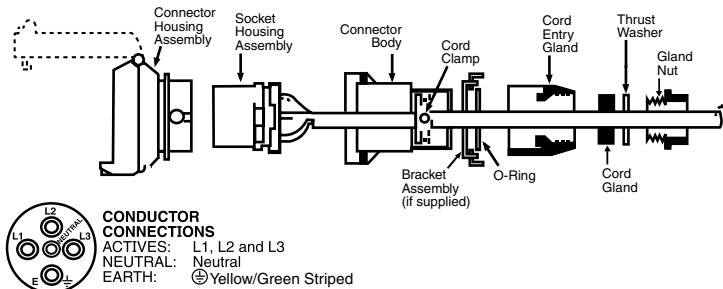

## Stripping Detail

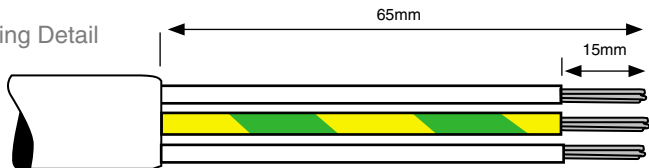

## Wiring Instructions

- Strip flexible cord as shown, loosen cord clamp on body, pass flexible cord through gland nut, thrust washer, cord gland, cord entry gland, o-ring, bracket assembly (for PO only), cord clamp and connector body. **Depending on cable size, remove the required internal segments of the cord gland to achieve a close fit around the outside diameter of the flexible cord. This is to maintain the IP rating.**
- Place appropriate conductors into plug pin, housing assembly terminals and tighten screws on bared ends of conductor to ensure good electrical and mechanical contact.
- Pull excess cord from body until socket housing seats itself within body. Place housing assembly over socket assembly then tighten screws to secure socket assembly in body.
- Tighten cord clamp to secure outer sheathing of the flexible cord. Check Green/Yellow Earth conductor is in terminal marked E ⊕.
- Slide bracket assembly (for PO only) o-ring, cord entry gland, cord gland, thrust washer and gland nut down cord and screw into position on connector body to ensure unit is sealed.

**NOTE:** These instructions are the same for the extension sockets/appliance connectors and pendant outlets, and are designed for use with ordinary duty or heavy duty flexible cords and cables.

Minimum acceptable cable outside diameter = 9mm.

Maximum acceptable cable outside diameter = 28mm.

## Old Design Connector

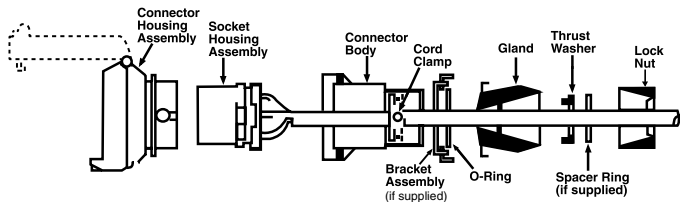

**NOTE:** Spacer ring supplied for old design lock nut only.

### Clipsal Australia Pty Ltd

A member of Schneider Electric

[clipsal.com](http://clipsal.com)

Contact us: [clipsal.com/feedback](http://clipsal.com/feedback)

National Customer Care Enquiries:

**Tel 1300 2025 25 Fax 1300 2025 56**

Clipsal Australia Pty Ltd reserves the right to change specifications, modify designs and discontinue items without incurring obligation and whilst every effort is made to ensure that descriptions, specifications and other information in this catalogue are correct, no warranty is given in respect thereof and the company shall not be liable for any error therein.

© Clipsal Australia Pty Ltd. The identified trademarks and copyrights are the property of Clipsal Australia Pty Ltd unless otherwise noted.