

Metal Glands - Unarmoured IP68

IP68 RATING

CABAC's Metal Gland is a unique product that is very different from traditional metal glands.

- IP68 rating - the highest possible
- Superior strain relief
- Large cable range with each gland
- Nickel plated brass for corrosion protection
- Incorporates a unique 'camera shutter' principle which protects the cable
- Fully insulated by plastic insert
- Neoprene seal for fluid tightness
- Metric thread to suit Australian requirements
- PG thread for motors etc. from Europe

Installation is extremely simple, just pass the cable through the assembled gland and tighten gland nut until cable is secured. No need to disassemble the gland.

The perfect gland for unarmoured PVC, XLPE and other synthetic cables.

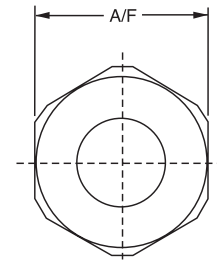
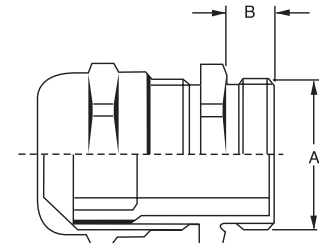

Metric Thread Range

Catalogue No.	Mounting Thread A Dia. (mm)	B Length (mm)	Min. Cable Range (mm)	Max. Cable Range (mm)	Width A/F (mm)	Std Pack
GU12	12	10	3	6	14	40
GU16	16	10	5	9	17	20
GU20	20	10	9	13	22	20
GU25	25	11	11	16	27	10
GU32	32	13	14	21	34	5
GU40	40	13	19	27	43	3
GU50	50	13	24	35	55	1
GU63	63	14	32	42	65	1

Note: These glands are NOT supplied with locknuts, see below.

PG Thread Range

Catalogue No.	Thread	Length of Thread (mm)	Min. Cable Range (mm)	Max. Cable Range (mm)	Width A/F (mm)	Std Pack
GU9PG	9PG	6	4	8	17	40
GU11PG	11PG	6	5	10	22	20
GU13.5PG	13.5PG	6.5	6	12	22	20
GU16PG	16PG	6.5	10	14	24	20
GU21PG	21PG	7.0	13	18	30	10

Note: These glands are NOT supplied with locknuts, see below.

Locknuts

Metric Brass Locknuts Nickel Silver Plated

Our metal glands do not include locknuts as standard.

- LNM12** Brass locknut 12mm
- LNM16** Brass locknut 16mm
- LNM20** Brass locknut 20mm
- LNM25** Brass locknut 25mm
- LNM32** Brass locknut 32mm
- LNM40** Brass locknut 40mm
- LNM50** Brass locknut 50mm
- LNM63** Brass locknut 63mm



PG Locknuts, Brass and Nylon

PG glands, nylon and brass do not include locknuts.

Nylon

- LNN9PG** Nylon locknut for GN9PG
- LNN11PG** Nylon locknut for GN11PG
- LNN13.5PG** Nylon locknut for GN13.5PG
- LNN16PG** Nylon locknut for GN16PG
- LNN21PG** Nylon locknut for GN21PG

Brass

- LNM9PG** Brass locknut for GU9PG
- LNM11PG** Brass locknut for GU11PG
- LNM13.5PG** Brass locknut for GU13.5PG
- LNM16PG** Brass locknut for GU16PG
- LNM21PG** Brass locknut for GU21PG



Metal Glands - Unarmoured IP68

IP68 RATING

Gland Selection Chart

Note: This chart should be used as a guide only. Cable dimensions vary by manufacturer and insulation type.

Cable Area (mm ²)	PVC Ins. Single	S.D.I. Single	Two Core & Earth	Three Core & Earth	Four Core & Earth
1		GU16			
1.5	GU12	GU16	GU16/GU20	GU20	GU20
2.5	GU12	GU16	GU20	GU25	GU25
4	GU12	GU16/GU20	GU20/GU25	GU25/GU32	GU25/GU32
6	GU12/GU16	GU16/GU20	GU25	GU32	GU32
10	GU16	GU16/GU20	GU25/GU32	GU32	GU32/GU40
16	GU16	GU20	GU32	GU32/GU40	GU40
25	GU16/GU20	GU20/GU25	GU40	GU40	GU40/GU50
35	GU20	GU25		GU40/GU50	GU50
50	GU20/GU25	GU25/GU32		GU50	GU50/GU63
70	GU25	GU32		GU63	GU63
95	GU25/GU32	GU32/GU40		GU63	
120	GU32	GU40			
150	GU32/GU40	GU40			
185	GU40	GU40/GU50			
240	GU40	GU50			
300	GU40/GU50	GU50/GU63			
400	GU50	GU63			
500	GU50/GU63	GU63			
630	GU63				

Technical Data

Material

Brass nickel plated Polyamide 6 Insert
(self extinguishing)
Neoprene seal (self extinguishing)
Neoprene O-ring (self extinguishing)

Continuous Operating Temperature

-20°C to +100°C

Chemical Resistance

Resistant to normal organic solvents, mineral, animal and vegetable oils, fat and petrol.

Conformant Standard

DIN 46 319 – brass glands metric

Threading

According to IEC 423, IEC 423A and EN 60423

IP Rating

IP68

Strain Relief and Twisting Protection

To DIN VDE 0619

Recommended Torque

Product	Torque (Nm)
GU12	6
GU16	6
GU20	6
GU25	7
GU32	10
GU40	10
GU50	10
GU63	10