

Twin & Uninsulated Bootlace Pins

Twin Wire BLPT Bootlace Pins

The twin wire BLPT range is specifically designed to terminate two wires in the same terminal. With the development of smaller switches and devices become smaller. The twin wire BLPT solves these problems in a quick and easy way.

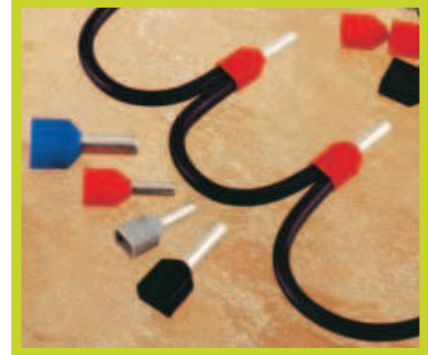
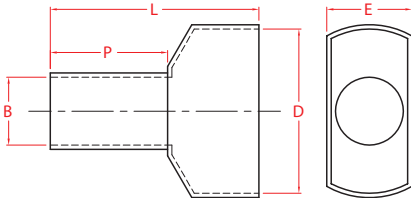

Catalogue No.	Nominal Conductor (mm ²)	Dimensions (mm)					Colour	Pack	Tooling			
		L	P	B	D	E			HNKES3	HNKES5	HNKES6	HNKES9
BLPT075	2 x 0.75	15.0	8.0	1.8	5.0	2.8	Grey	100				
BLPT100	2 x 1.0	15.0	8.0	2.05	5.4	3.4	Red	100				
BLPT150	2 x 1.5	16.0	8.0	2.3	6.6	3.6	Black	100				
BLPT250	2 x 2.5	18.5	10.0	2.8	7.8	4.2	Blue	100				
BLPT400	2 x 4.0	23.0	12.0	3.7	8.8	4.9	Grey	50				
BLPT600	2 x 6.0	26.0	14.0	4.8	10.0	6.9	Yellow	25				

Uninsulated Bootlace Pins - Cord End Connectors

CABAC un-insulated bootlace pins are used to terminate conductors, by containing the strands in a thin walled copper sleeve. Crimping of the sleeves is optional, since the screw in the terminal will "crimp" the connection.

Catalogue No.	Nominal Conductor (mm ²)	Dimensions (mm)		Std Pack	Tooling			
		L	B		HNKES3	HNKES6	HNKES5	HNKES7, 10 & 11
BLPU050	0.50	8	1.0	100				
BLPU075	0.75	8	1.2	100				
BLPU100	1.0	10	1.4	100				
BLPU150	1.5	10	1.7	100				
BLPU250	2.5	10	2.2	100				
BLPU400	4	12	2.8	100				
BLPU600	6	12	3.5	100				
BLPU1000	10	12	4.5	25				
BLPU1600	16	12	5.8	25				
BLPU2500	25	18	7.3	10				
BLPU3500	35	18	8.3	10				
BLPU5000	50	20	10.3	10				
BLPU7000	70	25	13.5	5				
BLPU9500	95	32	14.7	3				
BLPU12000	120	32	16.7	3				

